

ahead RC Crawler V303

Assembly Manual



Required tools and hardware

Tools

- 1.5mm Hex Driver
- 2.0mm Hex Driver
- 2.5mm Hex Driver
- Needle Nosed Pliers
- Instant Glue
- Hot Glue

Electronics

- 5mm LED White x3
- 5mm LED Red x2
- 3mm LED Orange x2

Hardware

Hardware	Quantity	Check ✓
M2*5 Socket head	41	
M2*8 Socket head	22	
M2*10 Socket head	20	
M3*10 Socket head	3	
M3*15 Socket head	14	
M3*25 Socket head	4	
M3*10 Button head (BH)	2	
M3*15 Countersunk (CS)	2	
M3*3 Grub screw (GS)	4	
M3*10 Grub screw (GS)	2	
M3*20 Grub screw (GS)	2	
1*6 Dowel Pin	2	

Before you begin

- Be sure to read through the manual and familiarise yourself with the instructions
- Visualise a plan to assemble all the pieces
- Make sure you have all of the hardware and tools
- Be sure to have enough instant glue
- Dry fit all parts before painting and assembling

Tip: It will help to paint all of the parts before final assembly

Assembling the cab and door hinges

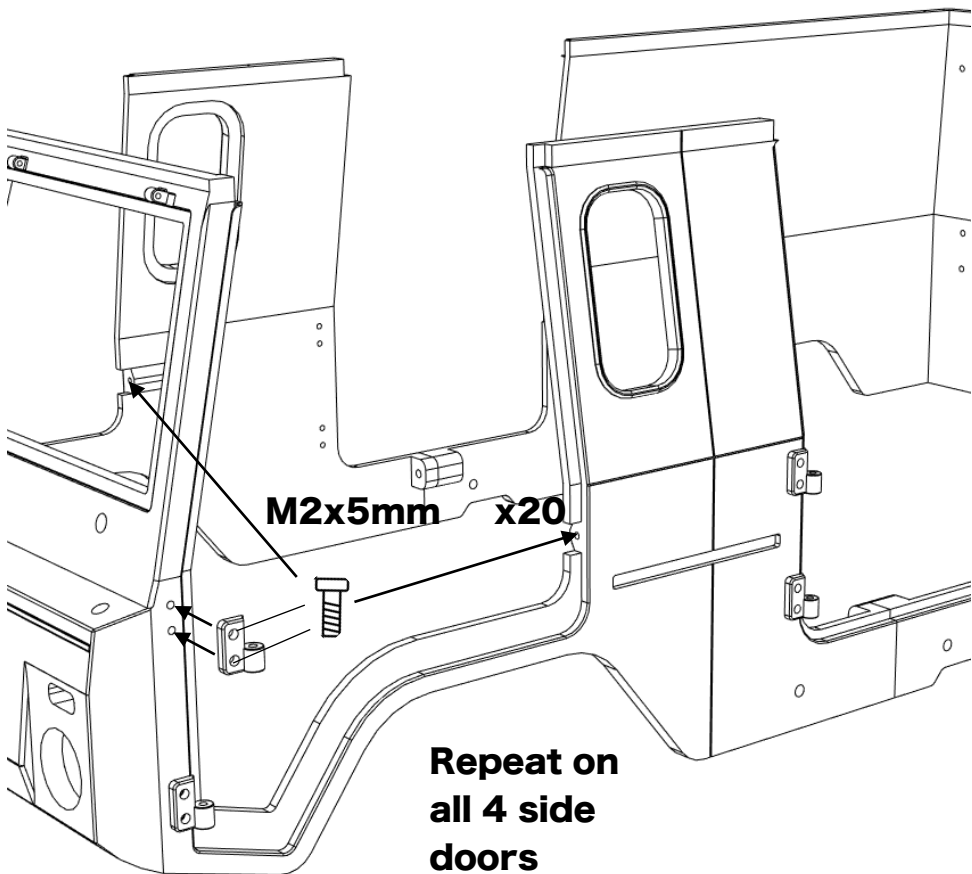
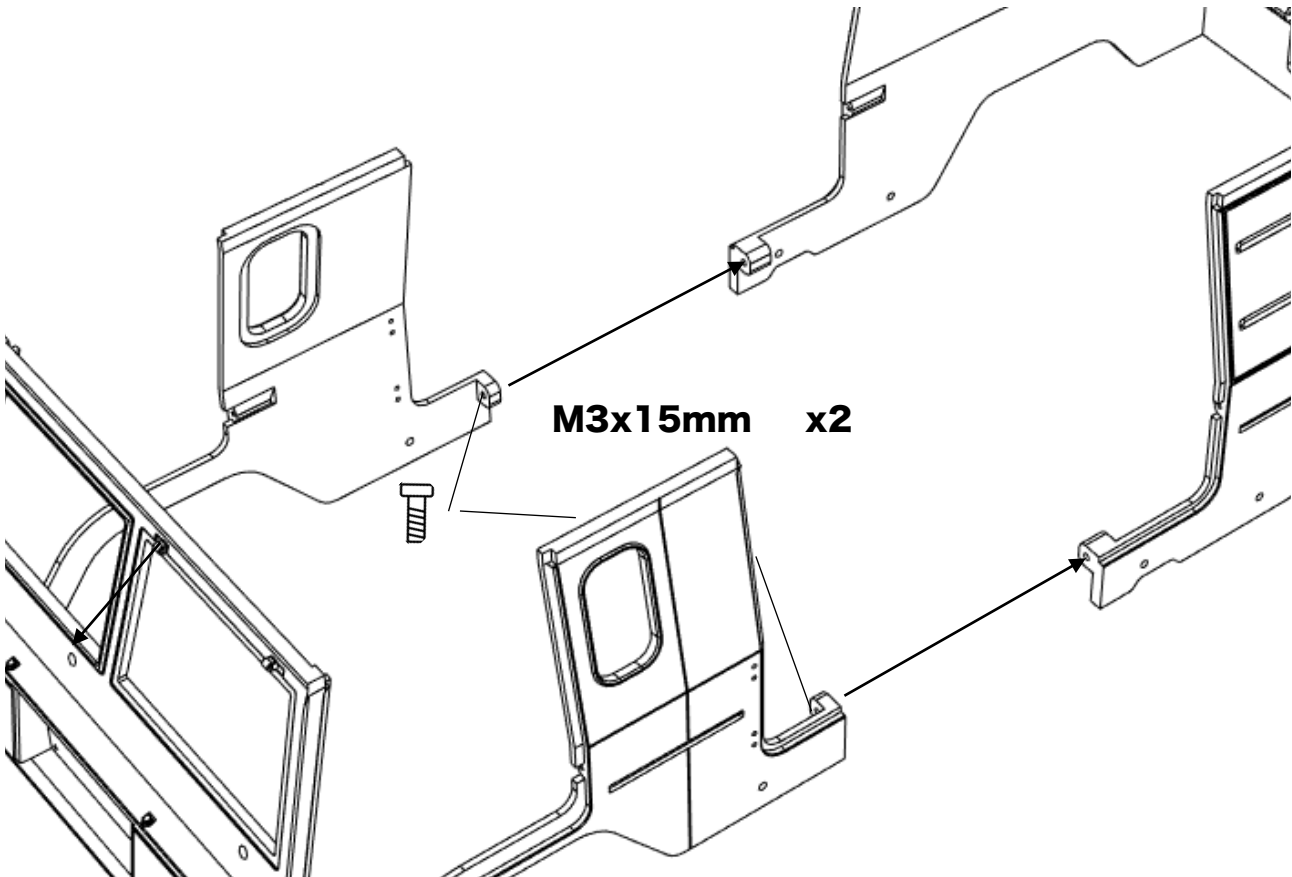

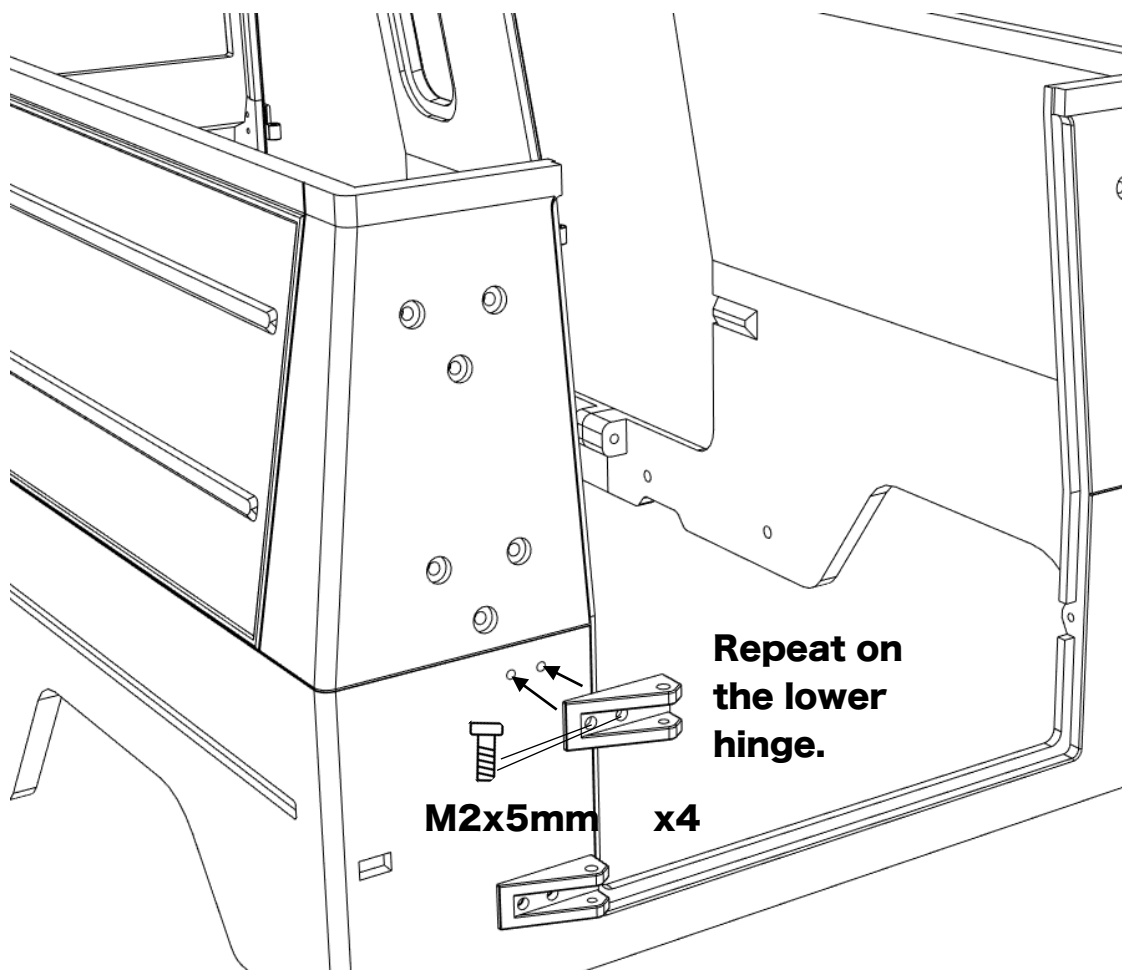

Assembling the doors

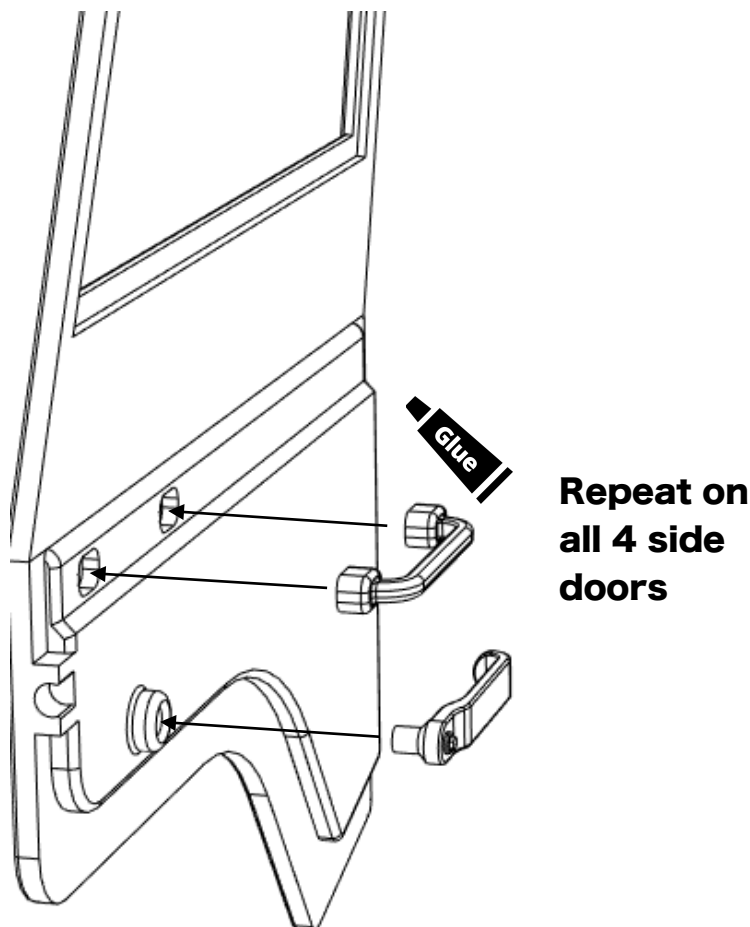
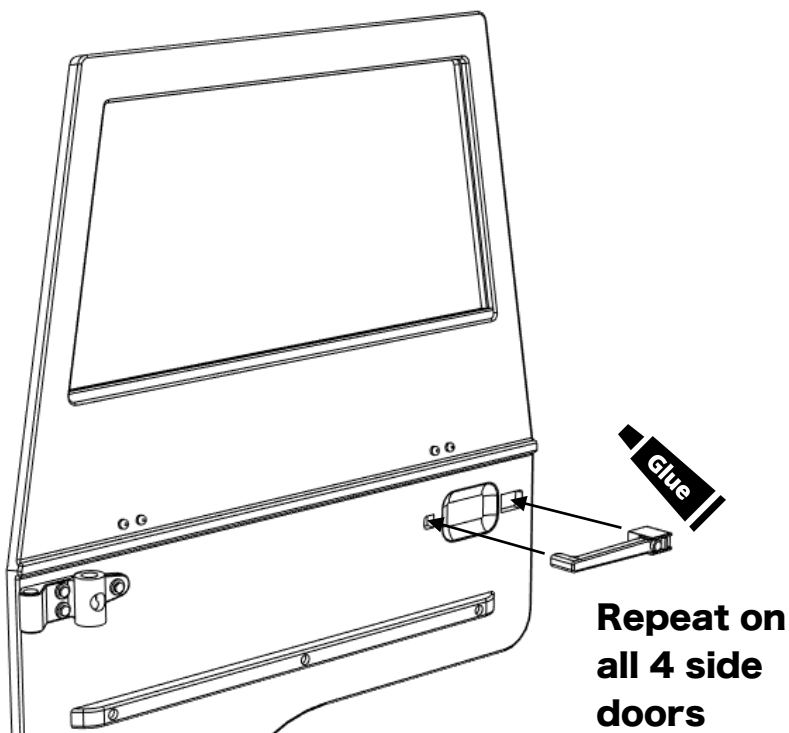

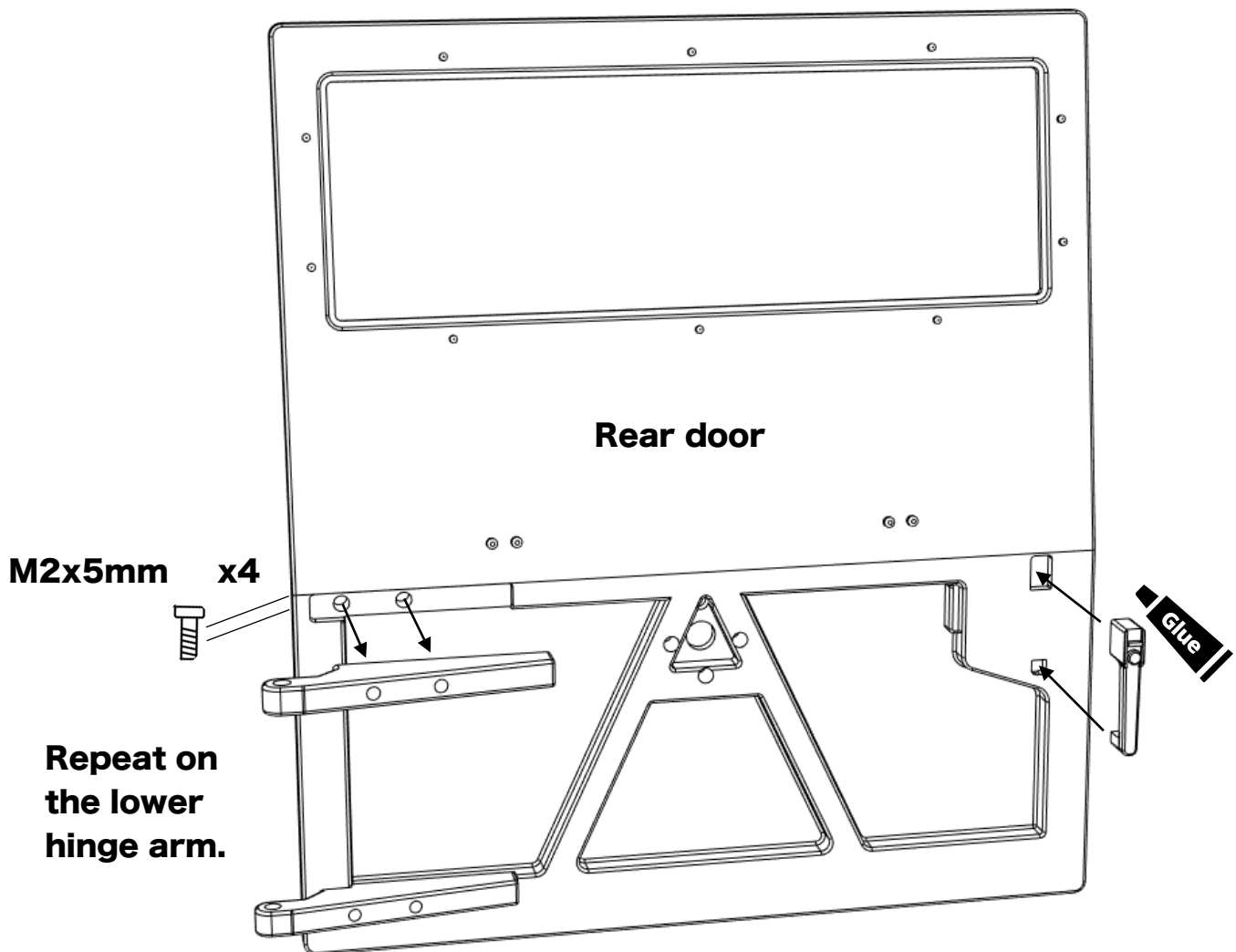
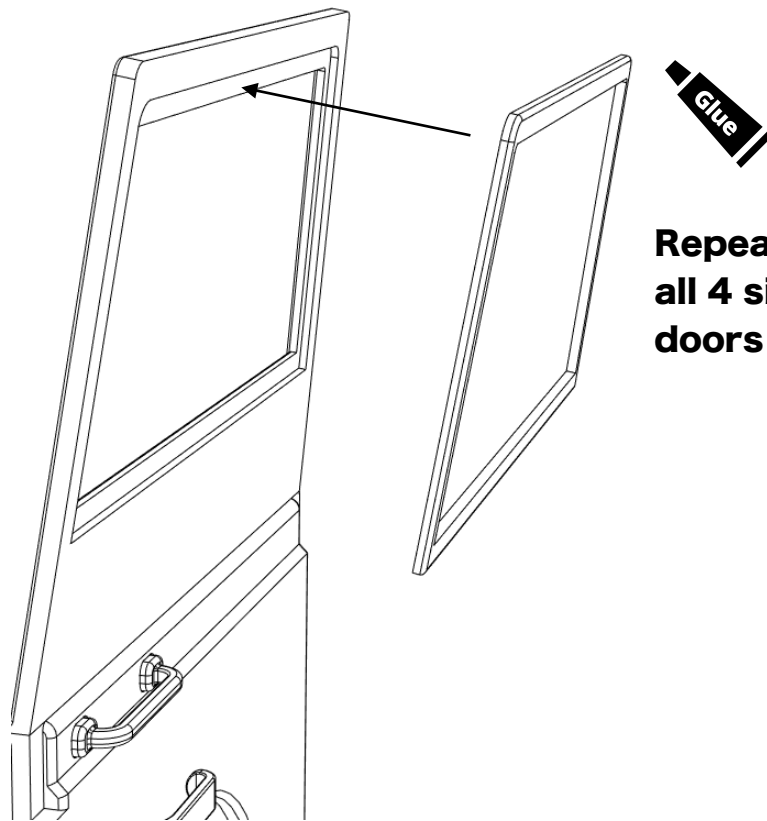

M2x10mm

x4

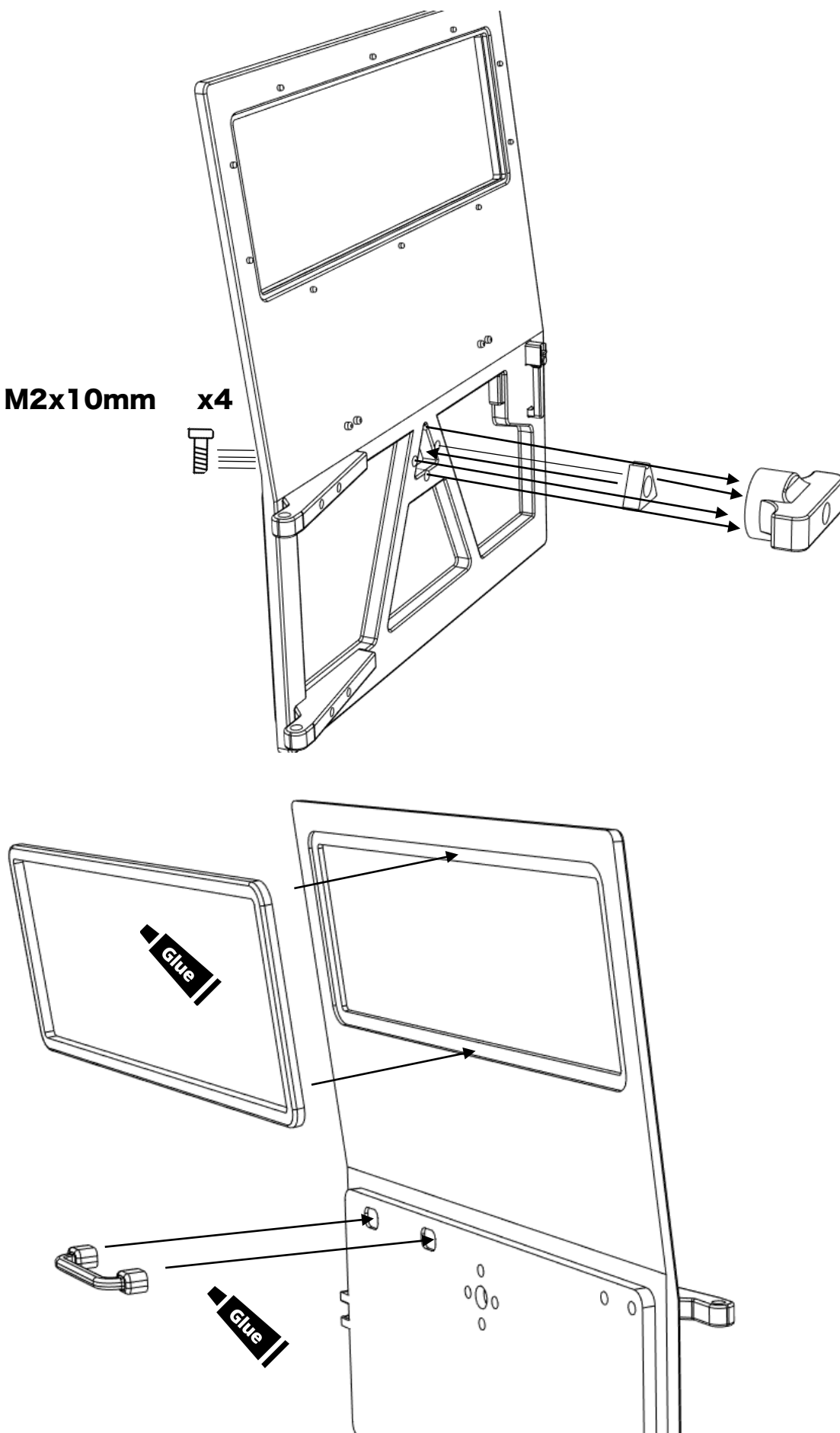

Installing the doors

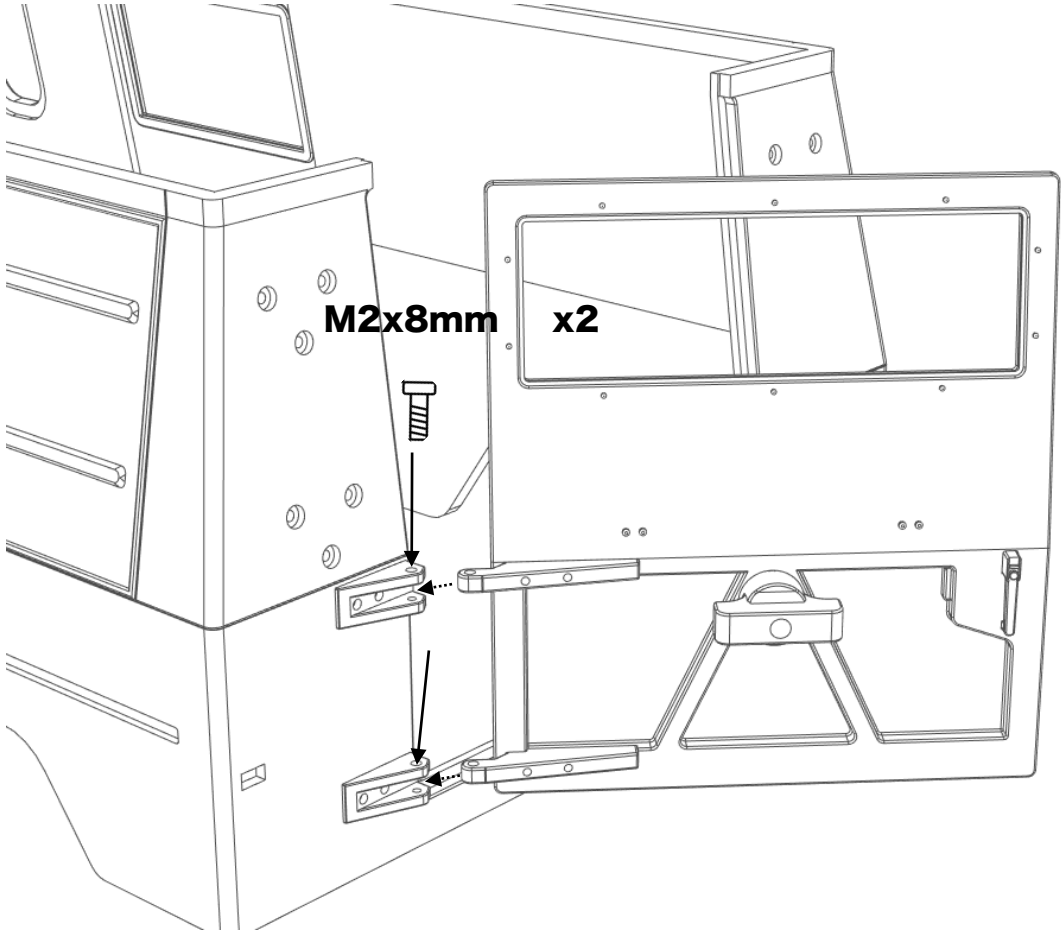
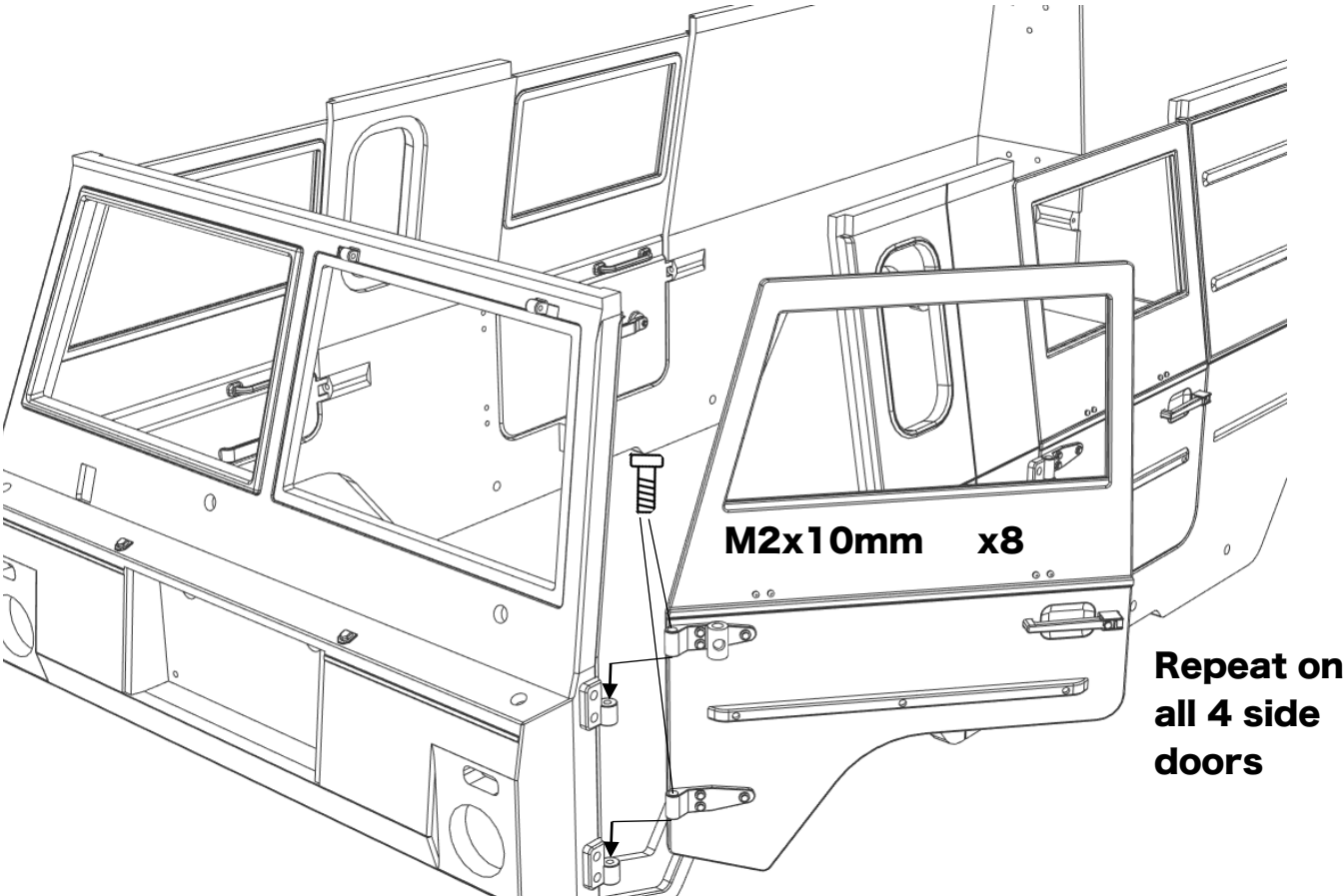

Installing cab window presses and windshield

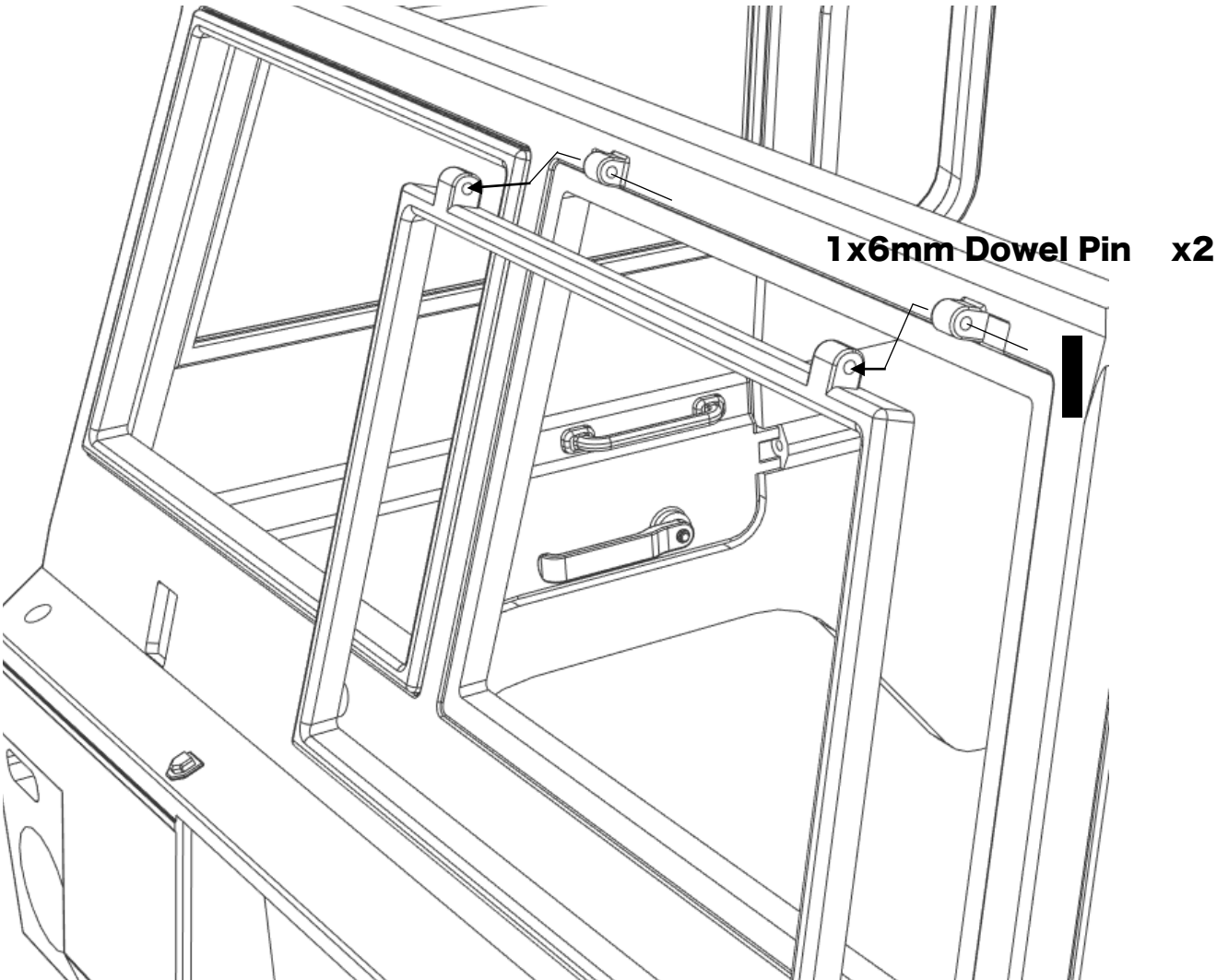
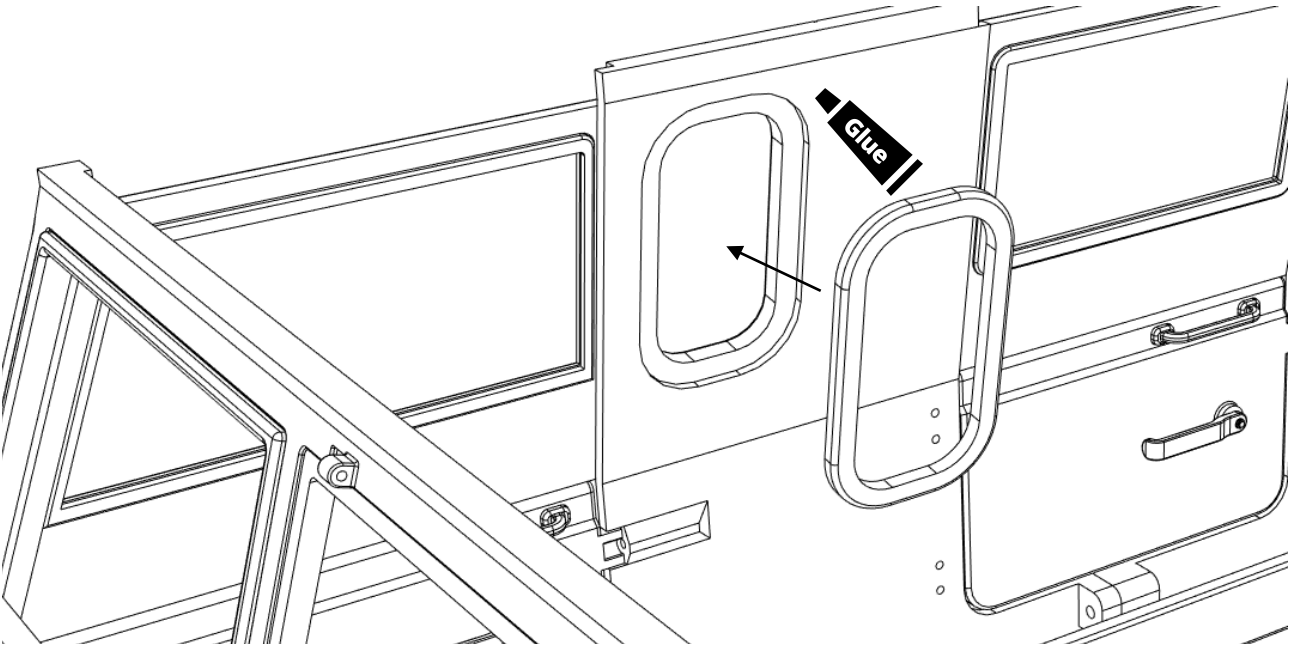

Installing the lights and mirrors

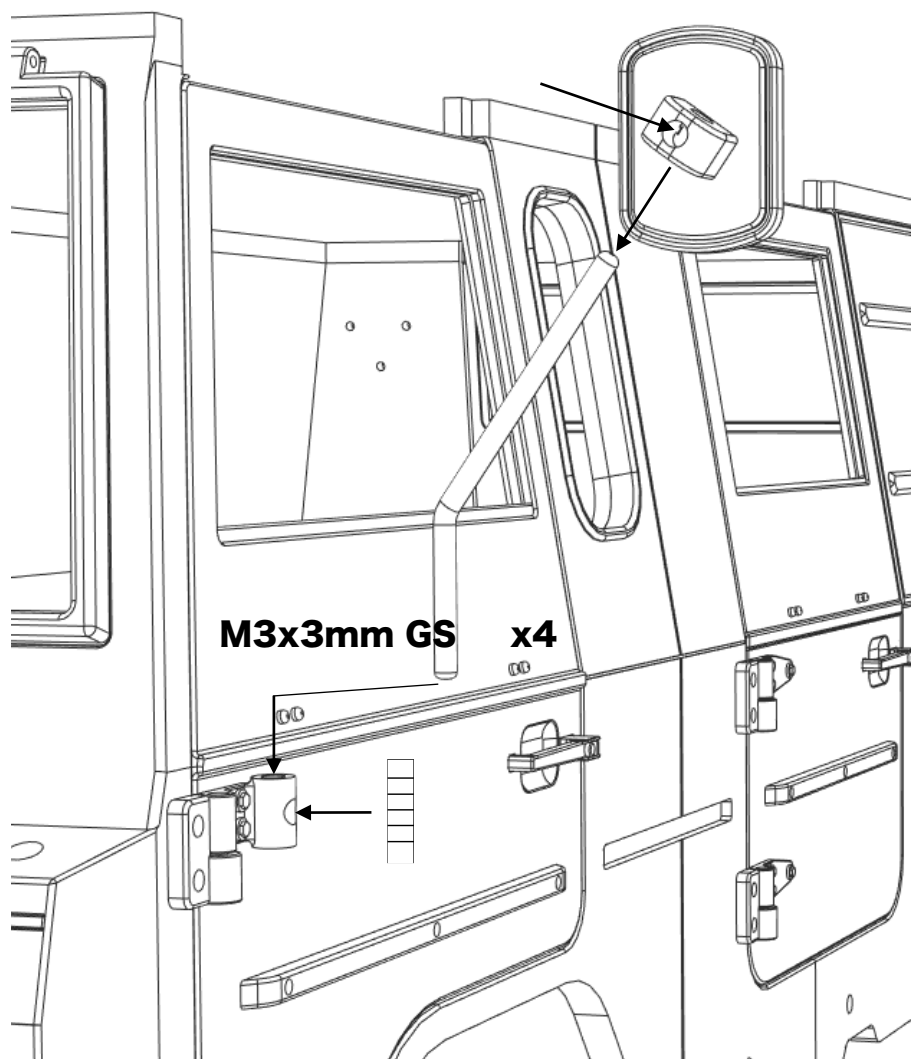
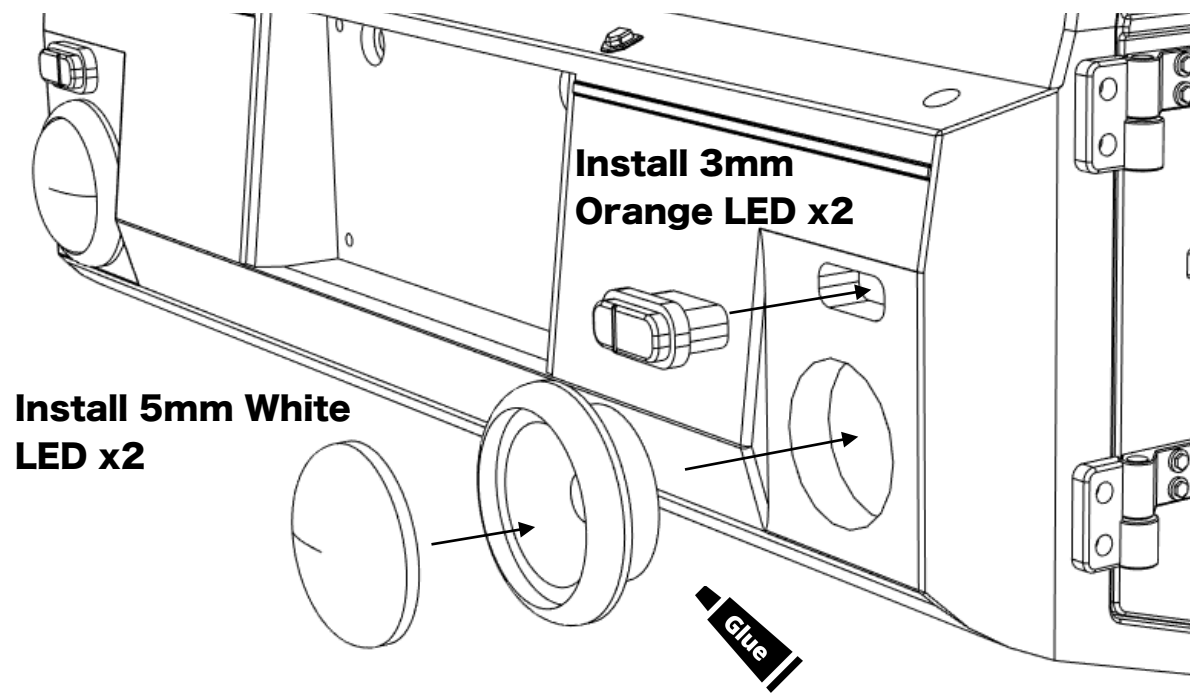

Assembling the interior dashboard

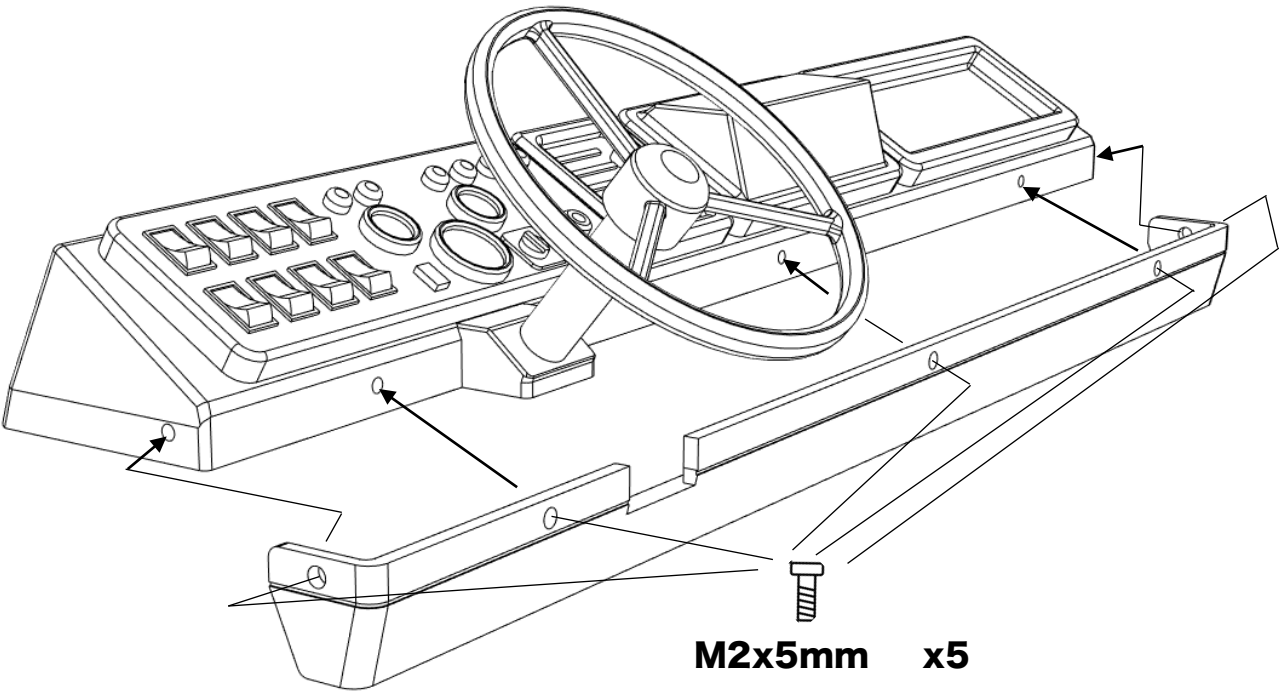
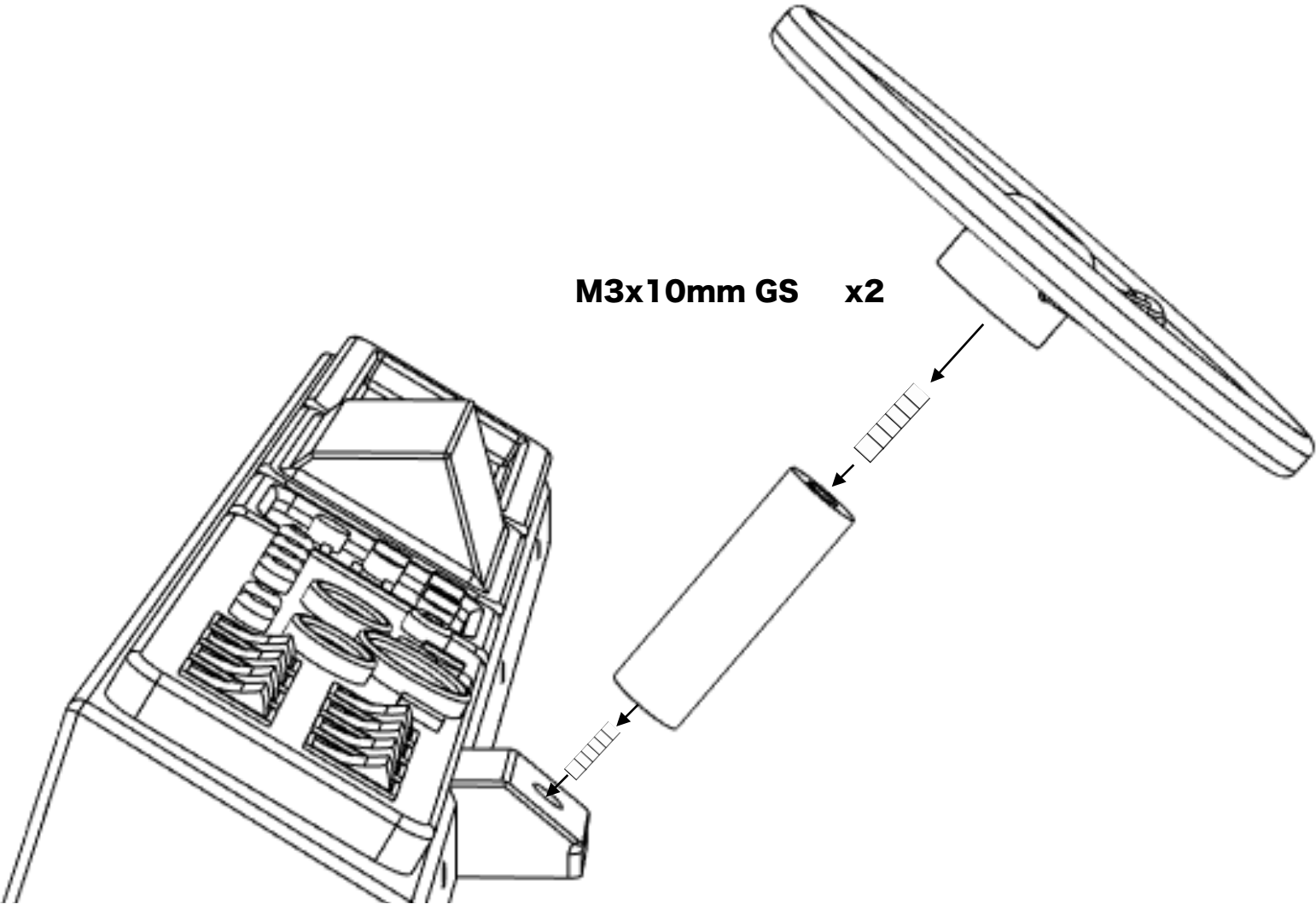

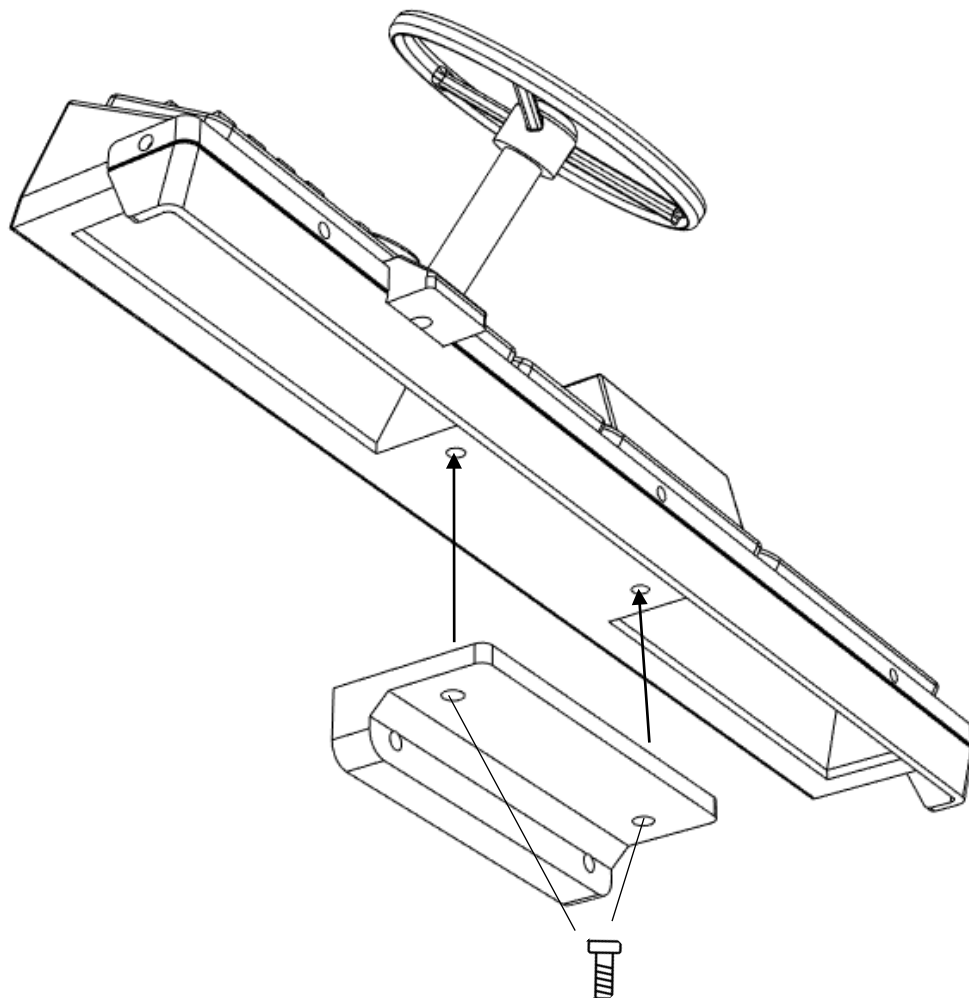

M3x10mm x2

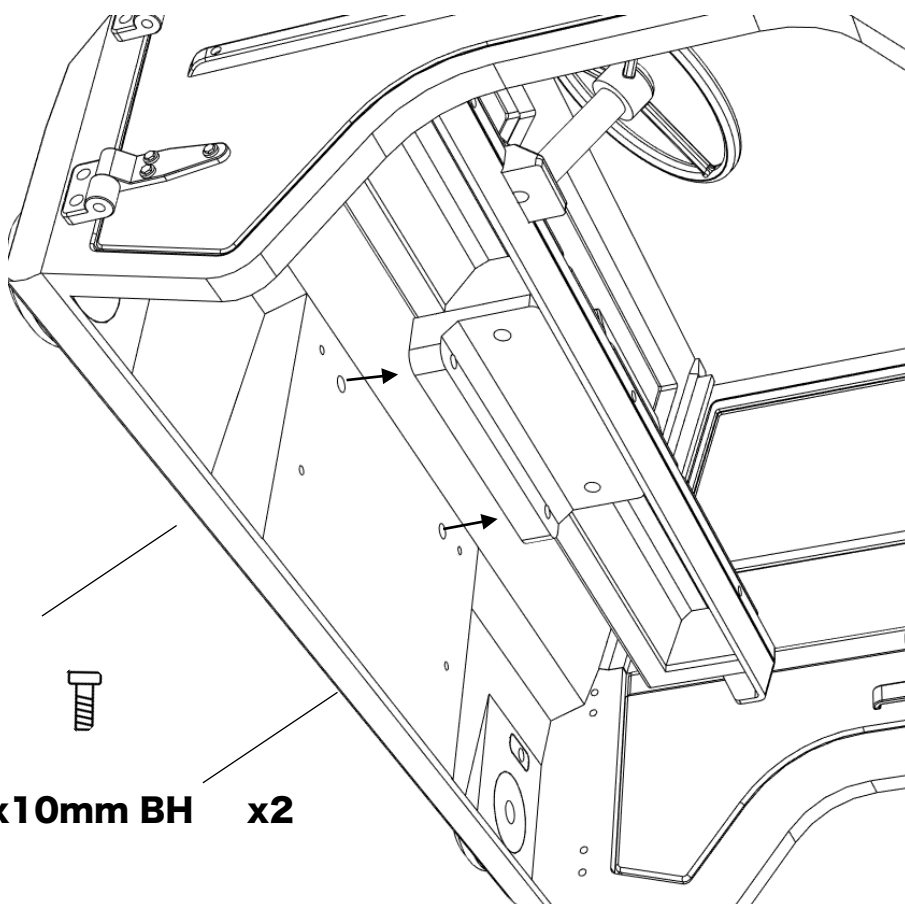

M3x10mm BH x2

ahead RC

Installing the radiator and grille

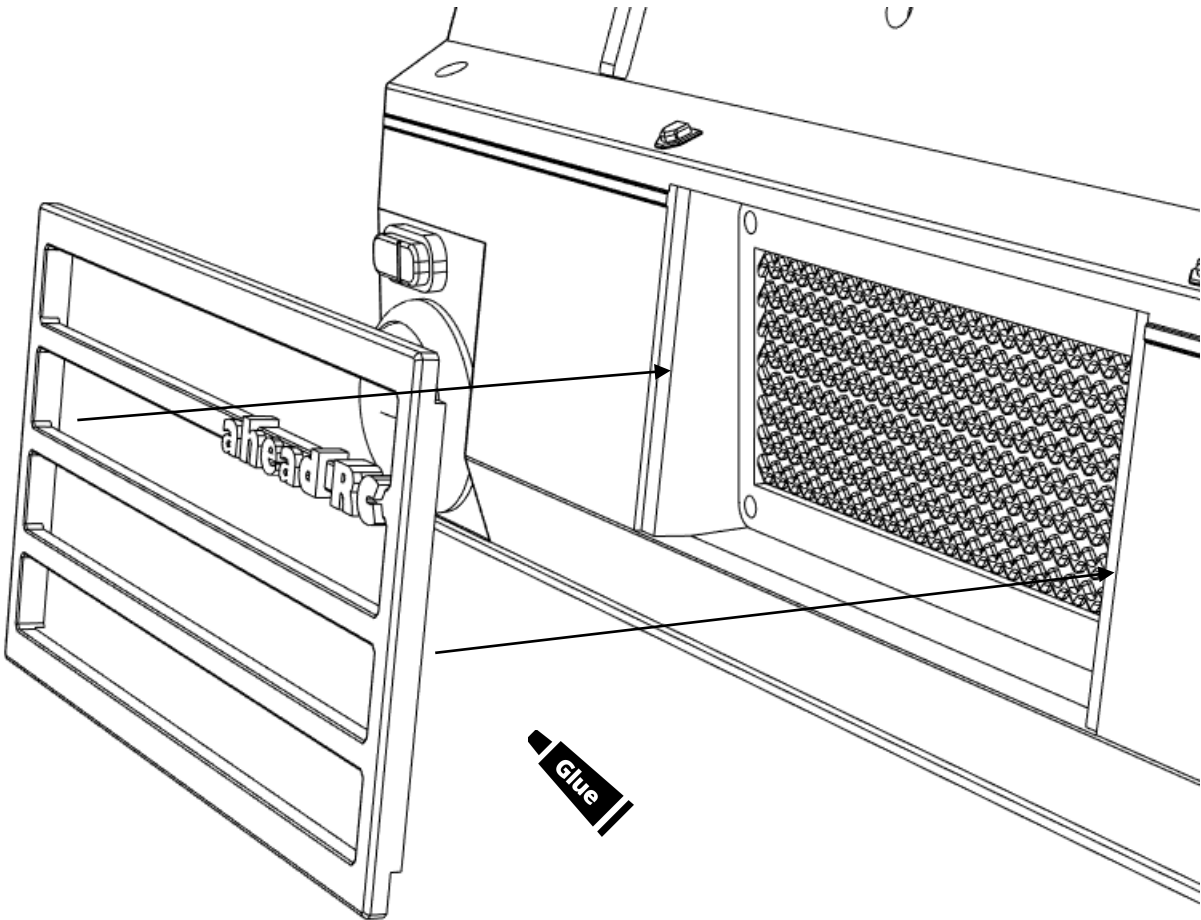
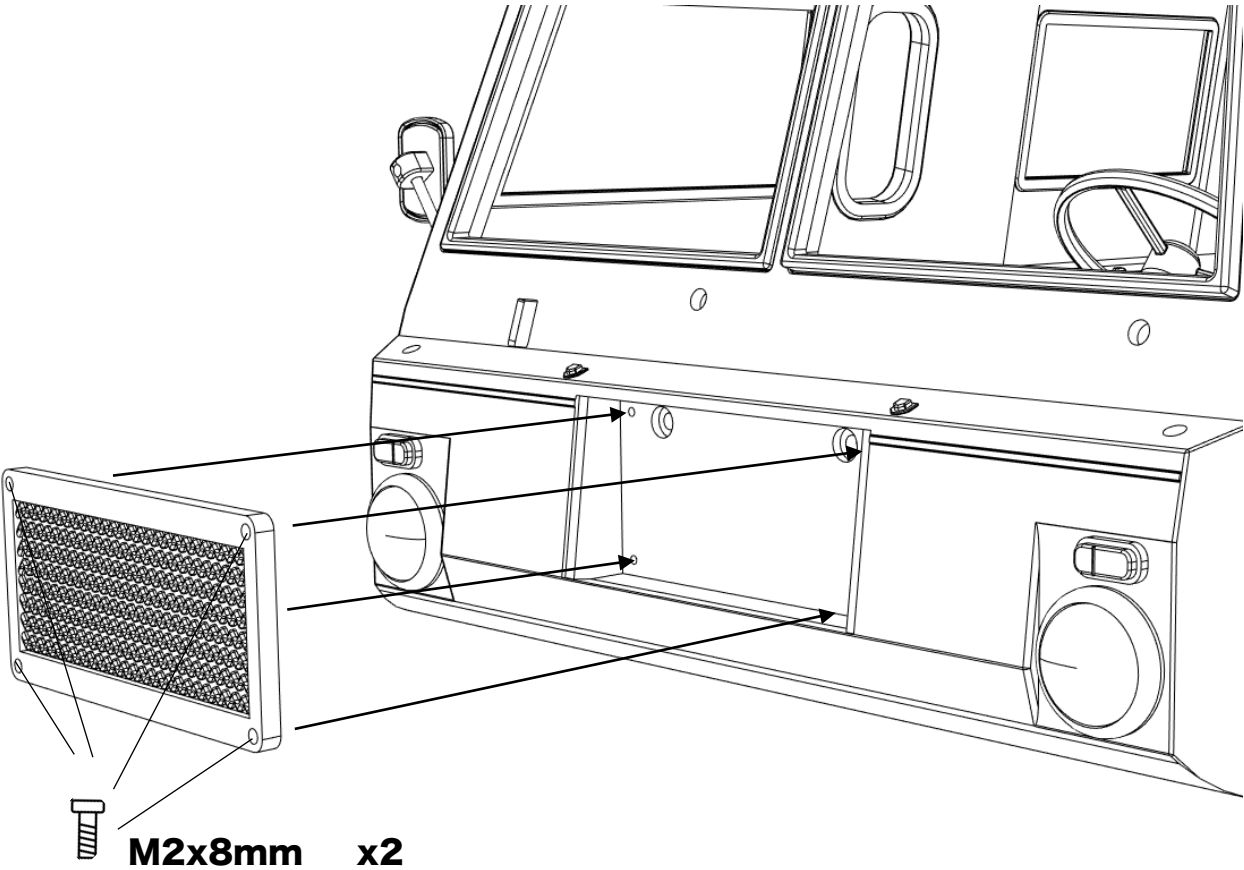

Installing the details

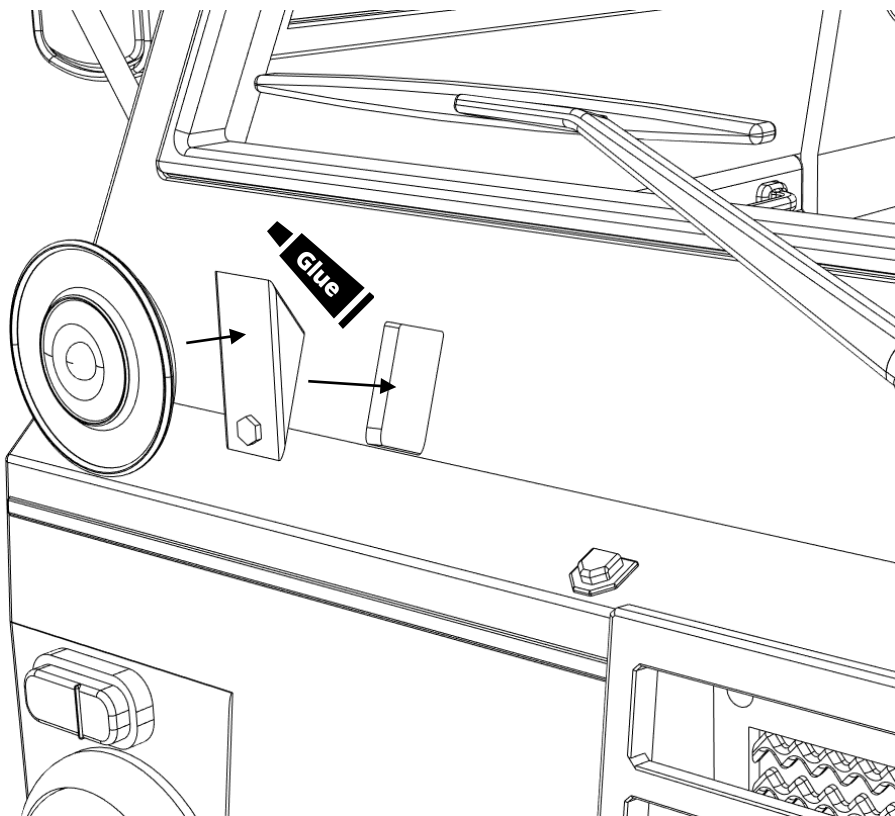
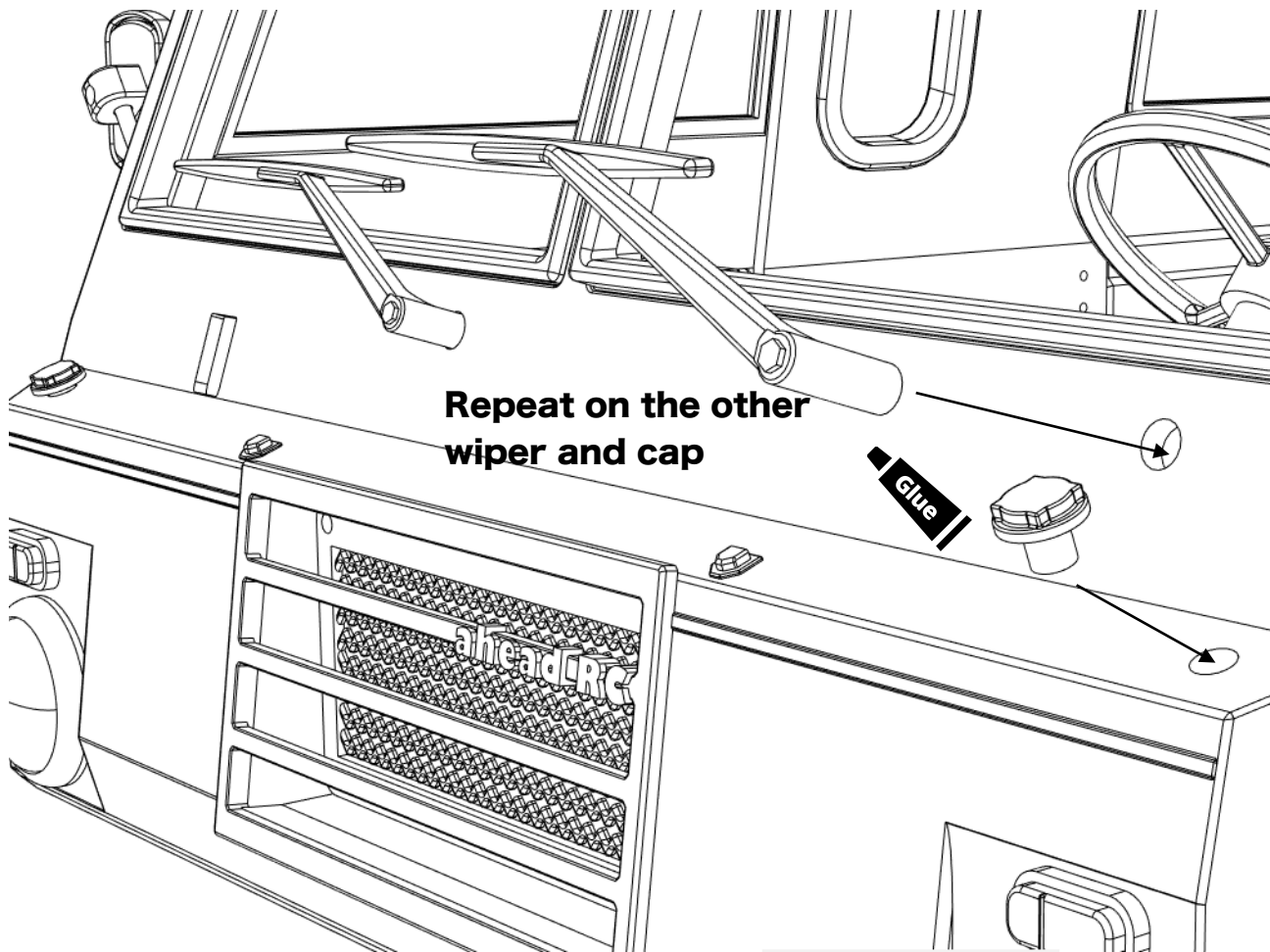

**Repeat on all 4 cab
side guard bars**

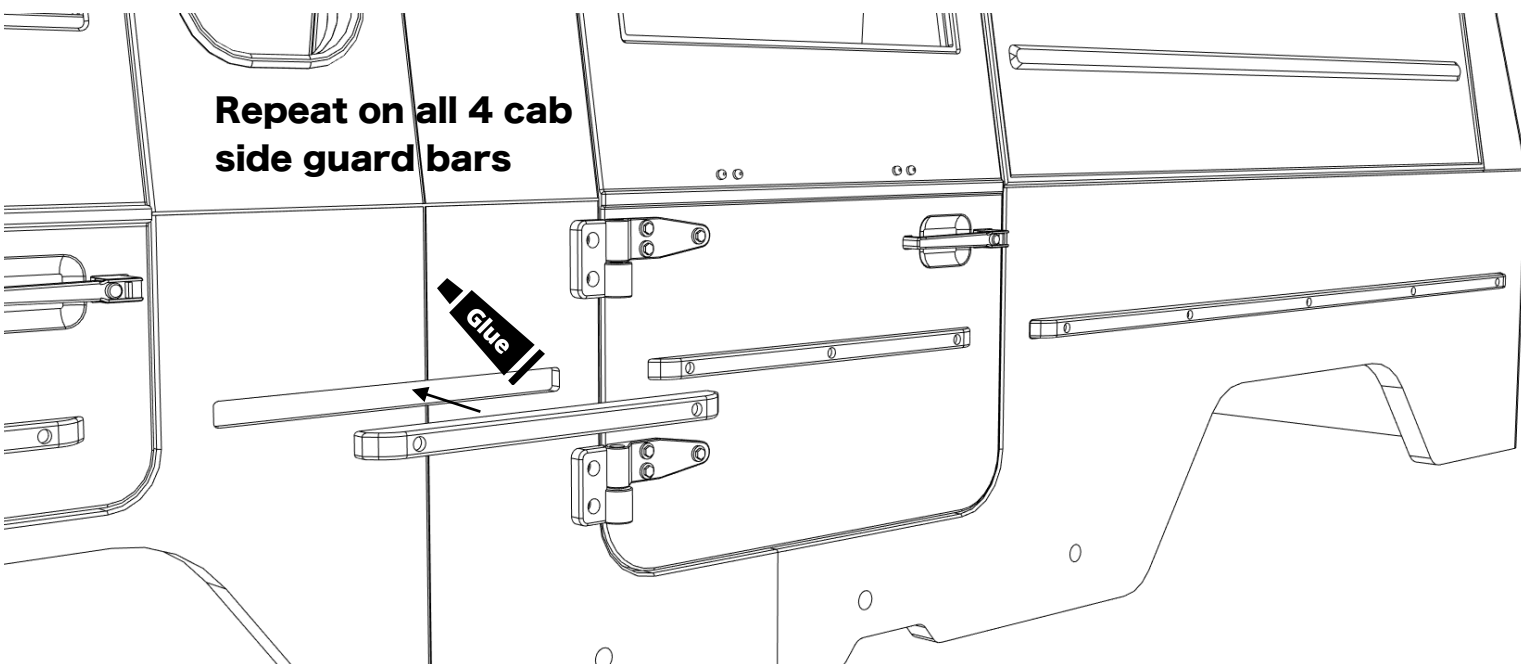

Rear side

**Repeat on the other
bracket**

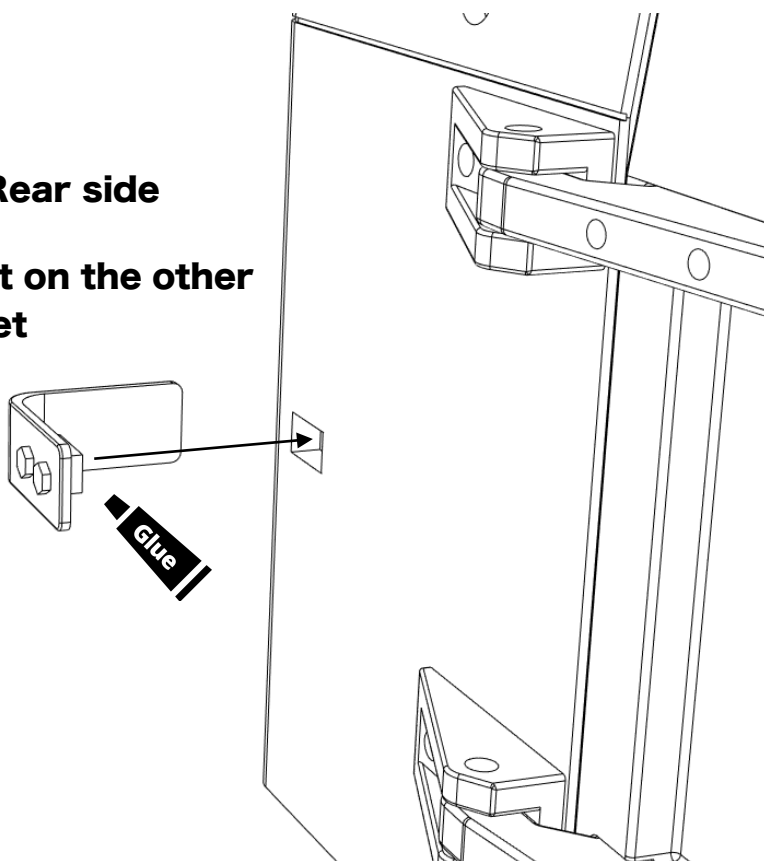

**Repeat on all 3 rear
plate carriers**

M2x8mm x9

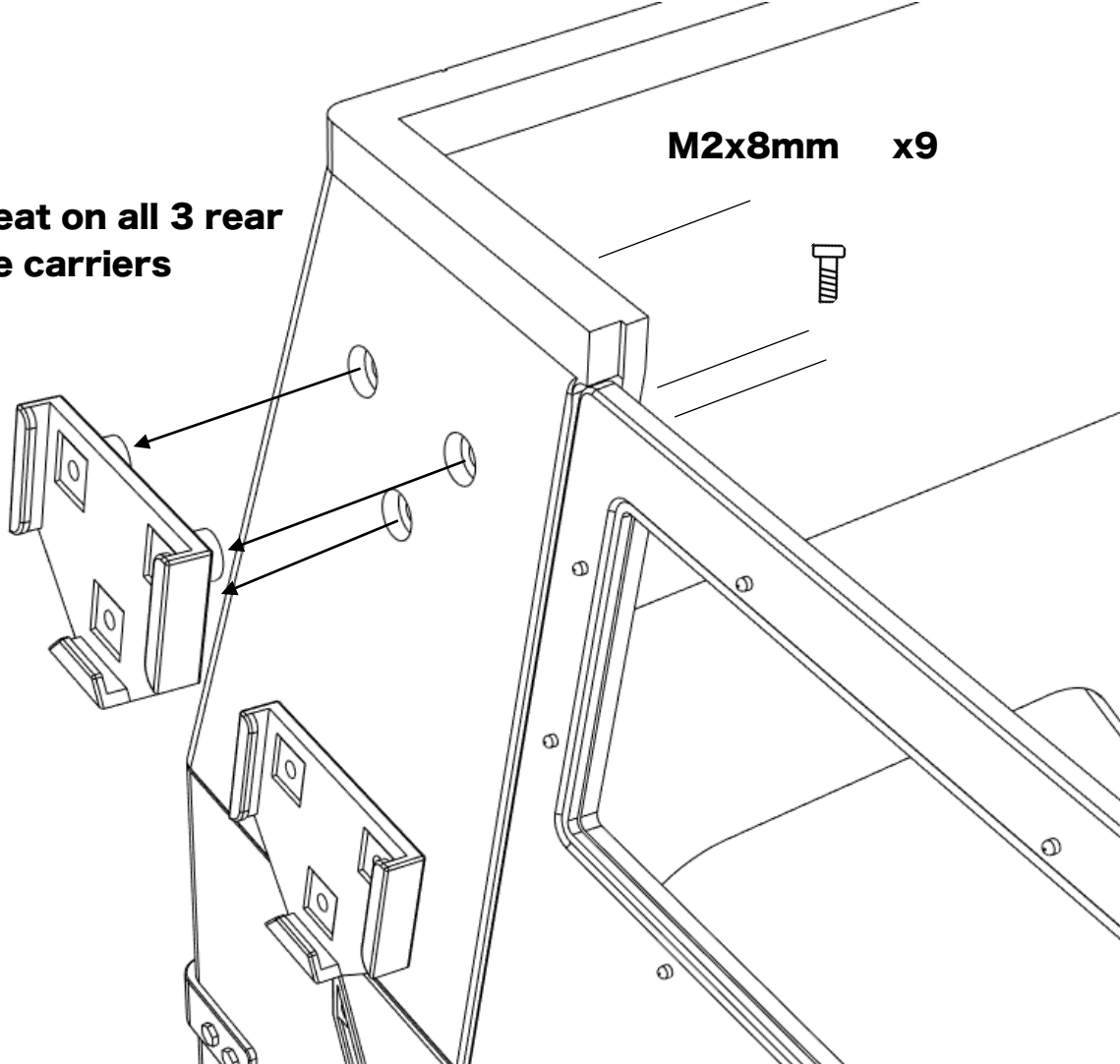

M2x8mm x4

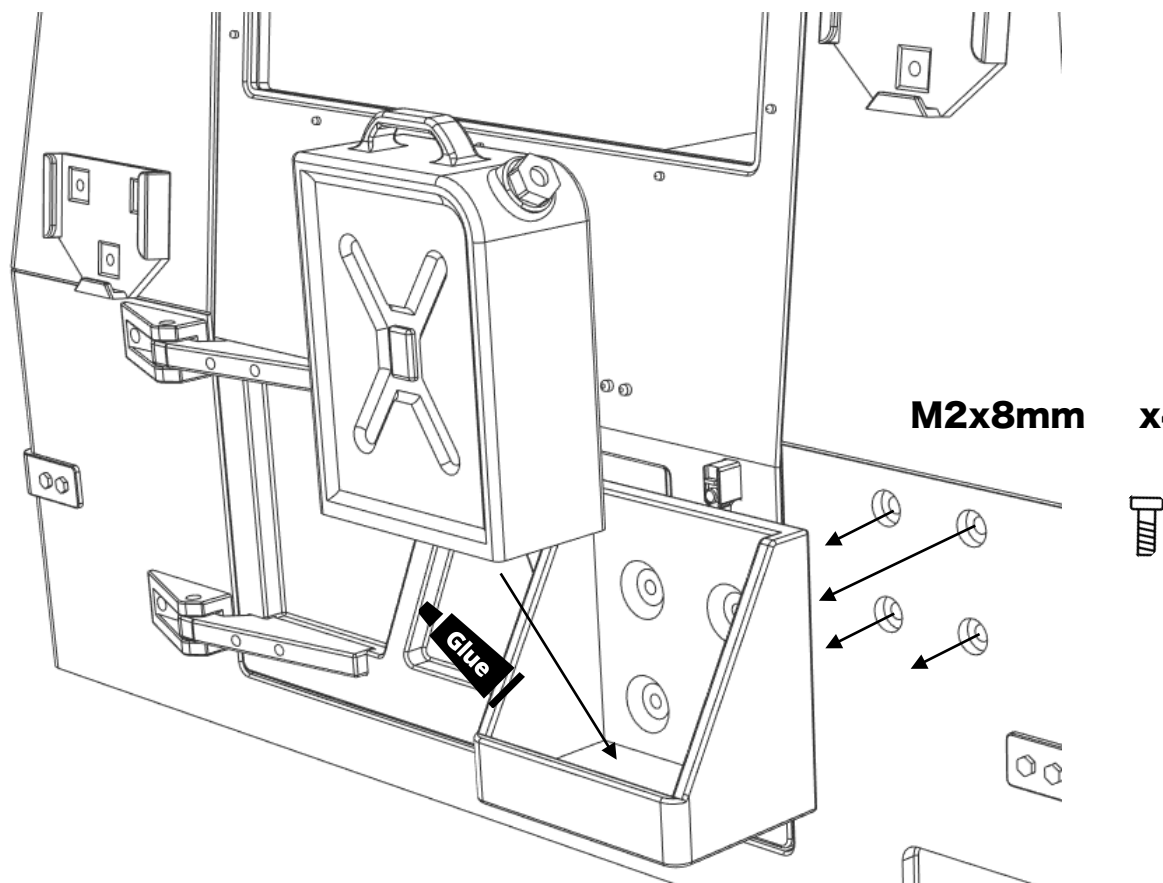

Assembling the roof hatch

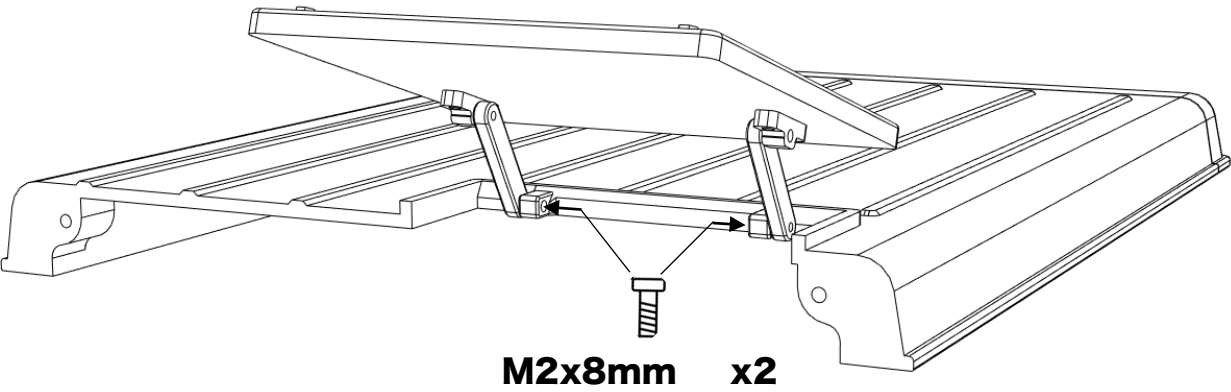
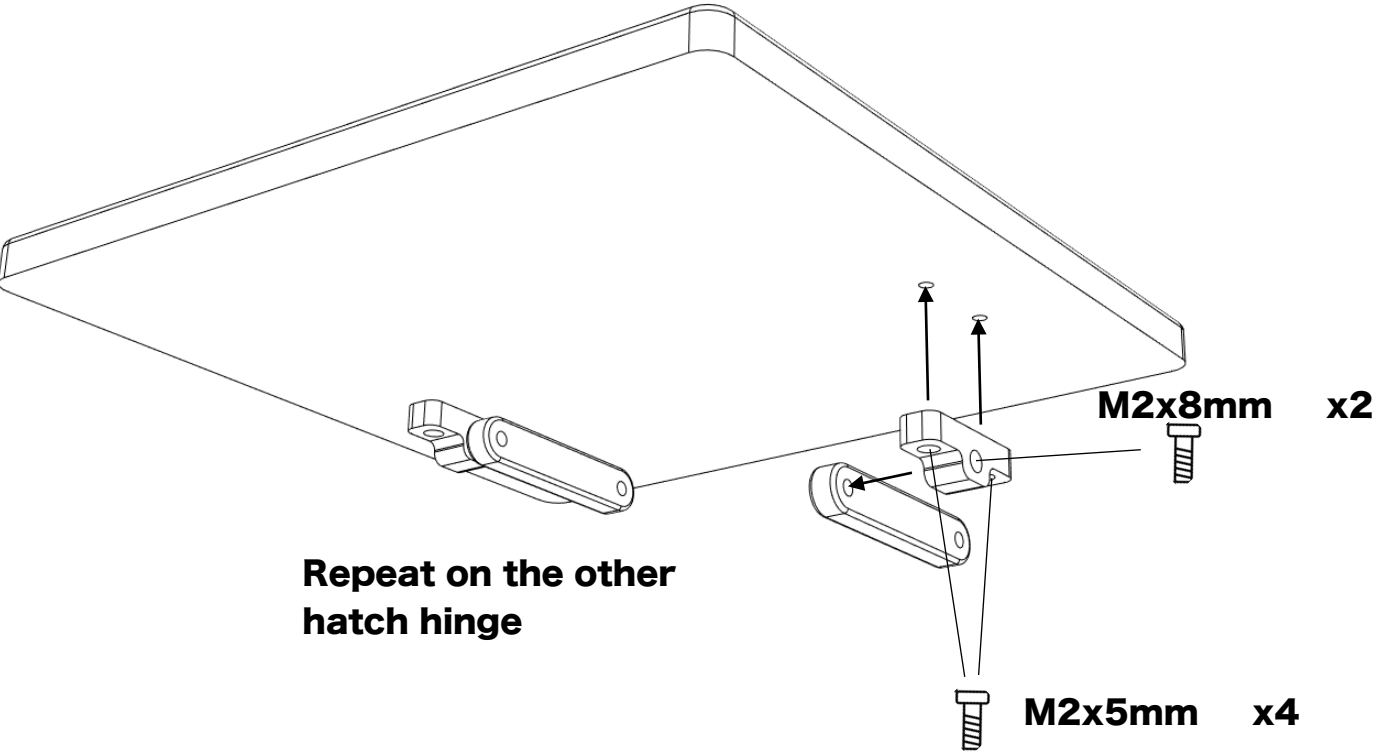

Assembling and installing the roof

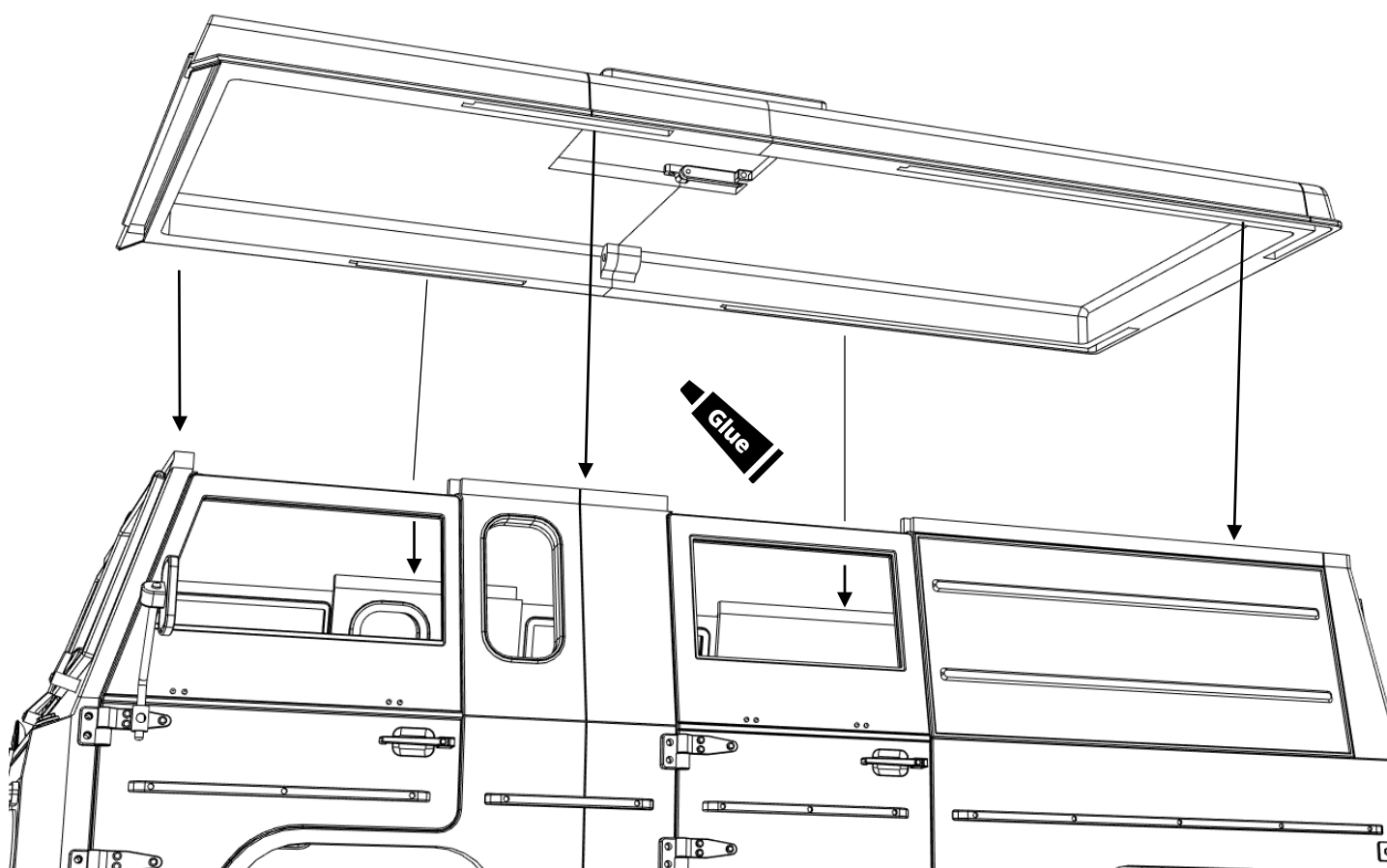
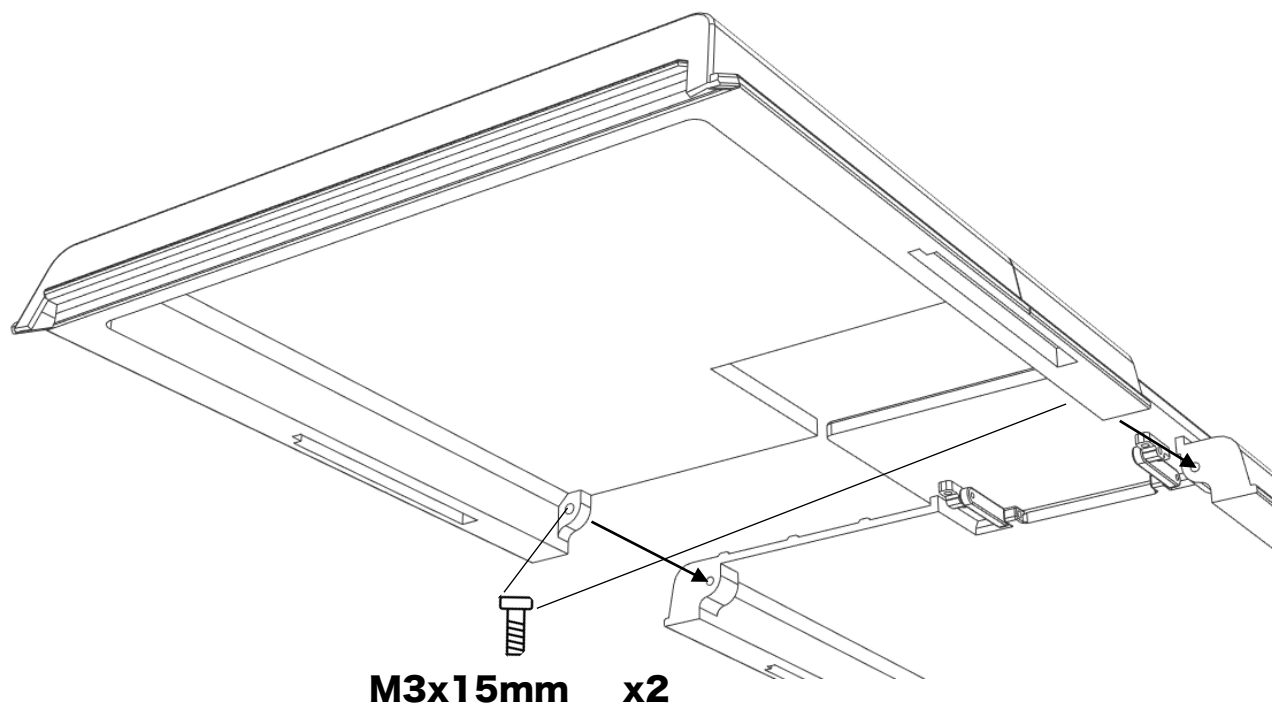

Installing the chassis mounts

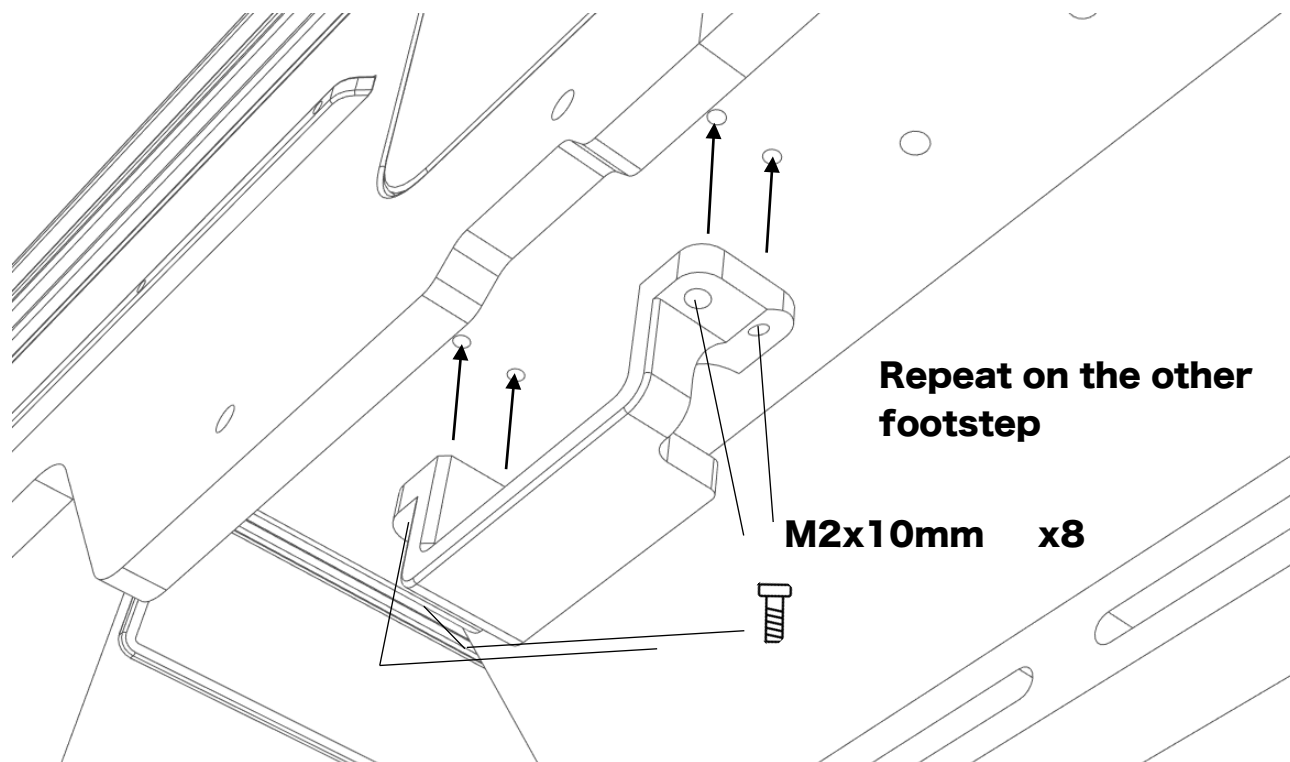
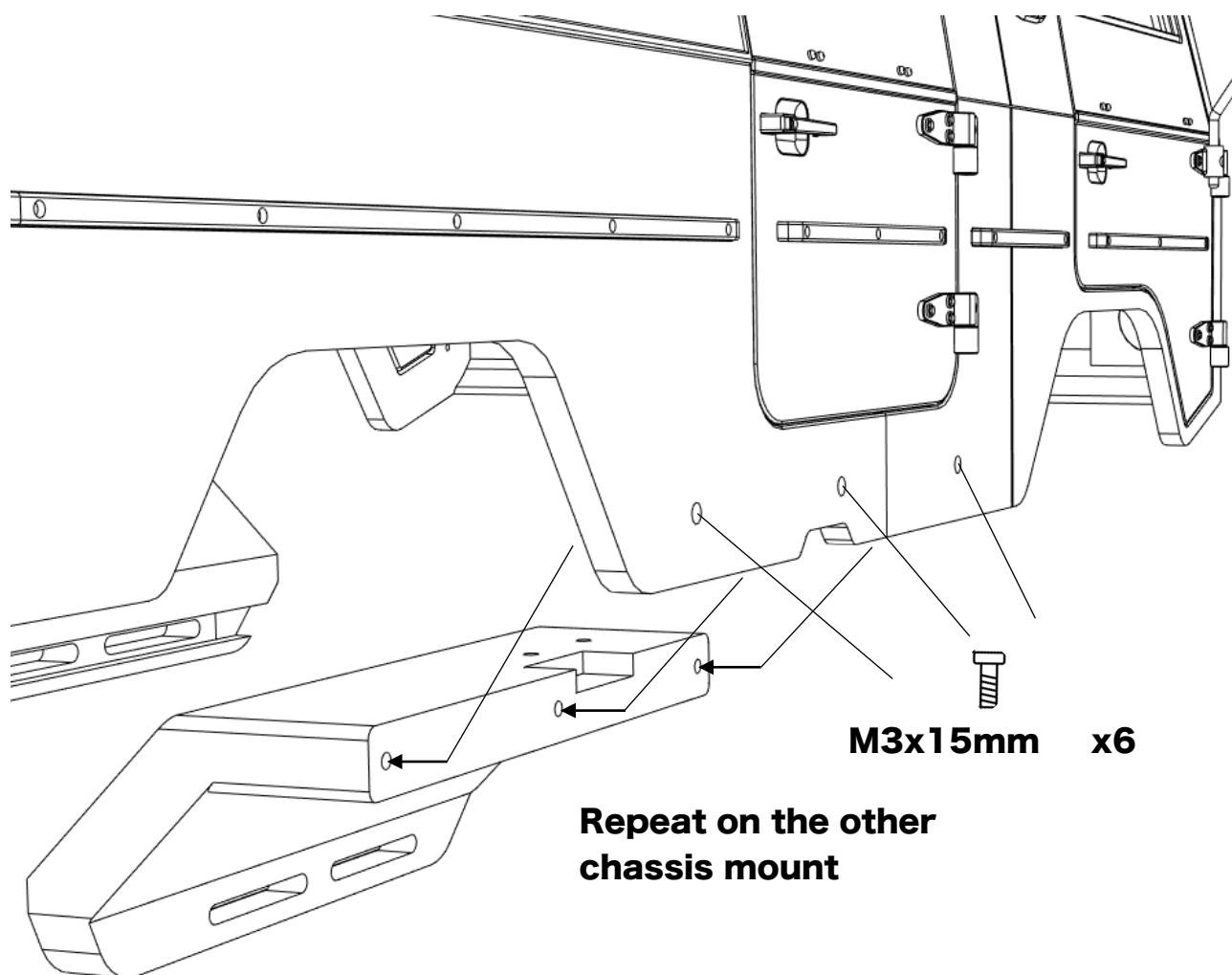

Assembling and installing the exhaust

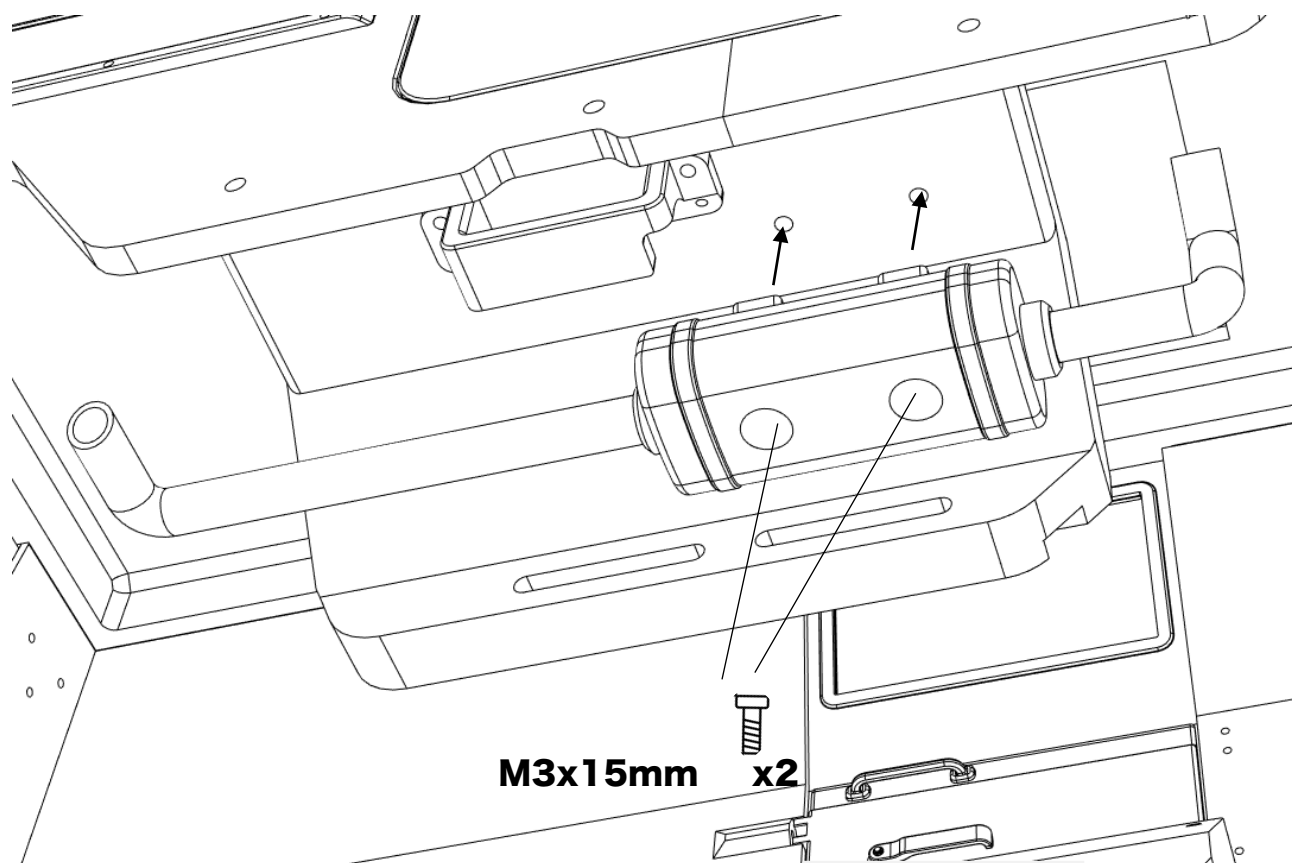
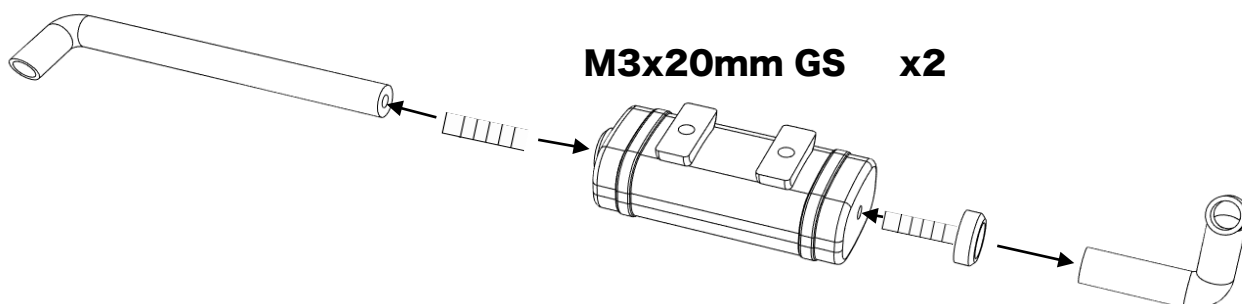

Assembling and installing the rear bumper

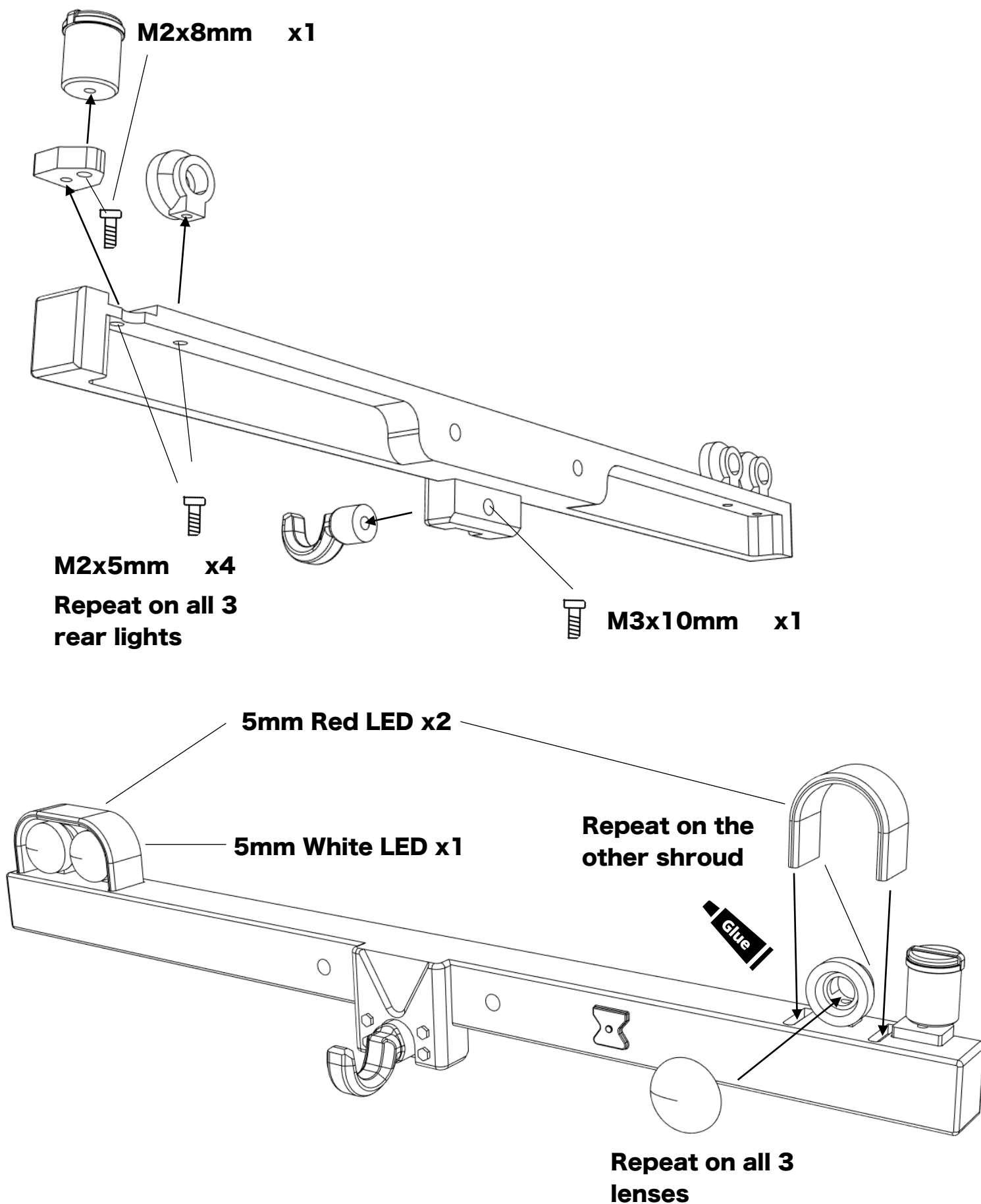

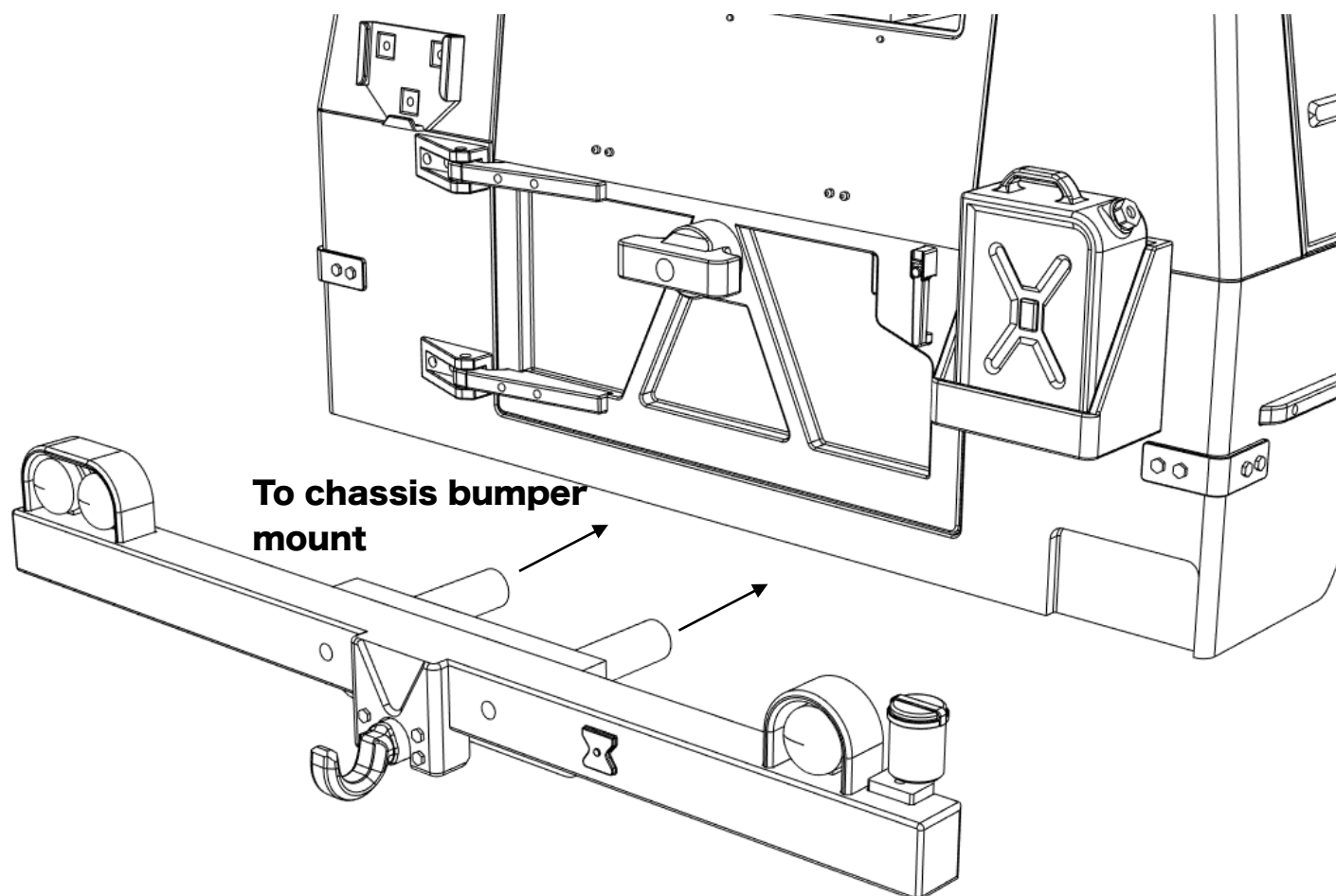
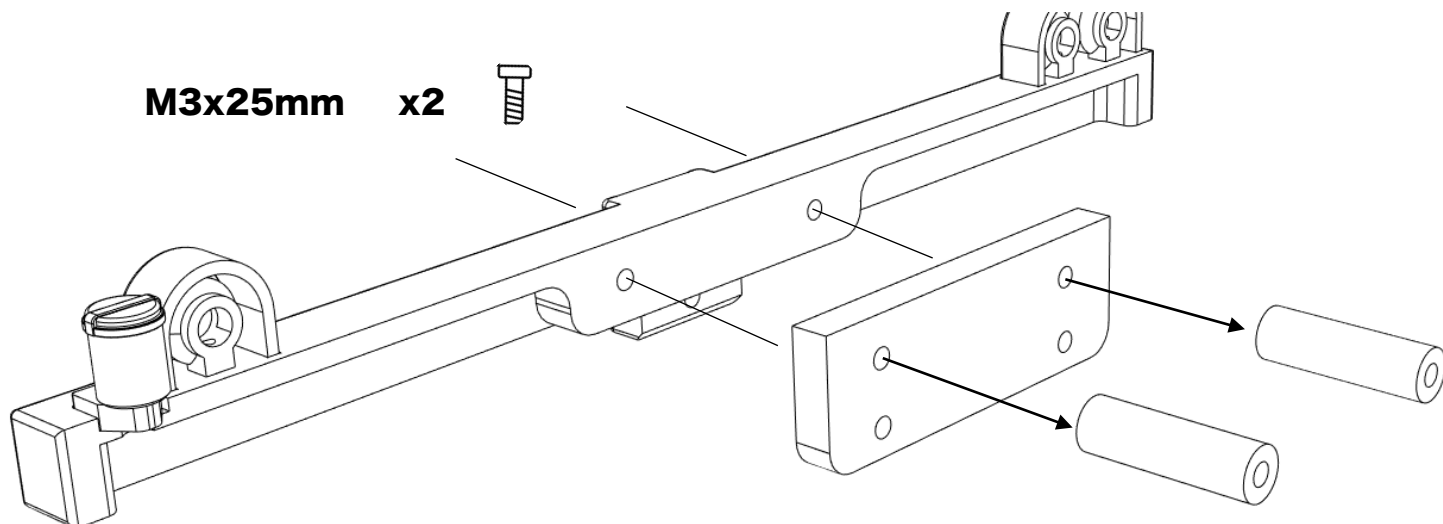

Assembling and installing the front bumper METHOD 1

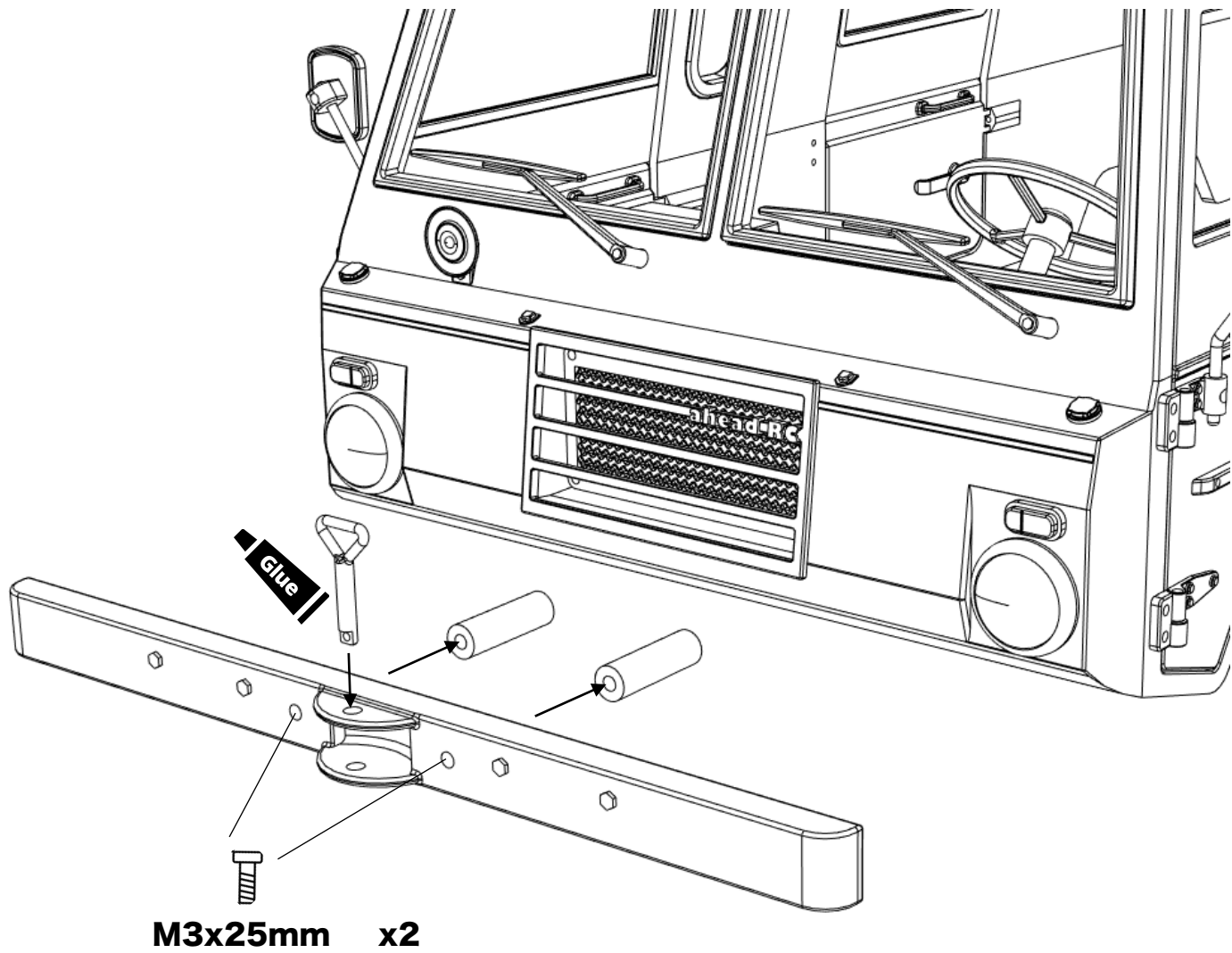

Assembling and installing the front bumper METHOD 2

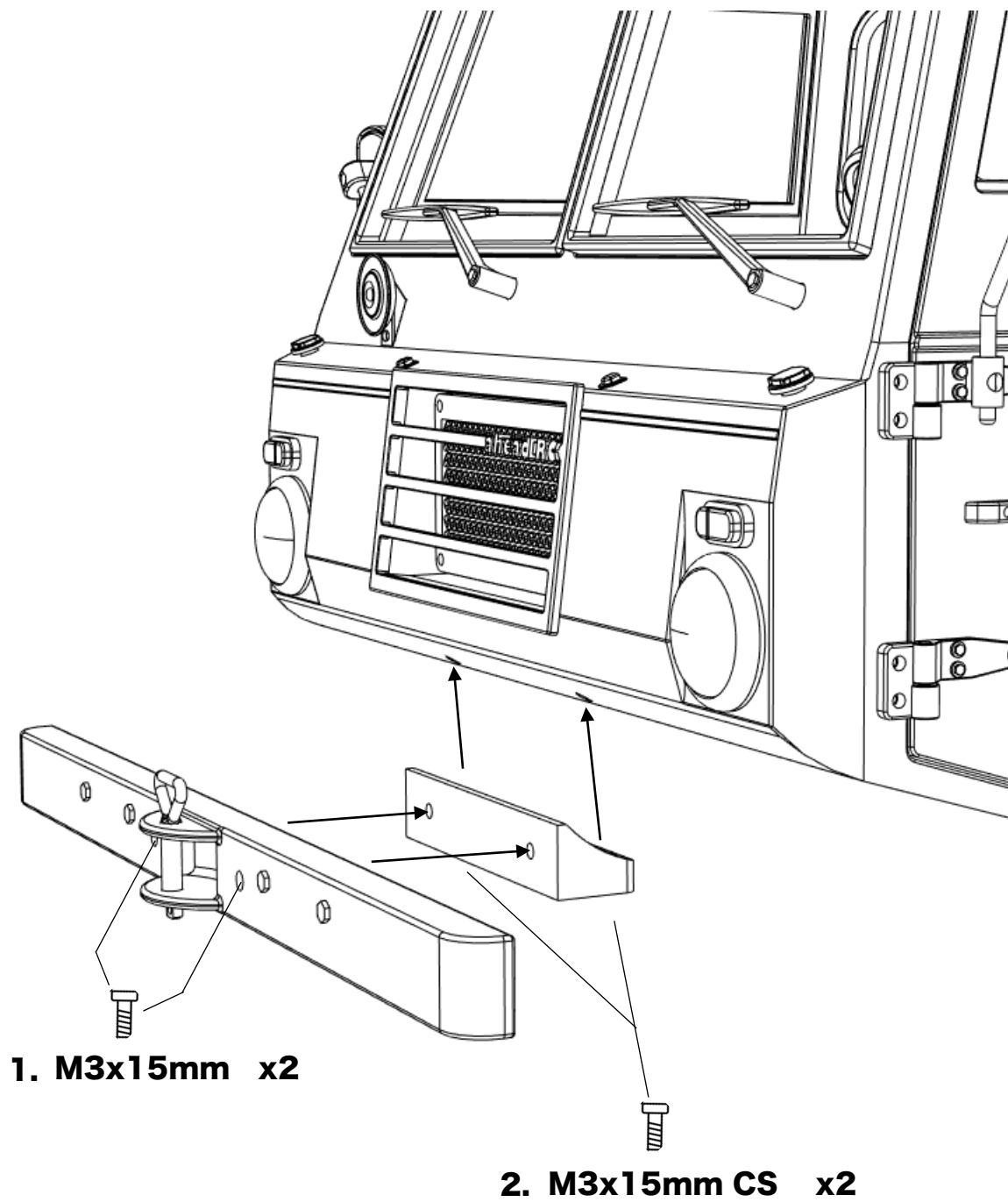

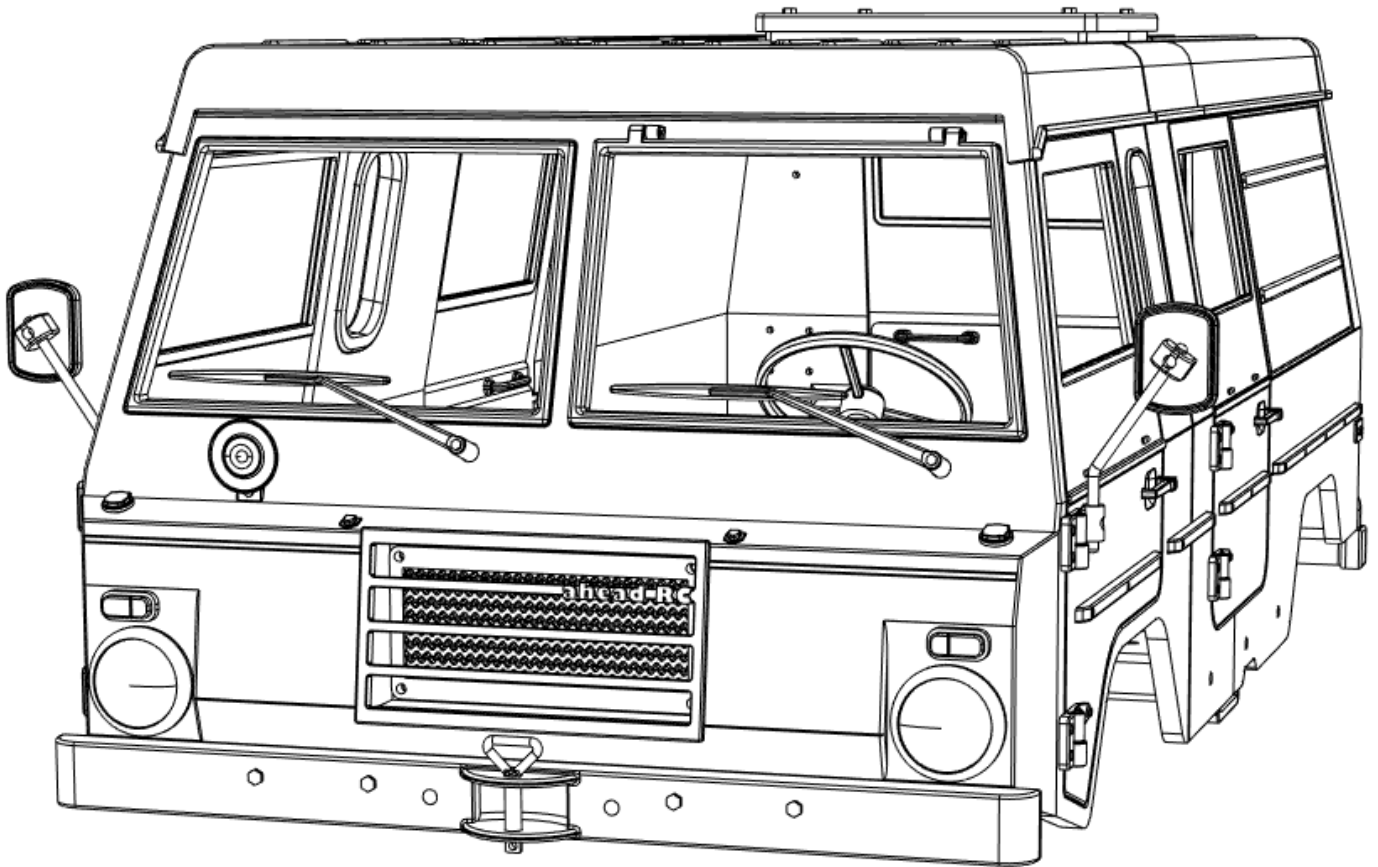

Body is now fully complete. Thank you for selecting ahead RC products.

If you have any questions or need help with the assembly, please do not hesitate to contact us at:

aheadrc@gmail.com

or visit us at:

www.aheadrc.com

Best of luck with your build!