

ahead RC Crawler

U452 Cab

Assembly Manual



Required tools and hardware

Tools

- 1.5mm Hex Driver
- 2.0mm Hex Driver
- 2.5mm Hex Driver
- Needle Nosed Pliers
- Instant Glue
- Hot Glue

Electronics

- 5mm LED White x2
- 3mm LED Orange x4

Hardware

Hardware	Quantity	Check
M2*5 Socket head	12	
M2*8 Socket head	14	
M2*10 Socket head	20	
M3*8 Socket head	6	
M3*10 Socket head	4	
M3*16 Socket head	2	
M3*5 Grub screw (GS)	1	
M3*10 Grub screw (GS)	4	
10x2mm Magnet	4	

Before you begin

- Be sure to read through the manual and familiarise yourself with the instructions
- Visualise a plan to assemble all the pieces
- Make sure you have all of the hardware and tools
- Be sure to have enough instant glue
- Dry fit all parts before painting and assembling

Tip: It will help to paint all of the parts before final assembly

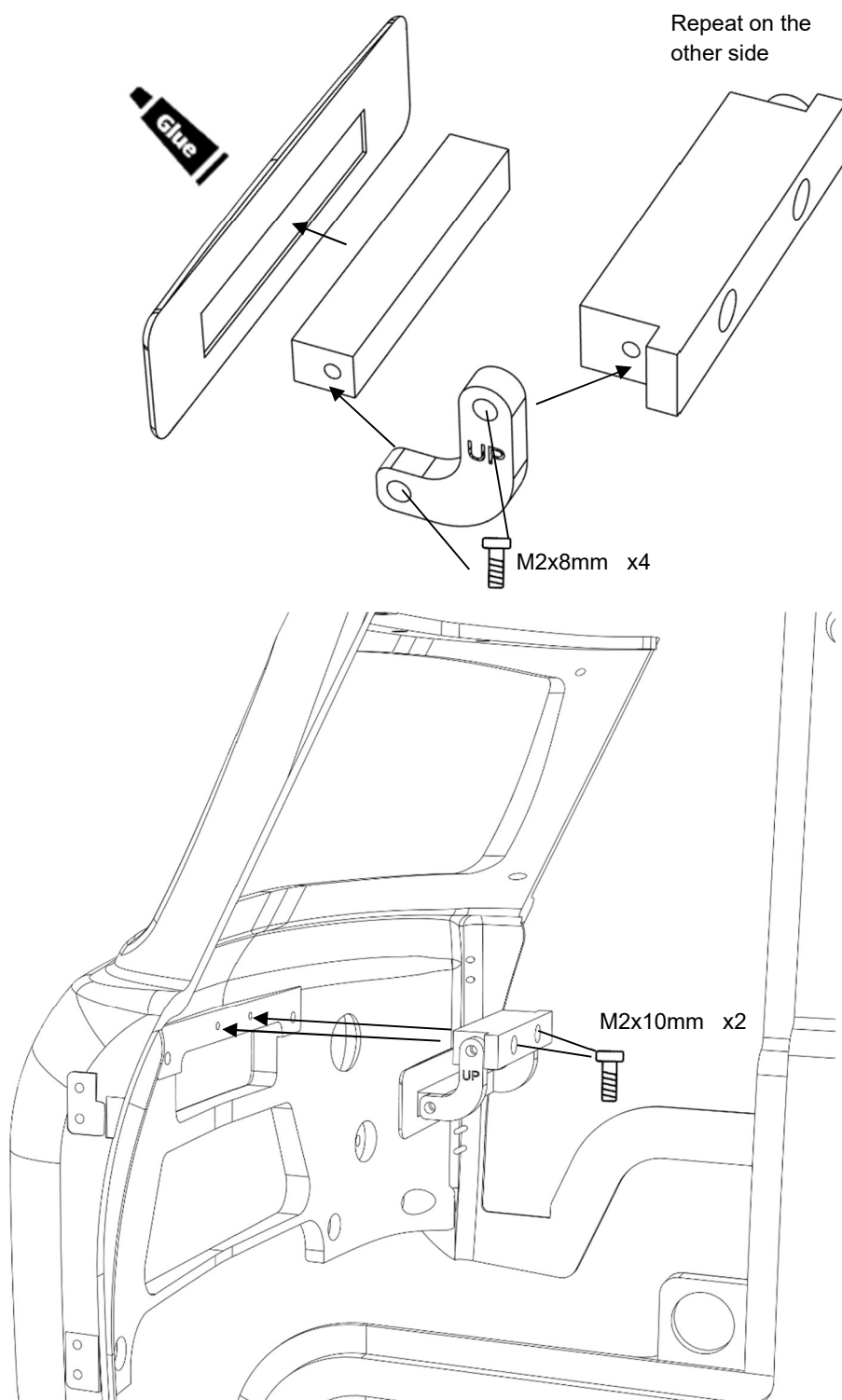

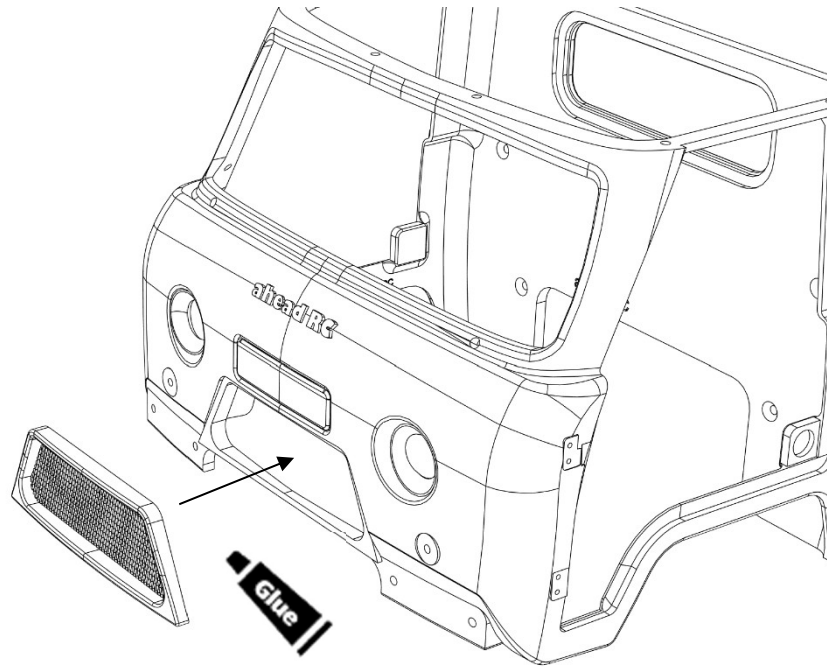

Bumper type 1

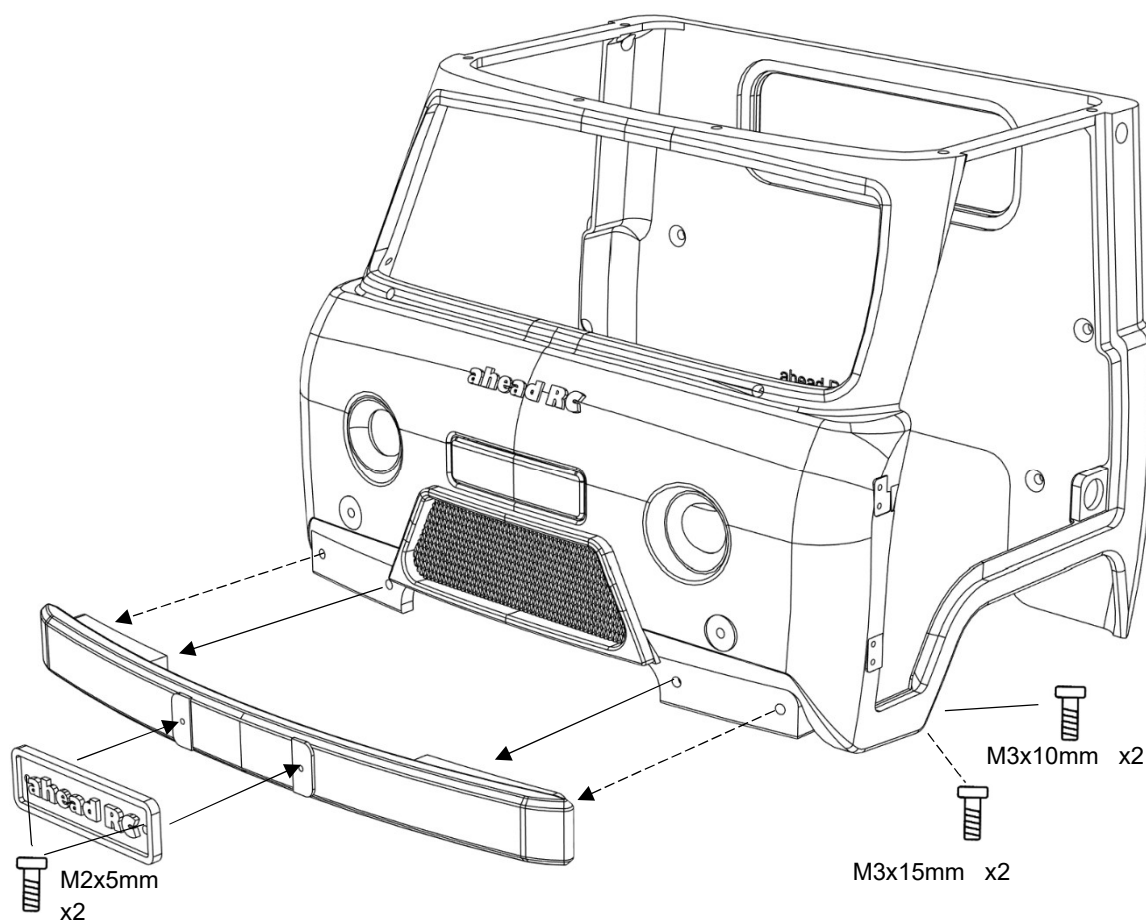

Bumper type 2

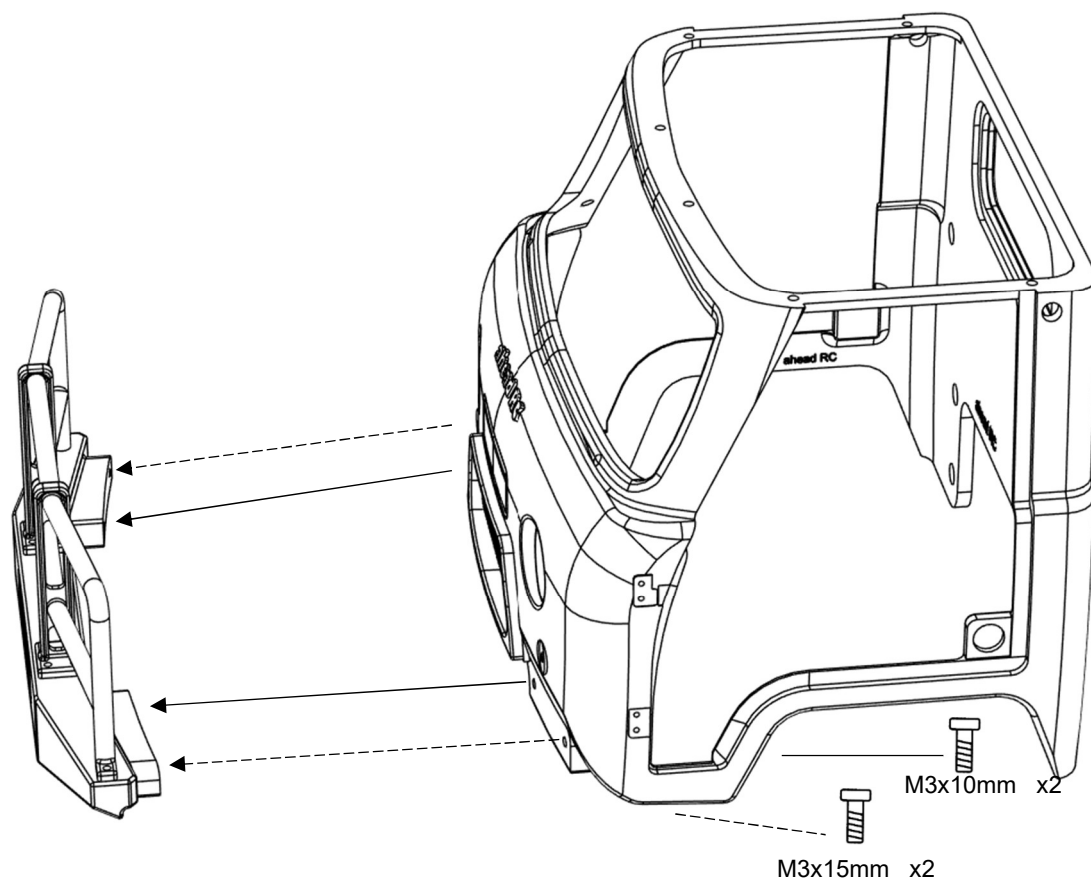
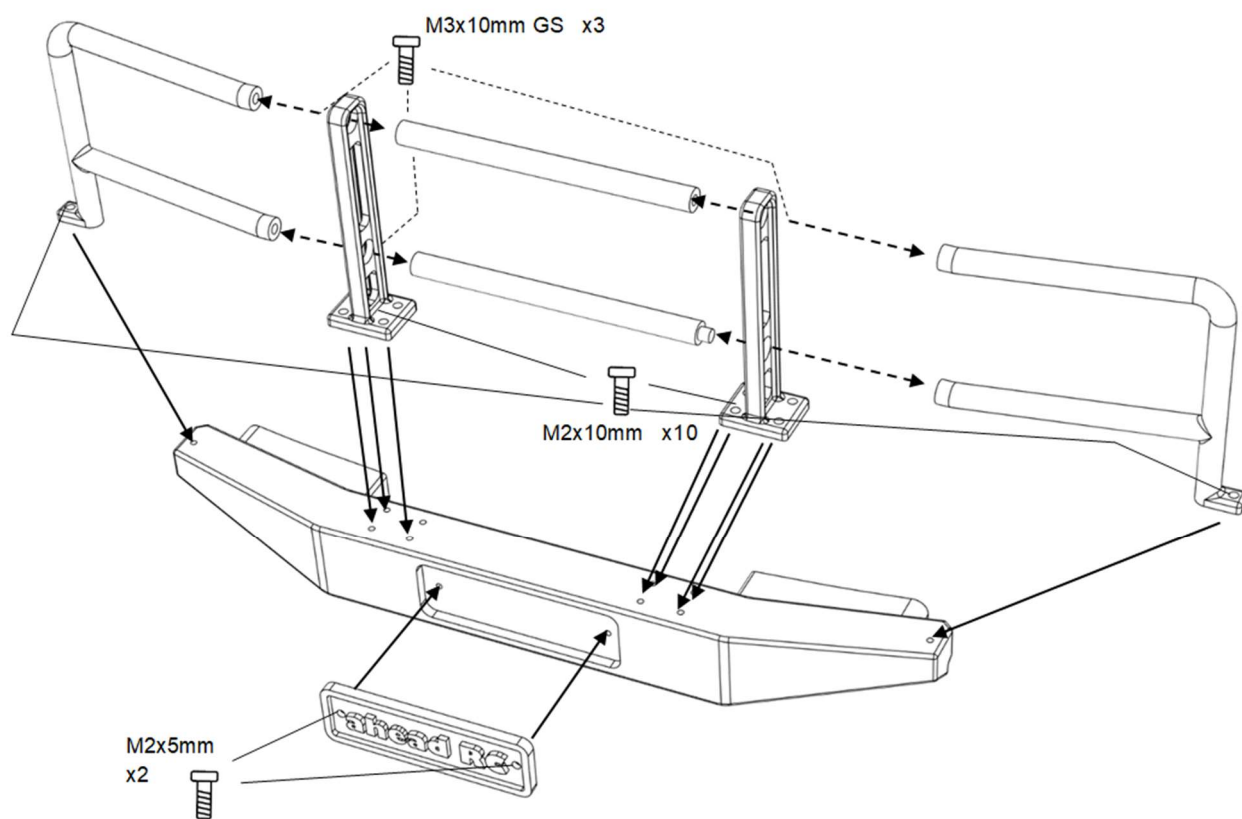

Bumper type 3

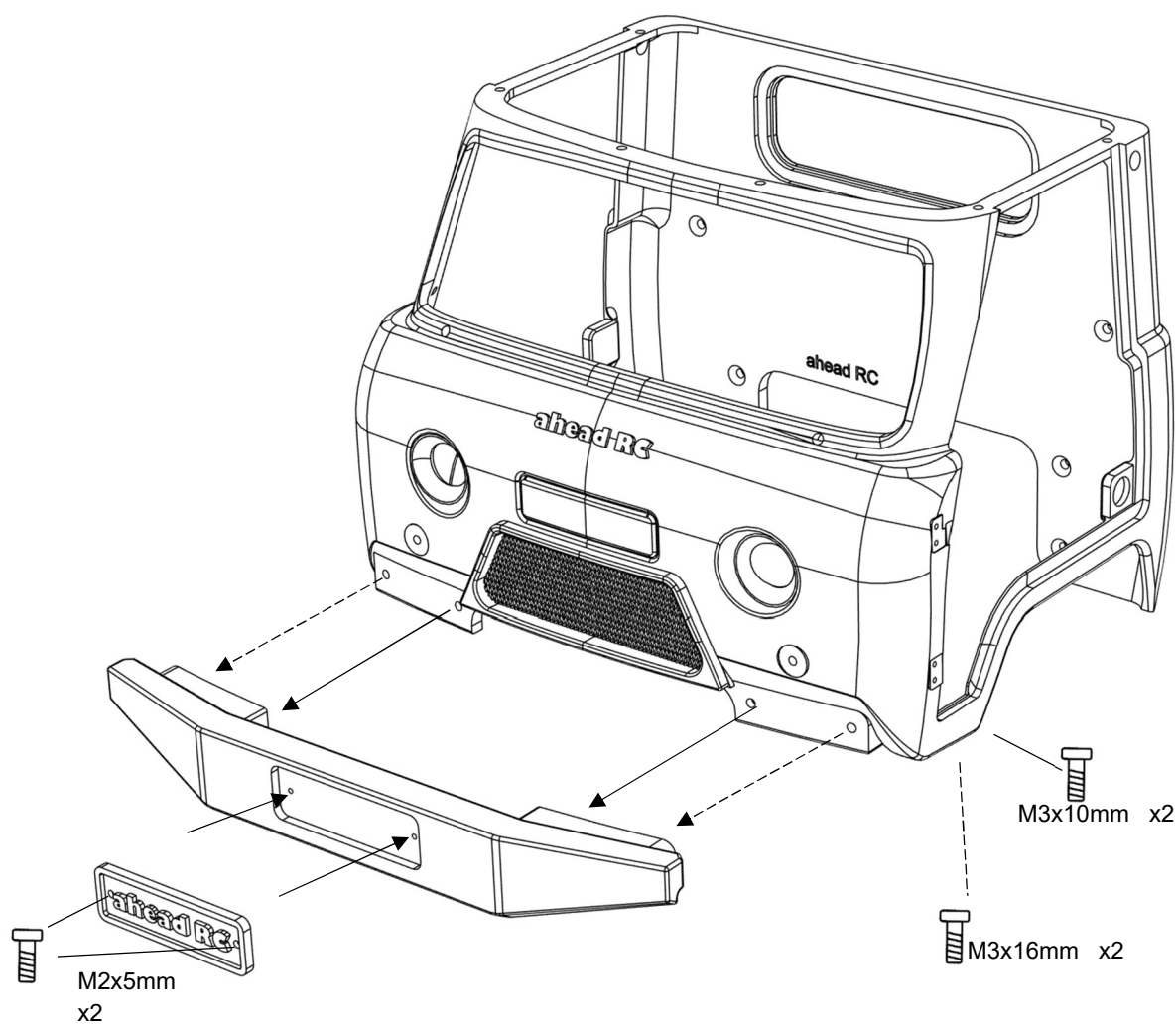

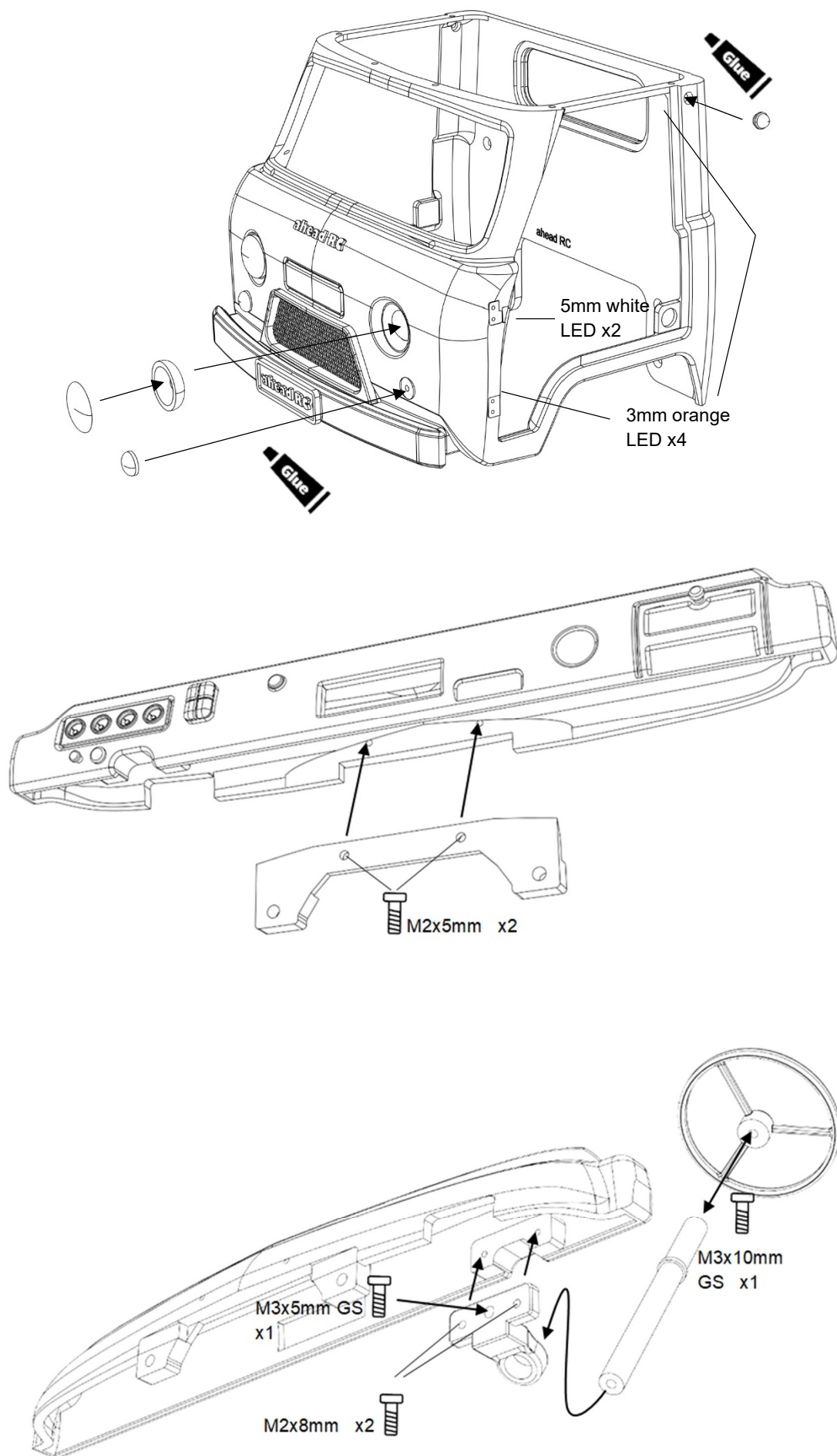

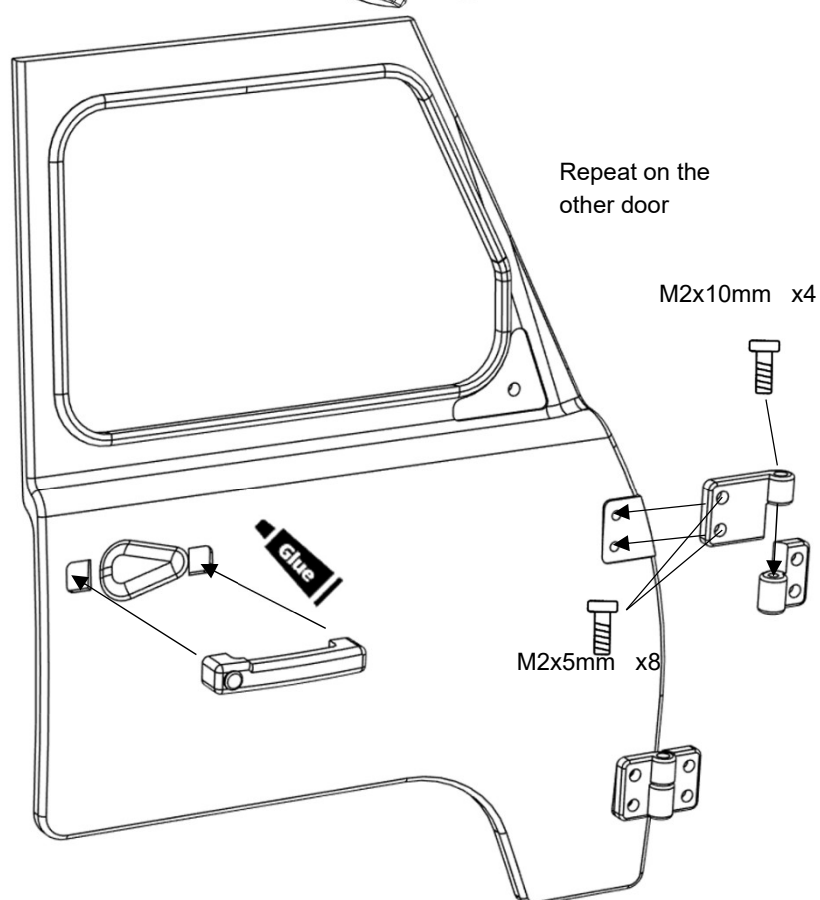
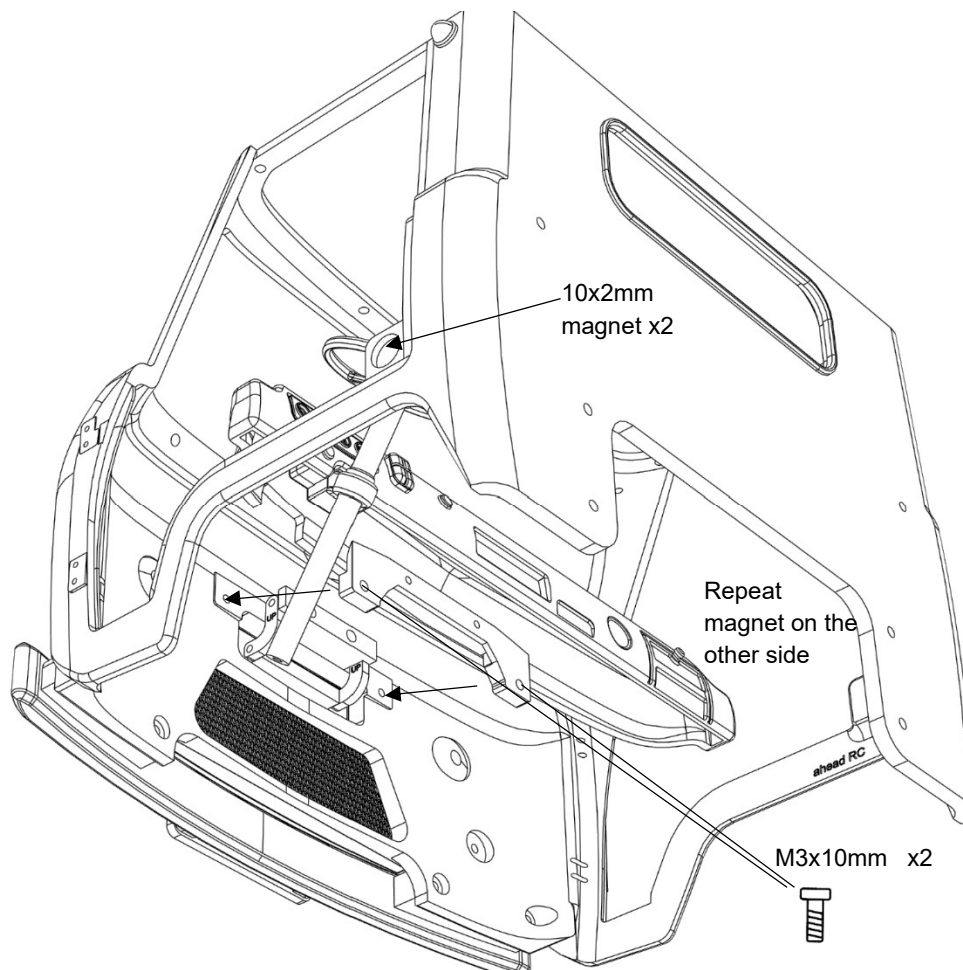

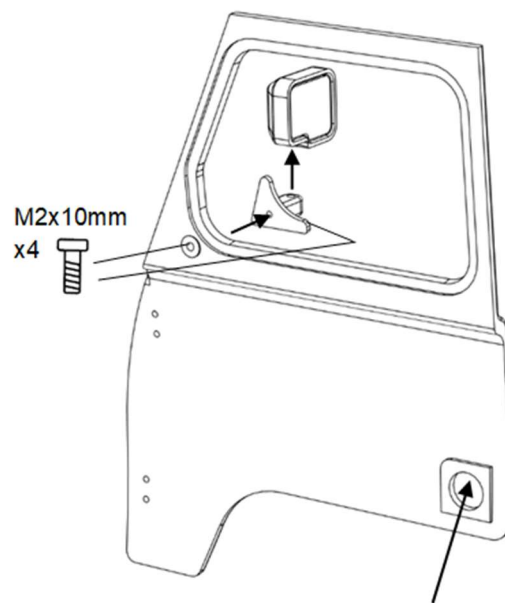

M2x10mm
x4

Repeat on the
other door

10x2mm
magnet x2

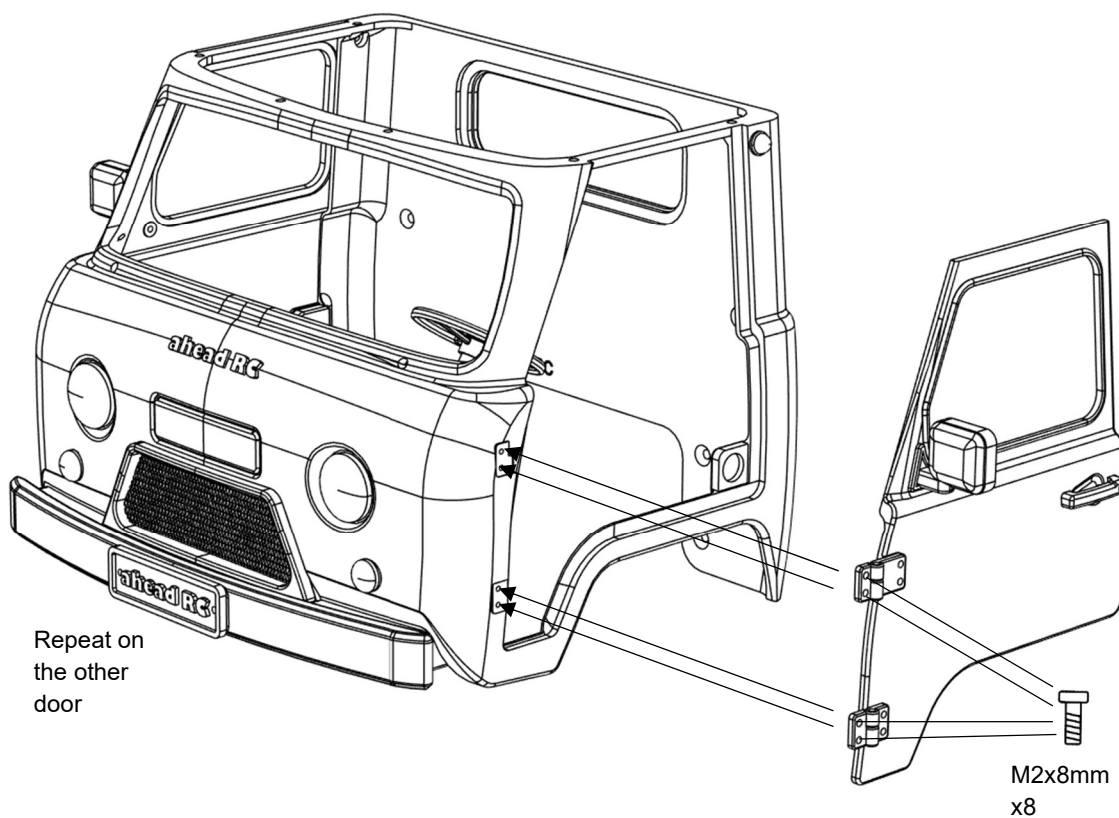

Repeat on
the other
door

M2x8mm
x8

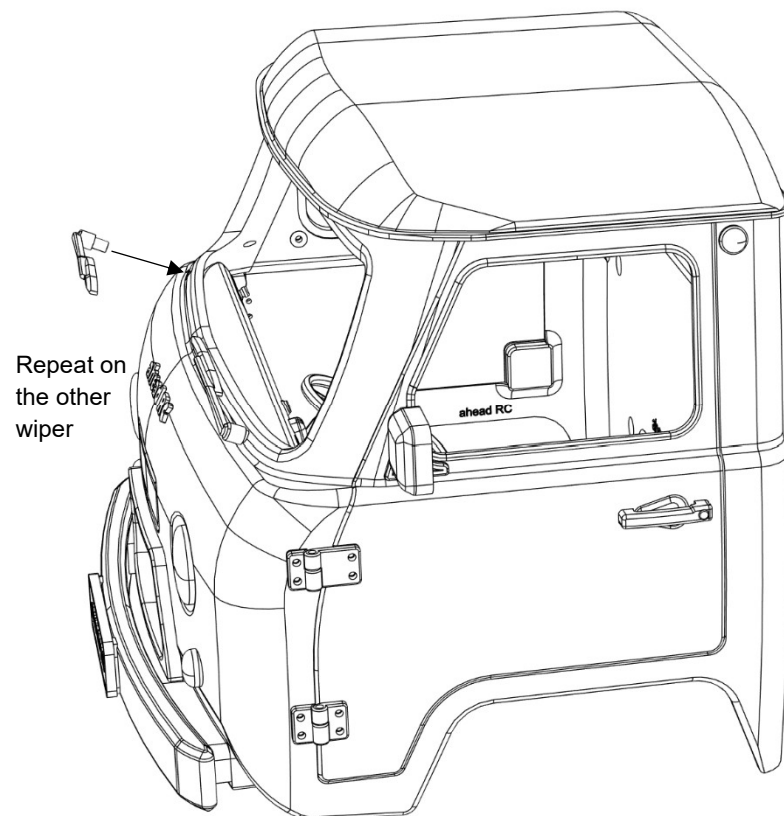
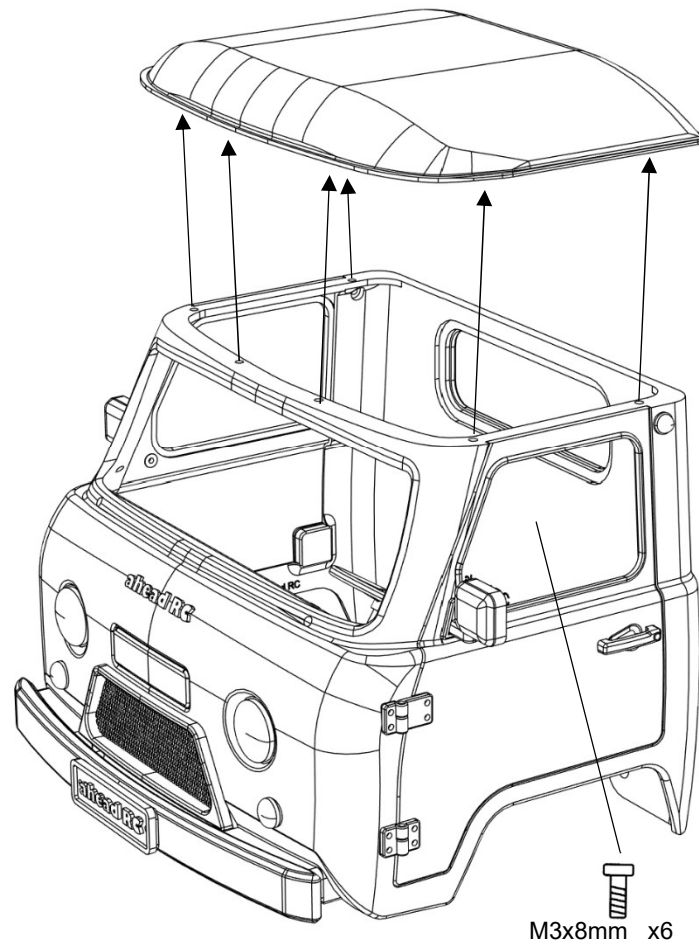



Body is now fully complete. Thank you for selecting ahead RC products.

If you have any questions or need help with the assembly, please do not hesitate to contact us at:

aheadrc@gmail.com

or visit us at:

www.aheadrc.com