

ahead RC Crawler 4320 Dual Cab Assembly Manual



Required tools and hardware

Tools

- 1.5mm Hex Driver
- 2.0mm Hex Driver
- 2.5mm Hex Driver
- 2.5mm Drill Bit
- Drill / handheld chuck
- Needle Nosed Pliers
- Instant Glue

Electronics

- 5mm White LED x4
- 3mm Orange LED x7

Hardware

Hardware	Quantity	Check ✓
M2x5 Socket Head Cap Screw	22	
M2x10 Socket Head Cap Screw	28	
M2x15 Socket Head Cap Screw	2	
M2x20 Socket Head Cap Screw	8	
M3x20mm Grub Screw	1	
M3x 15mm Countersunk Screw	4	
M3x20 Socket Head Cap Screw	2	
M3 Lock nuts	4	
Small hinges (Optional)	10	

Before you begin

- Be sure to read through the manual and familiarise yourself with the instructions
- Visualise a plan to assemble all the pieces
- Make sure you have all of the hardware and tools
- Be sure to have enough instant glue
- Dry fit all parts before painting and assembling

Tip: It will help to paint all of the parts before final assembly

Split cab assembly

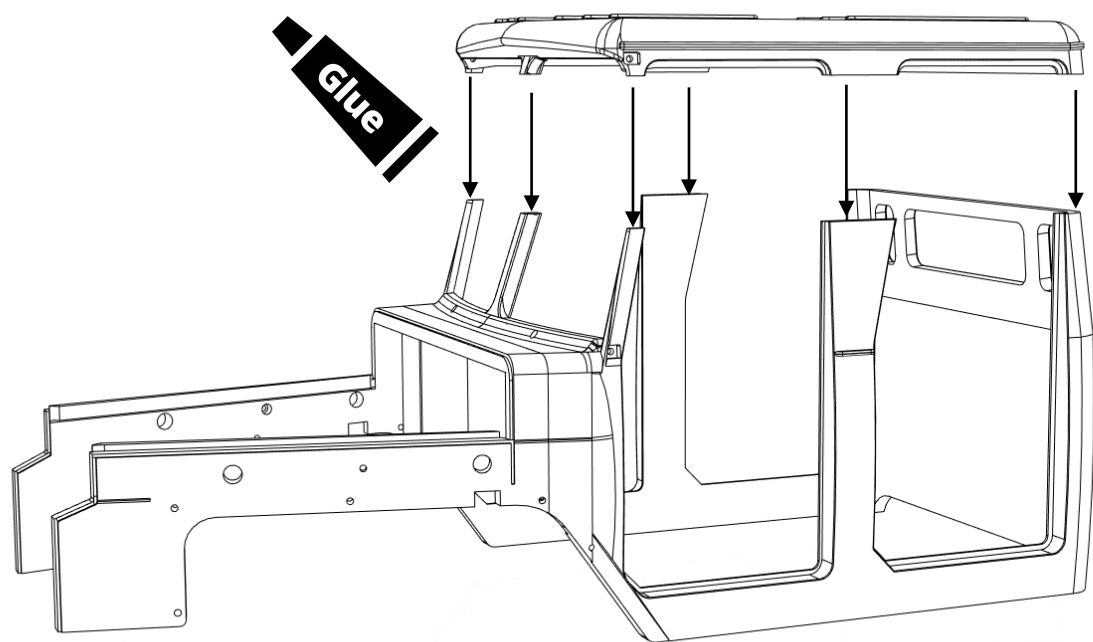
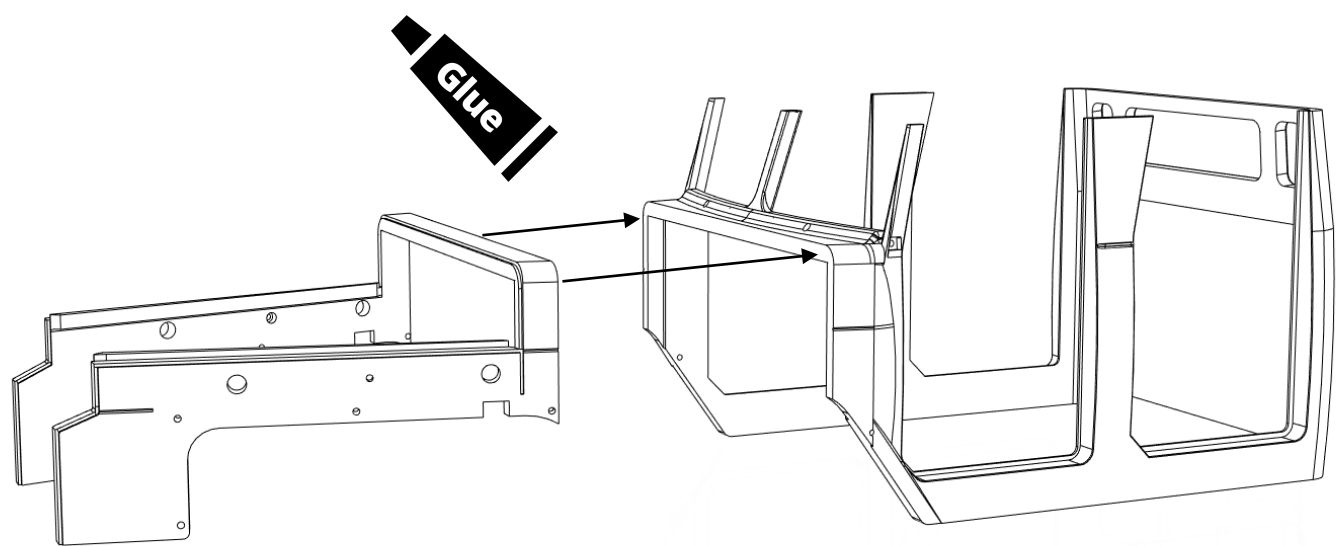

Mounting the mirrors

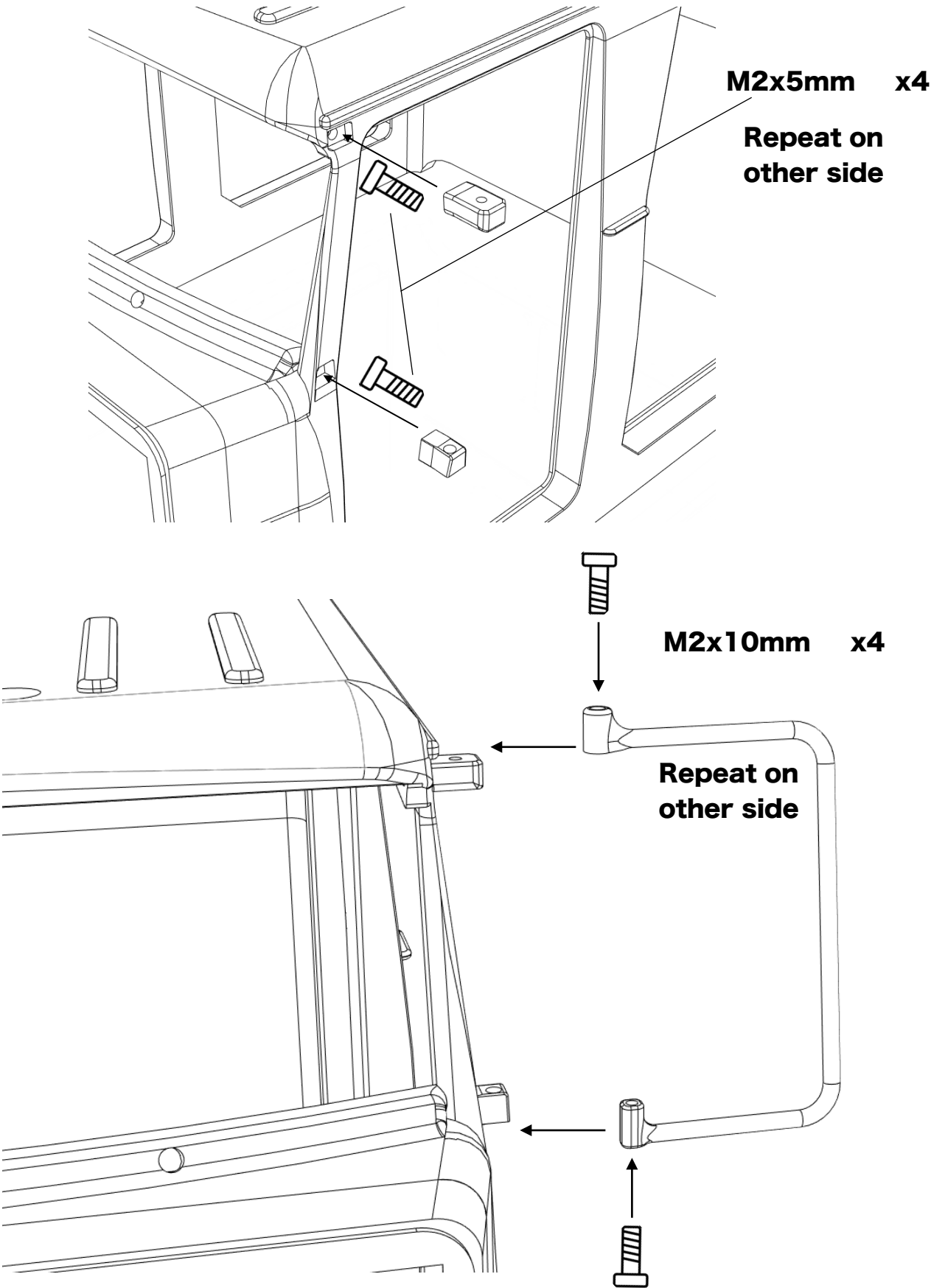

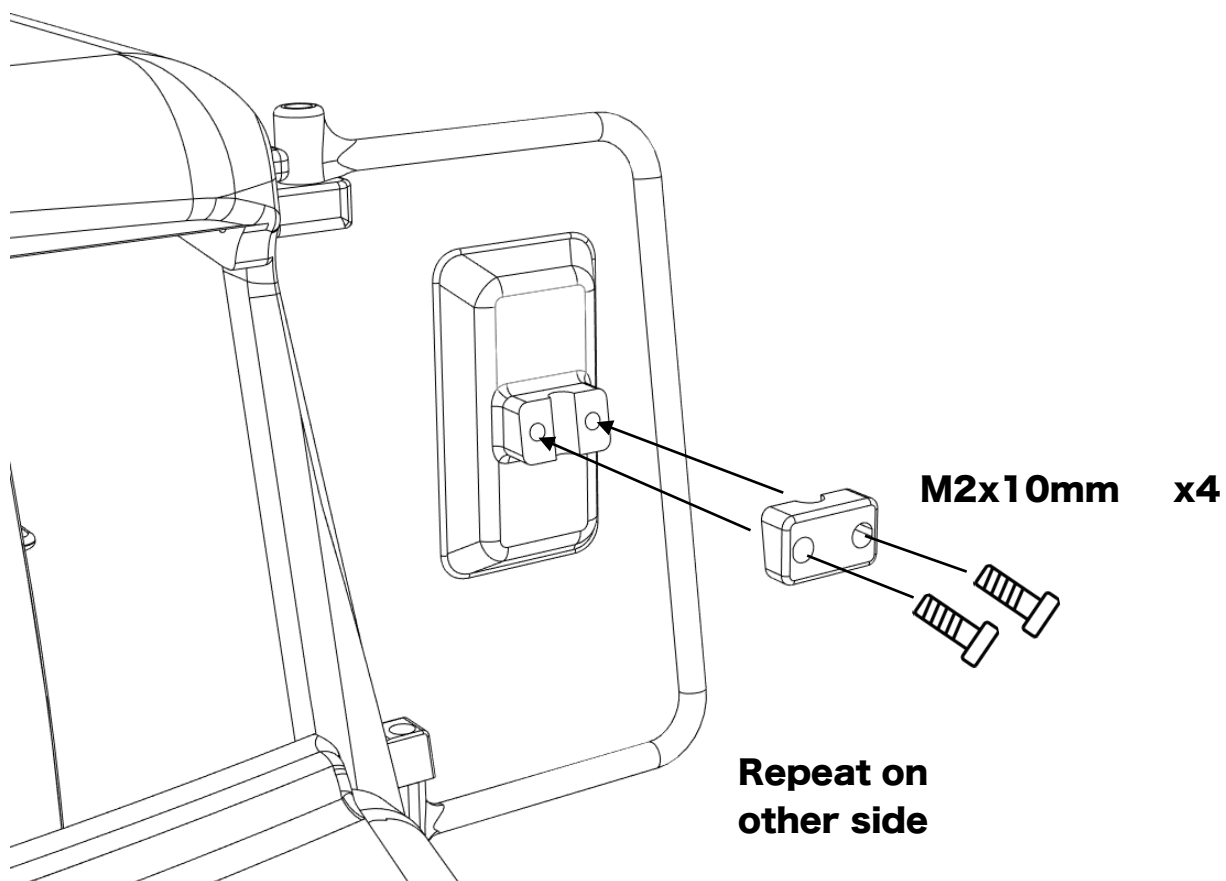

Grille and radiator assembly

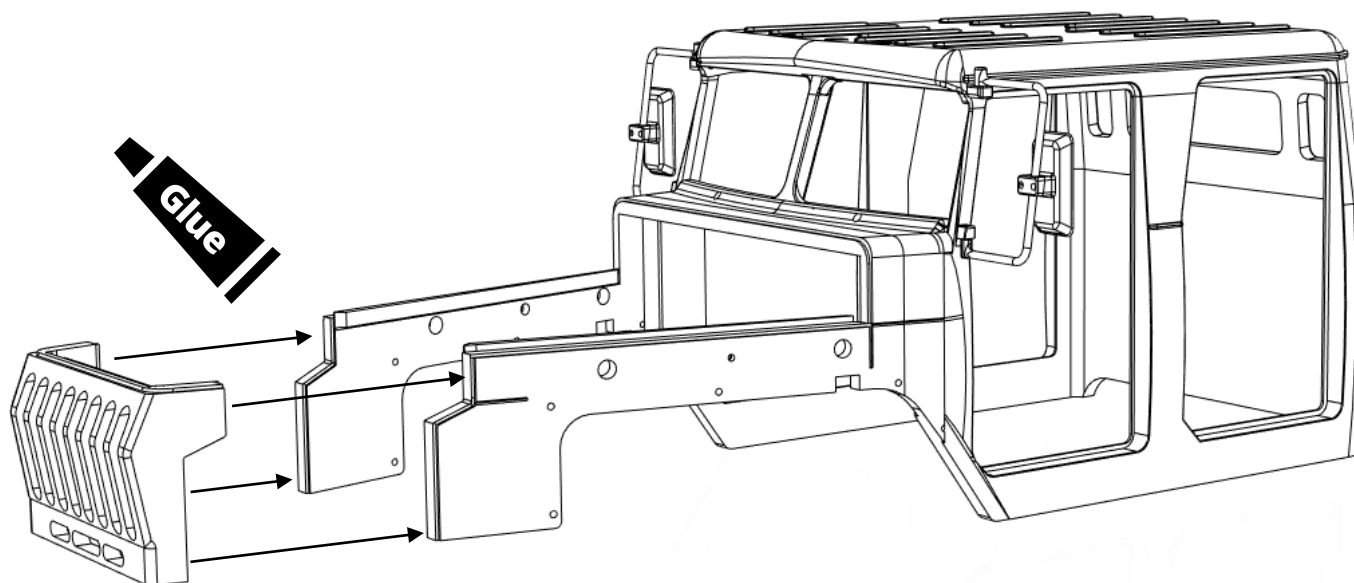
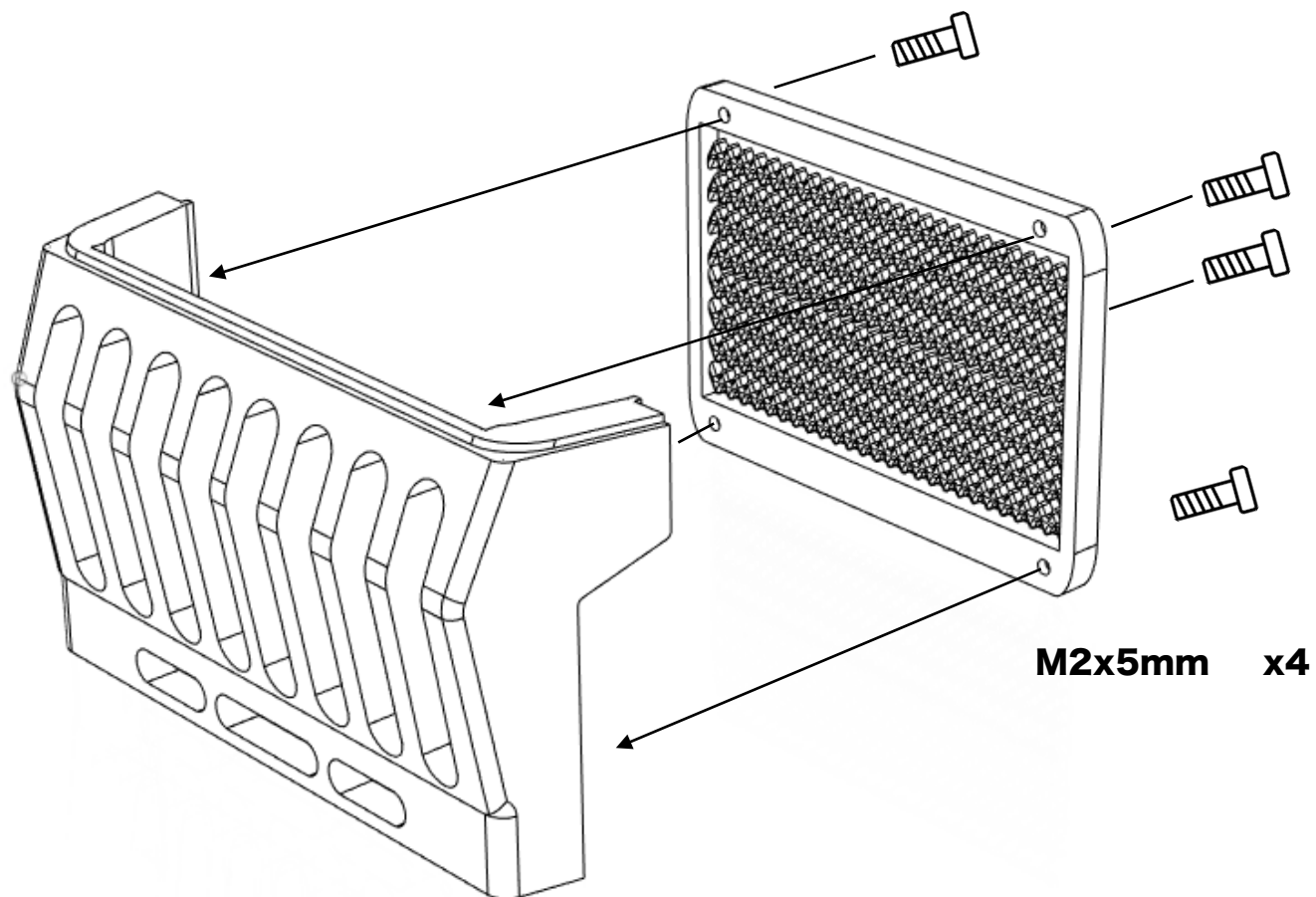

Door assembly

M2x10mm x8

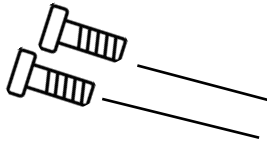

Repeat for all 4 doors

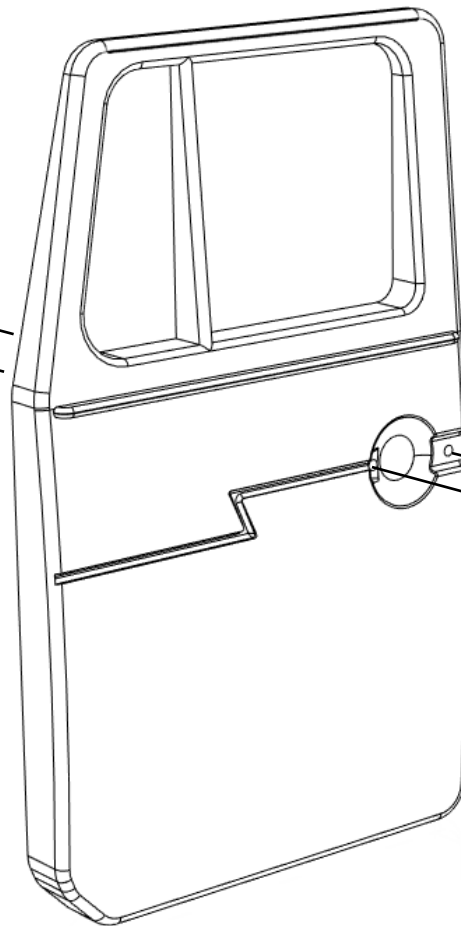

Take note of direction

Secure door using hinges or instant glue

**Hinges not included*

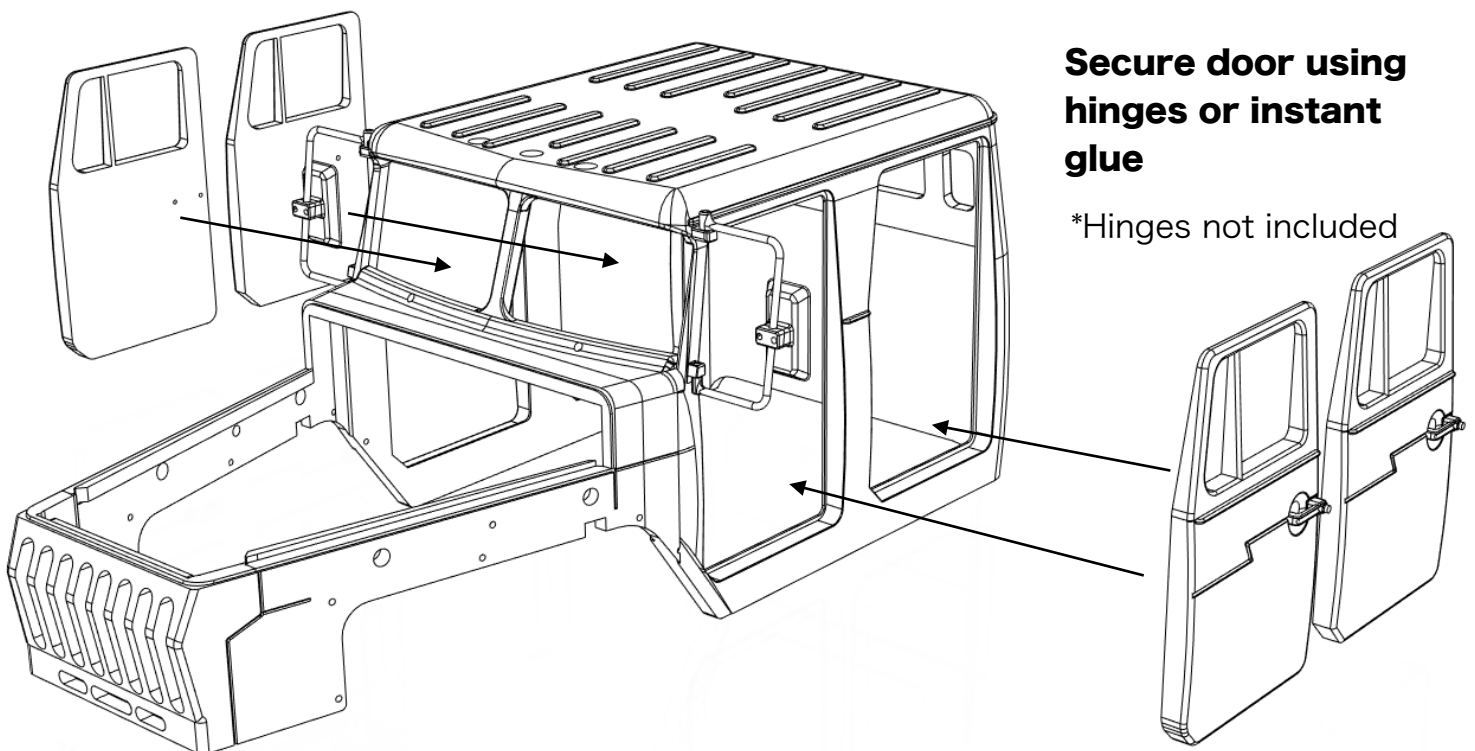

Fender assembly (Use LED fender version if using LEDs for fender top lights)

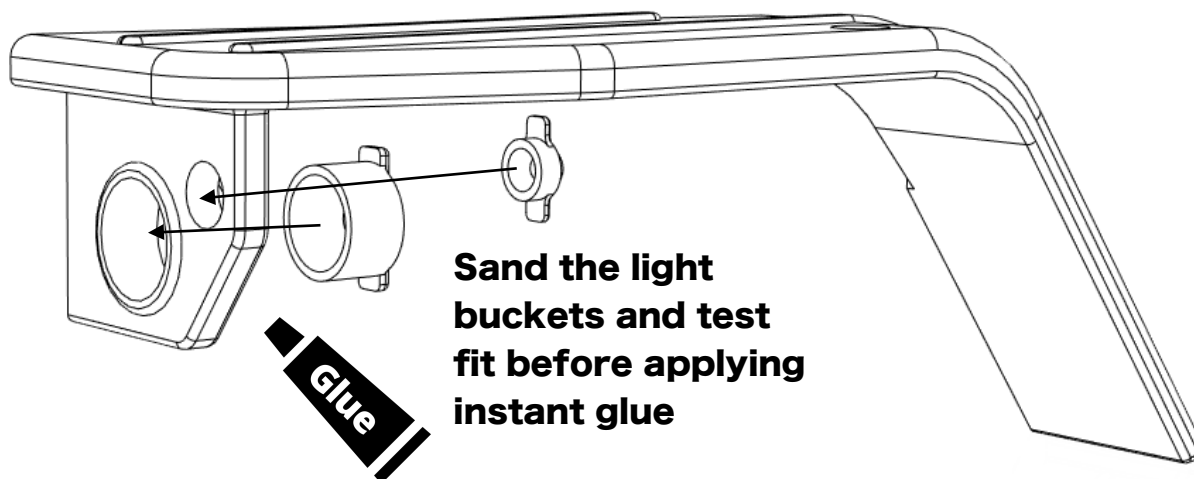

Repeat on the other fender

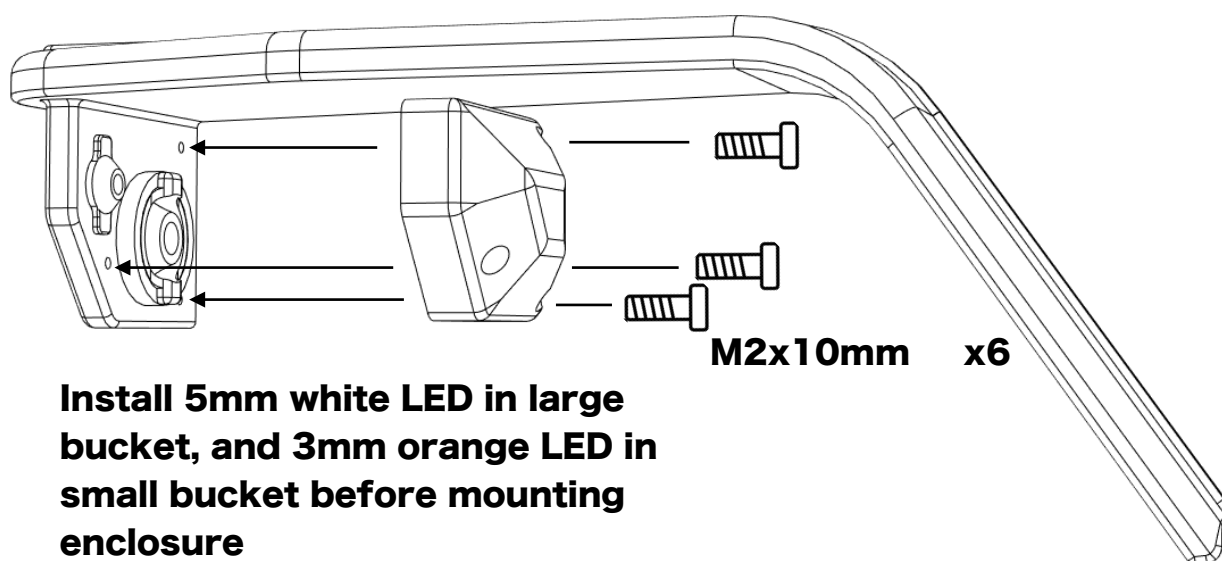

Repeat on the other fender

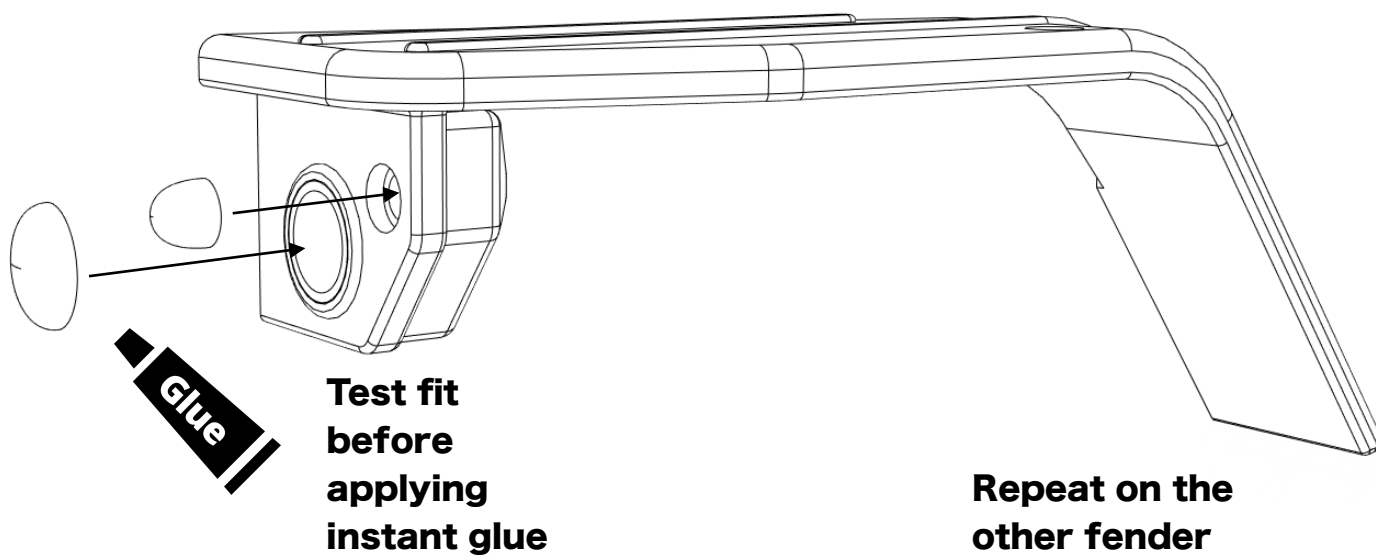

If you plan to use the included magnetic body mounts, please complete the next step first

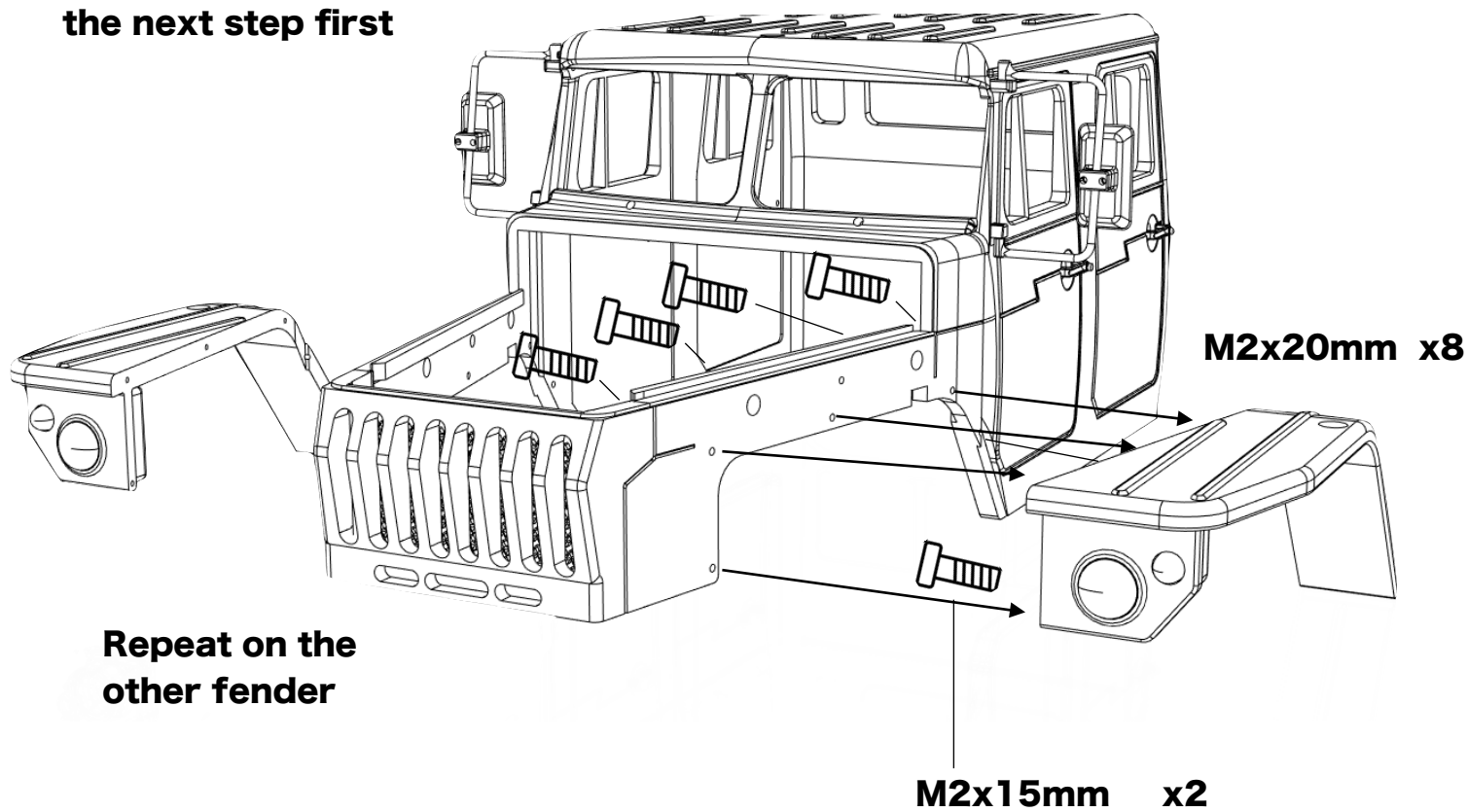

Body mounts (Optional)

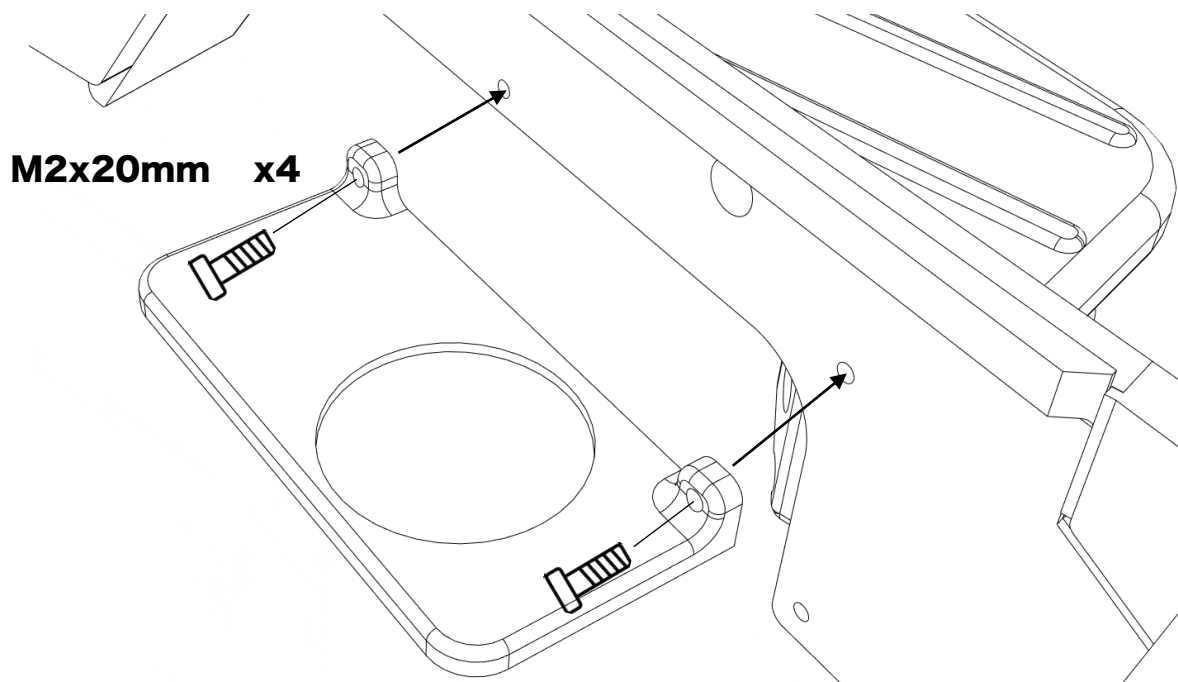

Install magnets here using instant glue. Maximum diameter = 25mm

Repeat on the other magnet mount

Take note of magnet polarity

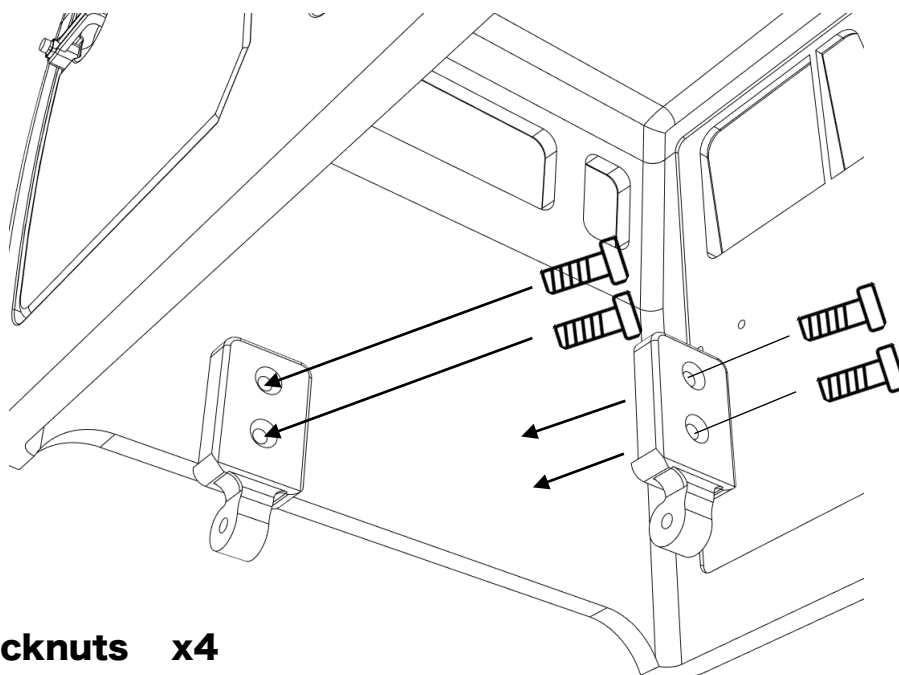

M3 Locknuts x4

**M3x20mm
Countersunk x4**

Cab side panels

Left

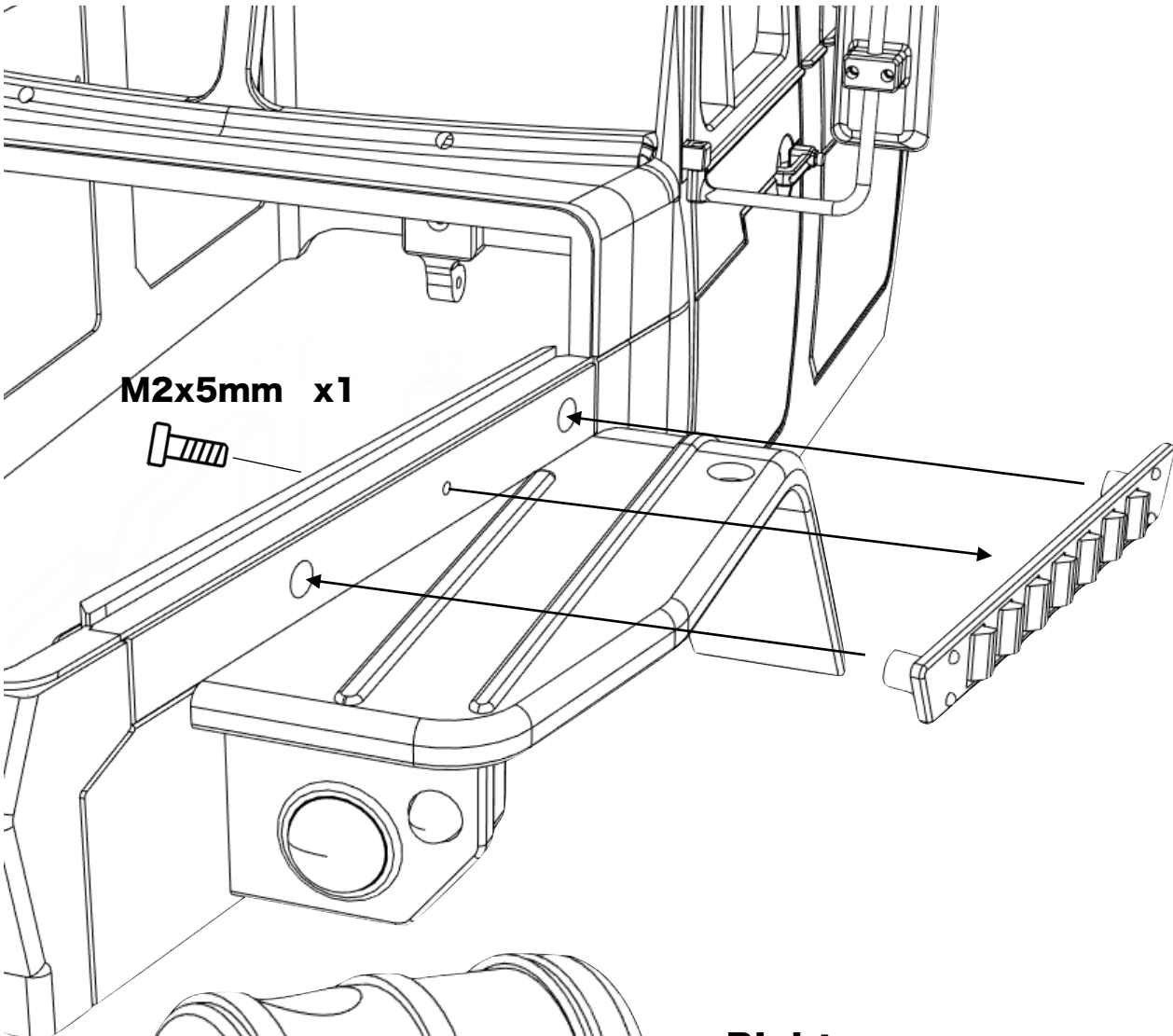

Right

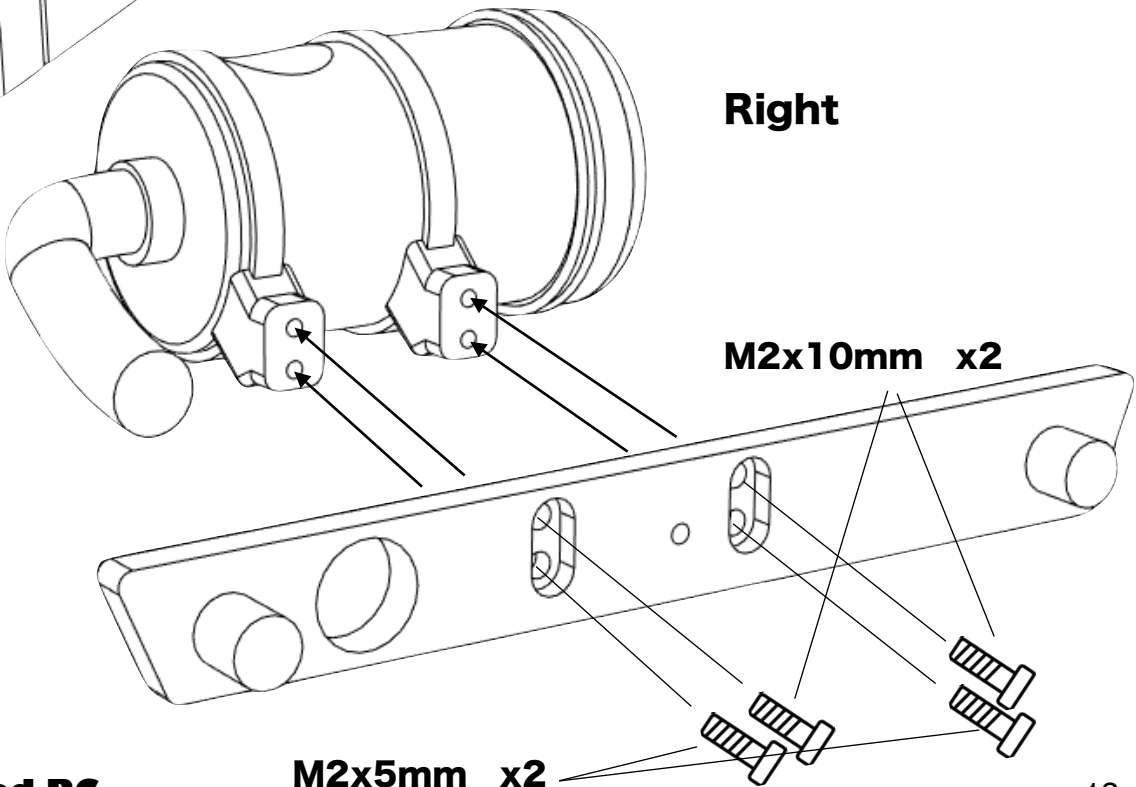

Air filter assembly

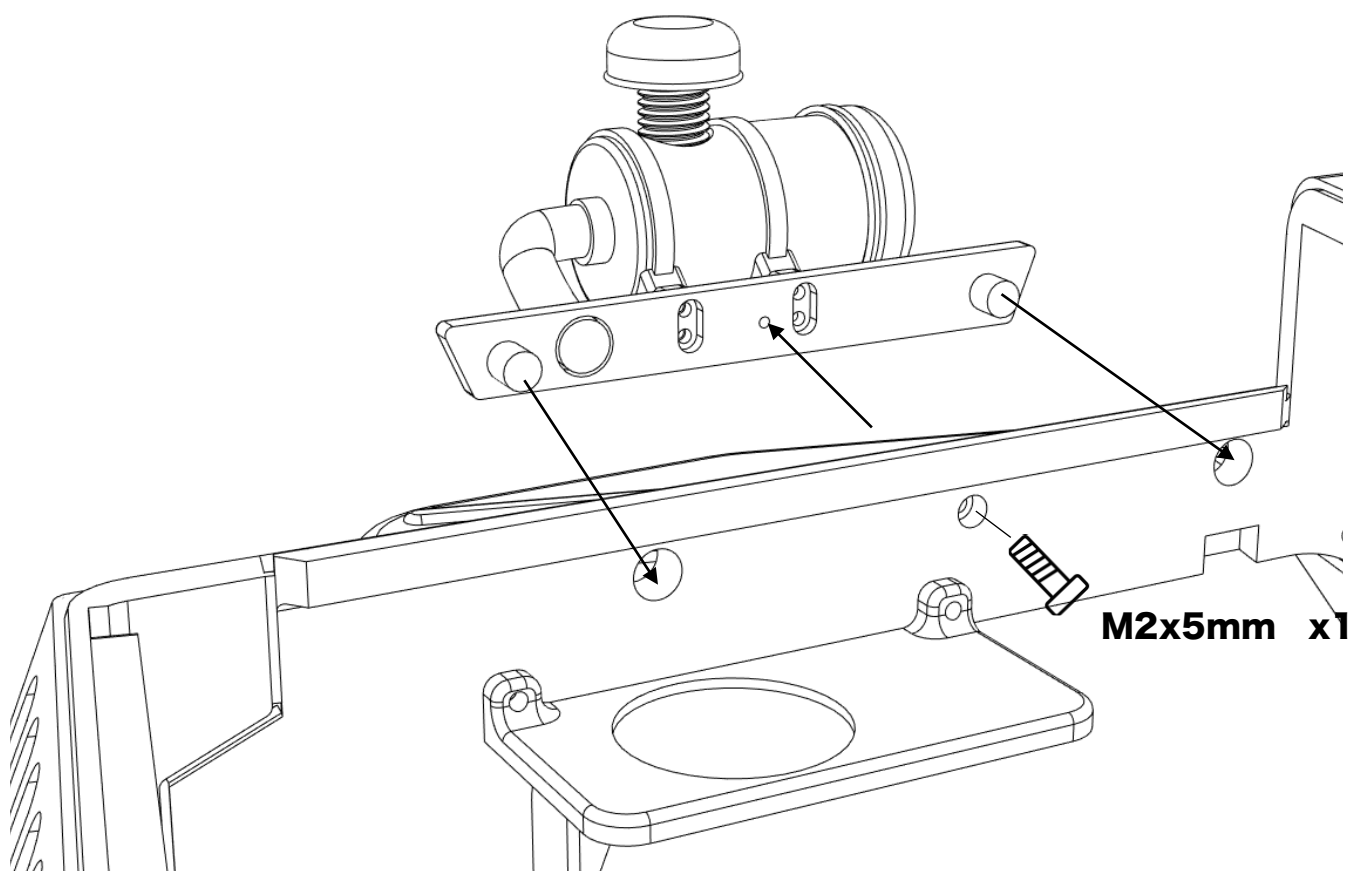
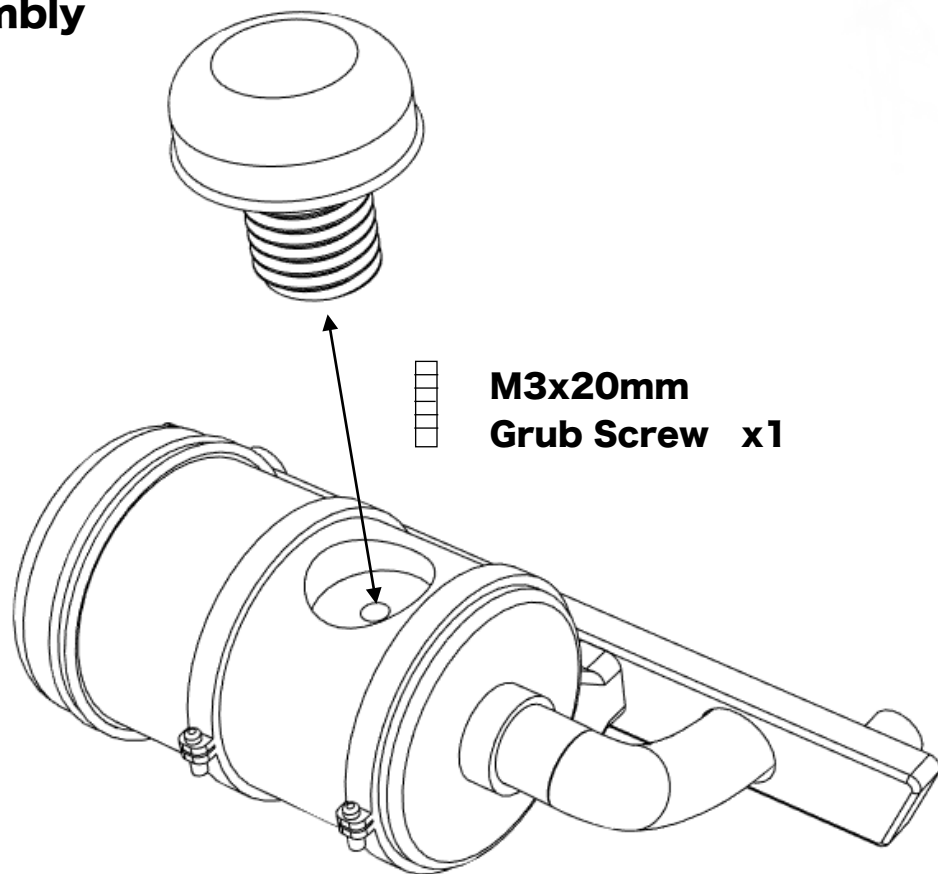

Accessories

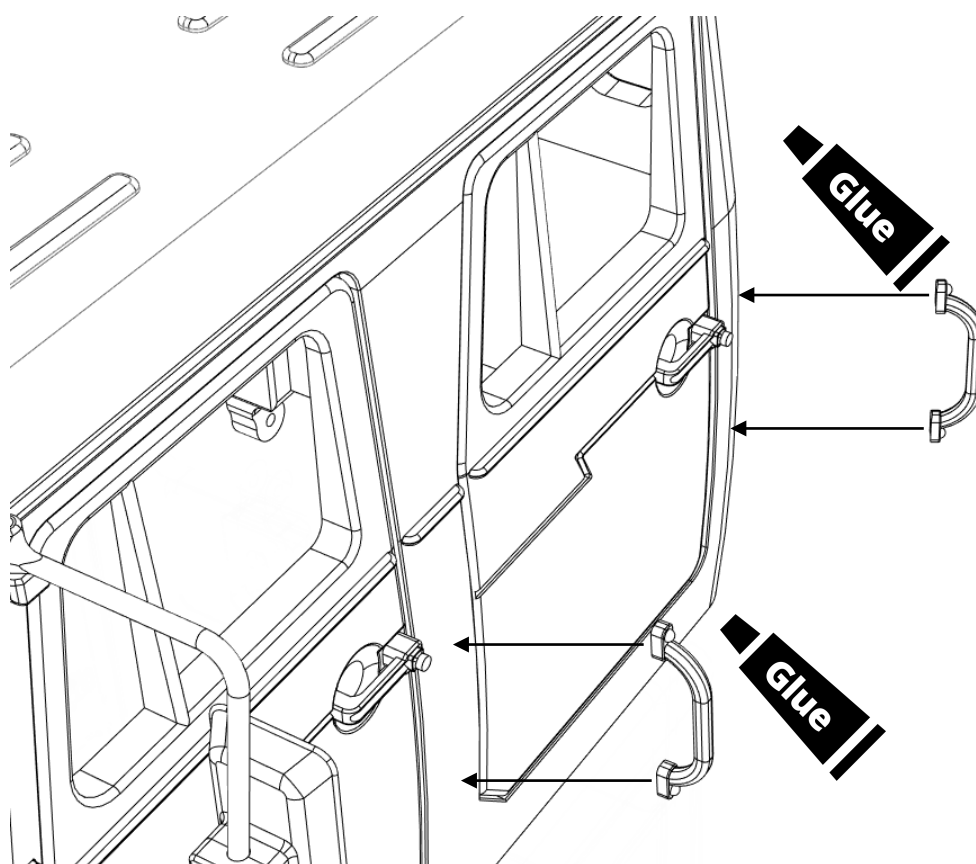
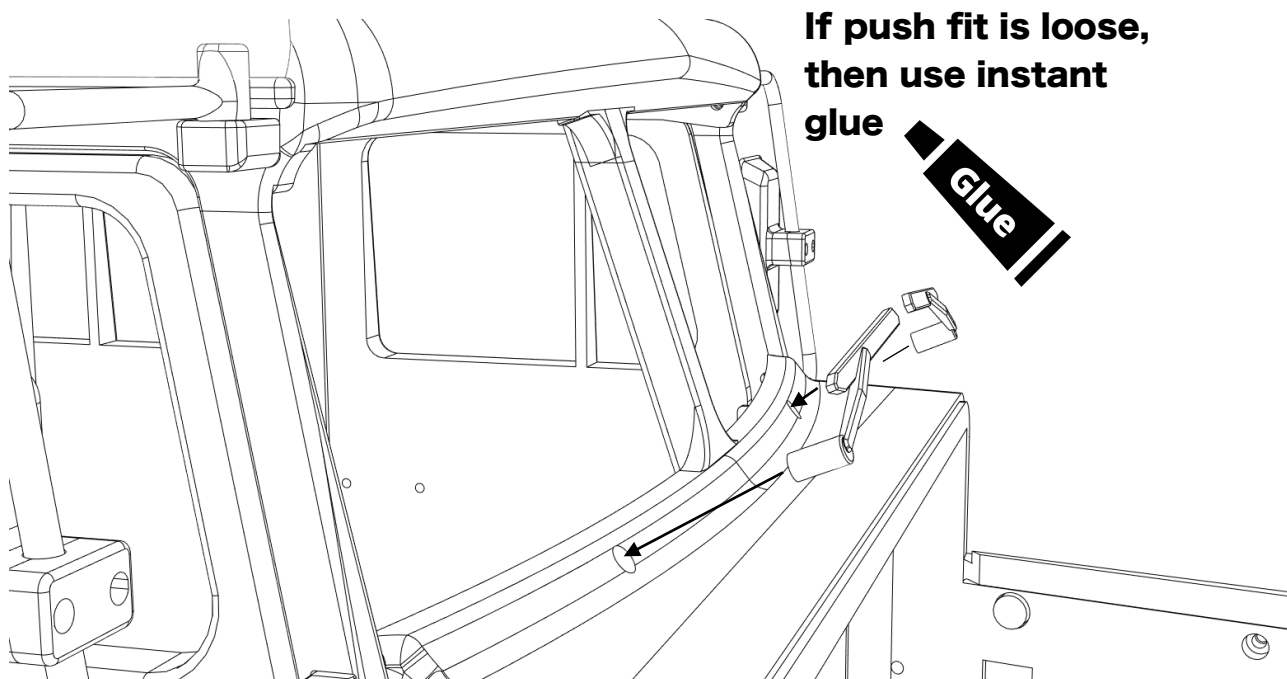

Cab lights and fender lights

**Test fit before
using instant glue**

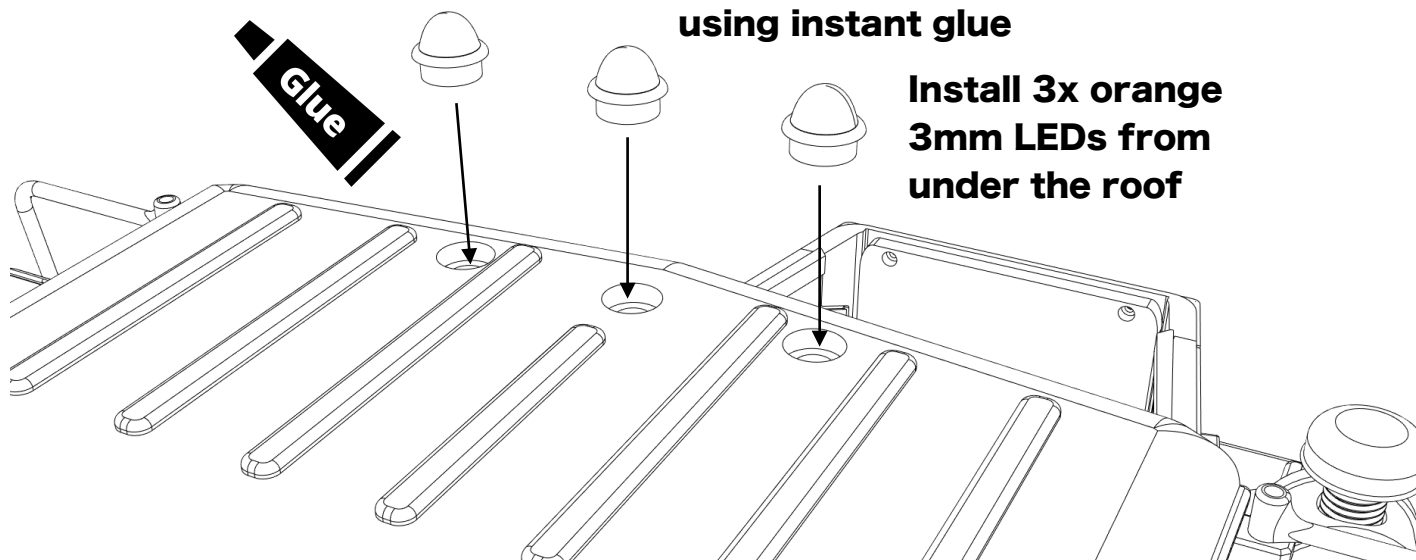

**Test fit before
using instant glue**

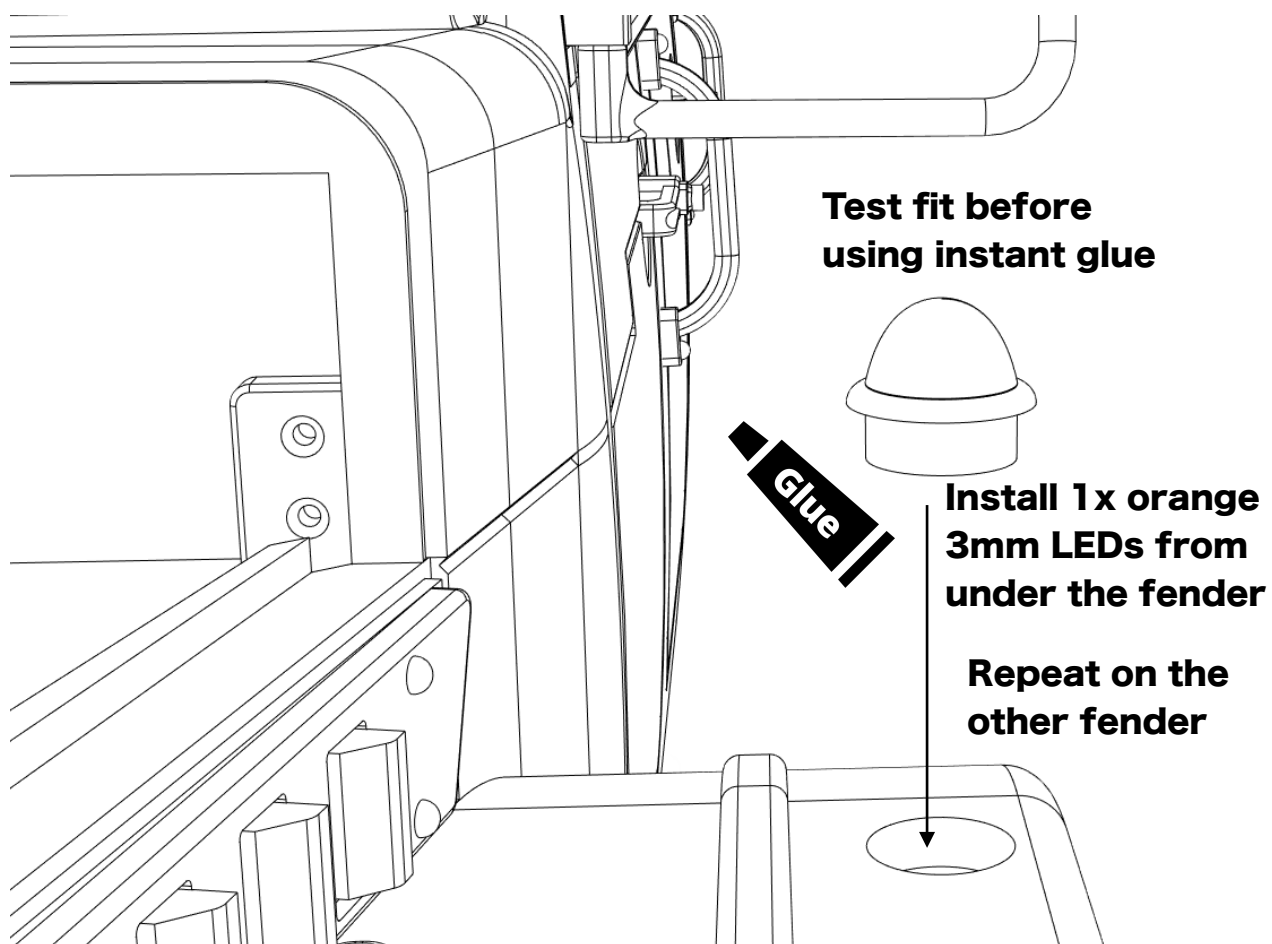

Bonnet assembly

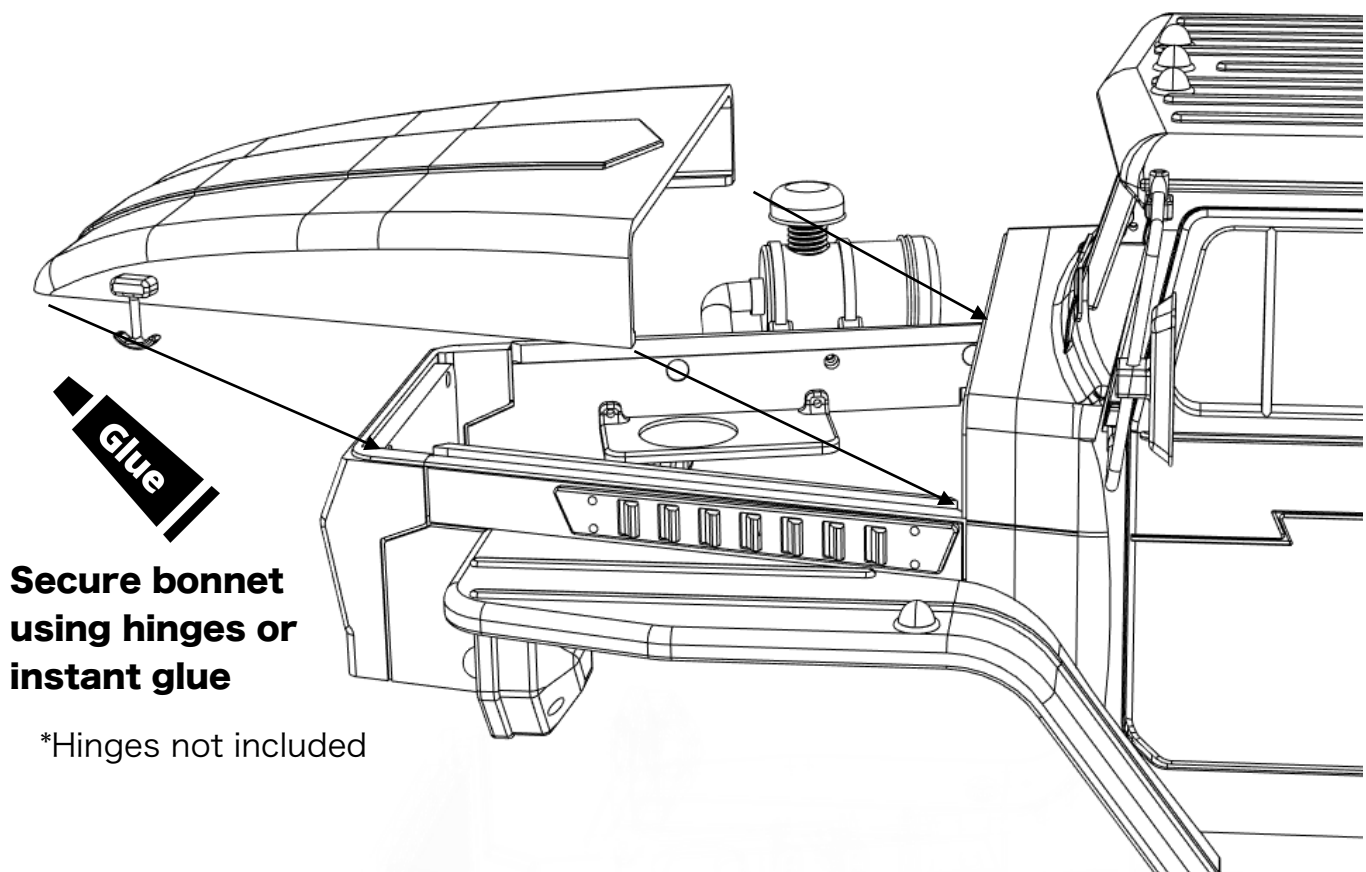
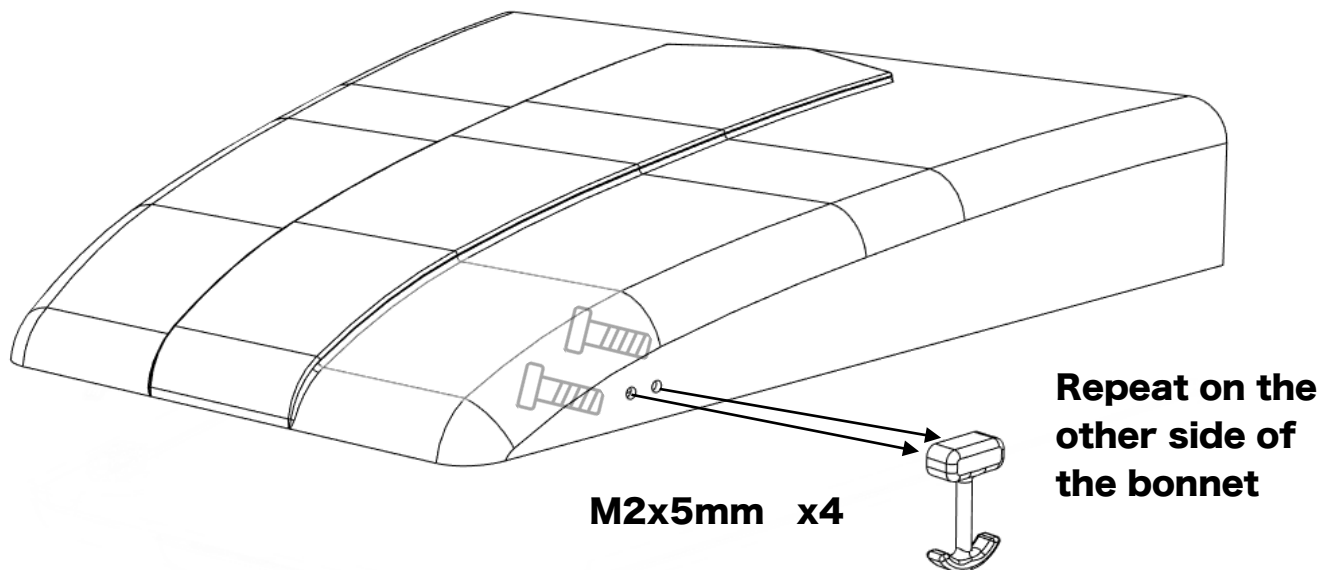

Cab is complete!

To add windows, open the .dxf files and print in 1:1 scale

Trace and cut out the windows on a clear polycarbonate sheet

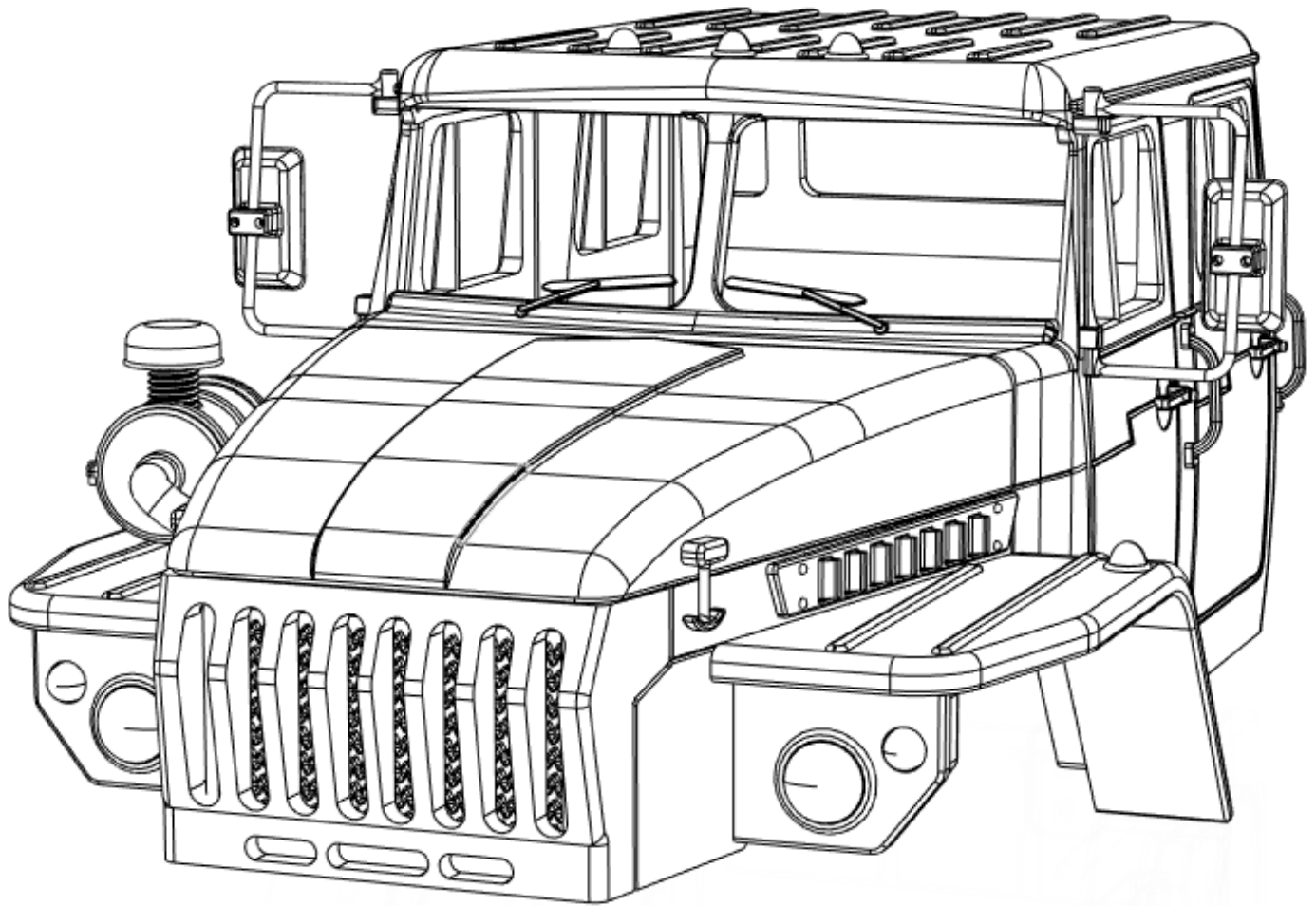

Bumper assembly

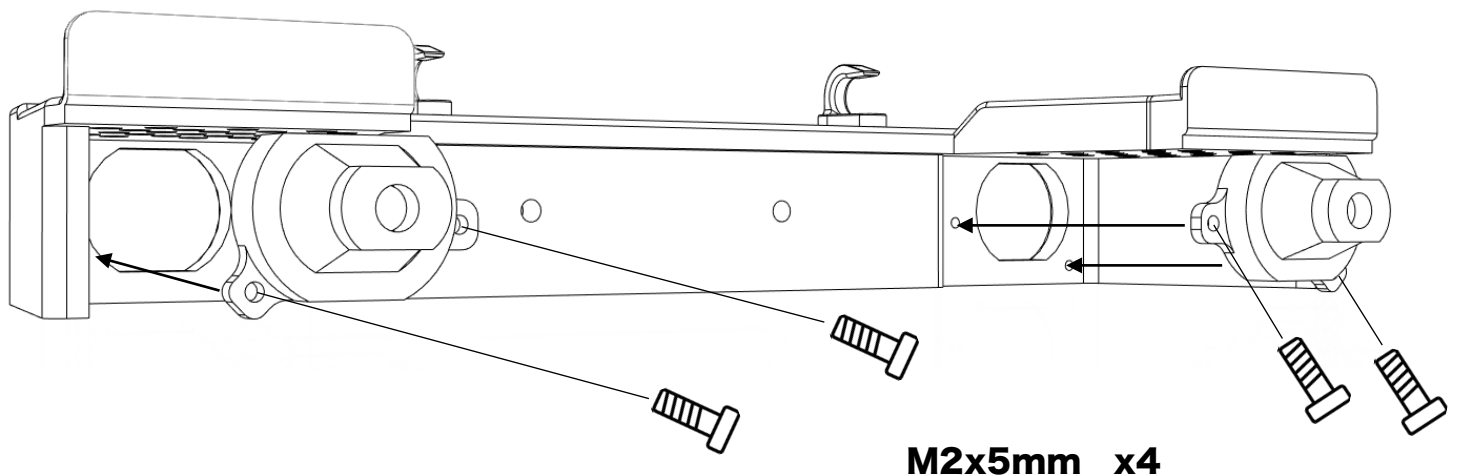
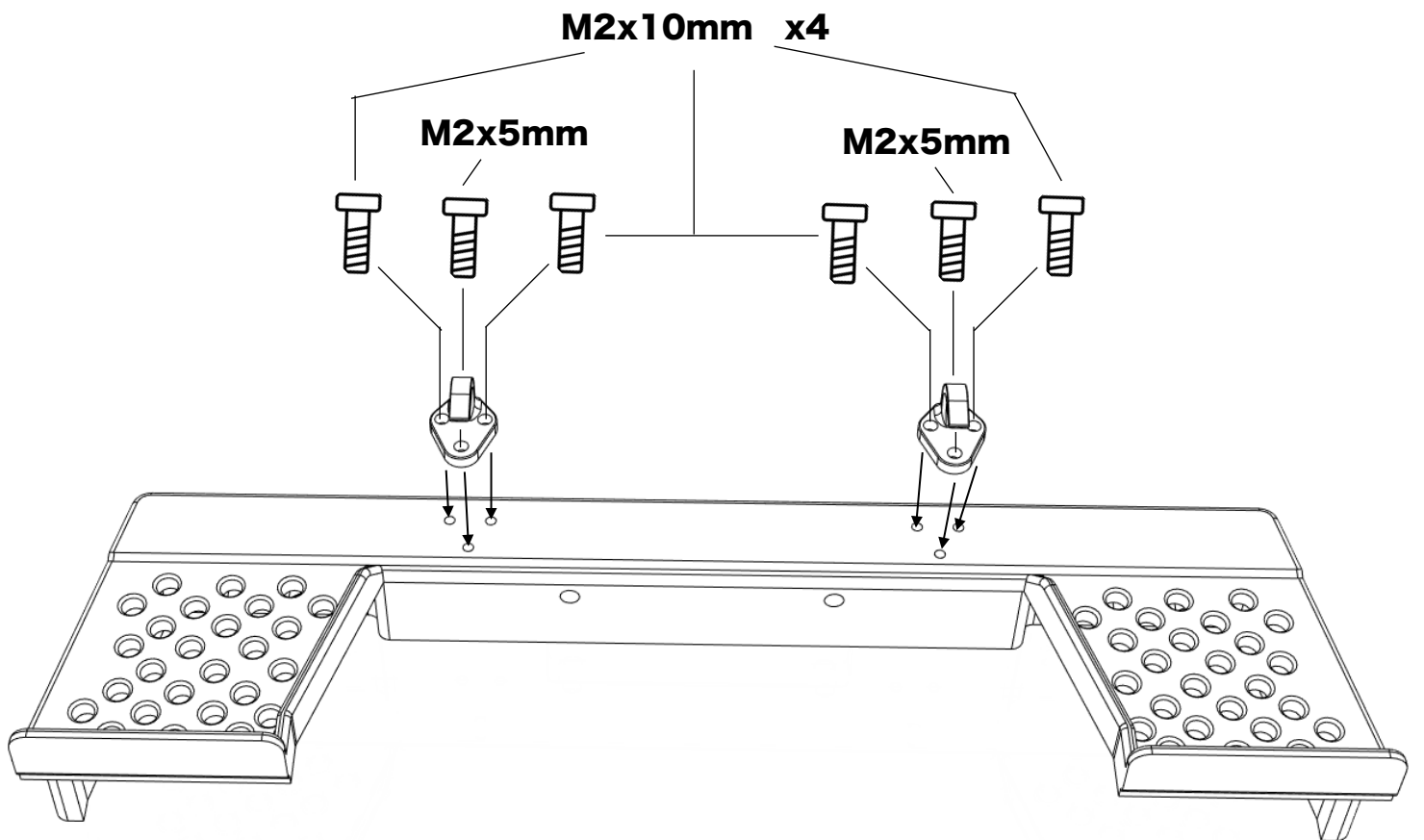

2x 5mm white LEDs can be fitted to the buckets

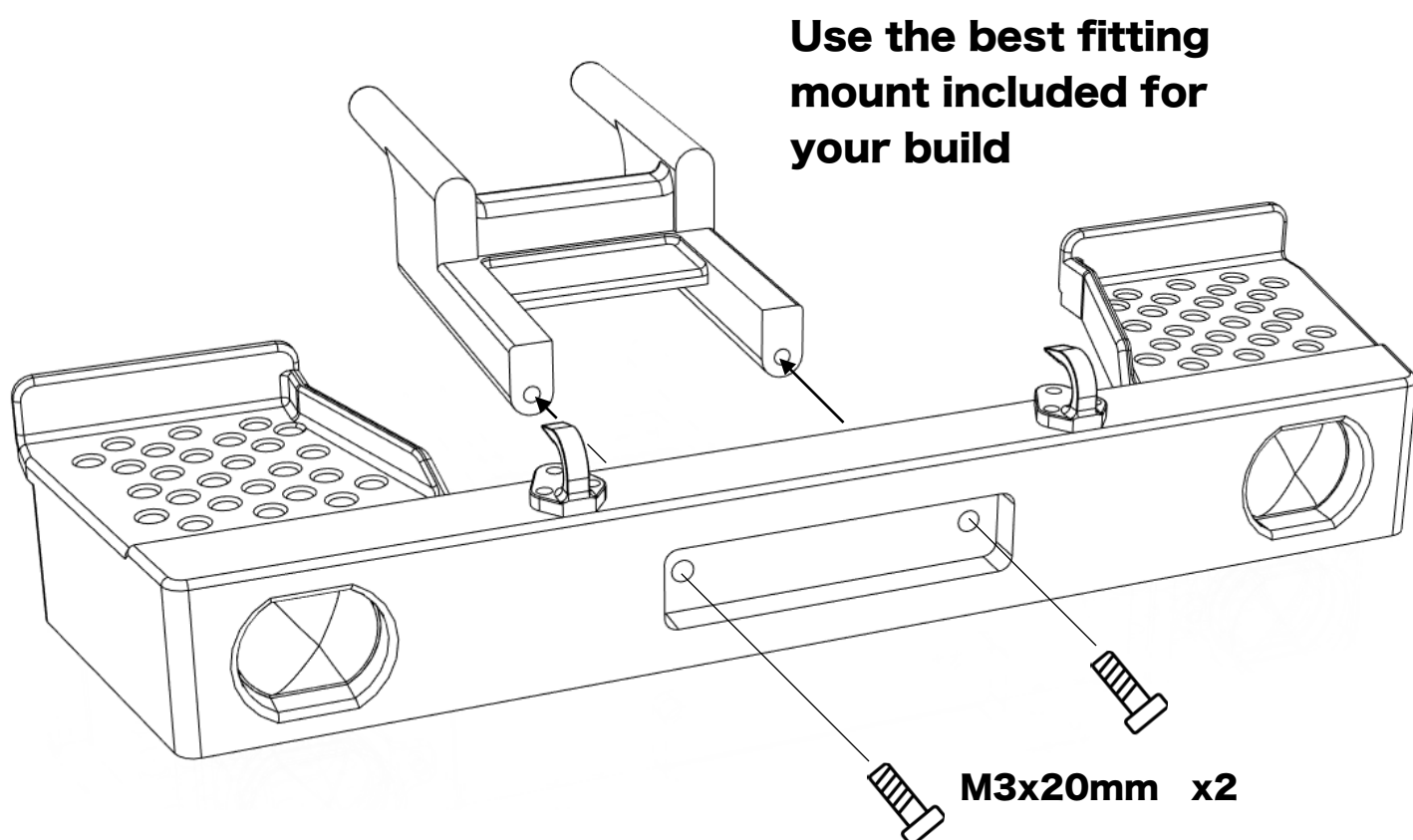
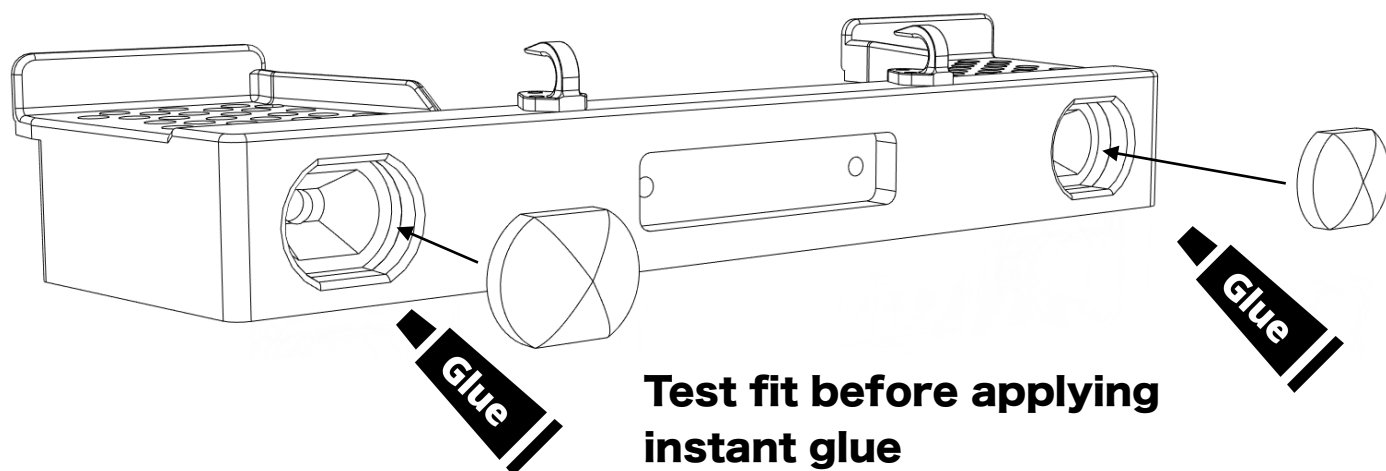

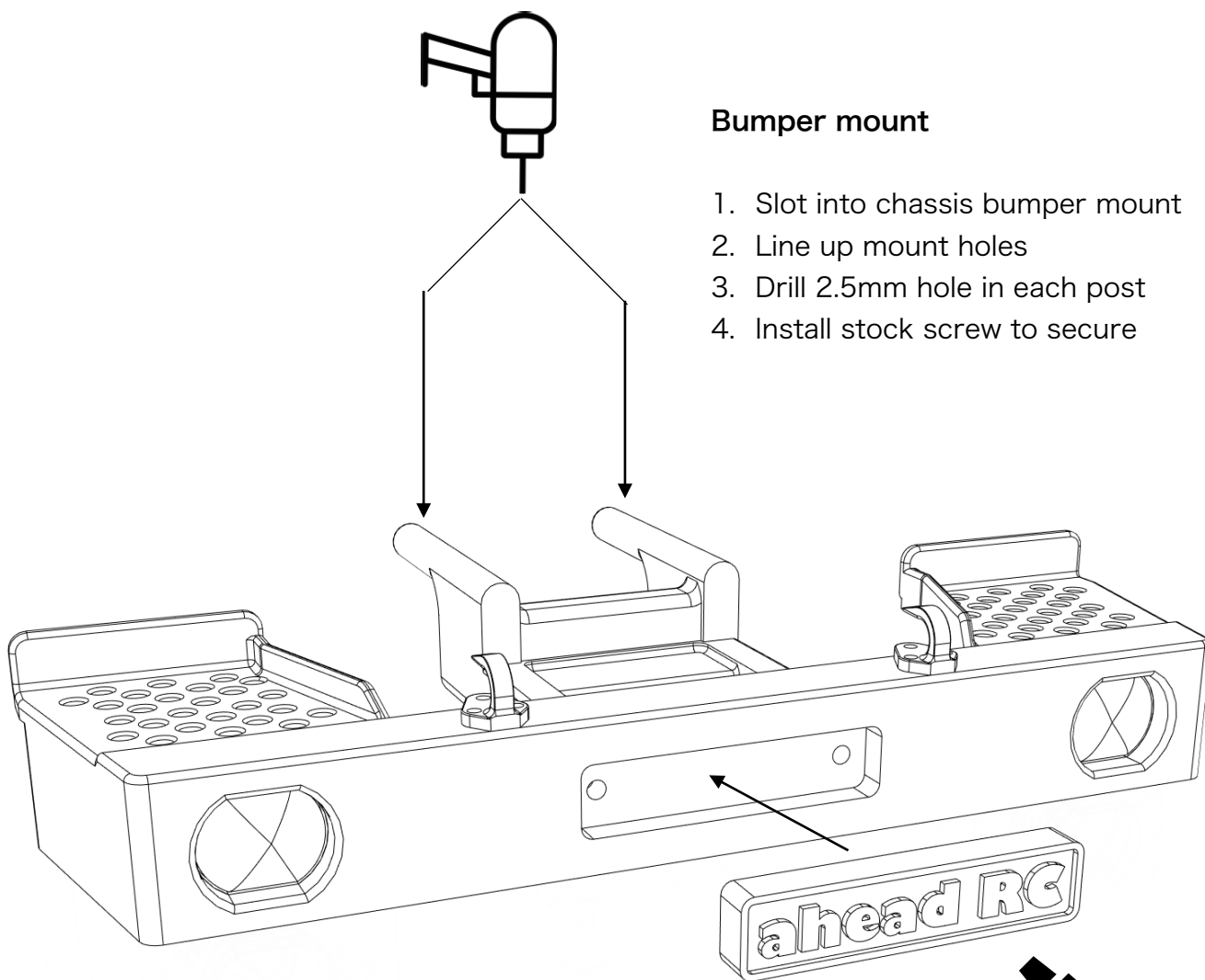

Bumper mount

1. Slot into chassis bumper mount
2. Line up mount holes
3. Drill 2.5mm hole in each post
4. Install stock screw to secure

Custom number plate (design and print method)

1. Draw a 3D rectangle with dimensions of 52*12*5mm.
2. Add 2mm fillets to each corner.
3. Add your own number or design to the front of the plate.
4. At the back of the plate, draw a centerline and place two 5mm circles with a total spacing of 43mm apart.
5. Cut the circles into the number plate to a depth of 3.2mm. It may be necessary to shrink the outer perimeter by 0.2mm for a looser and better fit.



Bumper is complete!

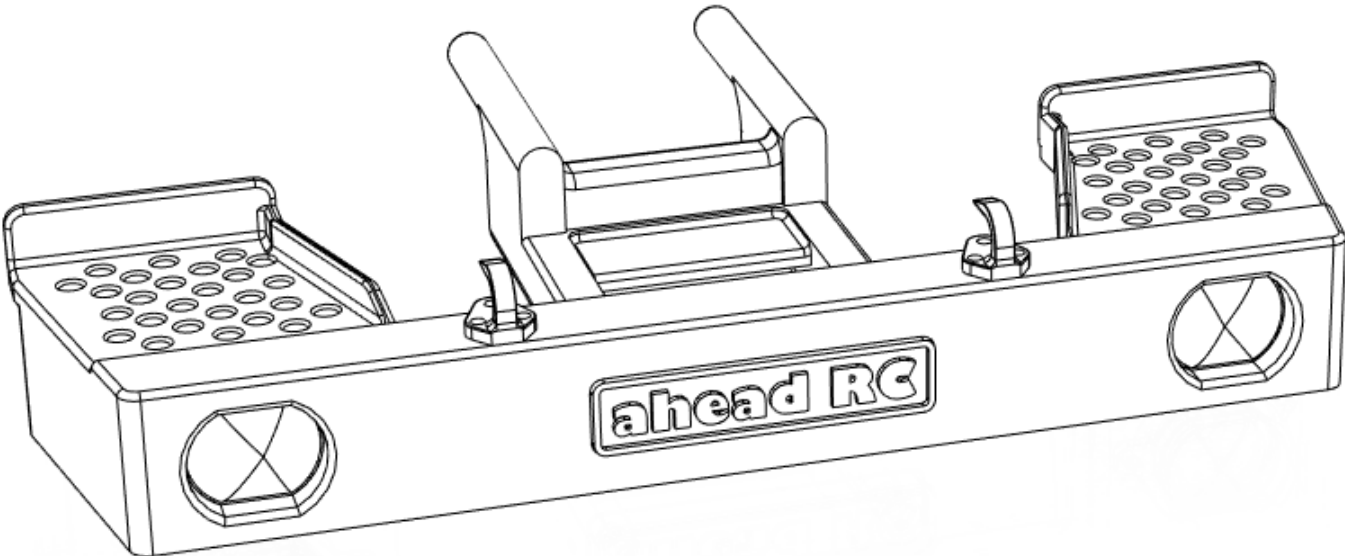

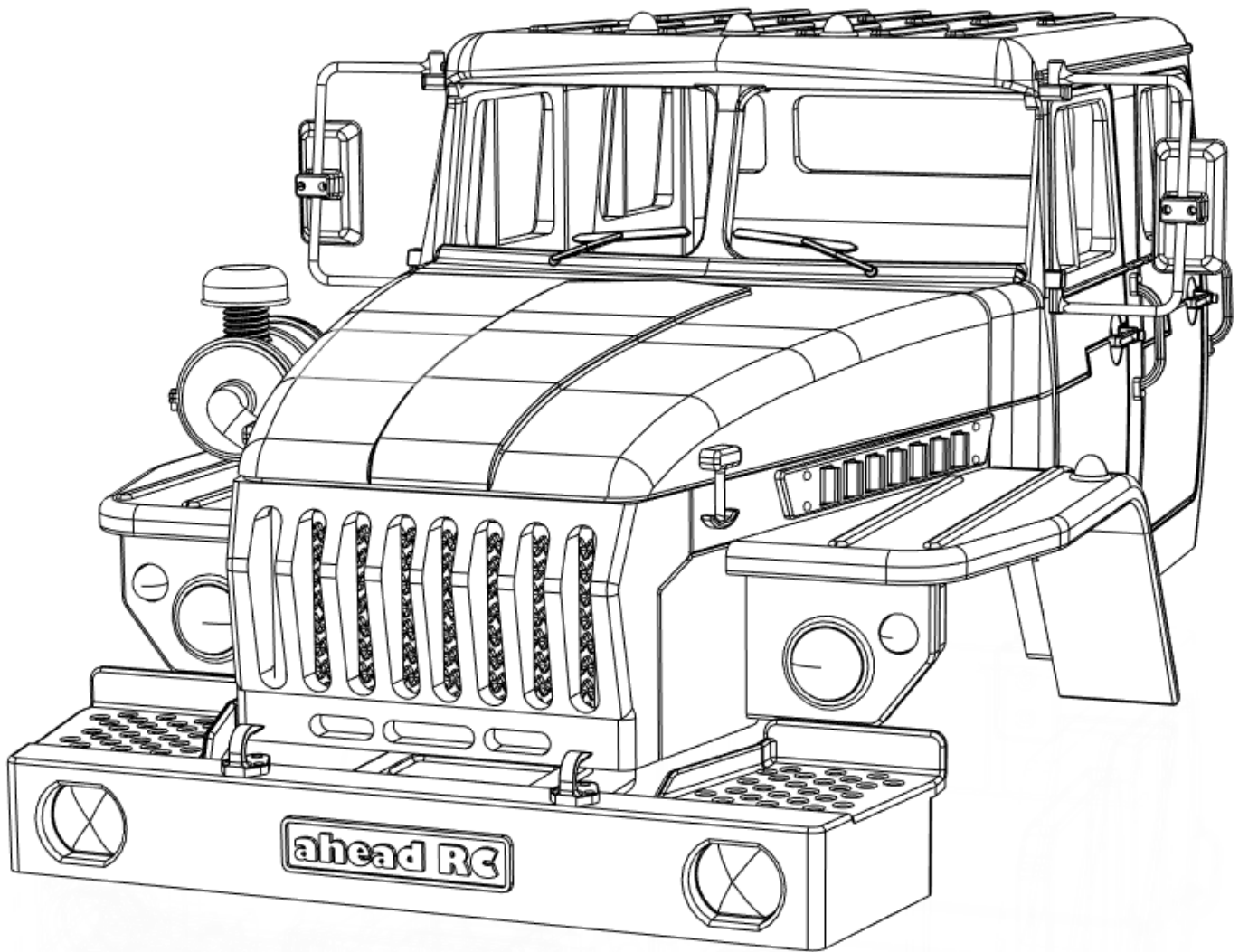

Body is now fully complete. Thank you for selecting ahead RC products.

If you have any questions or need help with the assembly, please do not hesitate to contact us at:

aheadrc@gmail.com

or visit us at:

www.aheadrc.com

Best of luck with your build!