

ahead RC Crawler Bog 406 Cab Assembly Manual



Required tools and hardware

Tools

- 1.5mm Hex Driver
- 2.5mm Hex Driver
- Needle Nosed Pliers
- Instant Glue
- Hot Glue

Electronics

- 5mm Warm White LED x4
- 3mm Orange LED x2

Hardware

Hardware	Quantity	Check ✓
M2*5 Socket head	20	
M2*8 Socket head	6	
M2*10 Socket head	12	
M2*15 Socket head	2	
M2*20 Socket head	1	
M3*10 Socket head	8	
M3*15 Socket head	9	
M3*15 Button head (BH)	1	
M3*20 Socket head	2	
M3*25 Button head (BH)	1	

Before you begin

- Be sure to read through the manual and familiarise yourself with the instructions
- Visualise a plan to assemble all the pieces
- Make sure you have all of the hardware and tools
- Be sure to have enough instant glue
- Dry fit all parts before painting and assembling

Tip: It will help to paint all of the parts before final assembly

Installing the headlight buckets

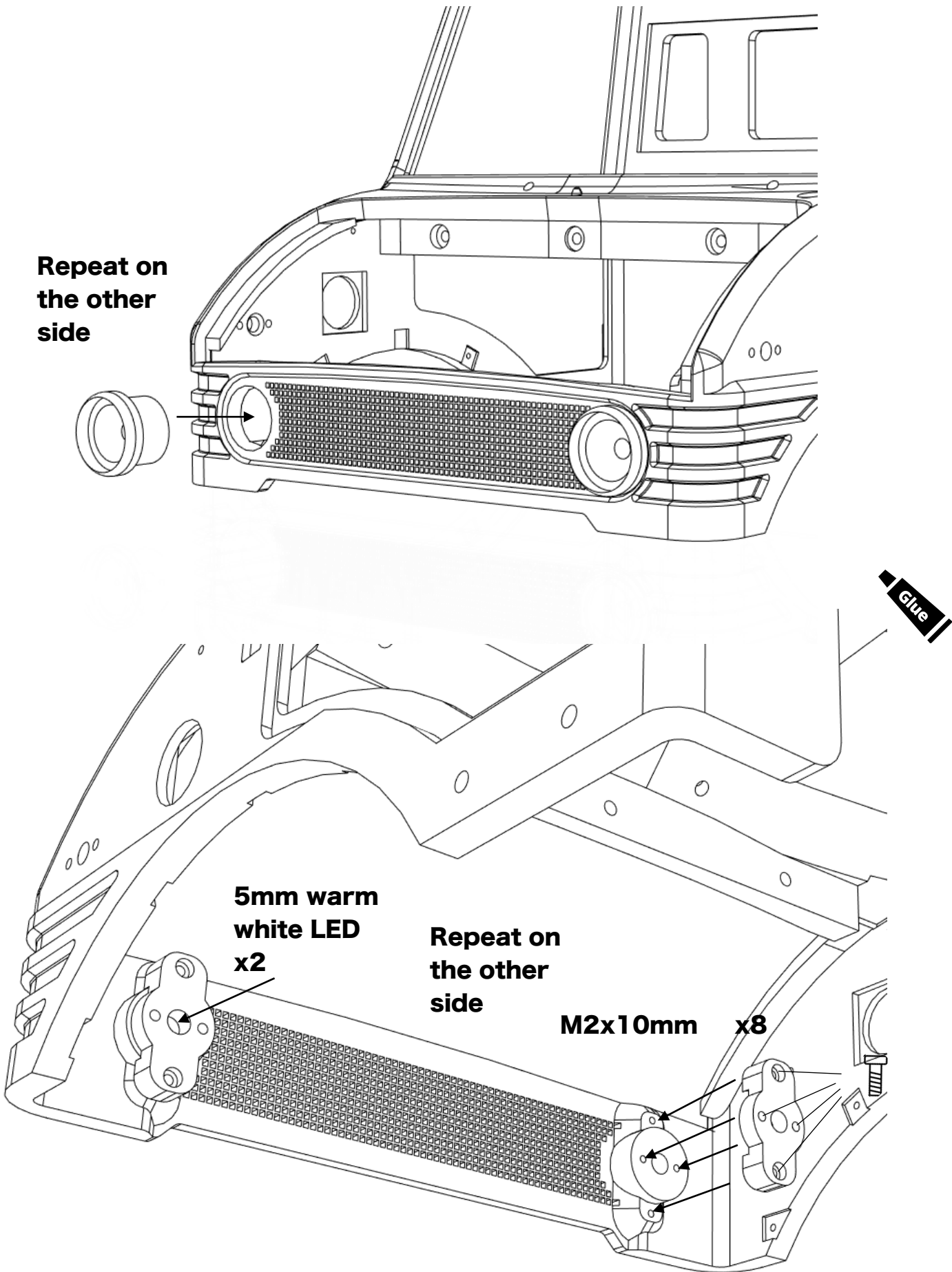

Installing the fenders

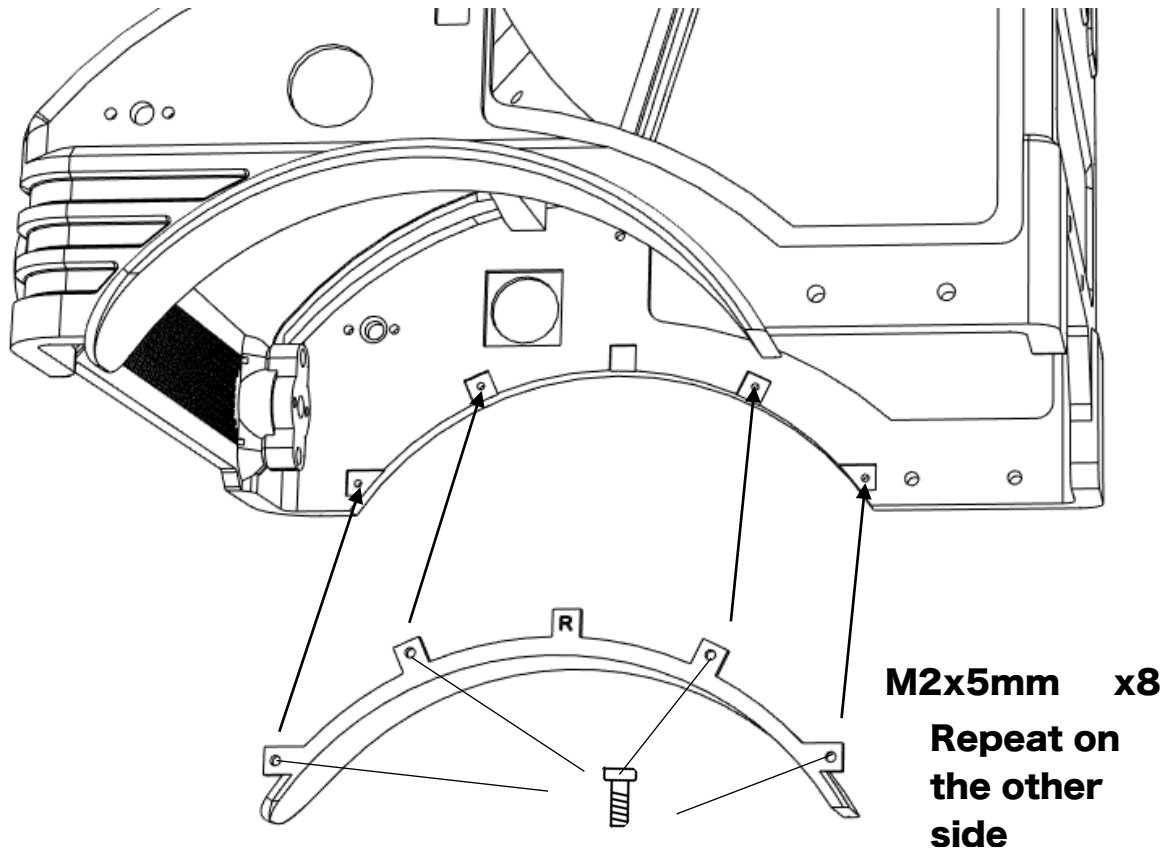

Assembling the Mirrors

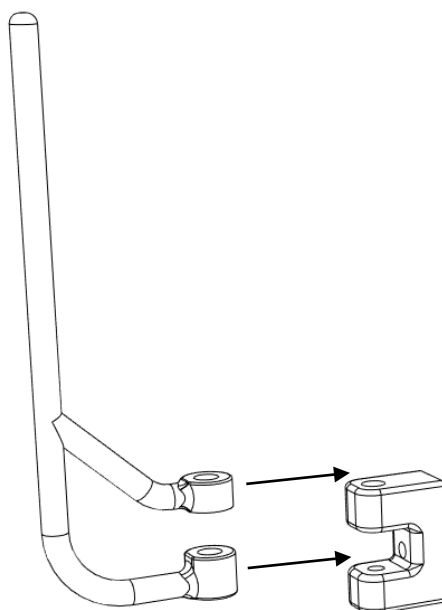

**Repeat on
other
mirror**

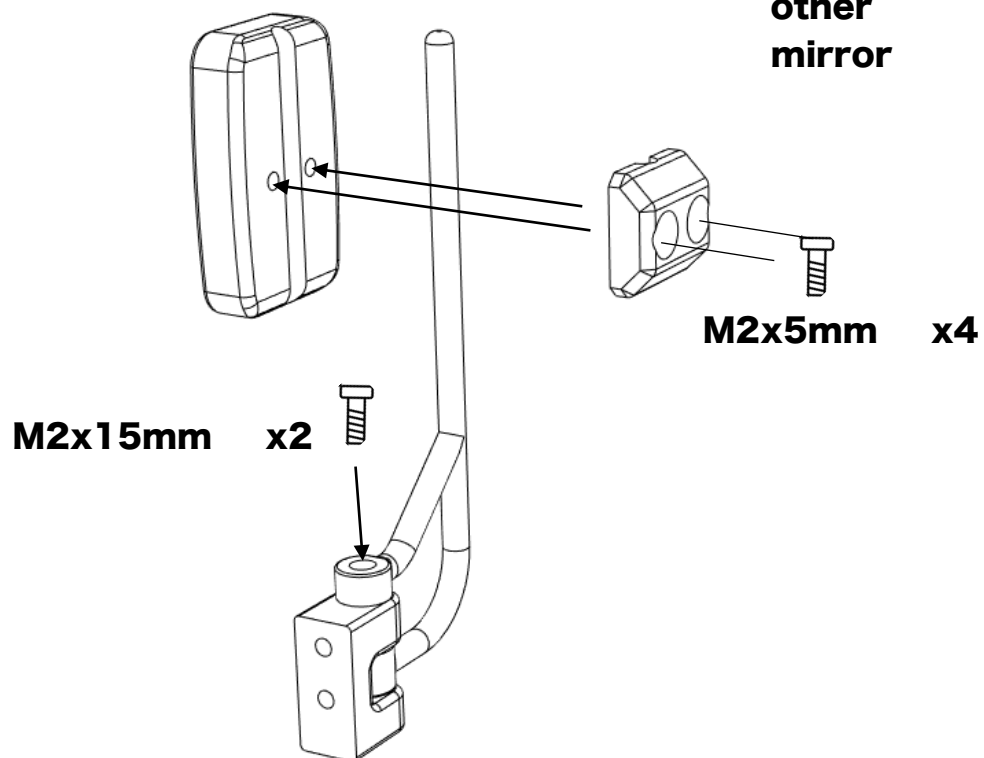

Installing the mirrors and snorkel

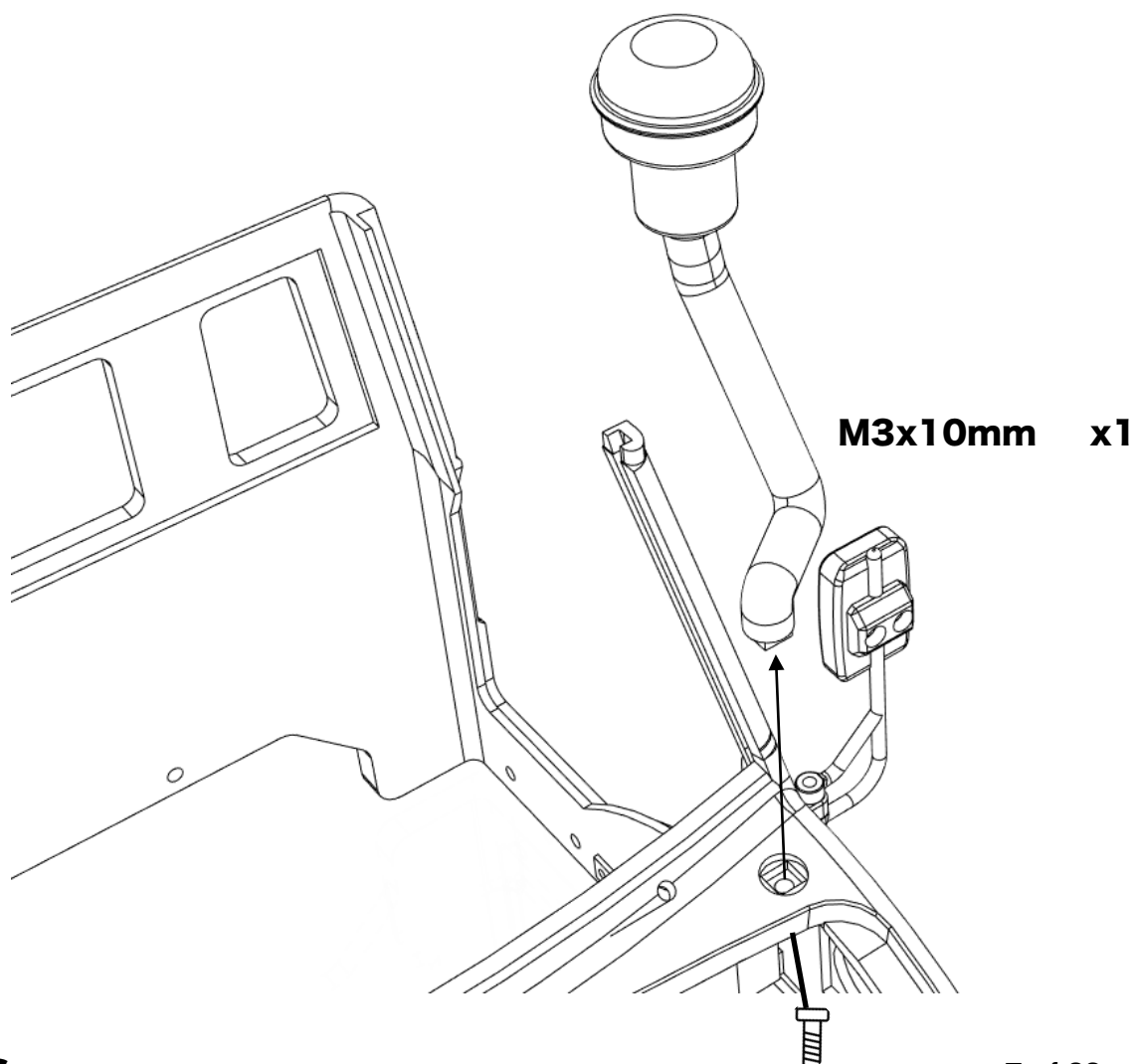
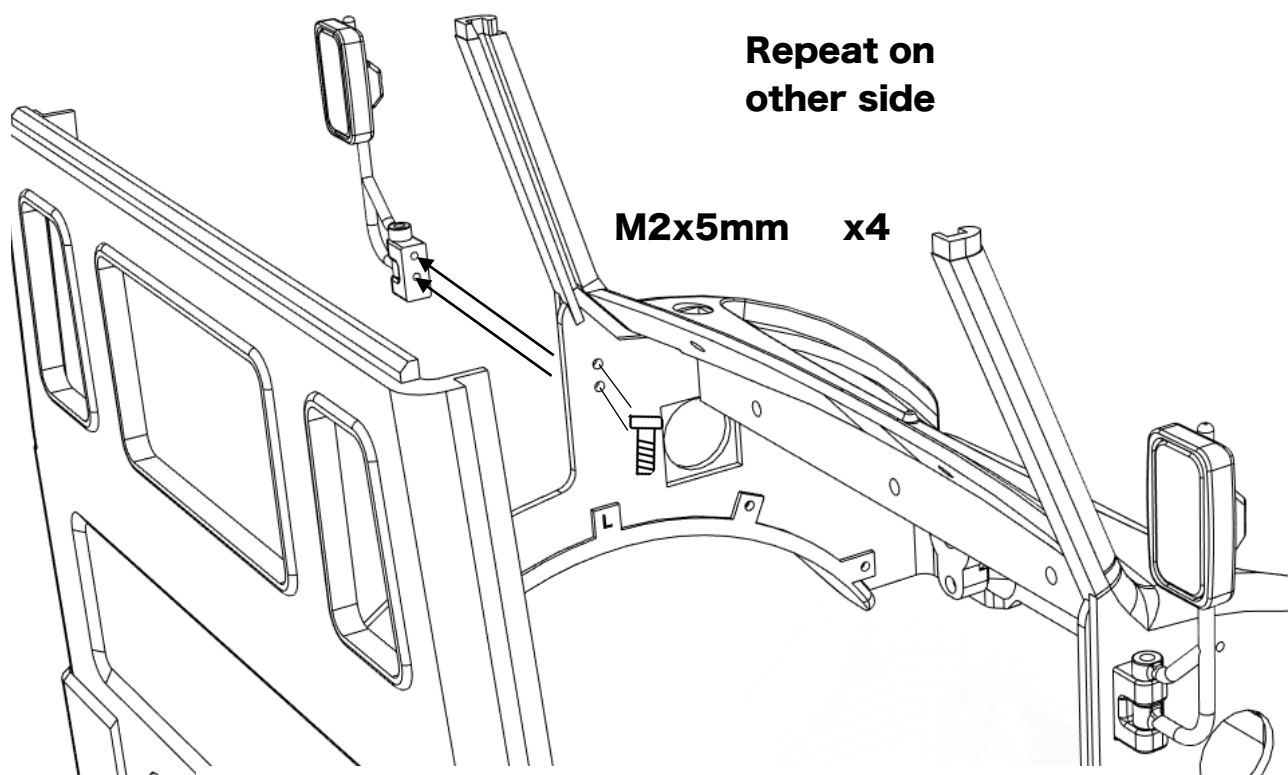

Installing the wipers and side vents

Repeat on
other wiper

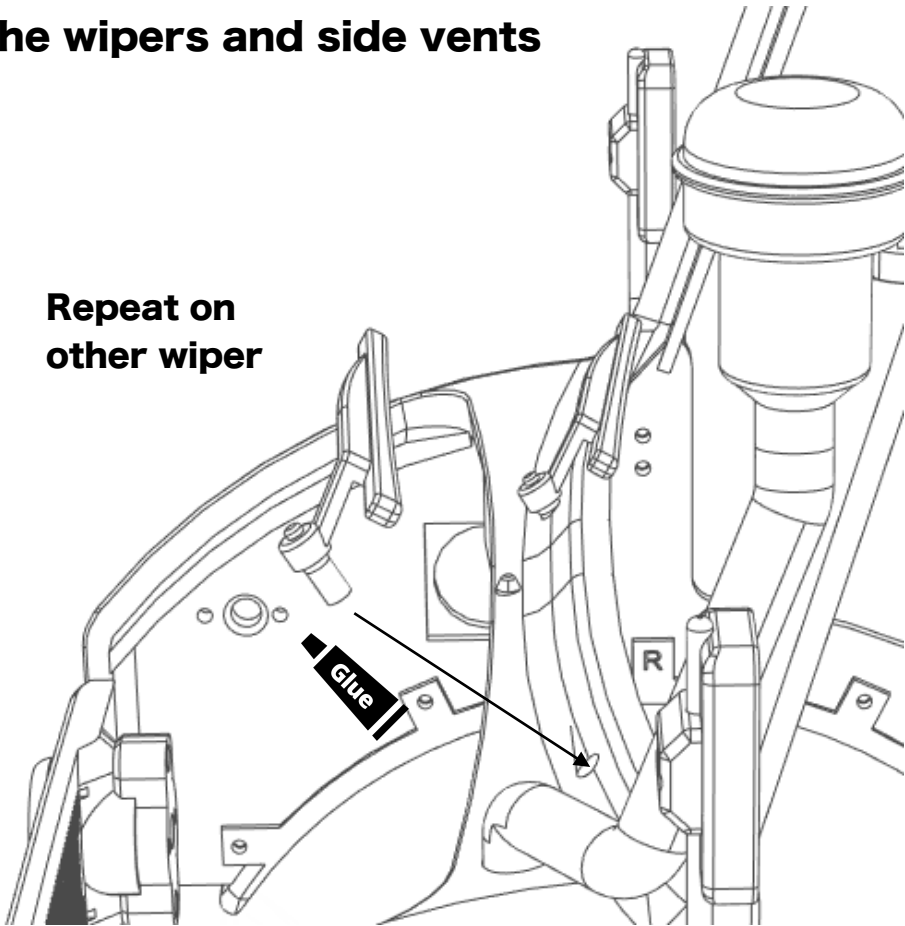

Repeat on
other side
vent

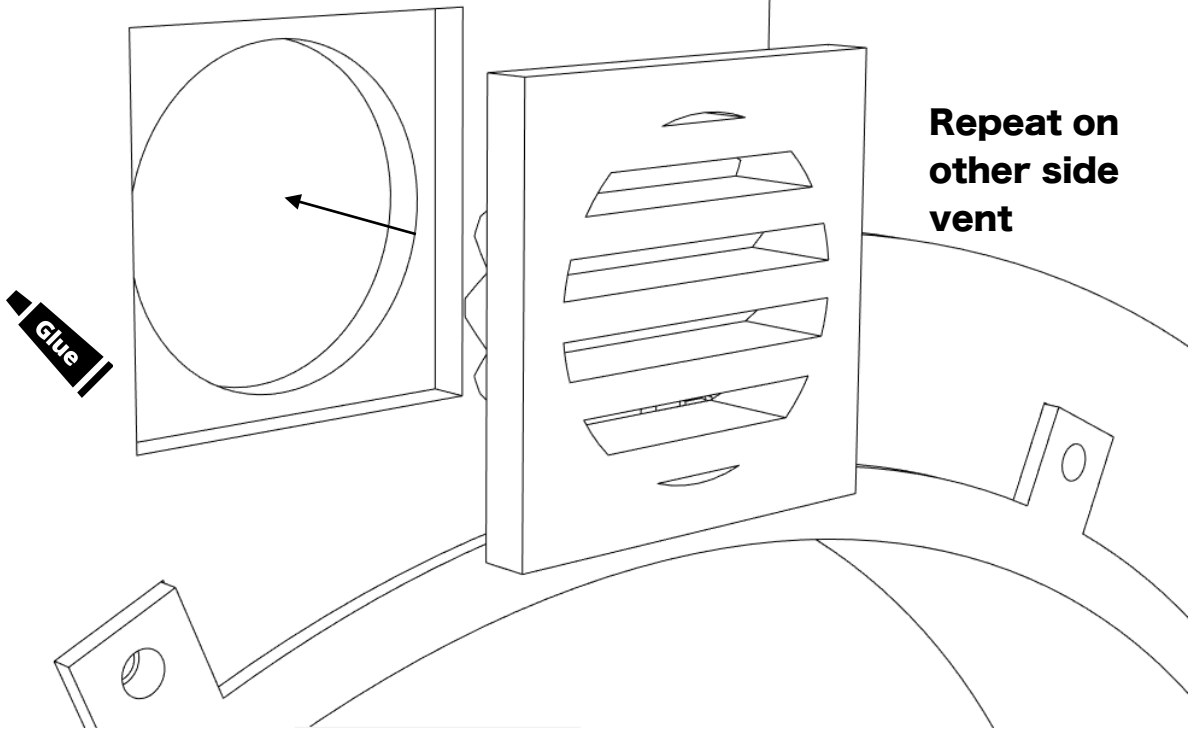

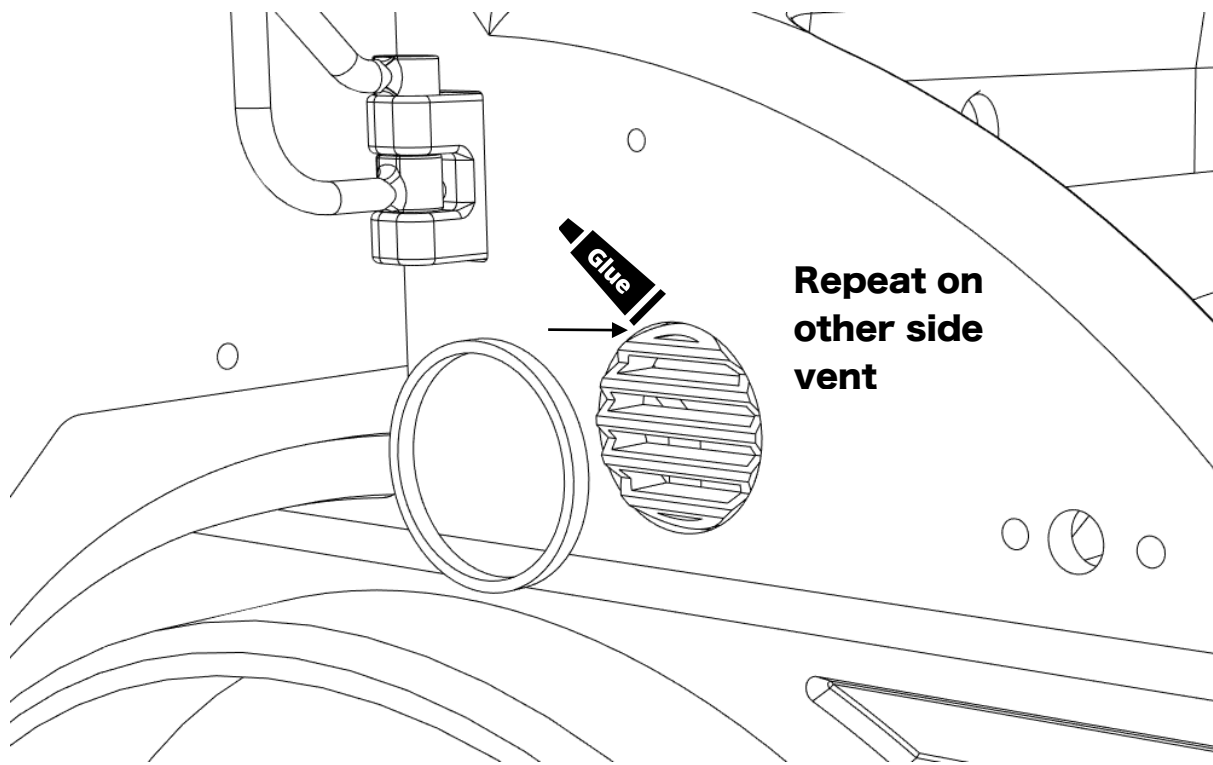

Assembling the exhaust

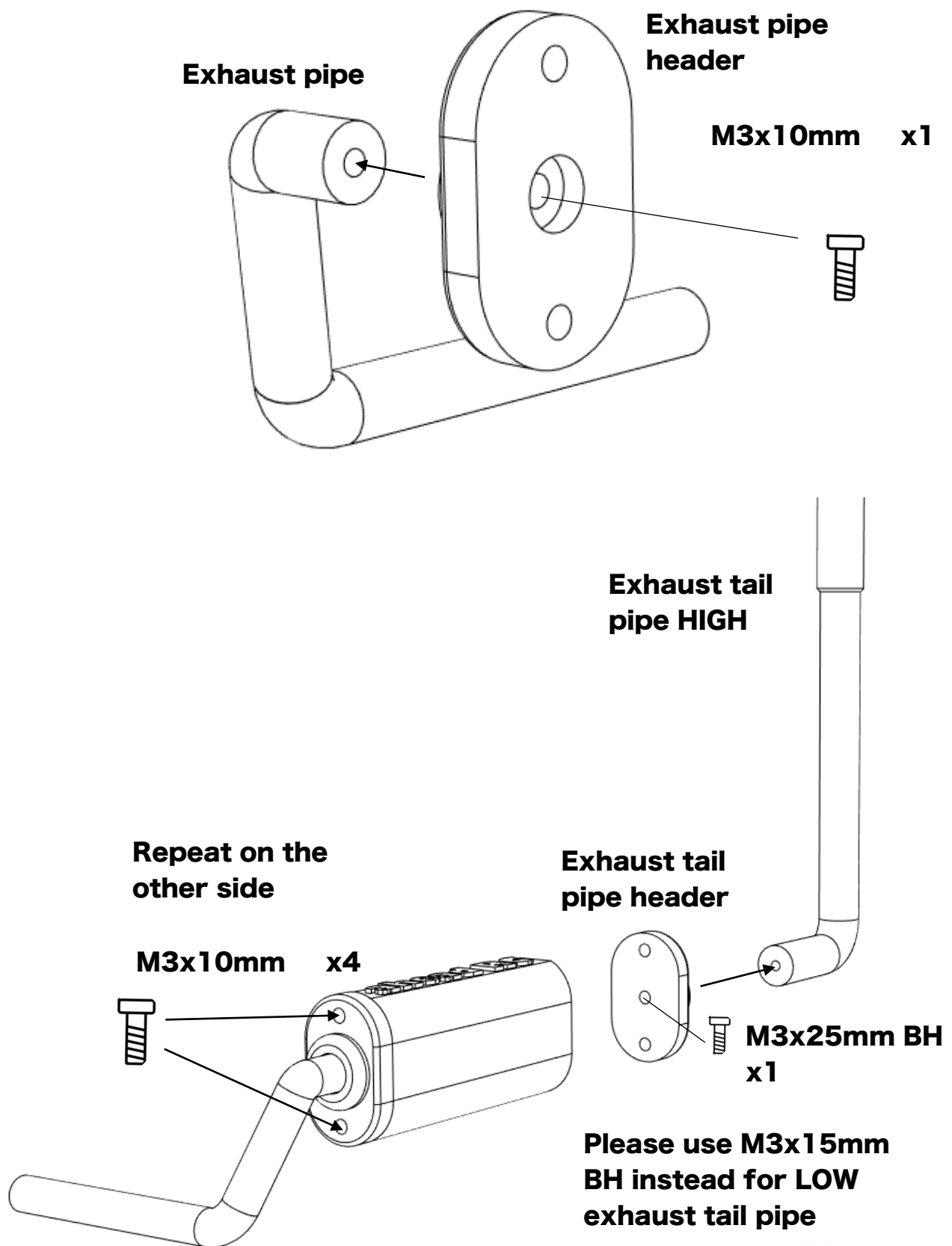

Installing the vertical mounted exhaust

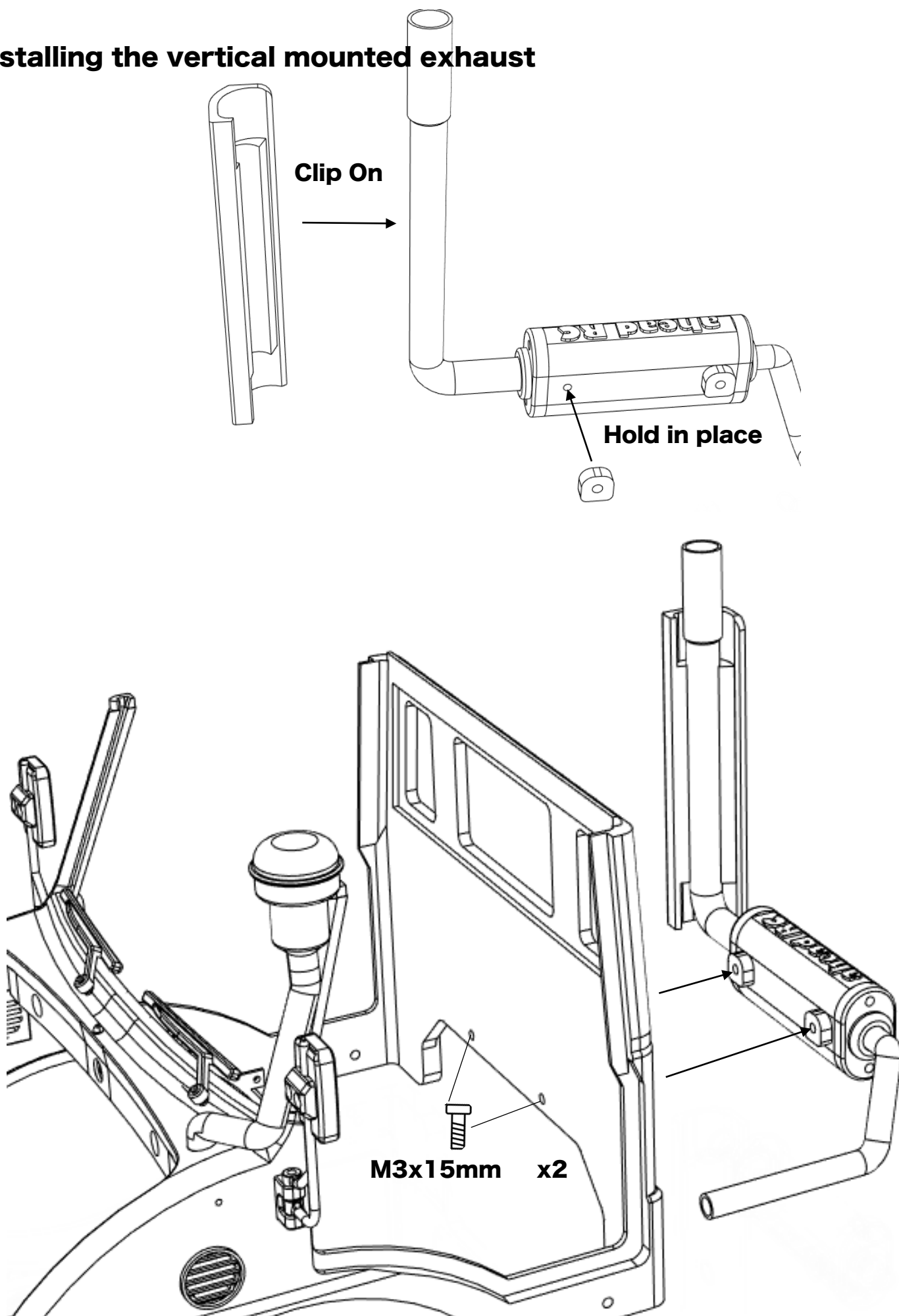

Installing the horizontal mounted exhaust

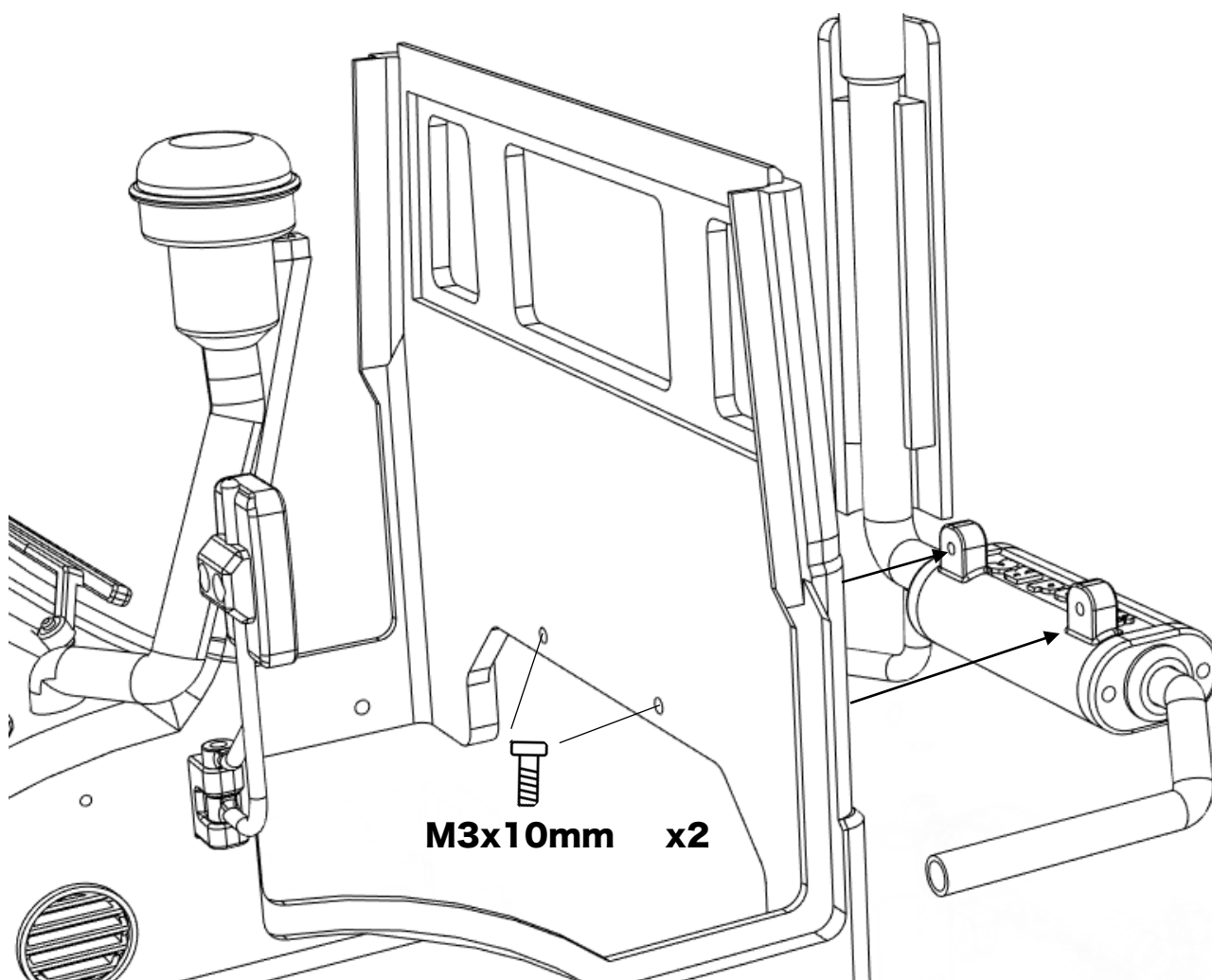

Assembling the interior

M2x20mm x1

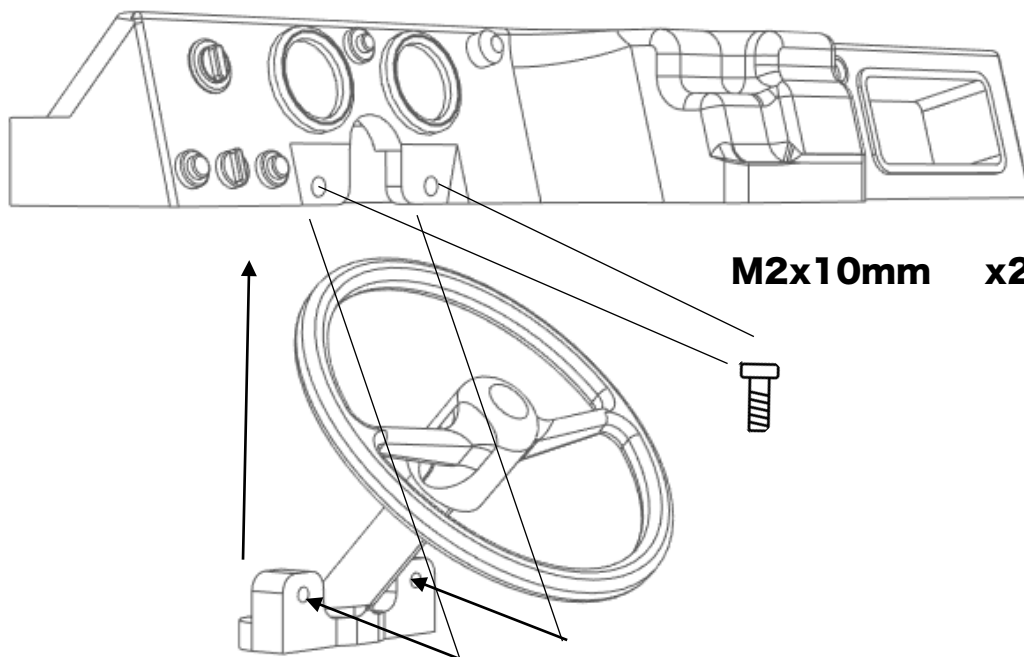
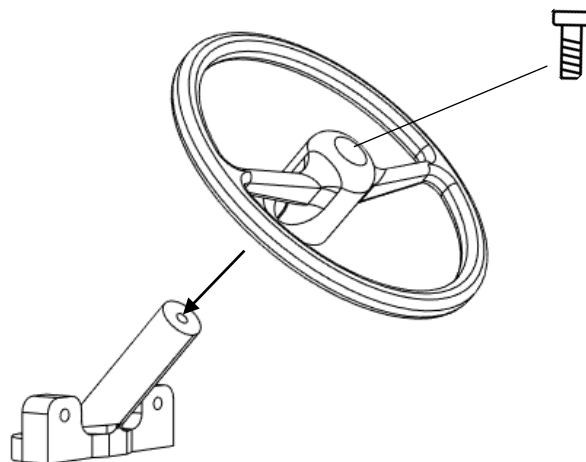

M2x10mm x2

Installing the interior

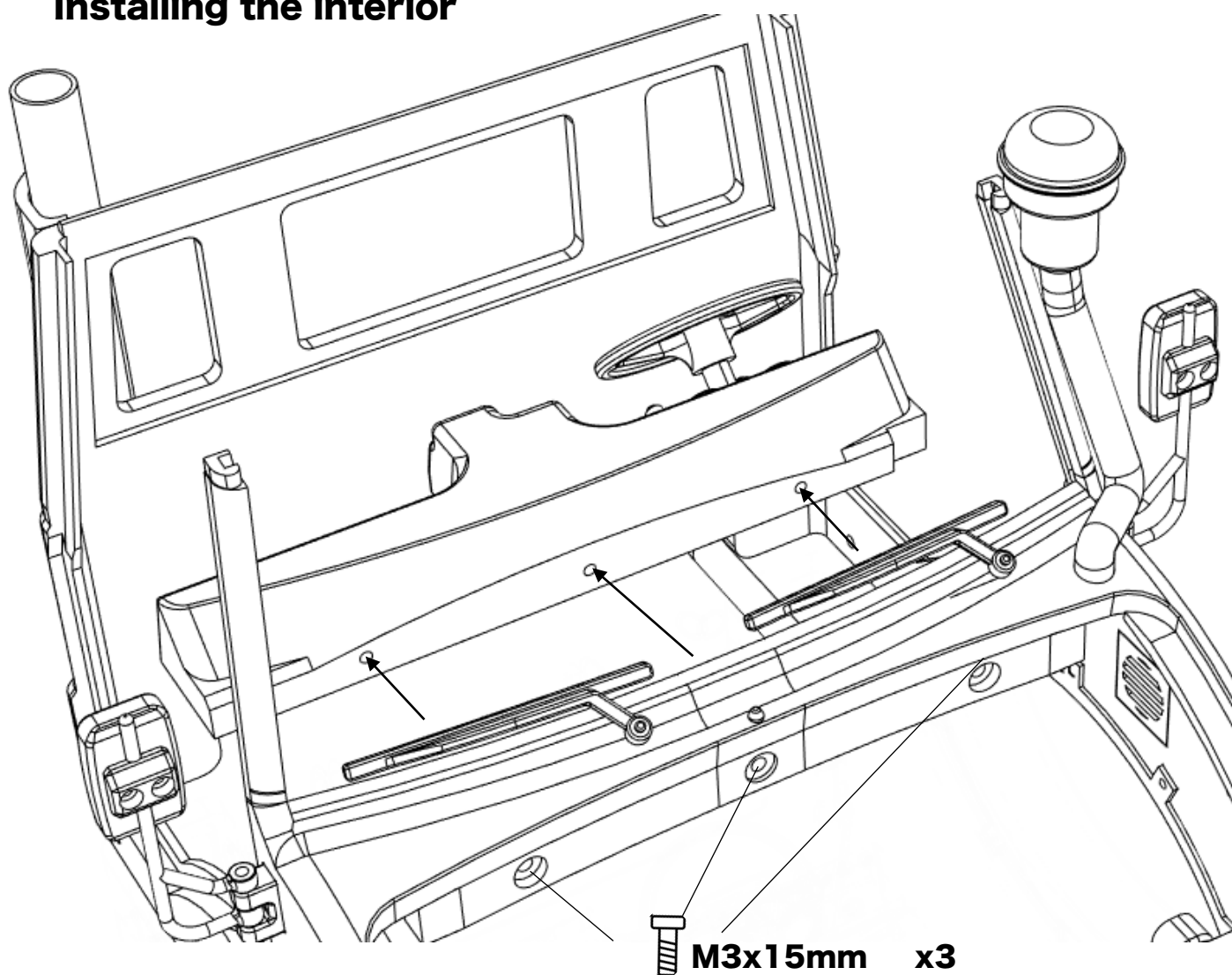

Installing the roof

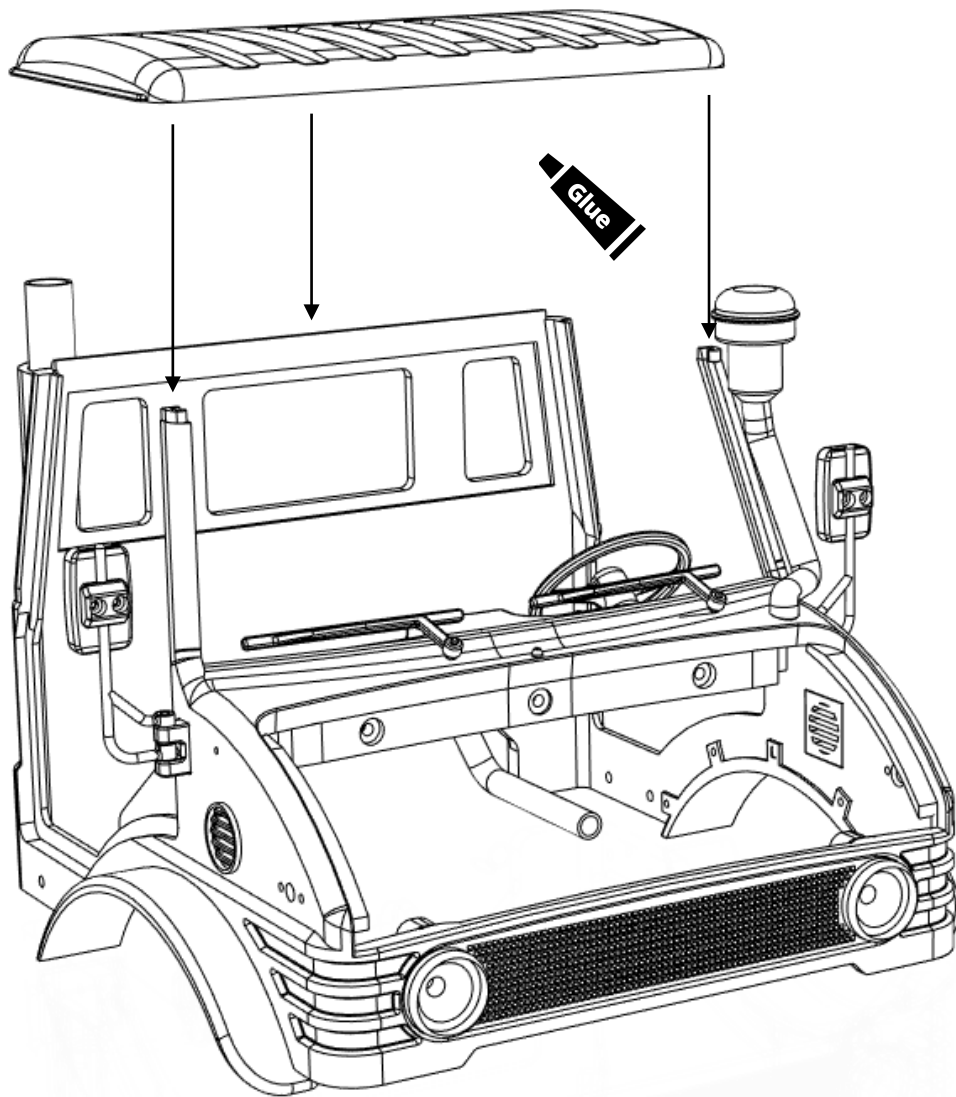

Assembling and installing the doors

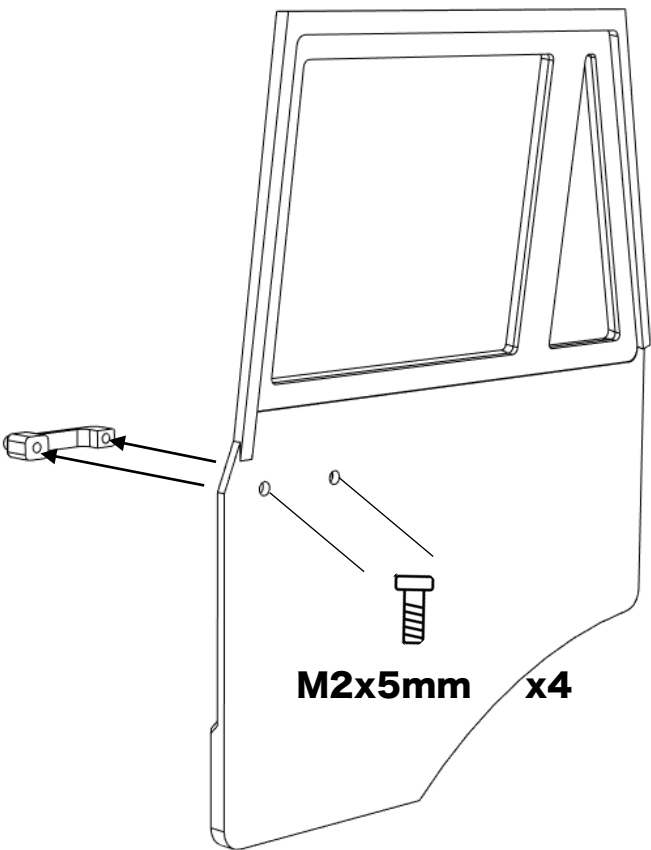

Repeat on the other door

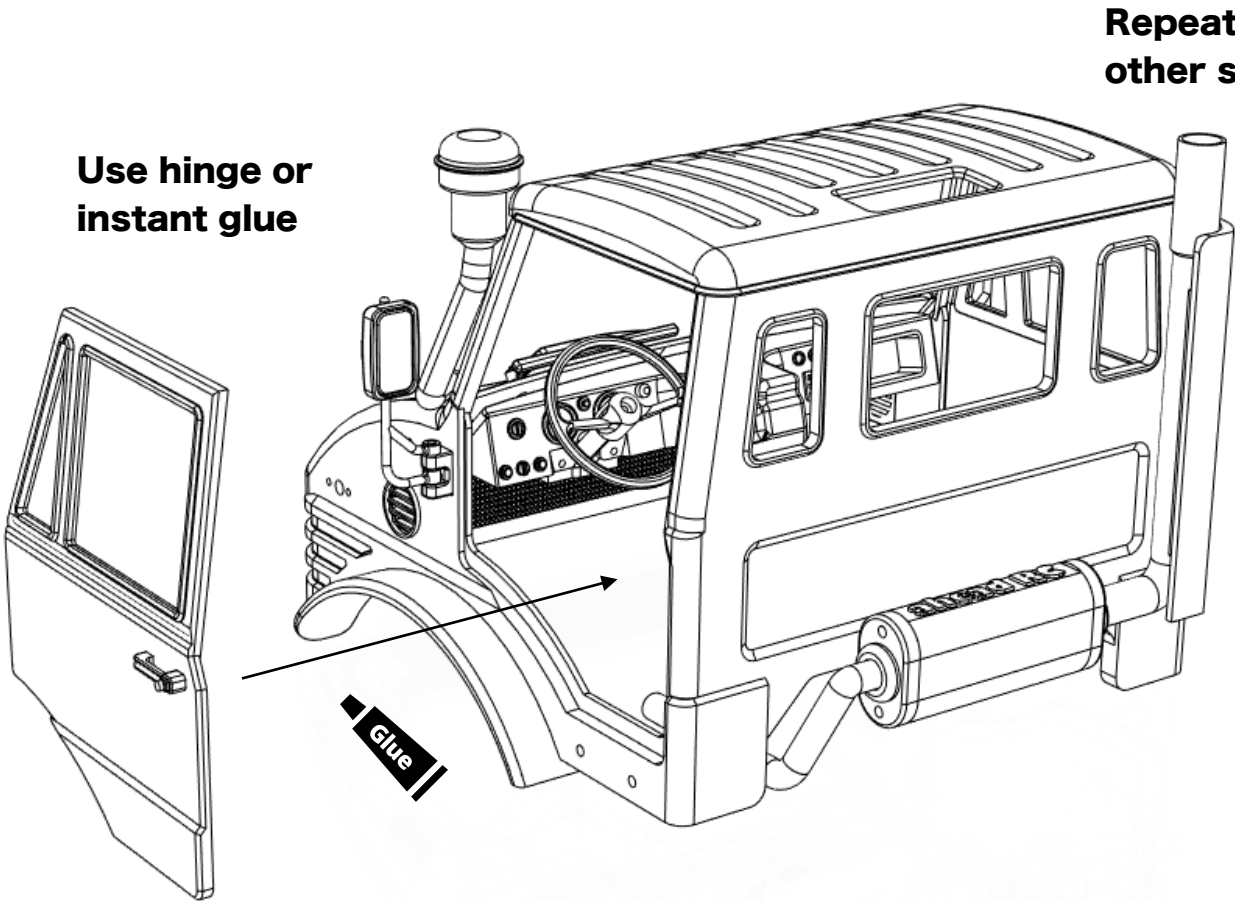

Repeat on the other side

Installing the lights

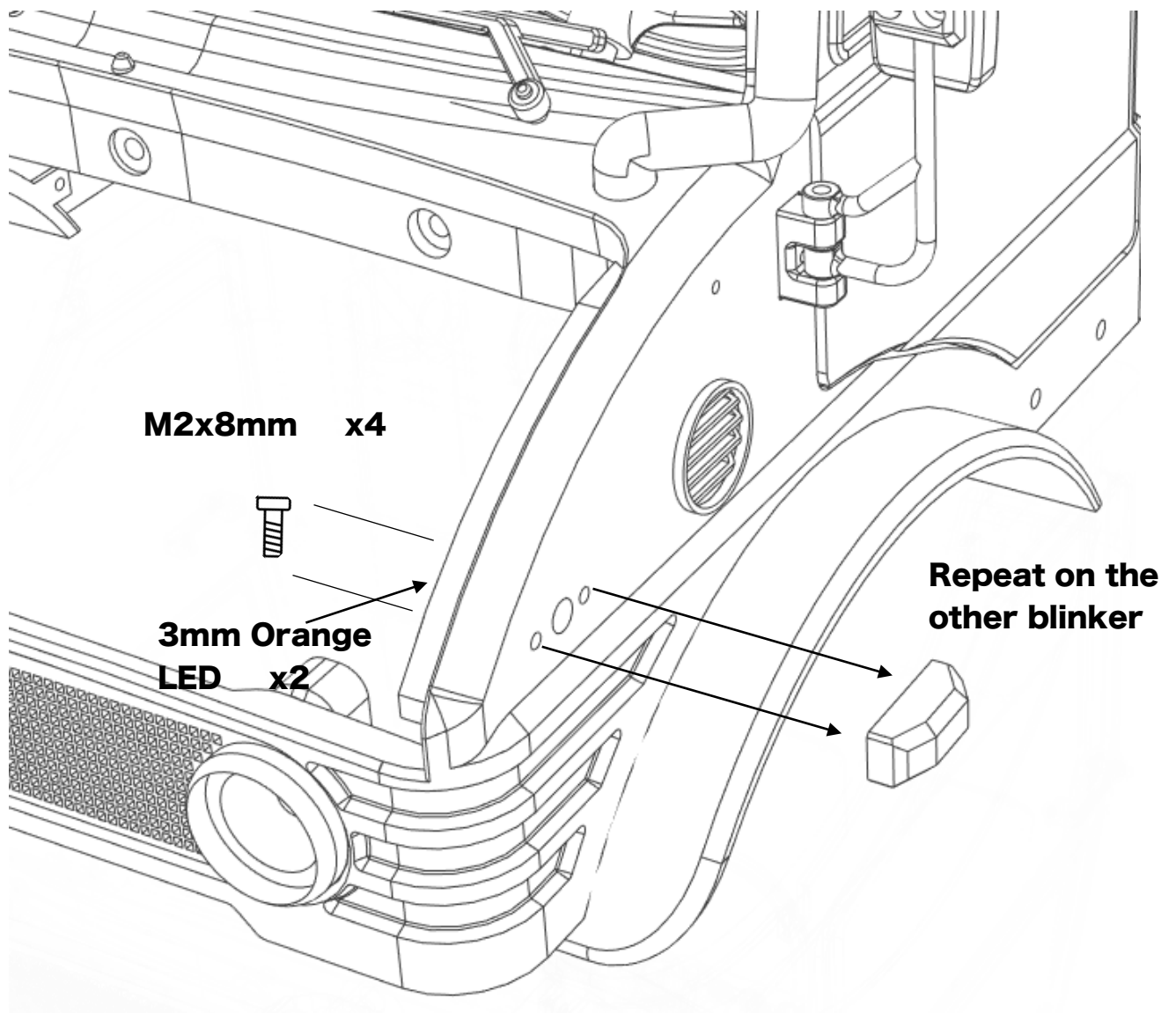

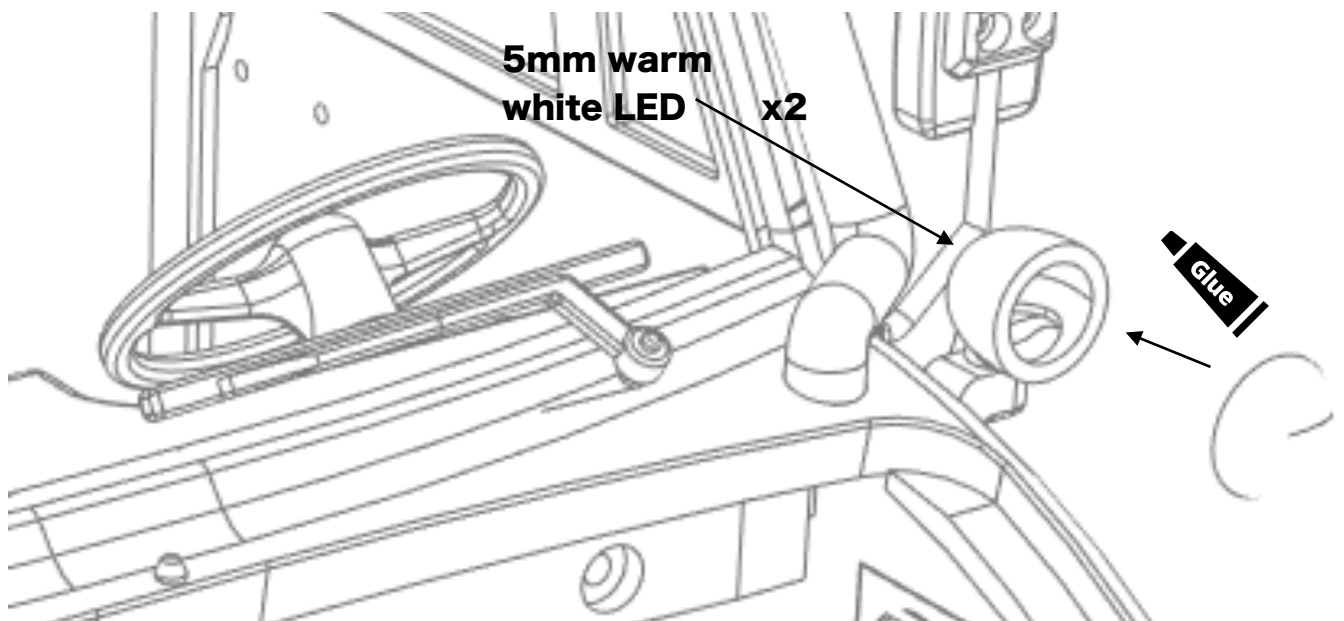
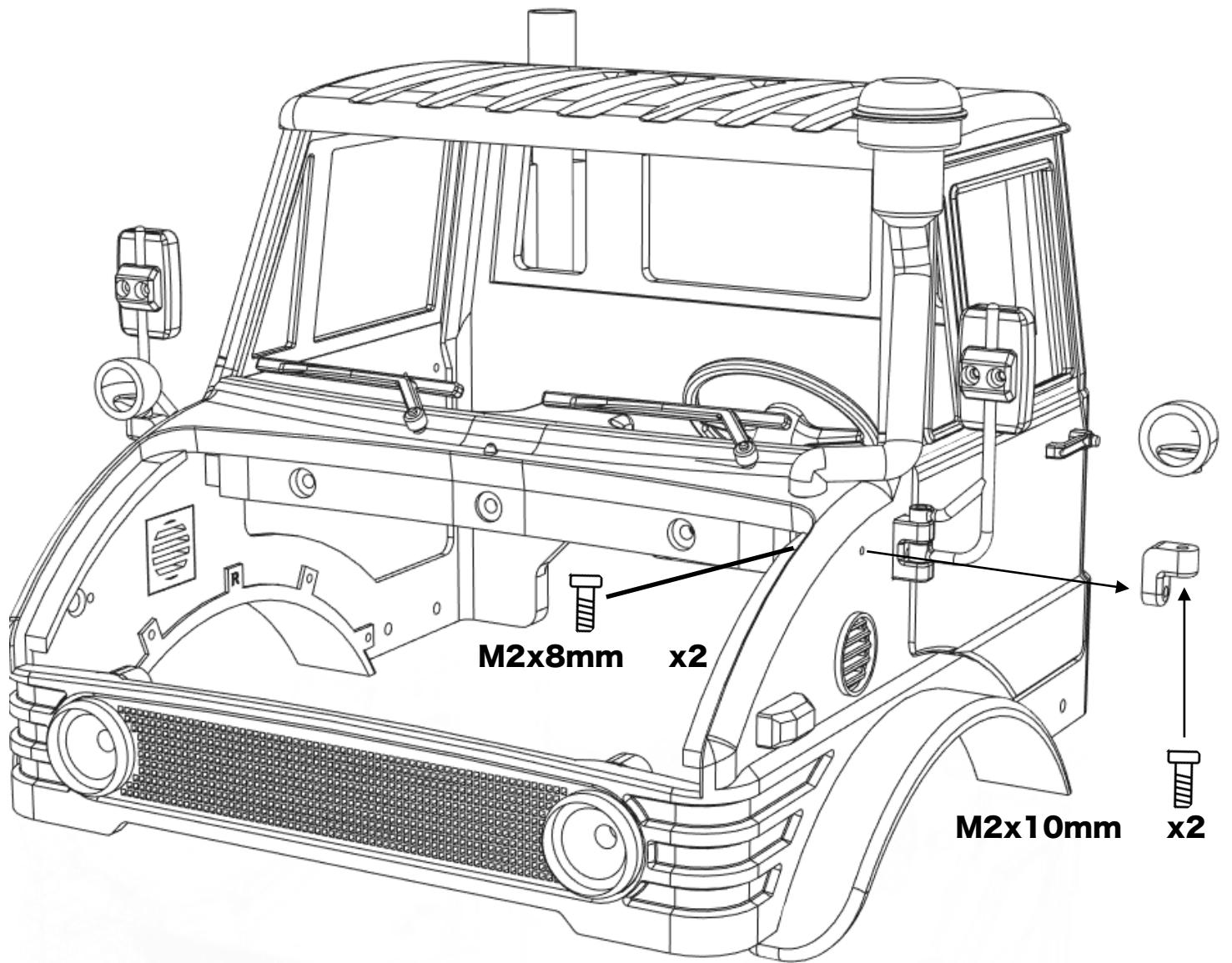

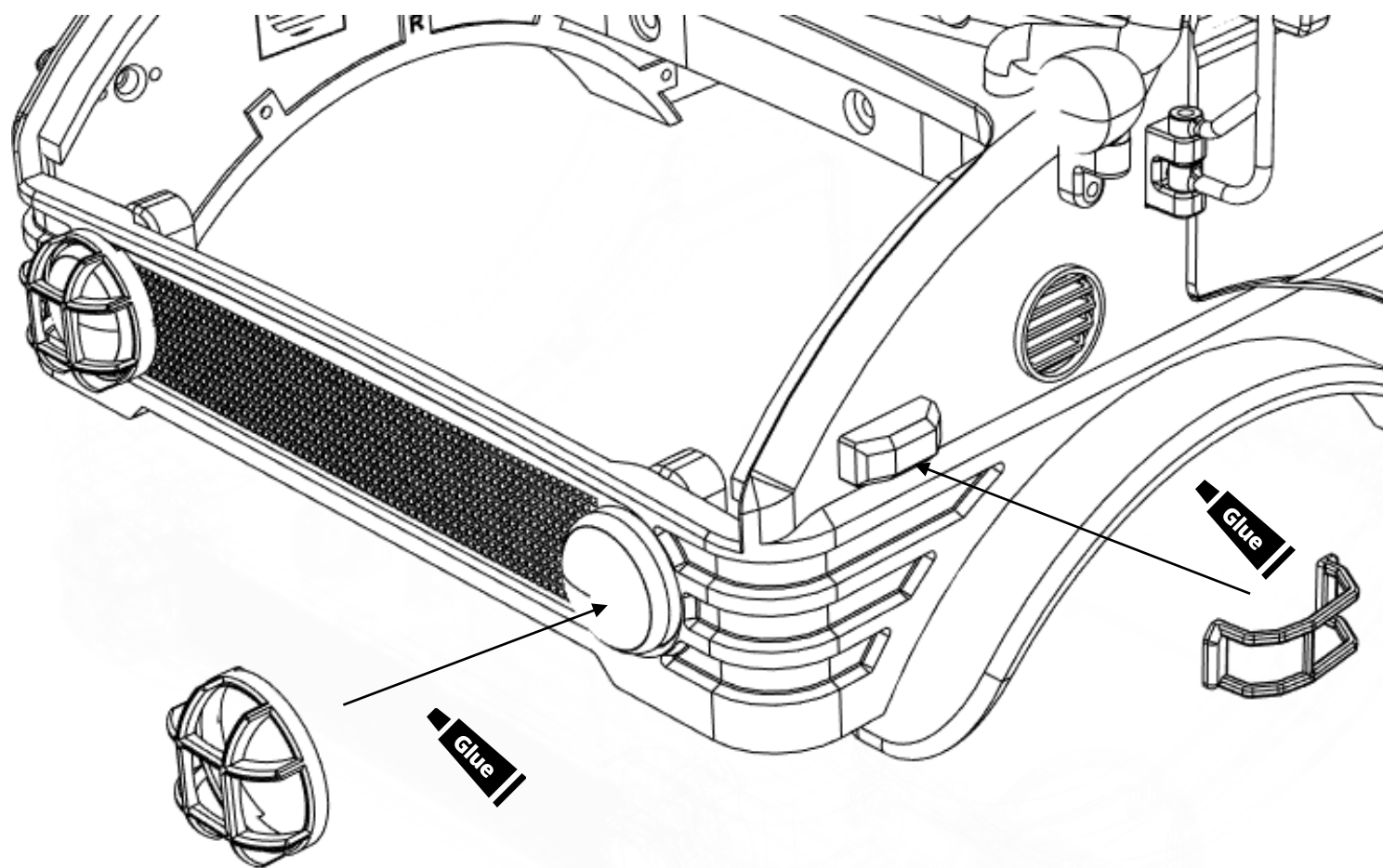
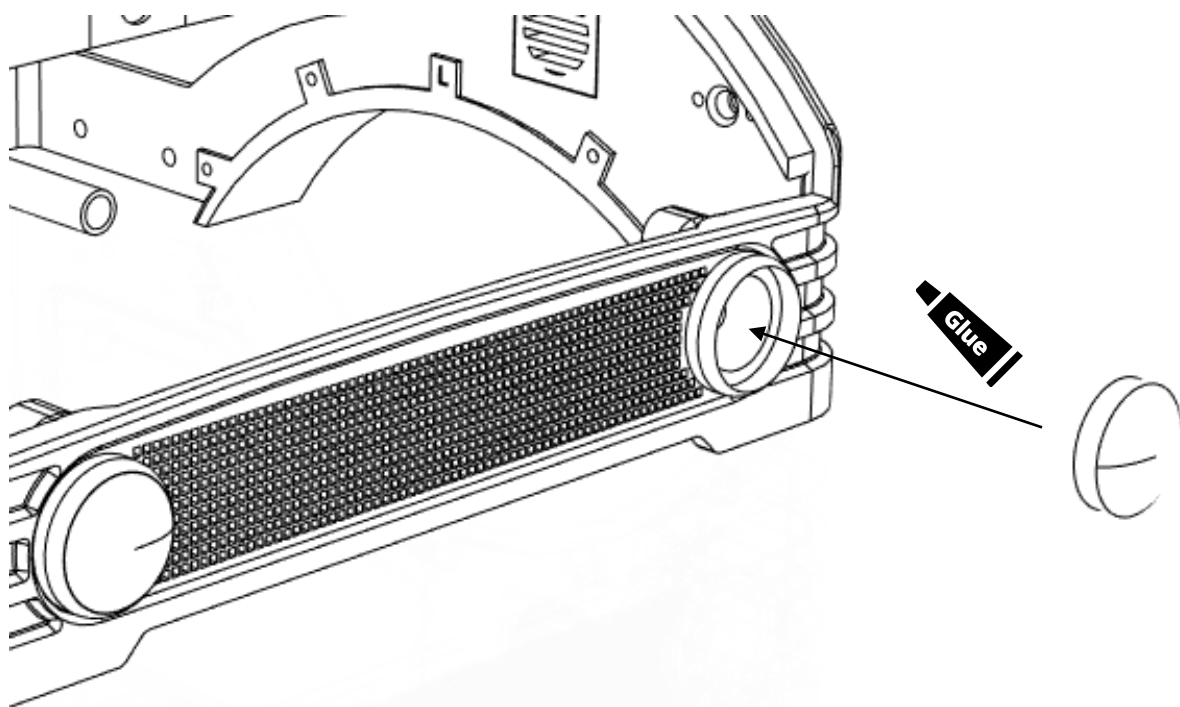

Installing the grille ornaments

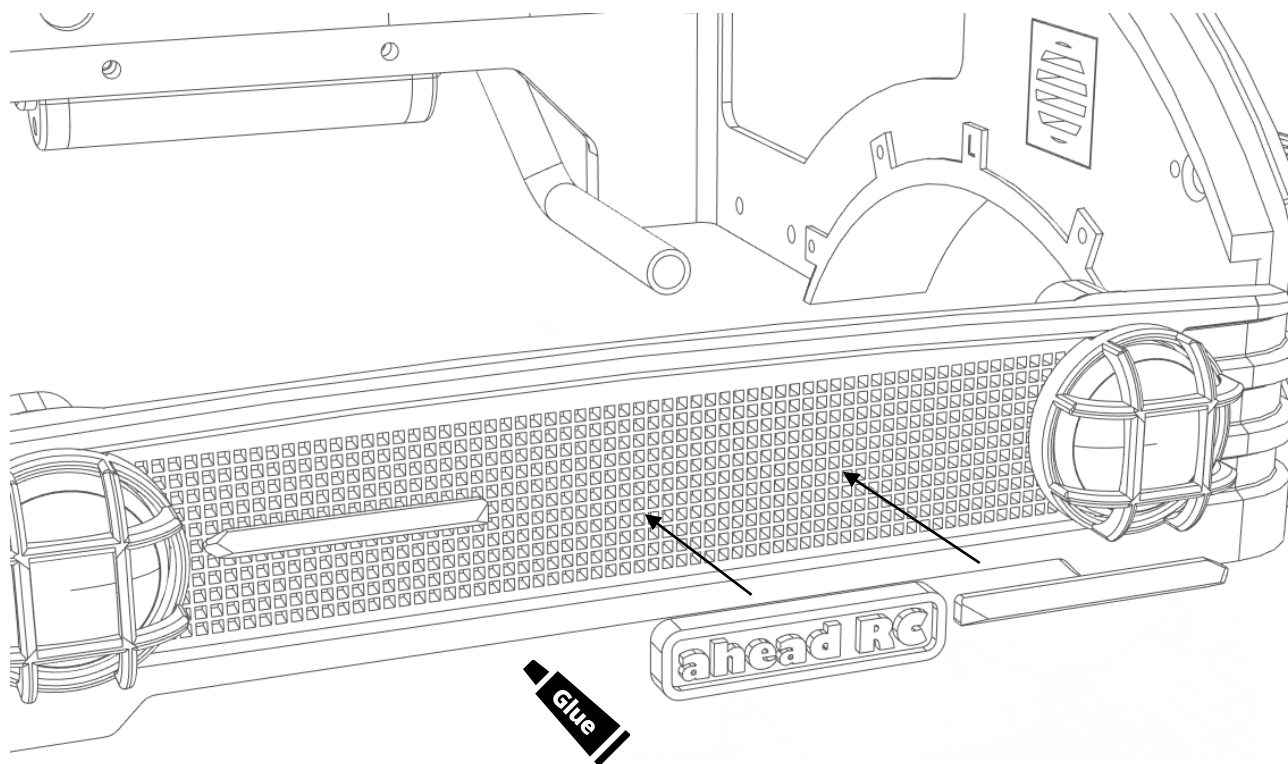

Installing the bonnet and bumper

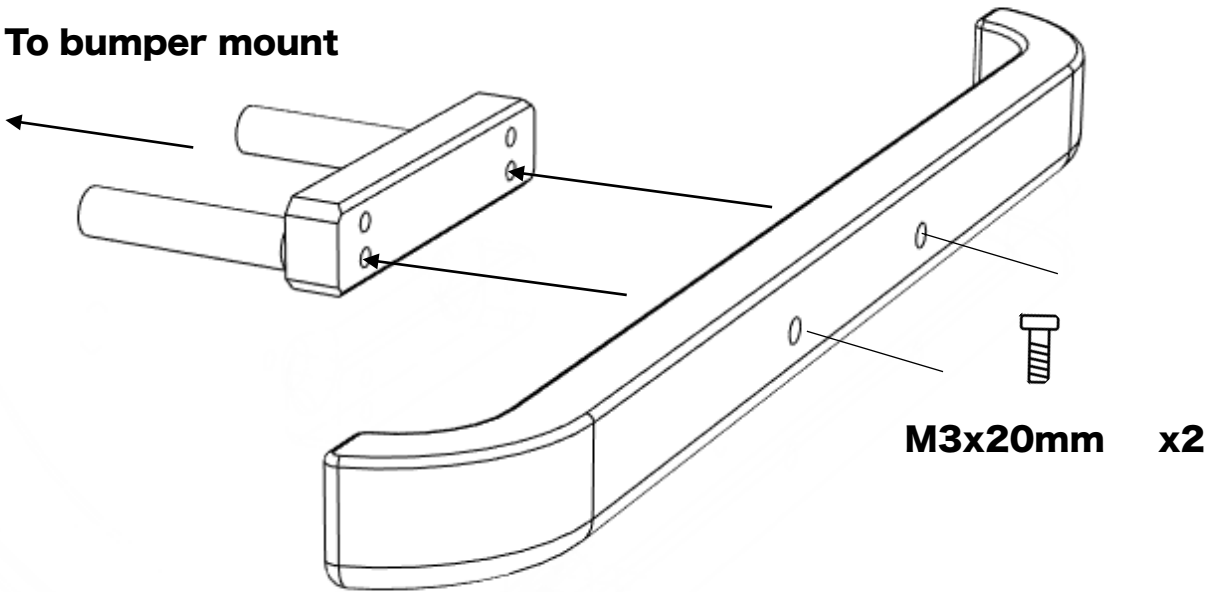
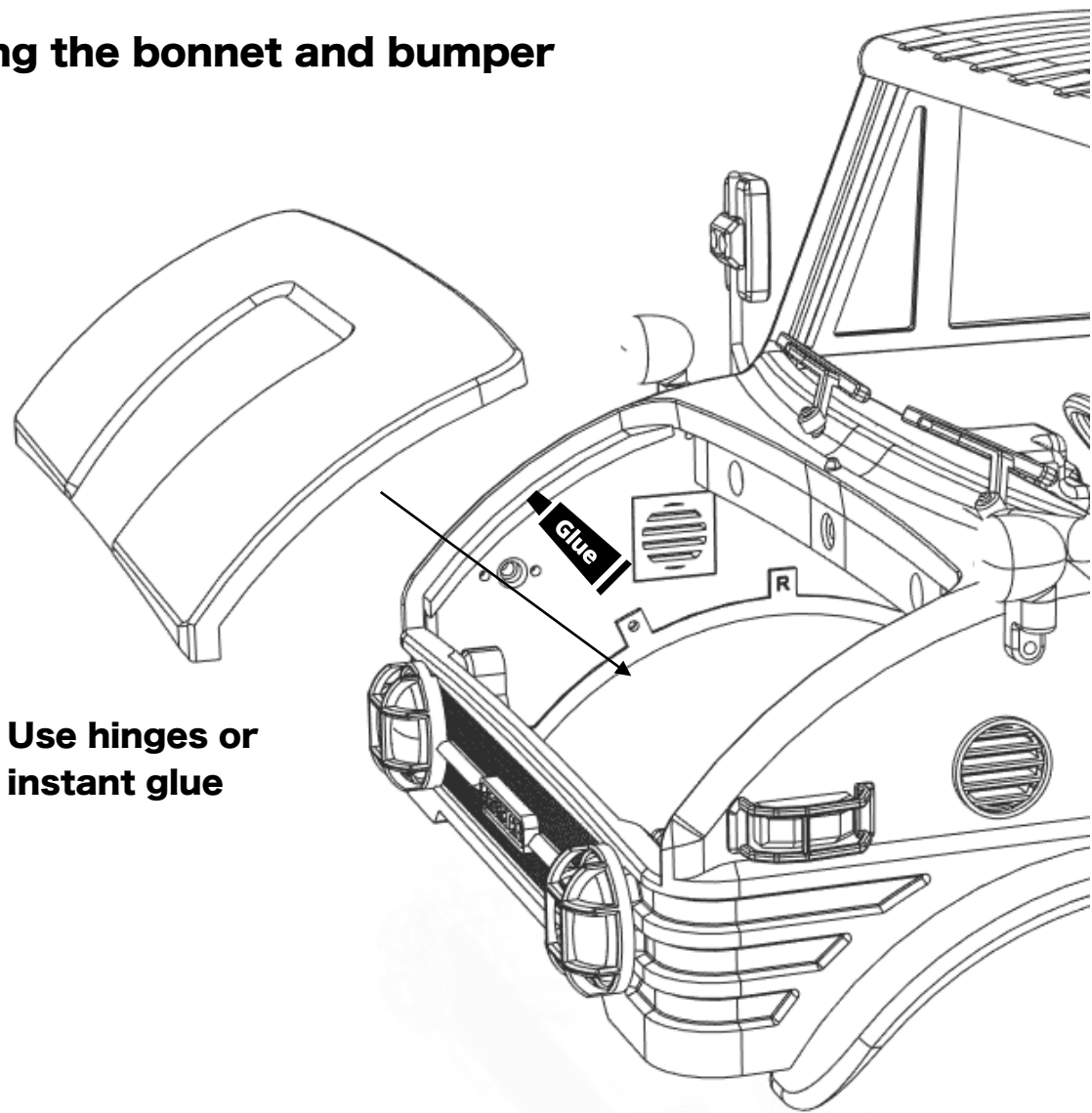

Installing the mounts

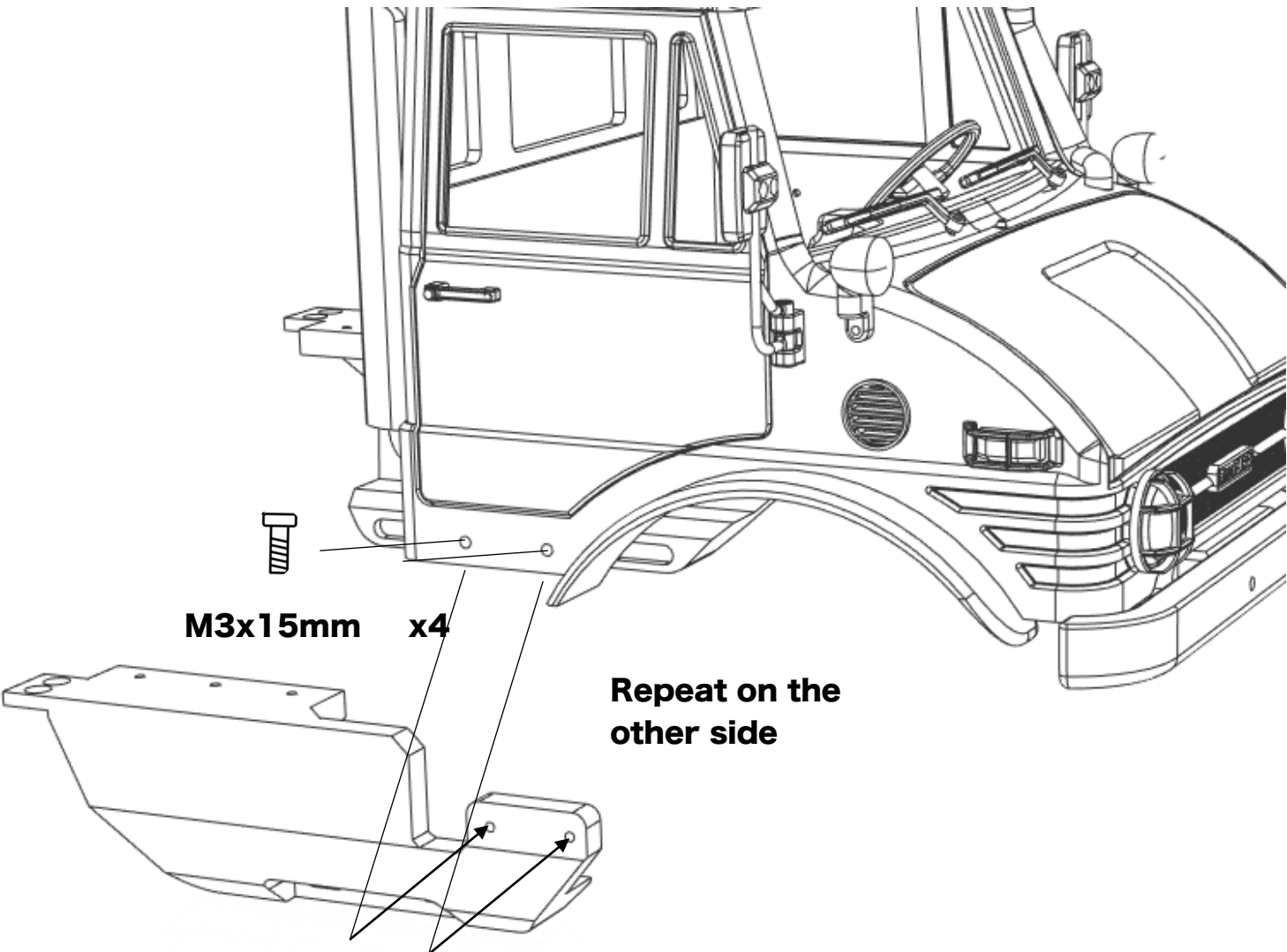

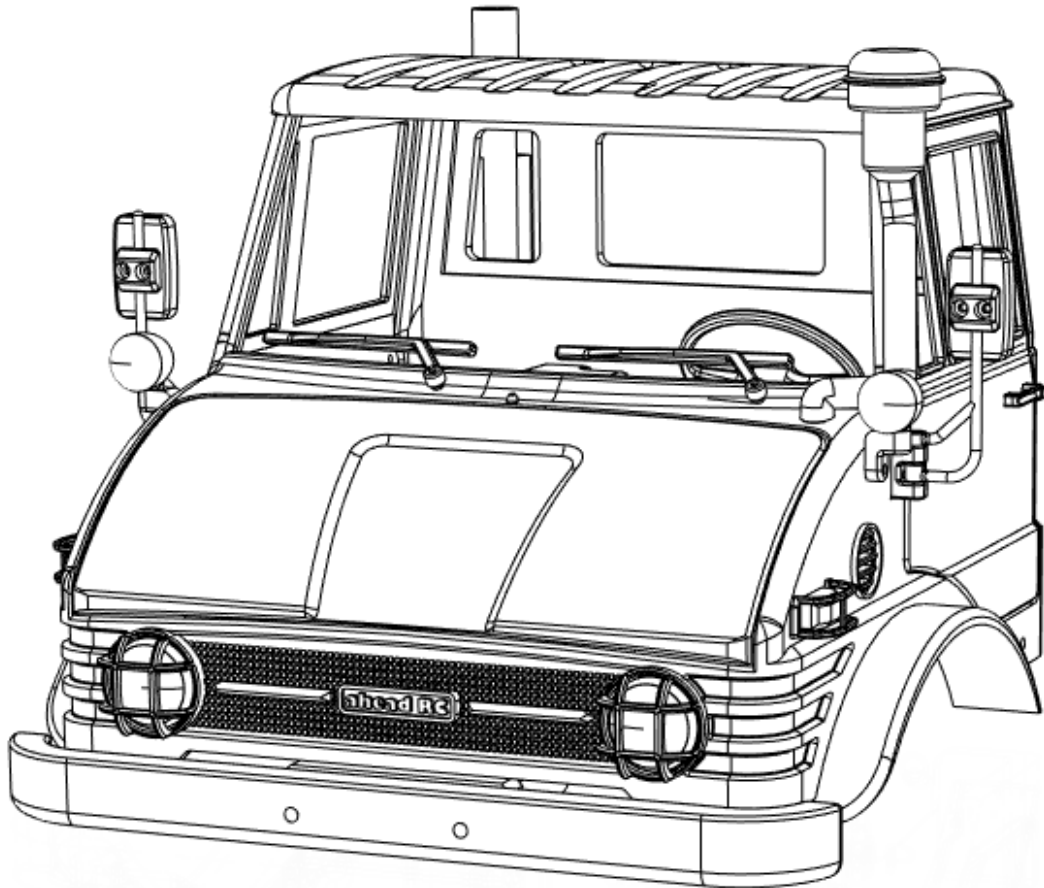

Body is now fully complete. Thank you for selecting ahead RC products.

If you have any questions or need help with the assembly, please do not hesitate to contact us at:

aheadrc@gmail.com

or visit us at:

www.aheadrc.com

Best of luck with your build!