

# **ahead RC** Crawler G3308

## “Adventurer”

### Assembly Manual

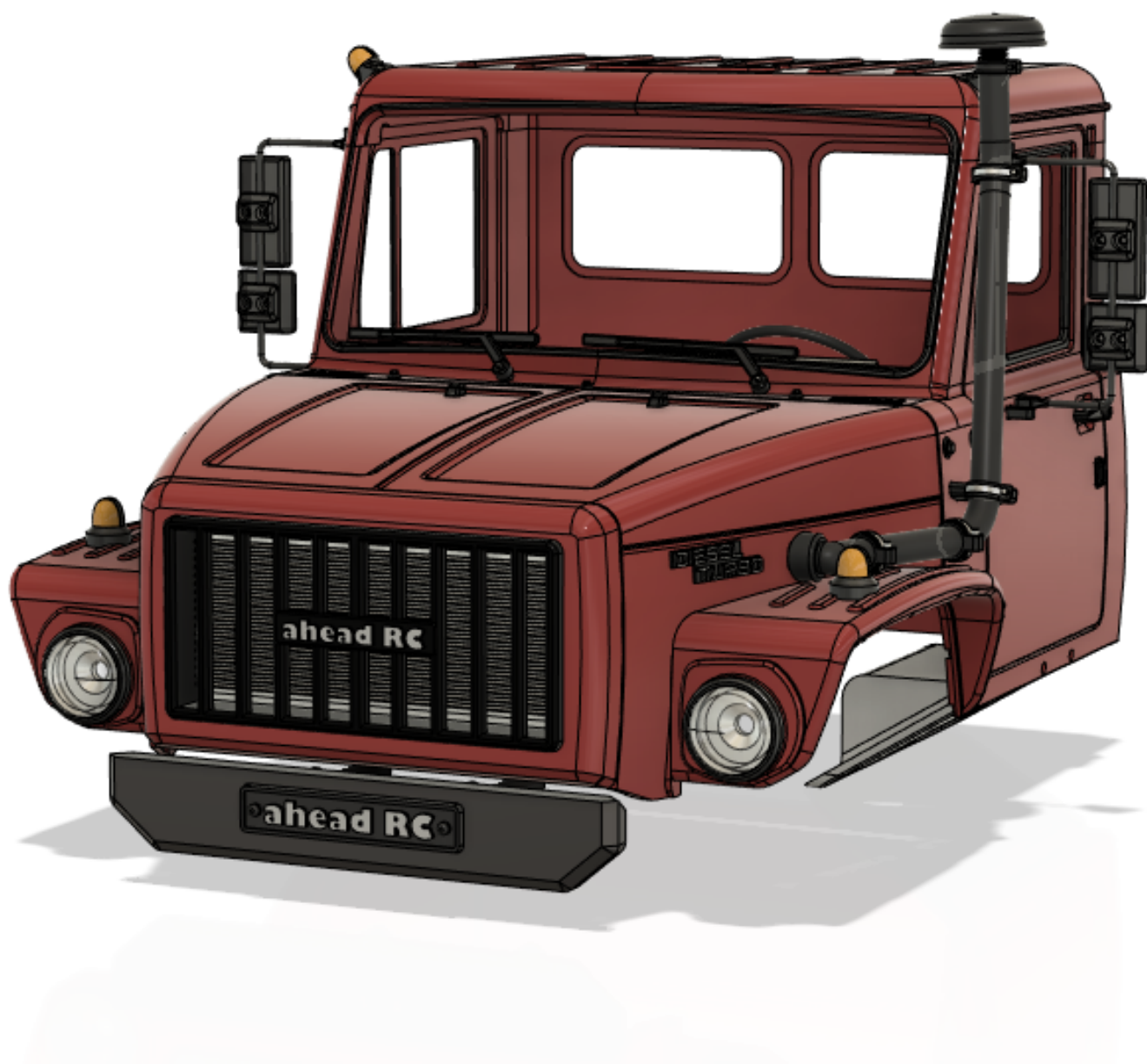

## Required tools and hardware

### Tools

- 1.5mm Hex Driver
- 2.0mm Hex Driver
- 2.5mm Hex Driver
- Needle Nosed Pliers
- Instant Glue
- Hot Glue

### Electronics

- 5mm White LED x2
- 3mm Orange LED x6

### Hardware

Hardware	Quantity	Check ✓
M2*5 Socket head	12	
M2*10 Socket head	17	
M3*8 Socket head	4	
M3*10 Socket head	1	
M3*15 Socket head	4	
M3*20 Button head (BH)	2	
M3*10 Grub screw (GS)	2	
M3*20 Grub screw (GS)	1	

# Before you begin

- Be sure to read through the manual and familiarise yourself with the instructions
- Visualise a plan to assemble all the pieces
- Make sure you have all of the hardware and tools
- Be sure to have enough instant glue
- Dry fit all parts before painting and assembling

**Tip:** It will help to paint all of the parts before final assembly

## Combining and assembling the split cab and fenders

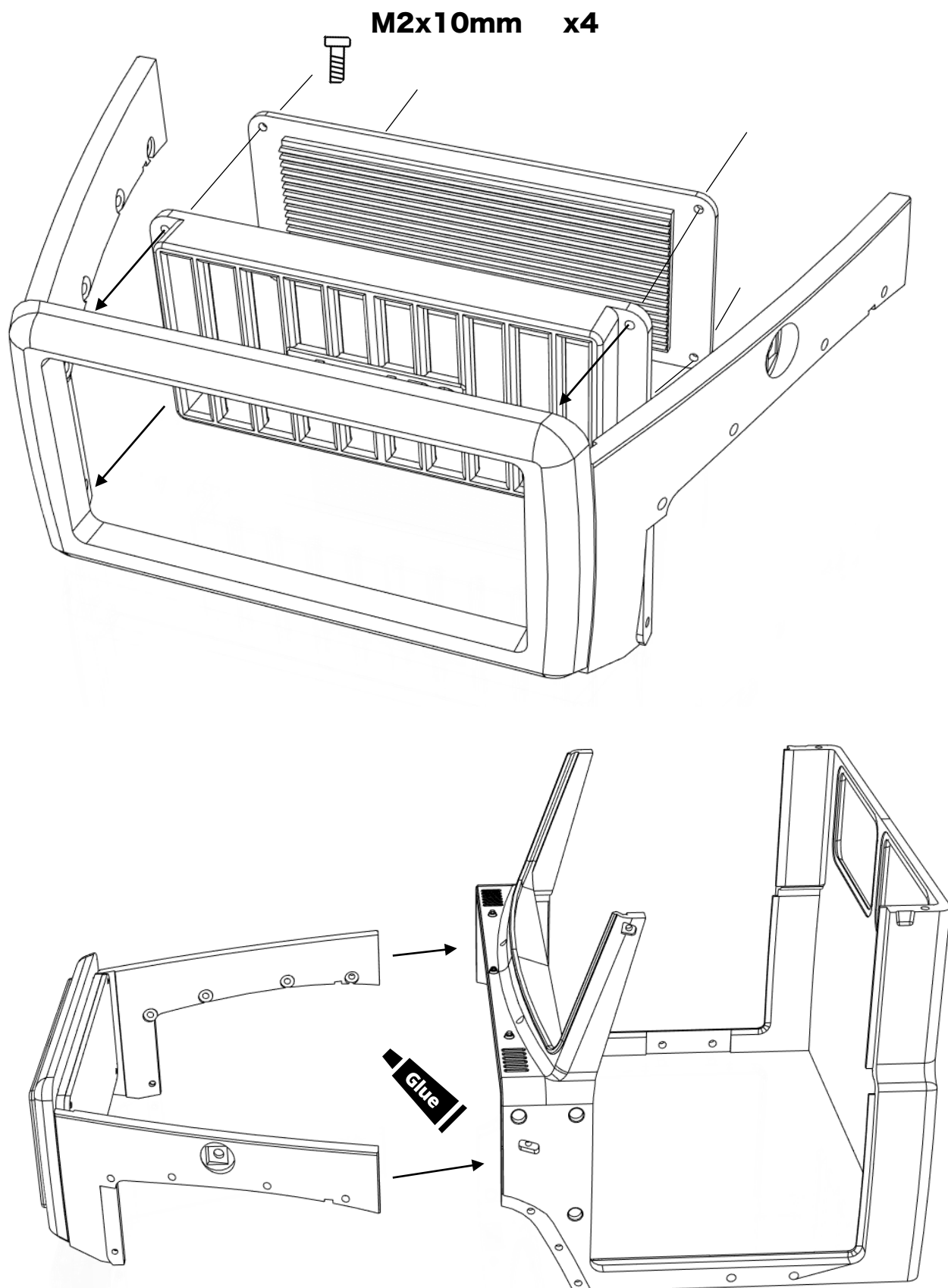

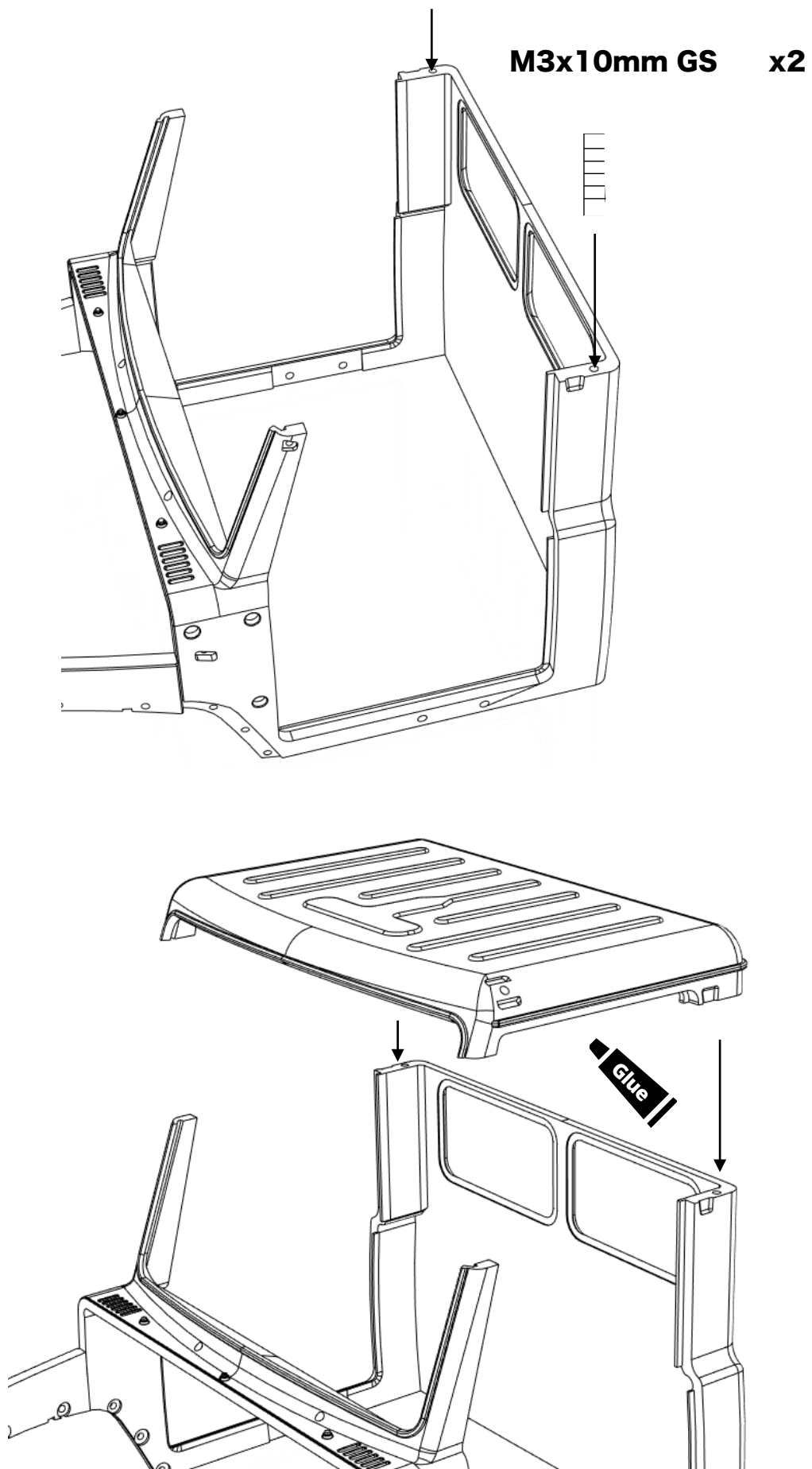

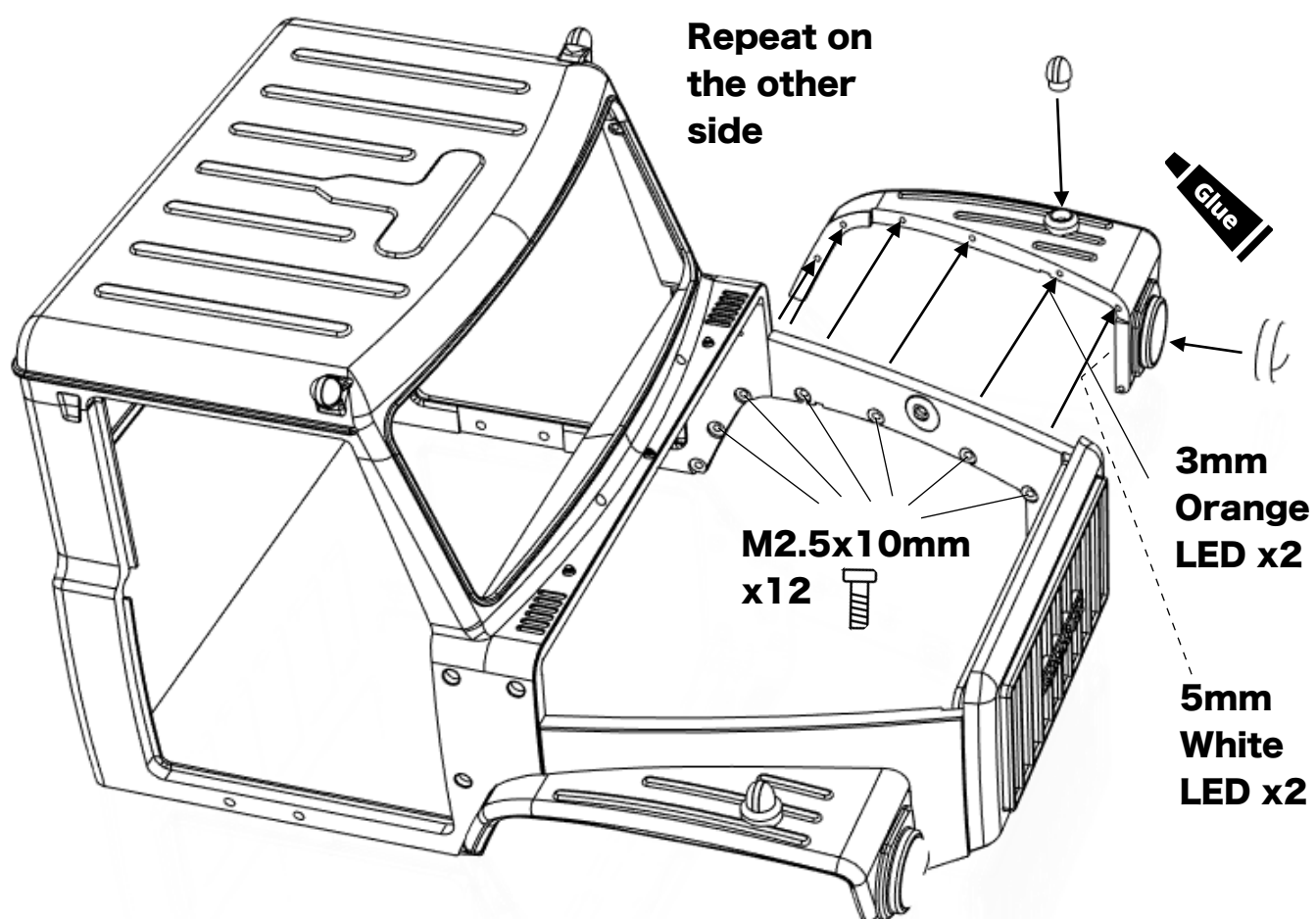
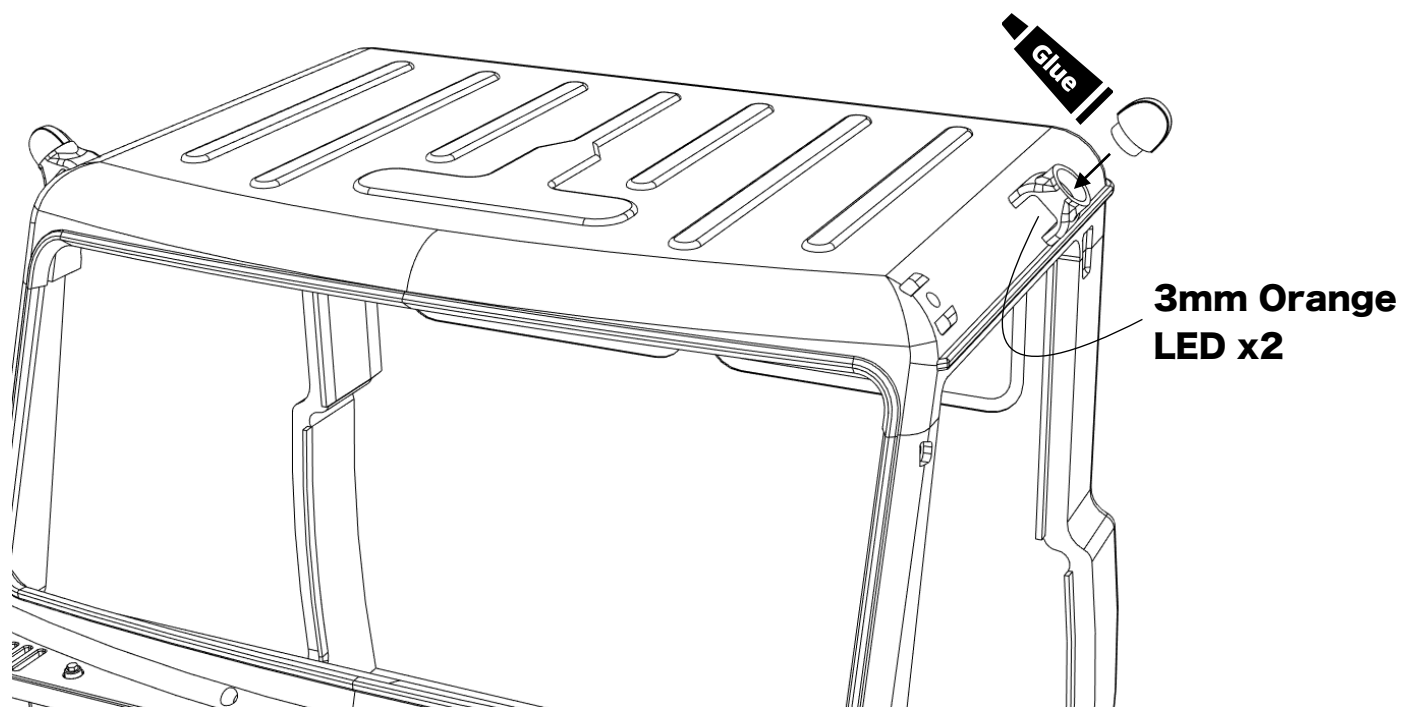

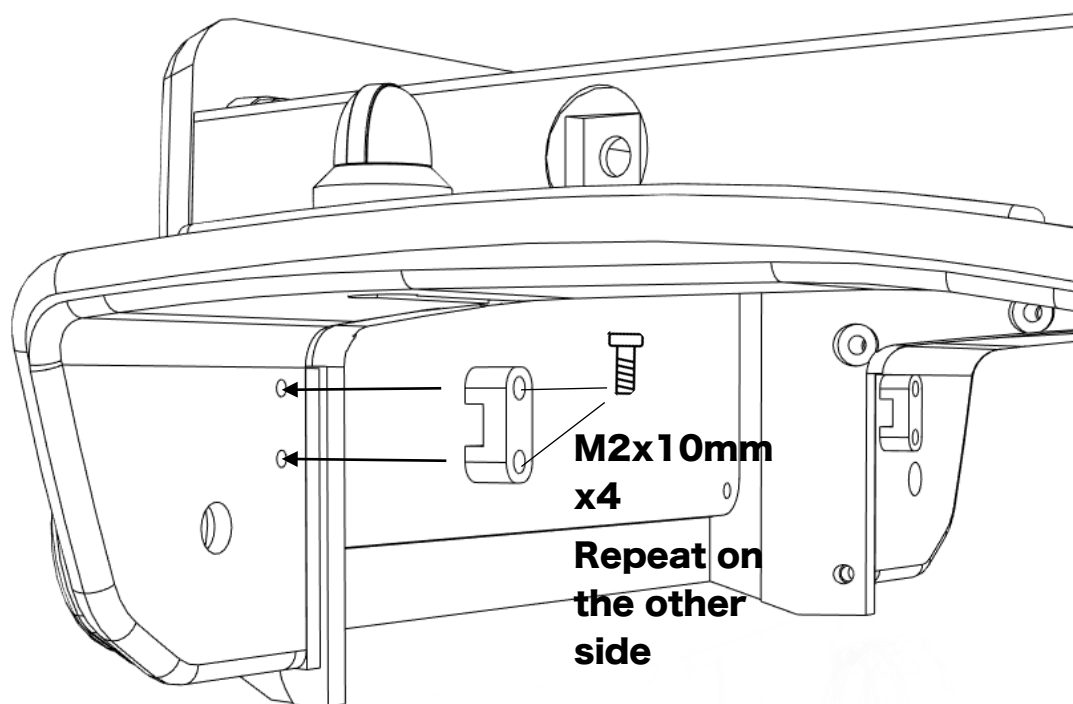

Assembling the dashboard

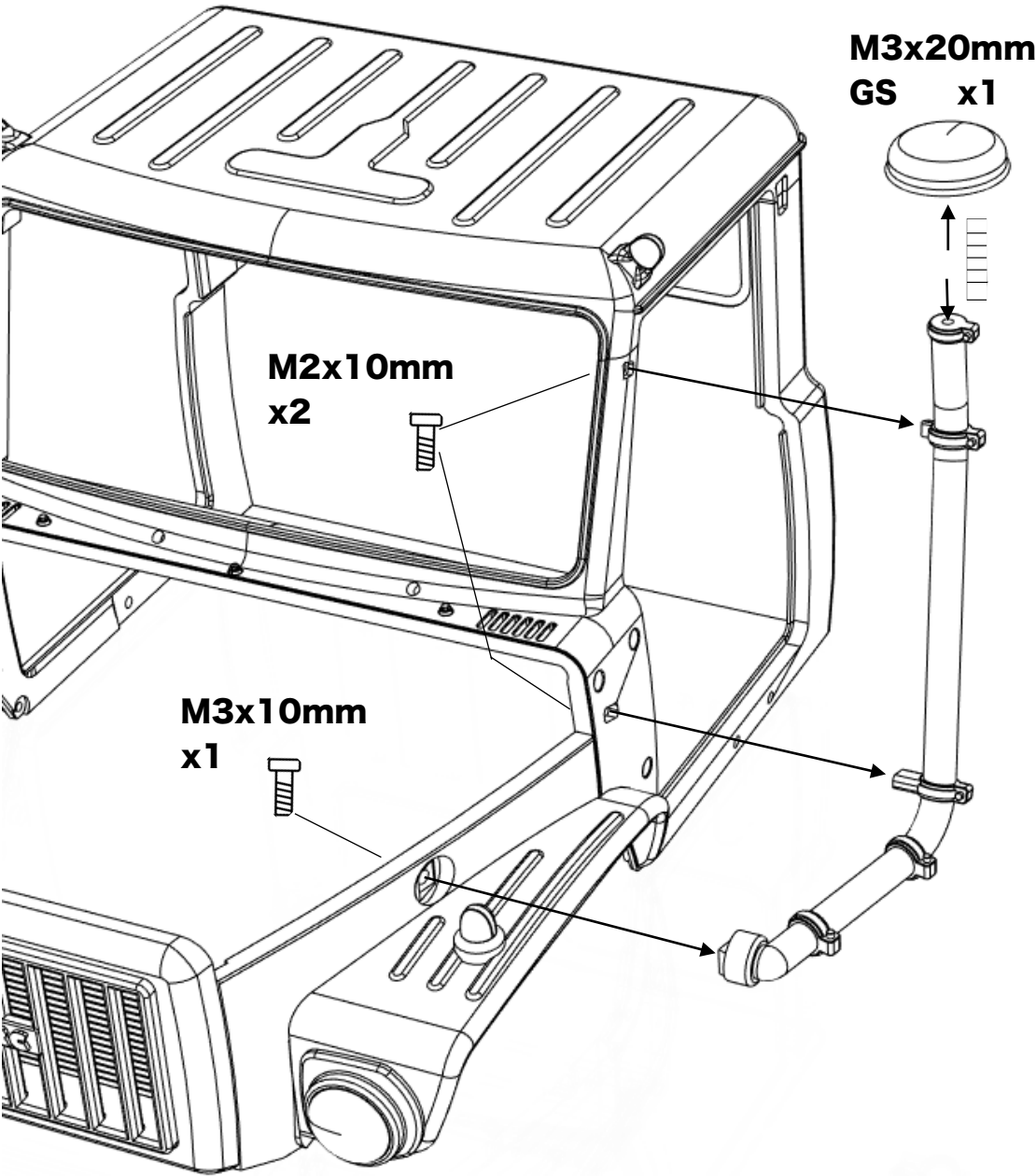



## Assembling the dashboard

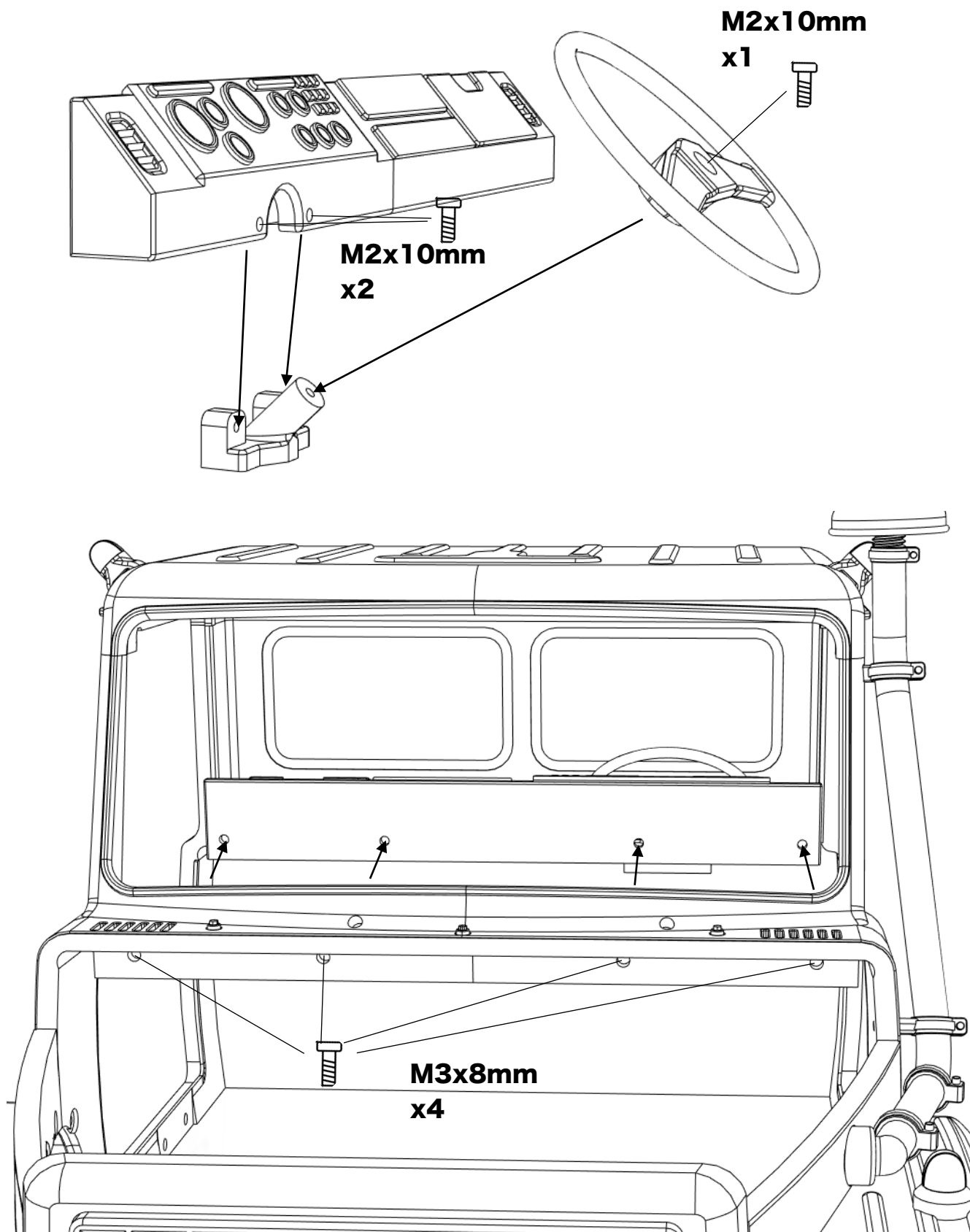

## Assembling the door and mirrors

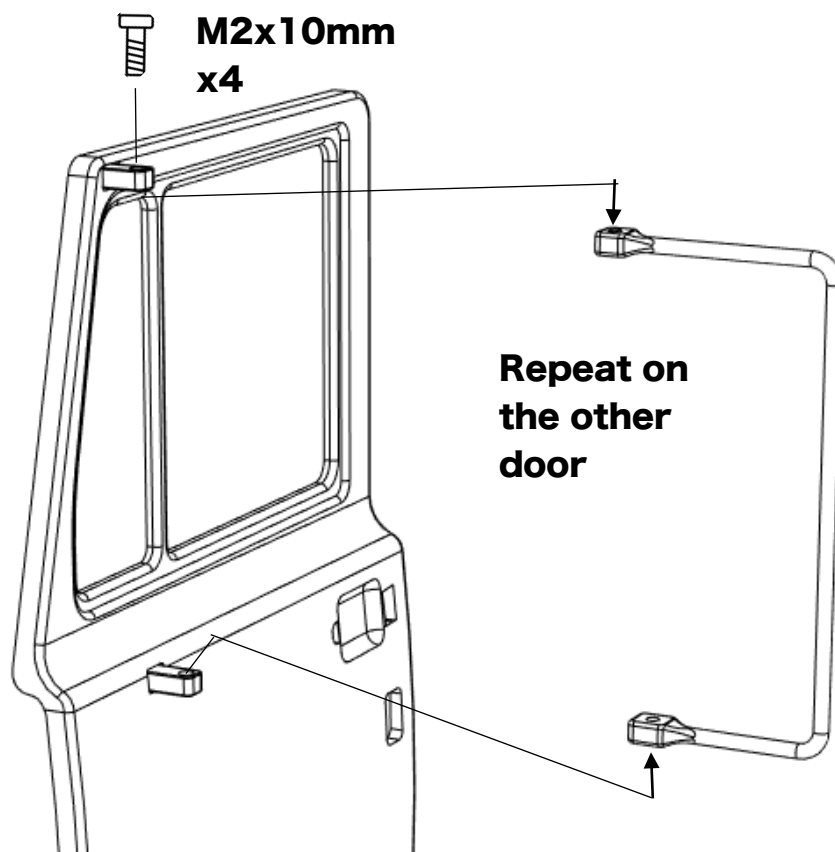
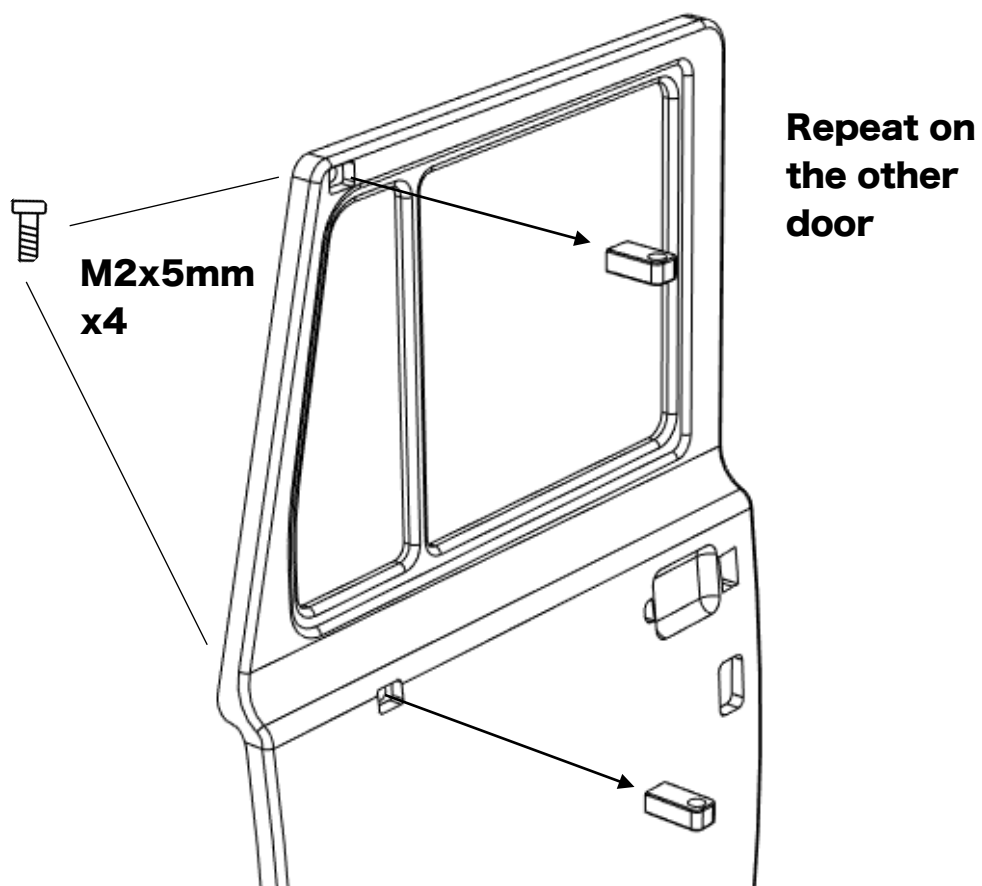

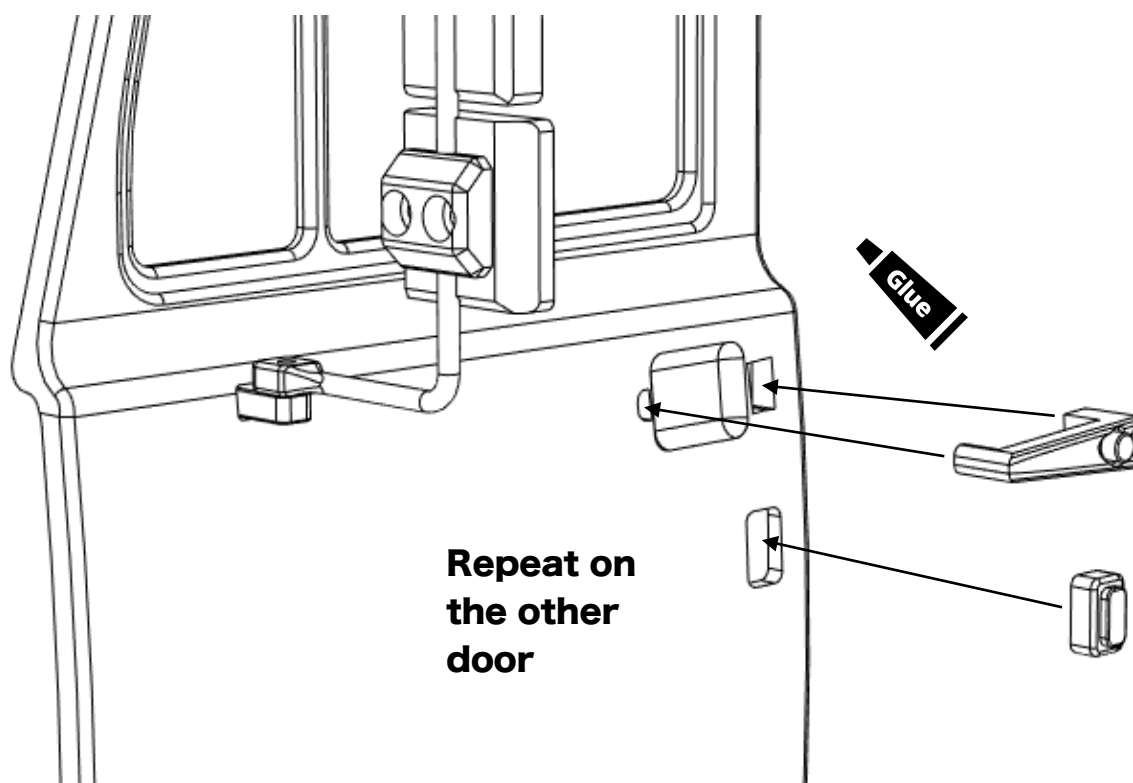
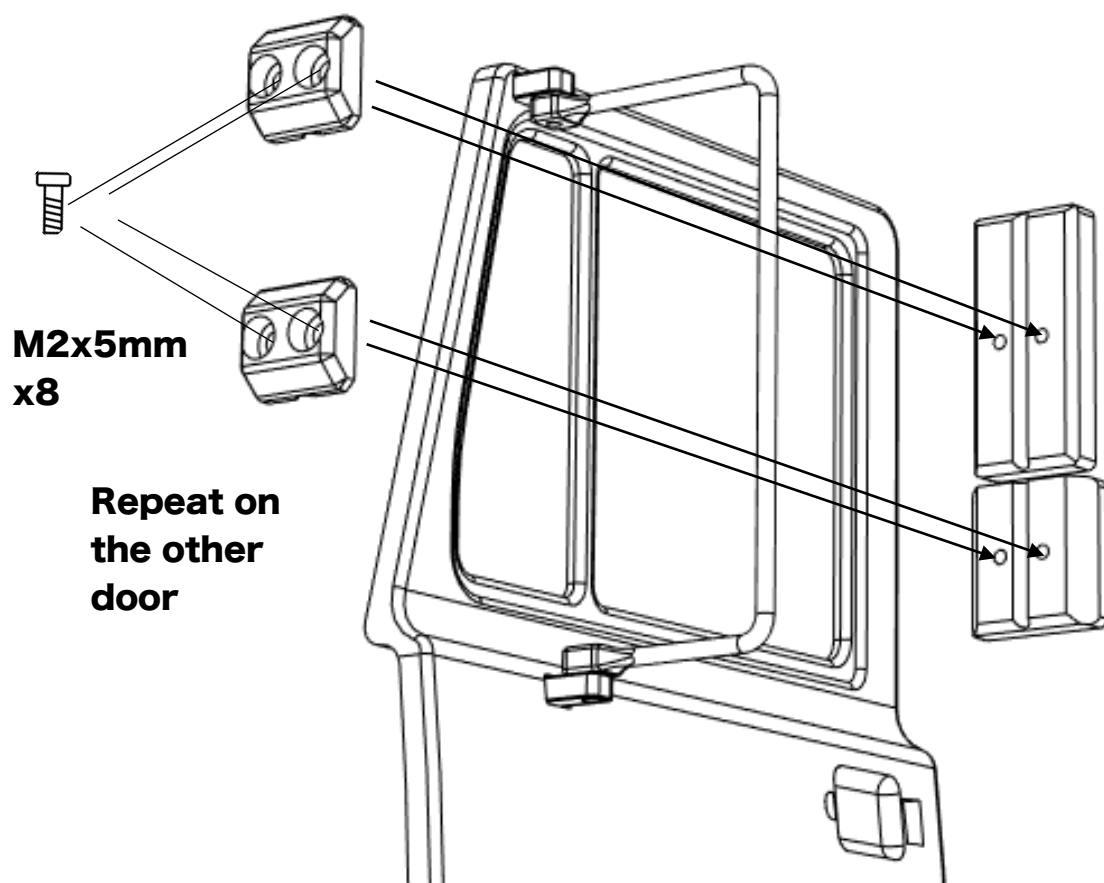

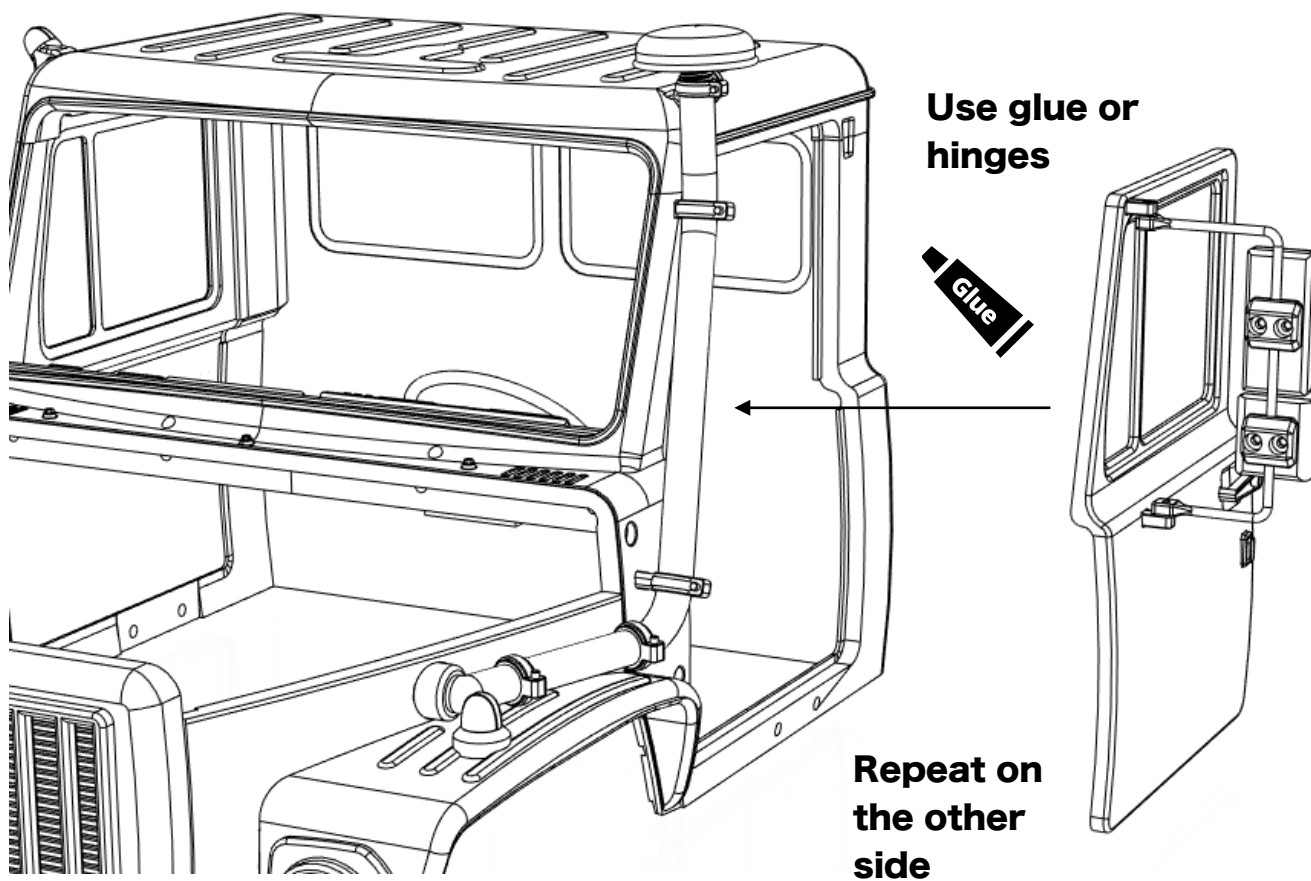

## Adding the details

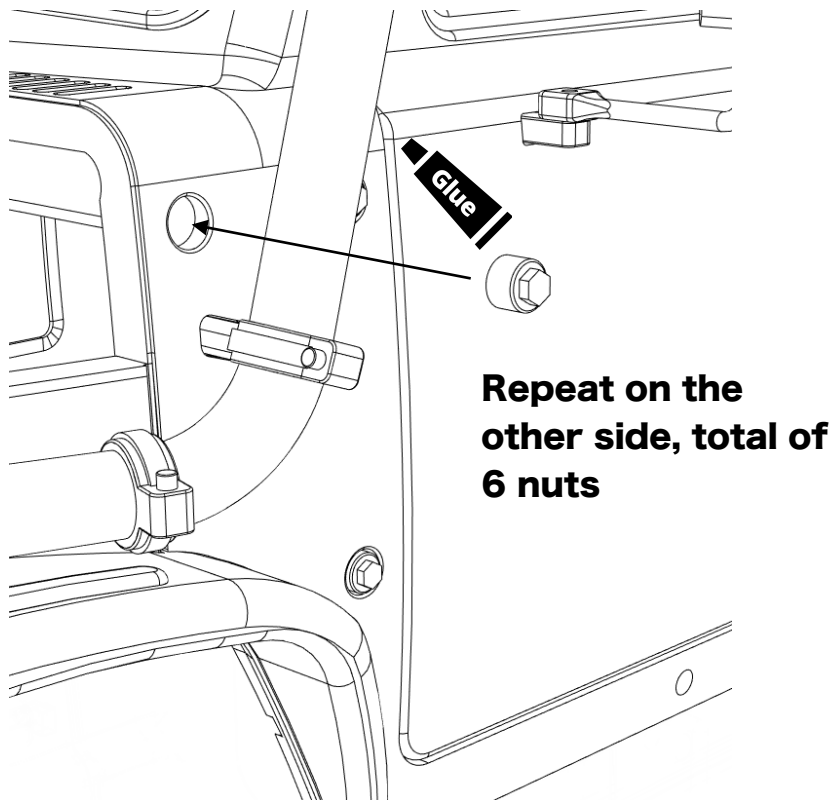
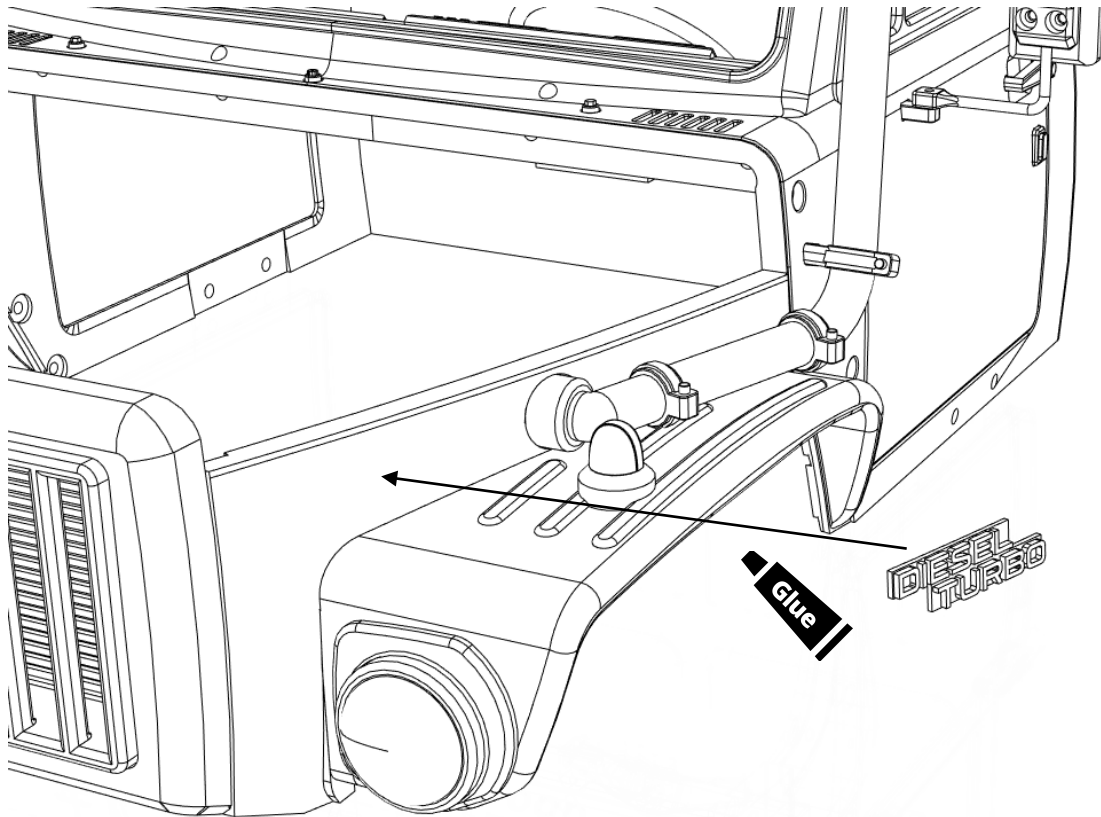

**Repeat on the  
other wiper**

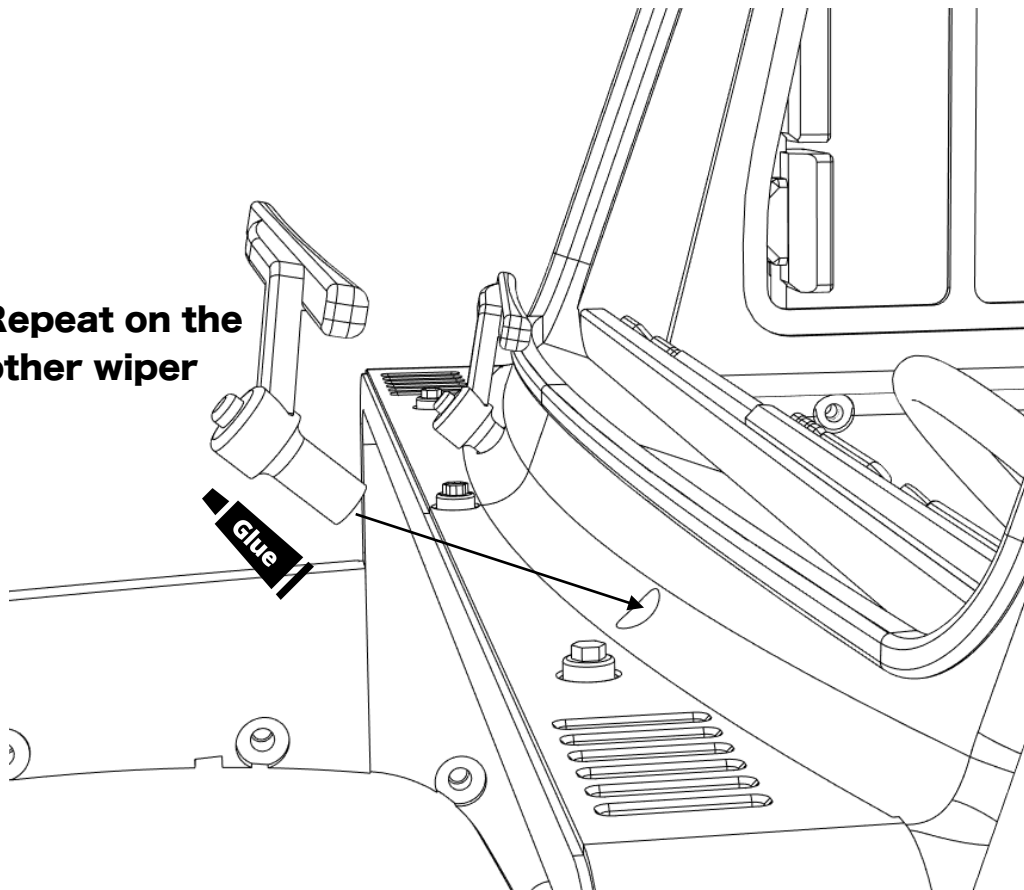

## Assembling and mounting the bumper

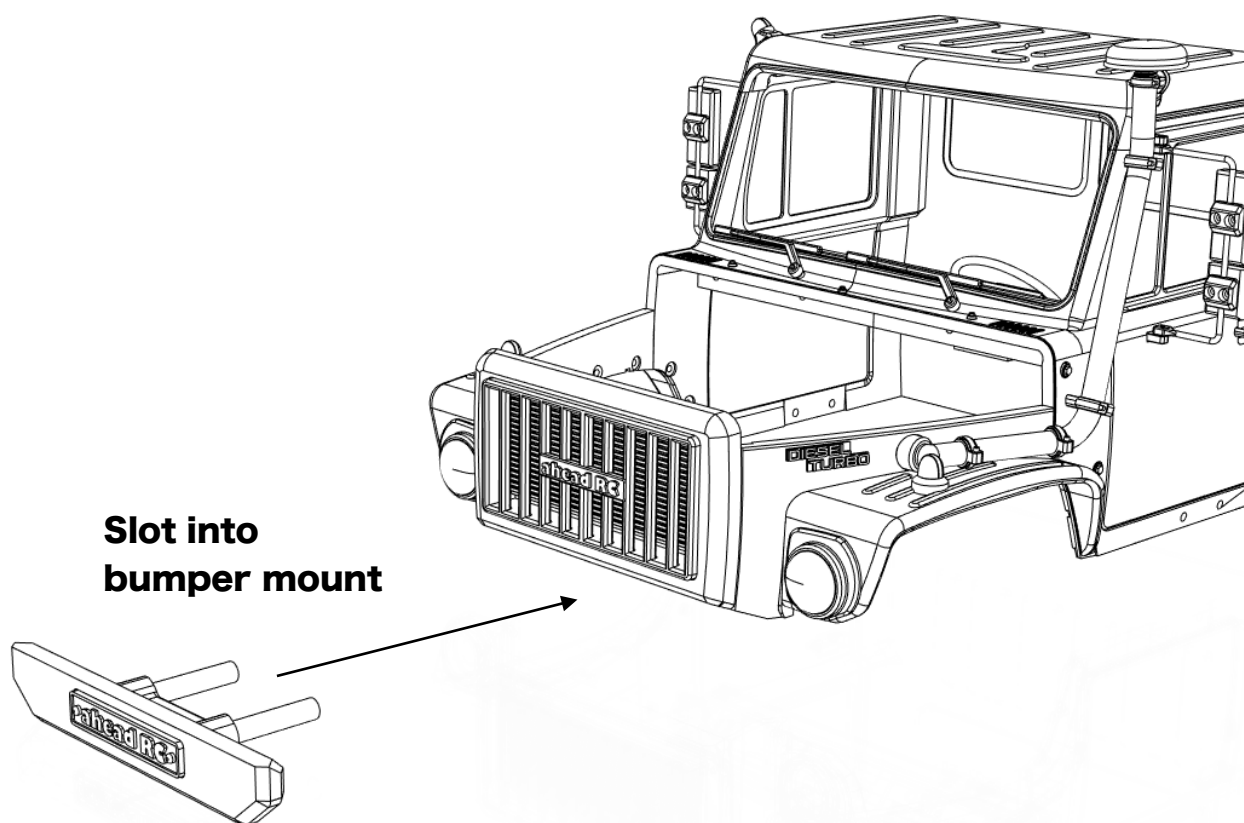
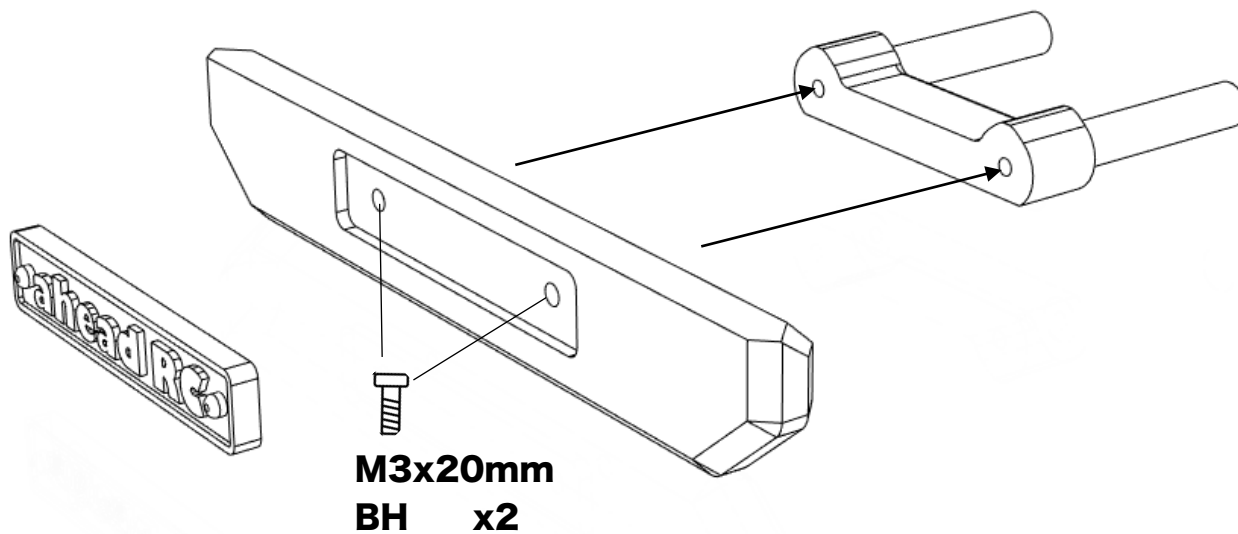

## Mounting the bonnet

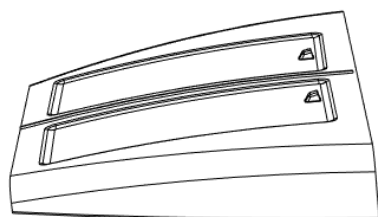

**Use glue or  
hinges**

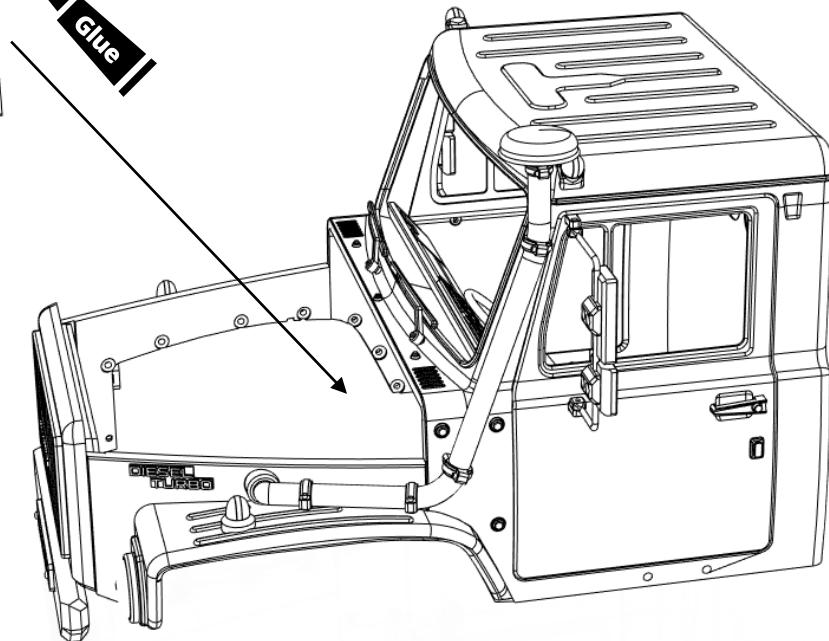



## Installing the body mounts

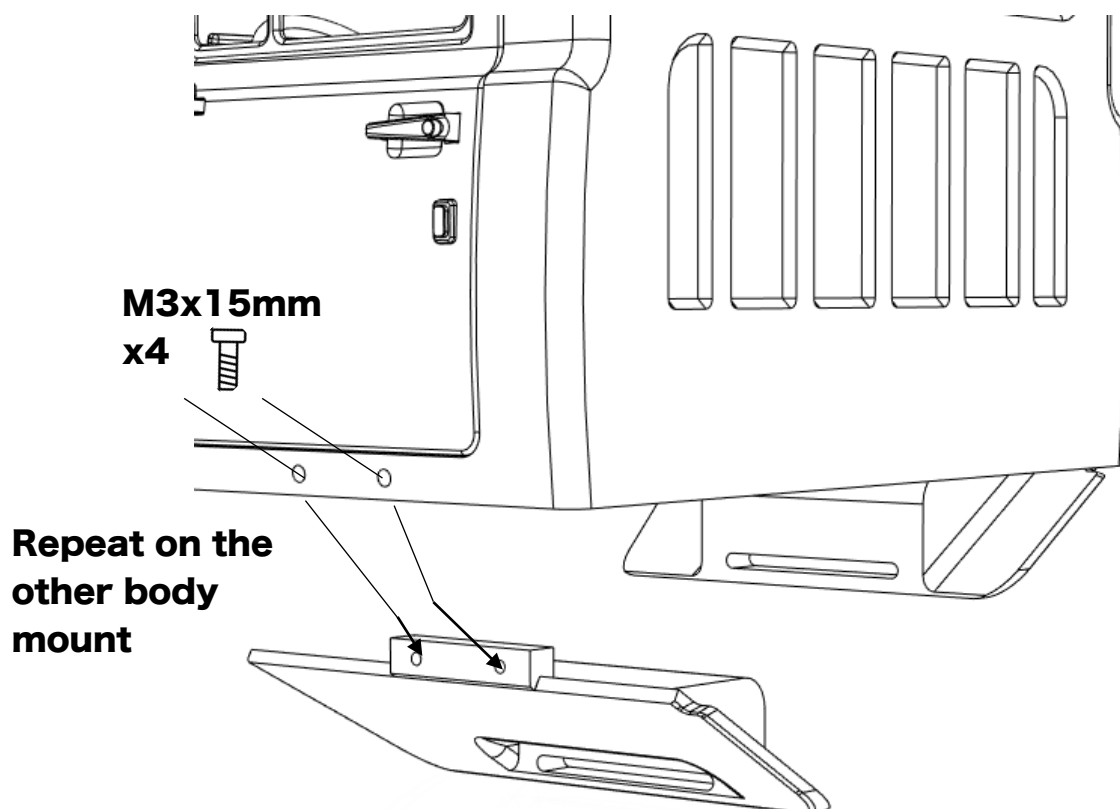

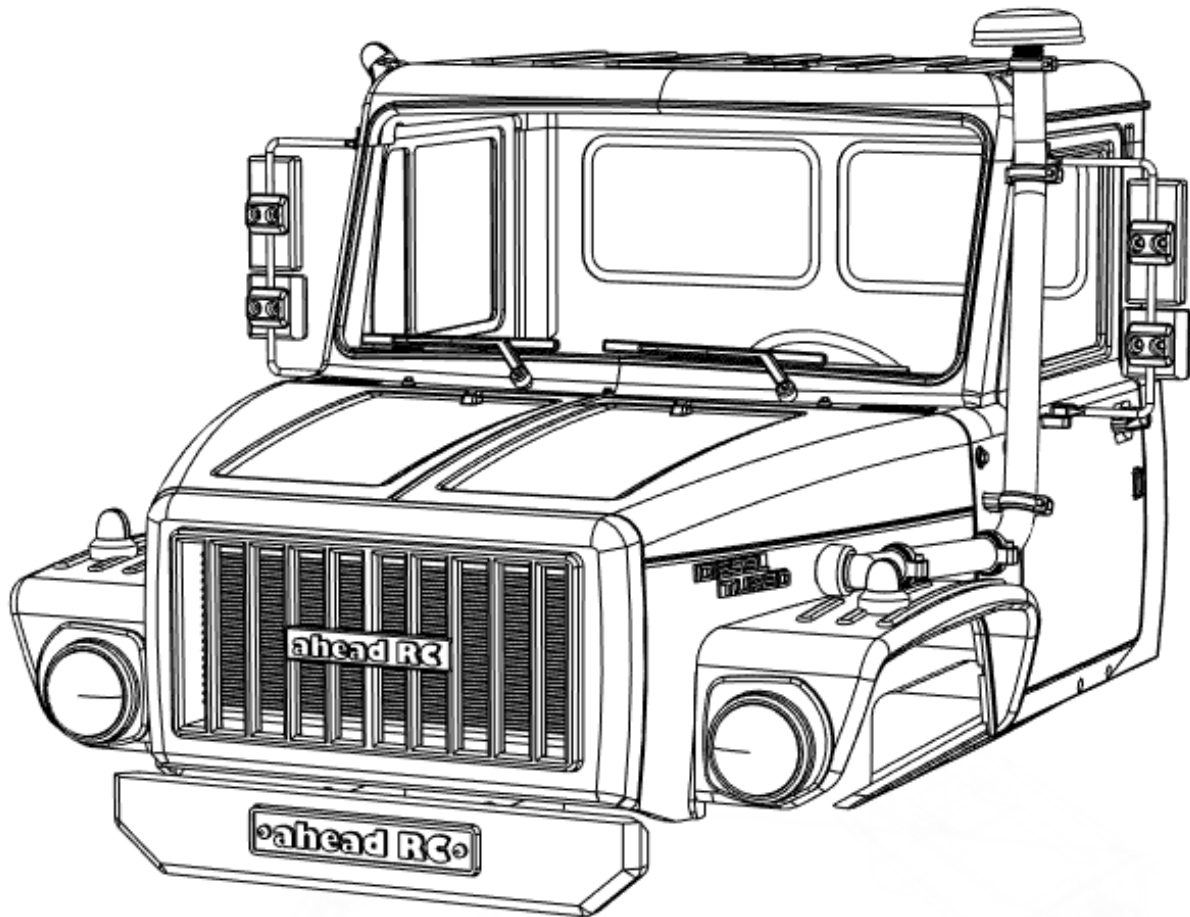

Body is now fully complete. Thank you for selecting ahead RC products.

If you have any questions or need help with the assembly, please do not hesitate to contact us at:

[aheadrc@gmail.com](mailto:aheadrc@gmail.com)

or visit us at:

[www.aheadrc.com](http://www.aheadrc.com)

## Best of luck with your build!