

ahead RC Crawler Bog 406

Flatbed

Assembly Manual

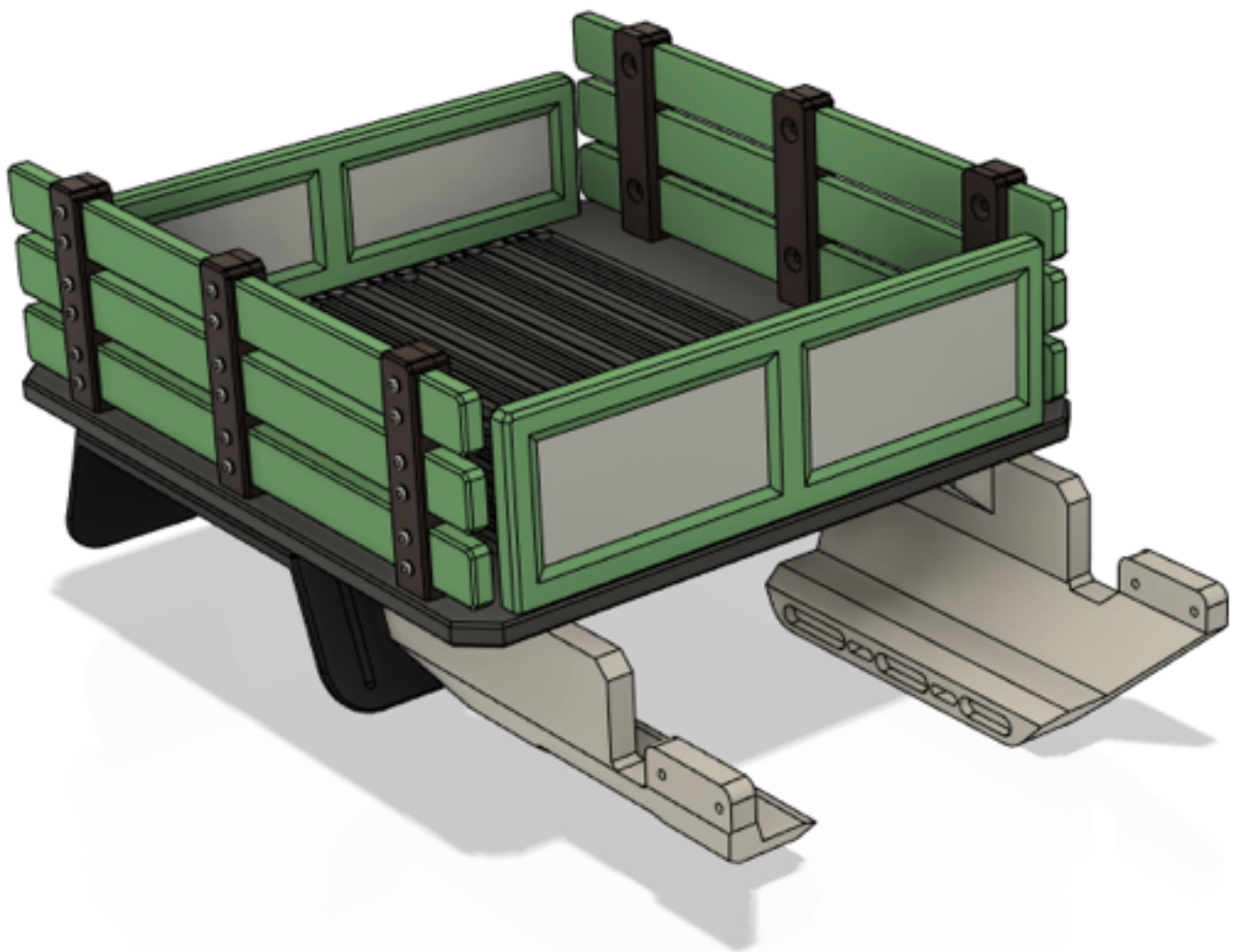

Required tools and hardware

Tools

- 1.5mm Hex Driver
- 2.0mm Hex Driver
- 2.5mm Hex Driver
- Needle Nosed Pliers
- Instant Glue
- Hot Glue
- 3mm drill bit (if using standard 3 gear transmission)

Electronics

- 5mm LED White x2
- 5mm LED Orange x2
- 5mm LED Red x2

Hardware

Hardware	Quantity	Check ✓
M2*10 Socket head	4	
M3*10 Countersunk (CS)	30	
M3*12 Countersunk (CS)	10	
M3*12 Socket head	10	
M3*15 Socket head (CS)	32	
M3*20 Countersunk (CS)	16	
M3*20 Grub screw (GS)	8	

Before you begin

- Be sure to read through the manual and familiarise yourself with the instructions
- Visualise a plan to assemble all the pieces
- Make sure you have all of the hardware and tools
- Be sure to have enough instant glue
- Dry fit all parts before painting and assembling

Tip: It will help to paint all of the parts before final assembly

Assembling the bed

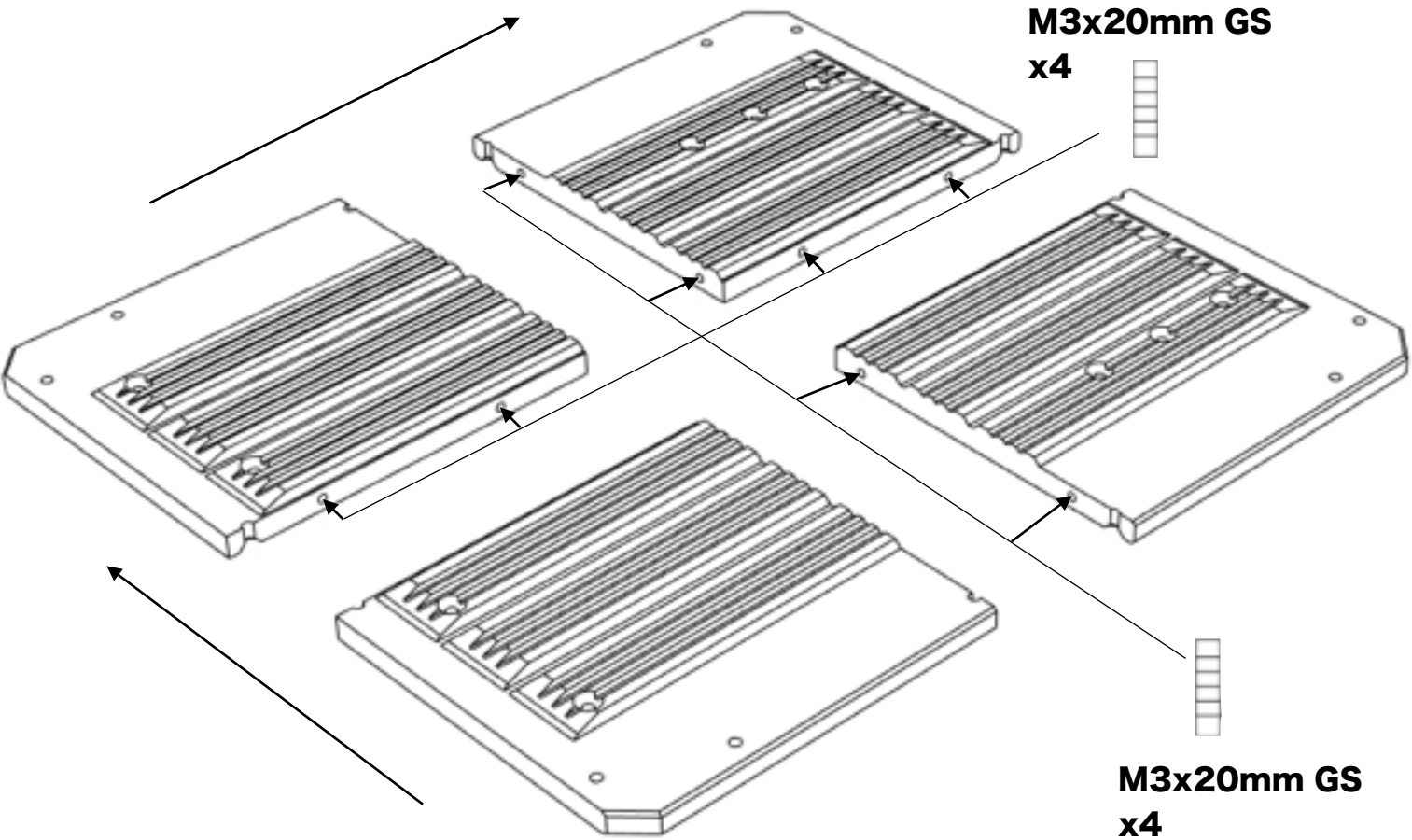

1. Insert grub screws half way

2. Push quarters together and glue to secure



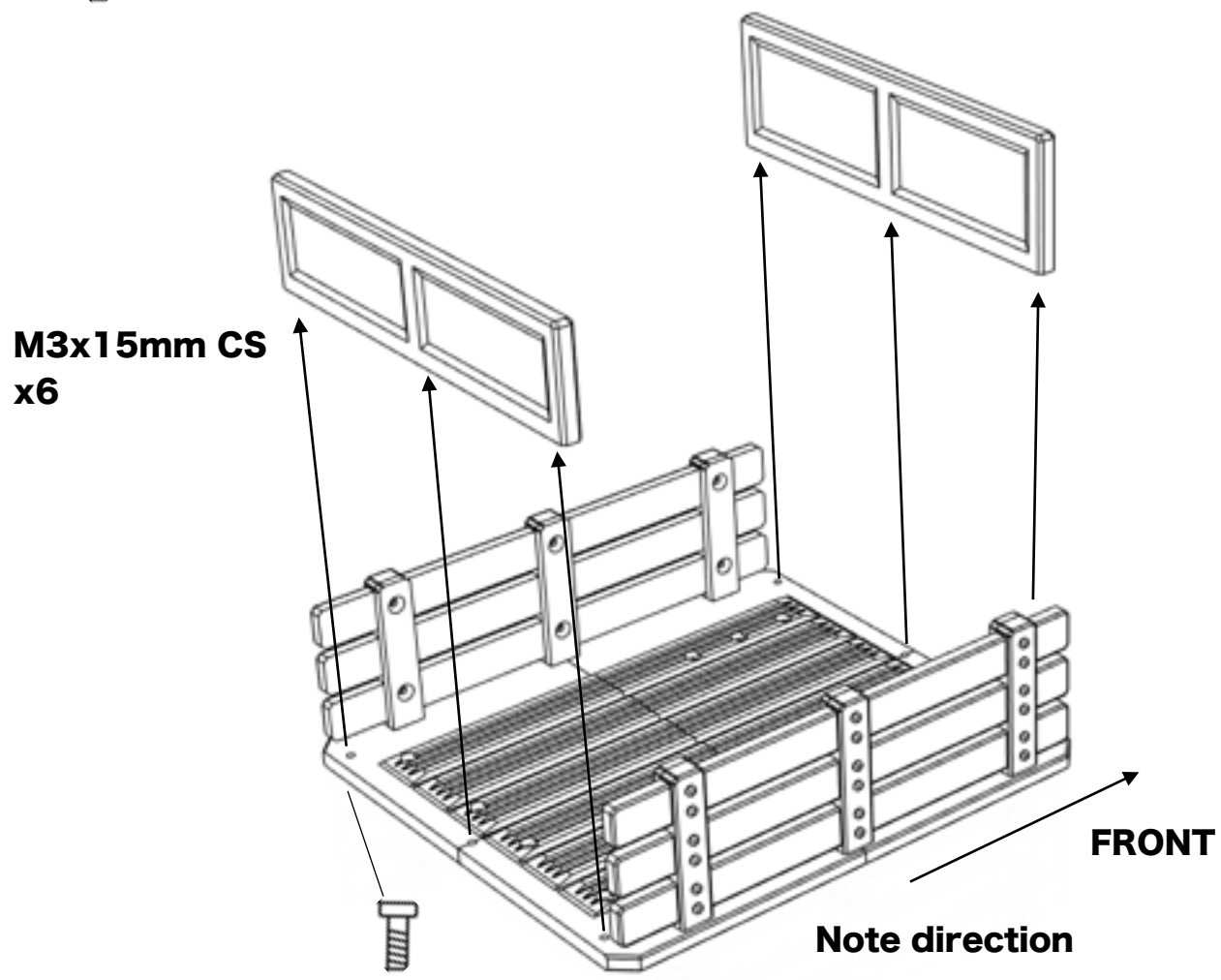
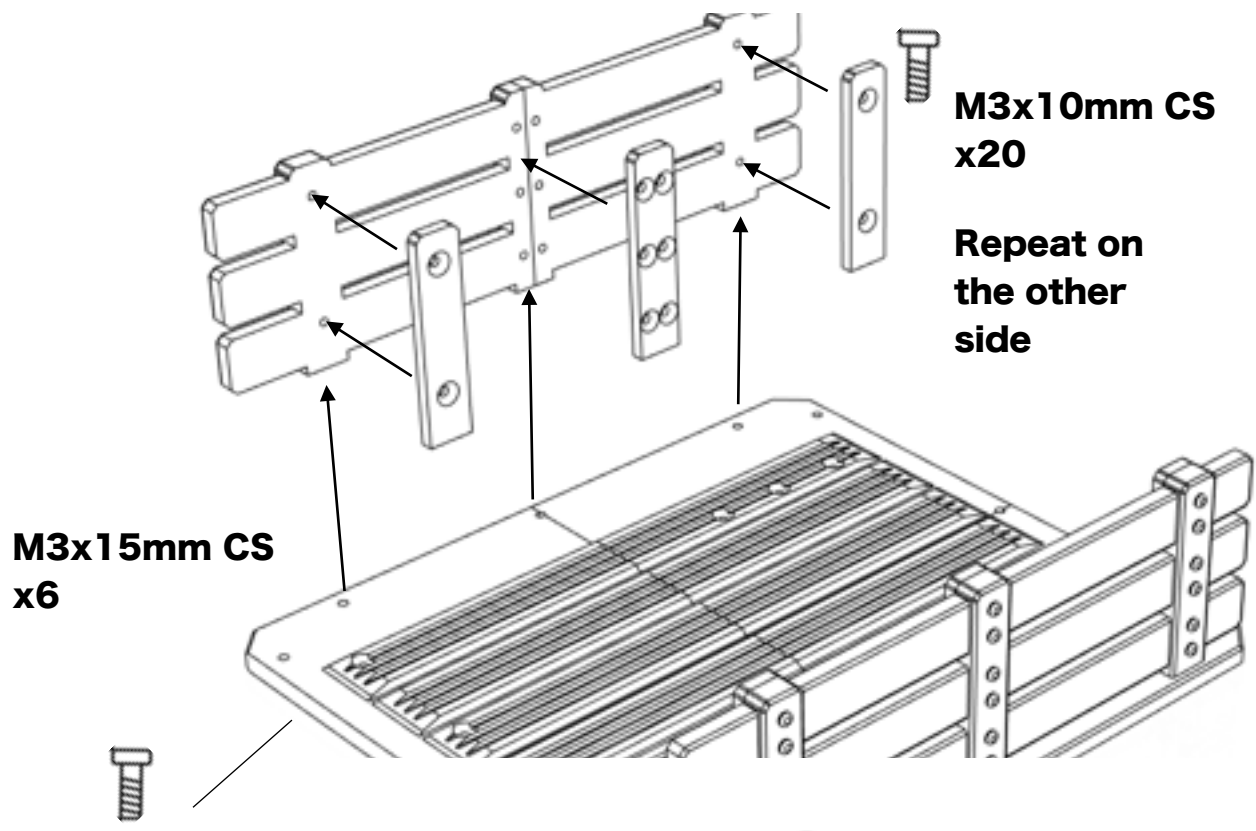

Assembling the mounts bed

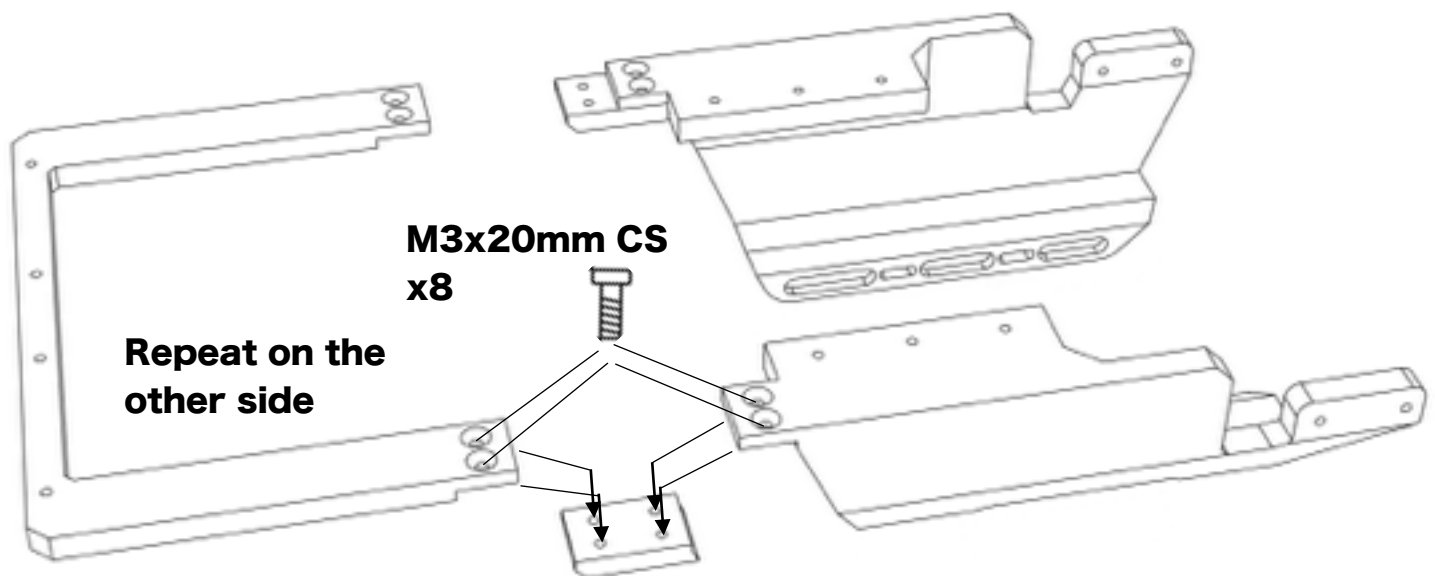

Installing the bed

**M3x15mm CS
x10**

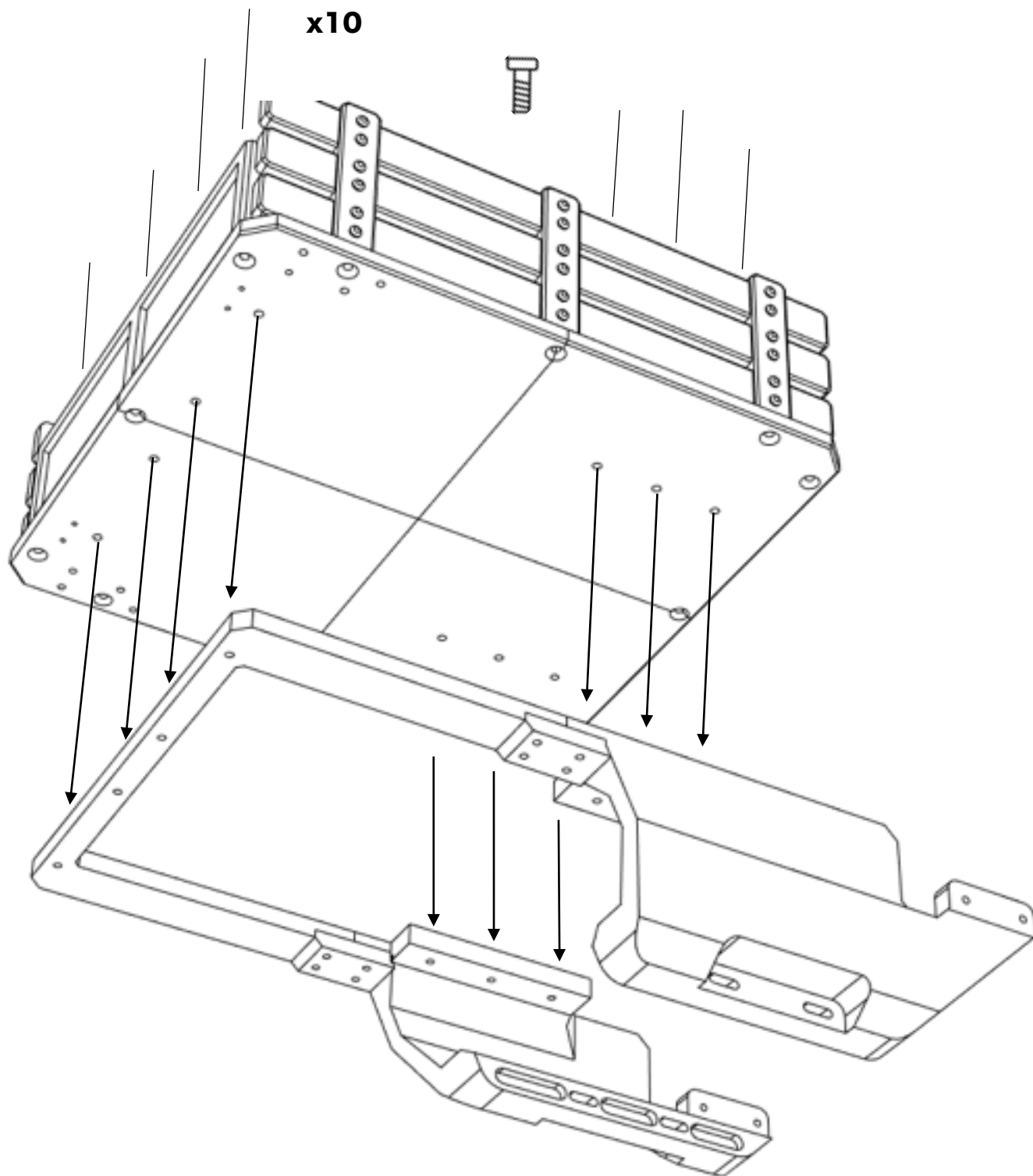

Installing the fenders

Use these holes
for the 313 mm
wheelbase
fenders

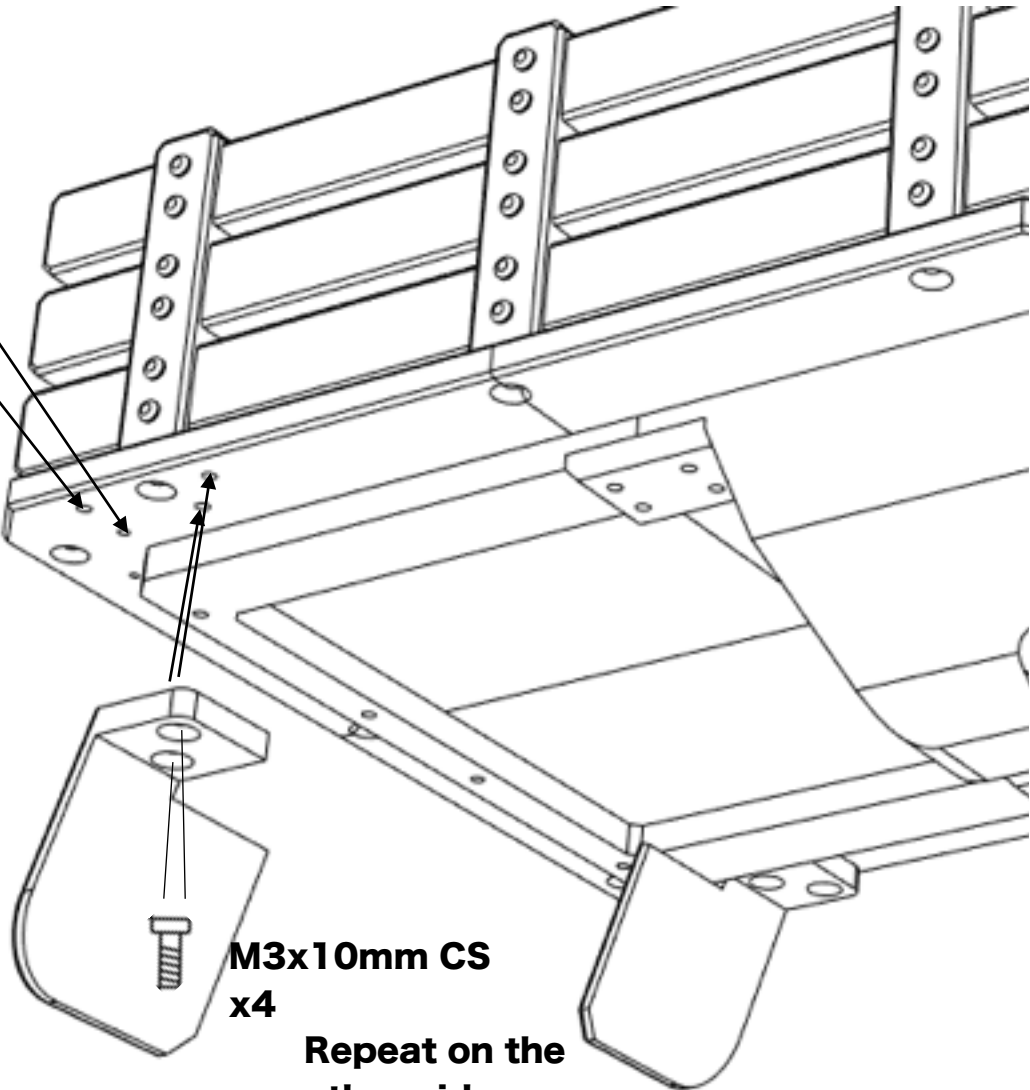

M3x10mm CS
x4

Repeat on the
other side

Installing the rear lights

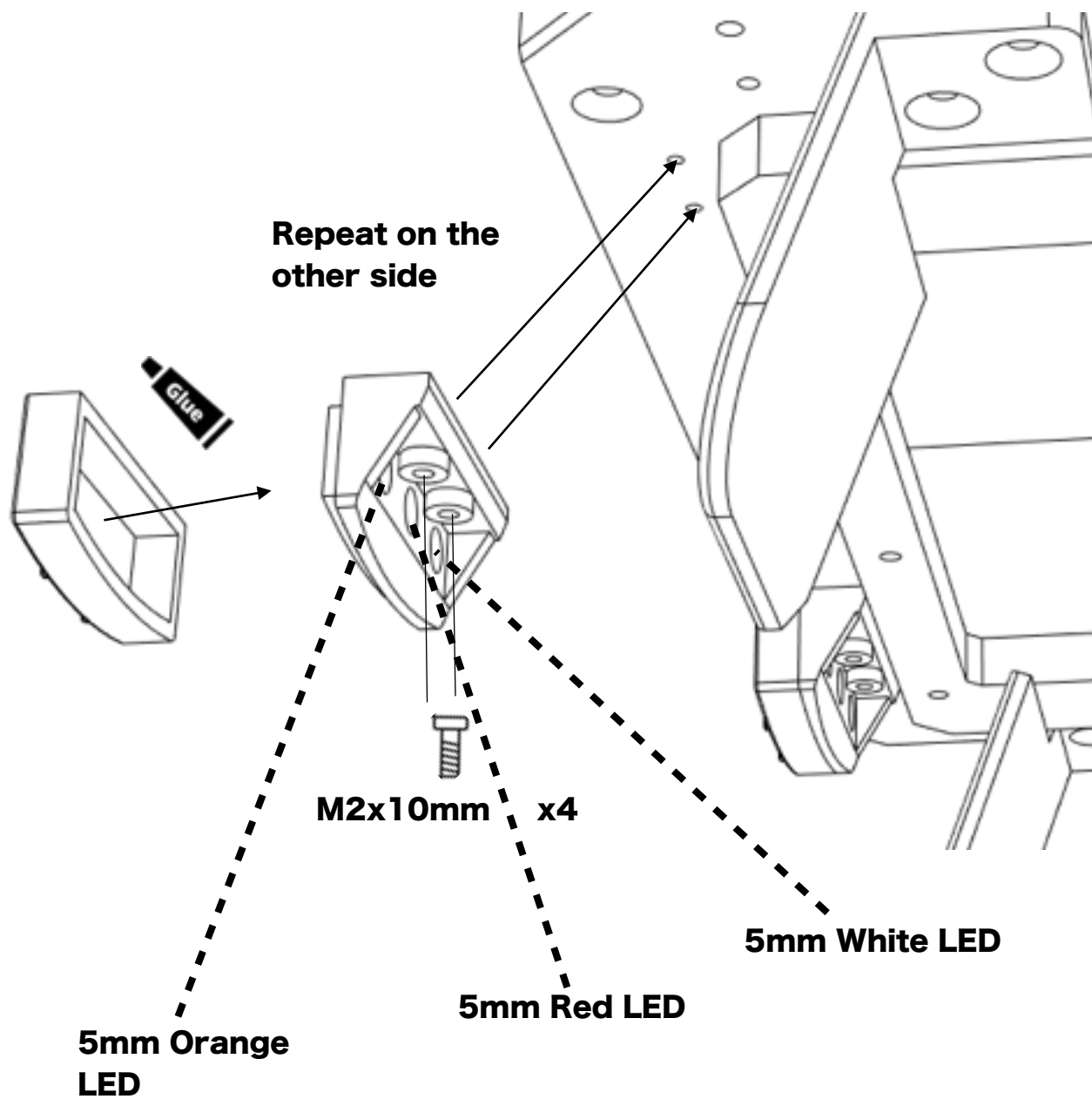

Installing the bed (alt version)

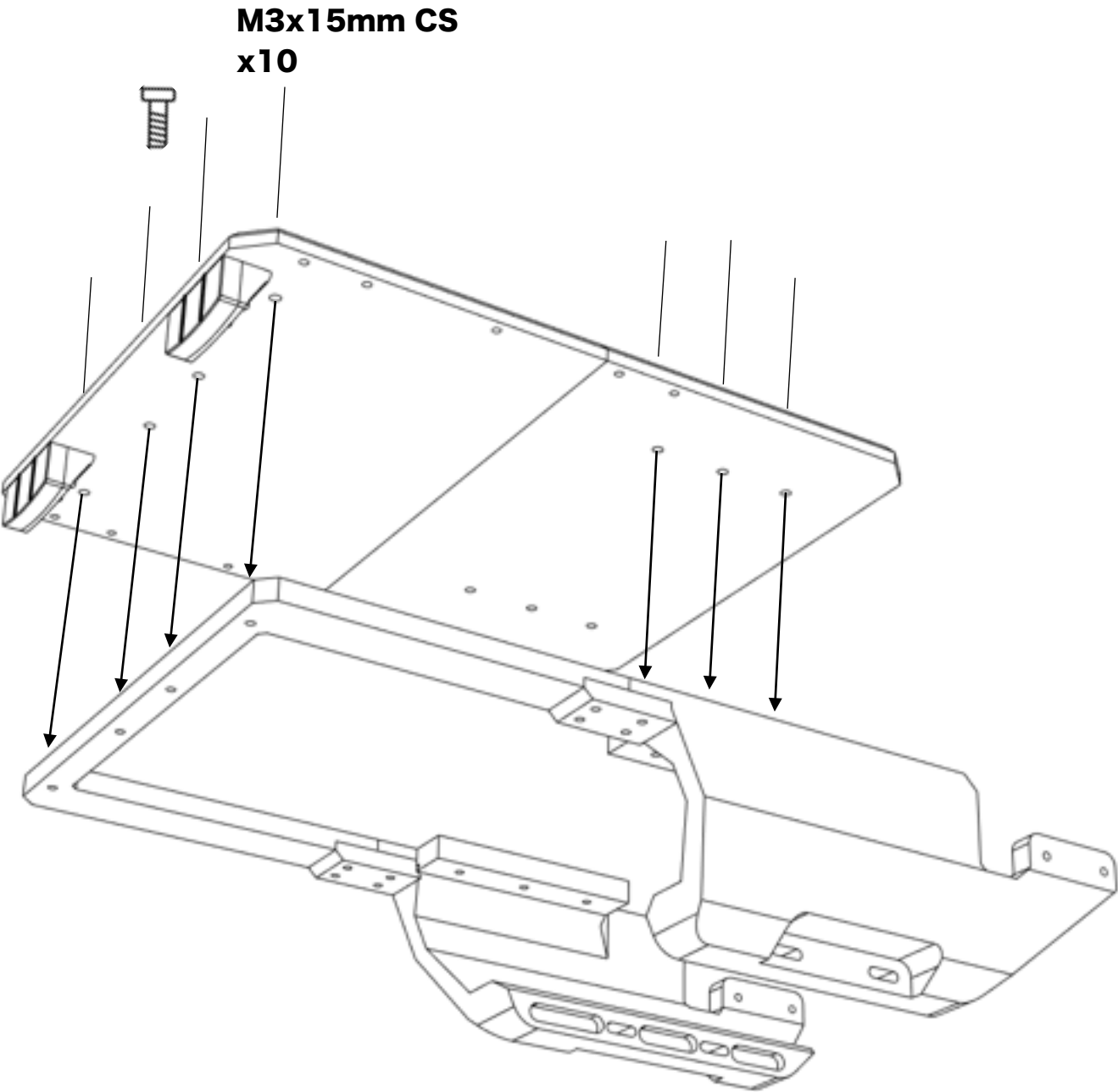

Installing the fenders (alt version)

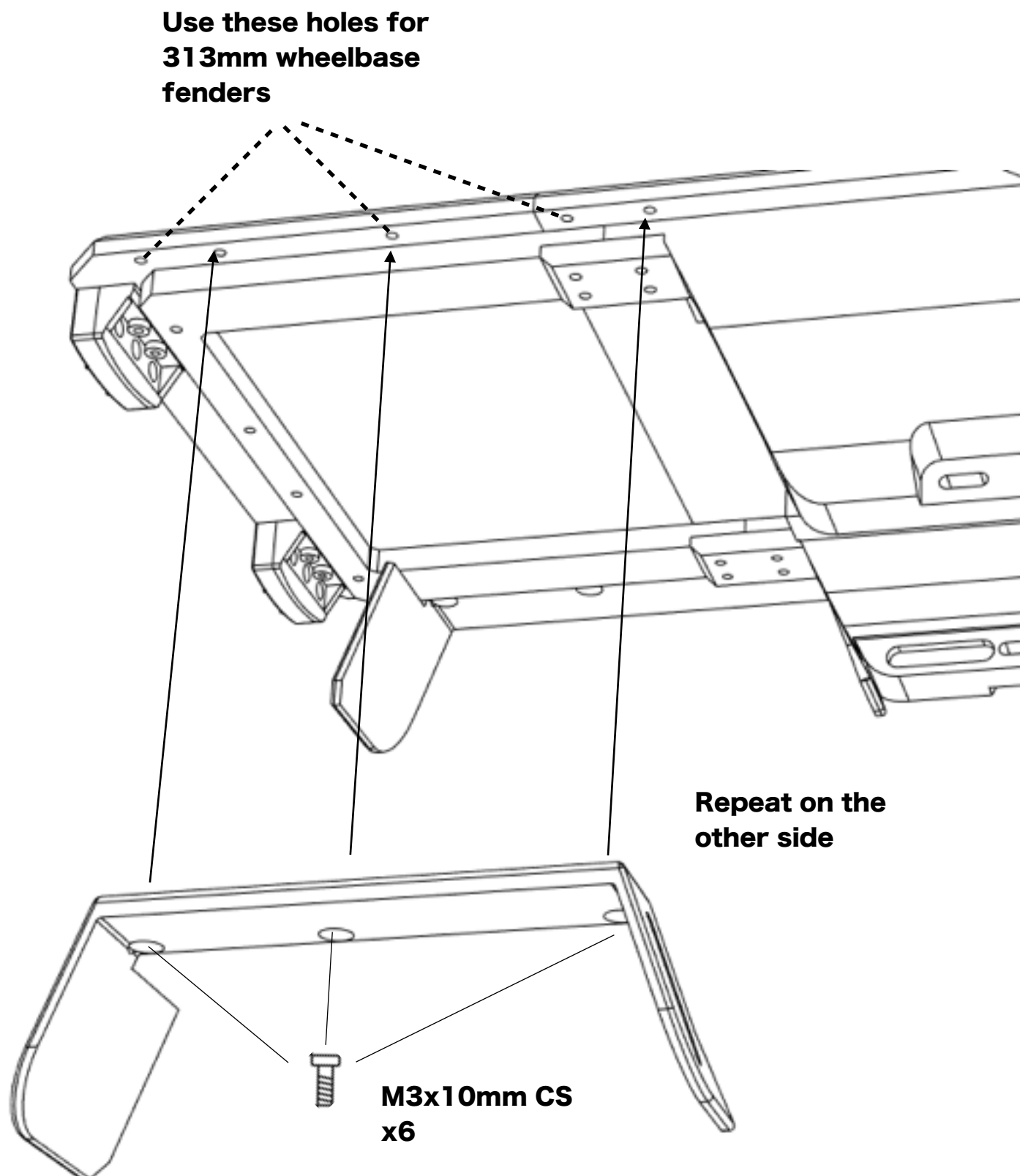

Installing the bed raiser (for 3 gear transmission only)

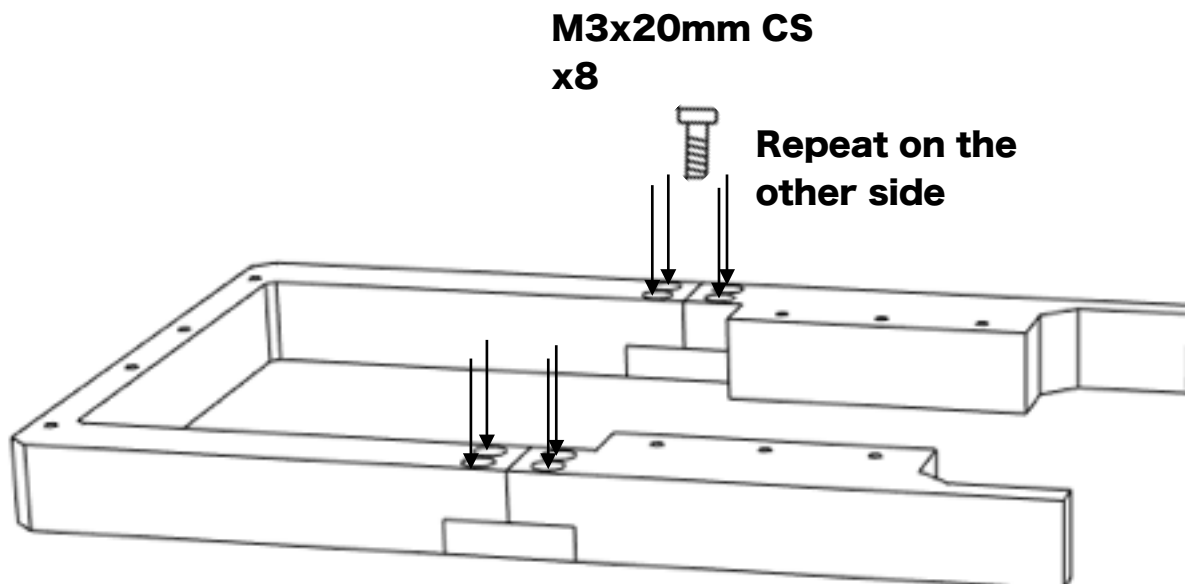

**Drill through
with 3mm bit**

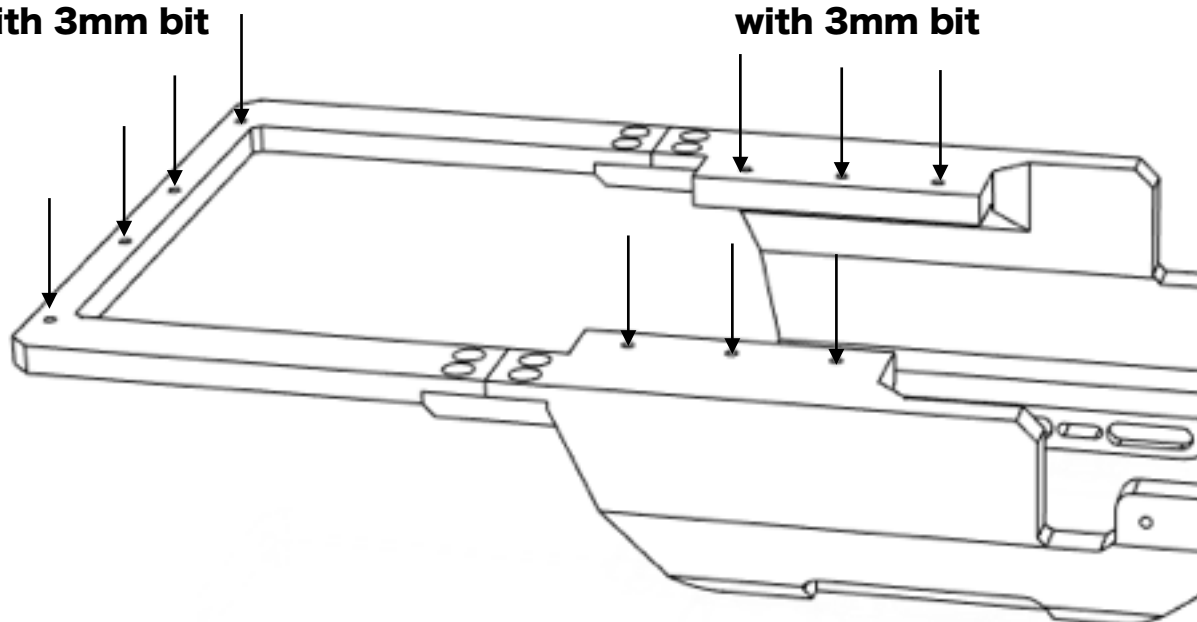

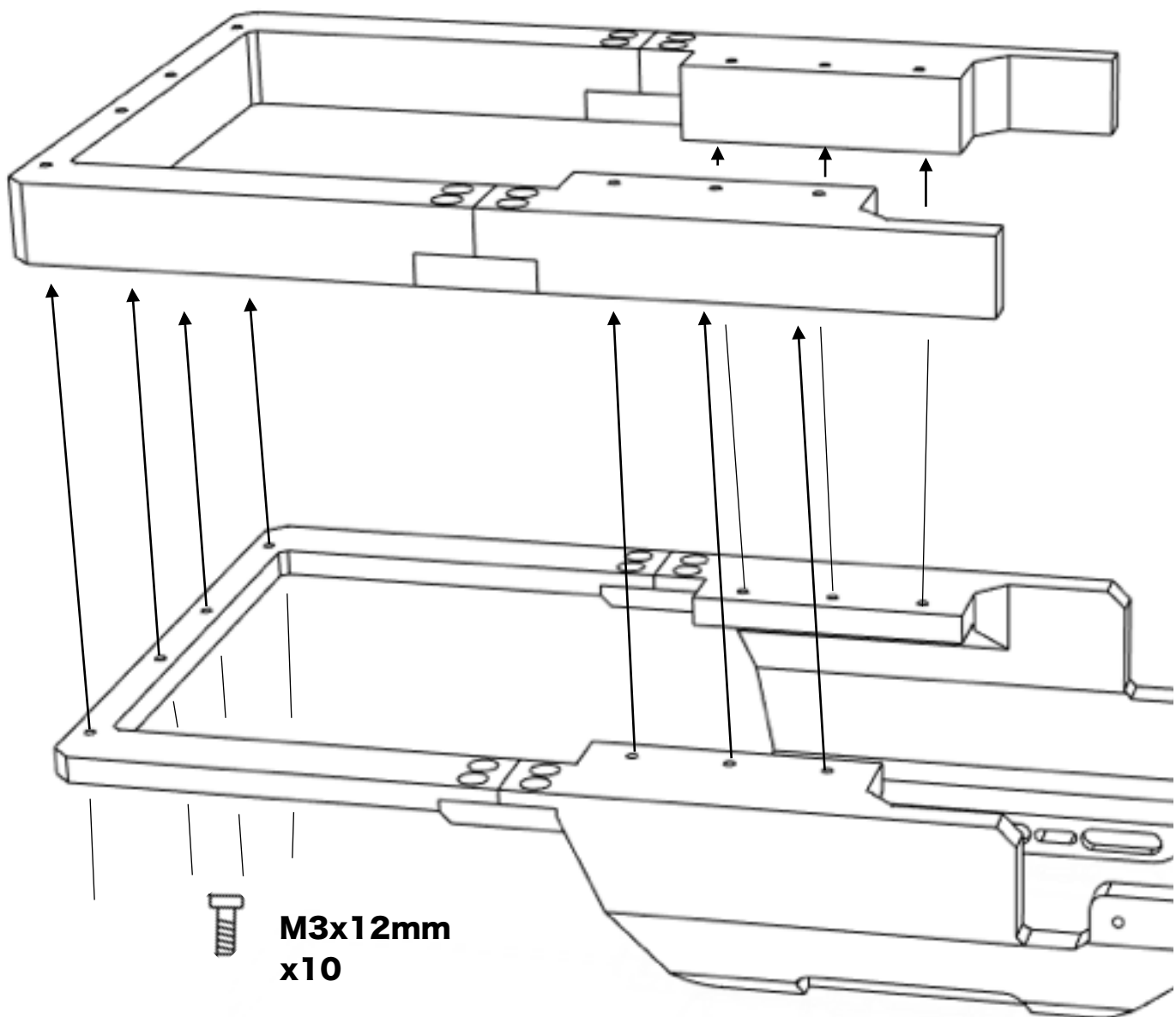

M3x12mm CS
x4

M3x12mm CS
x6

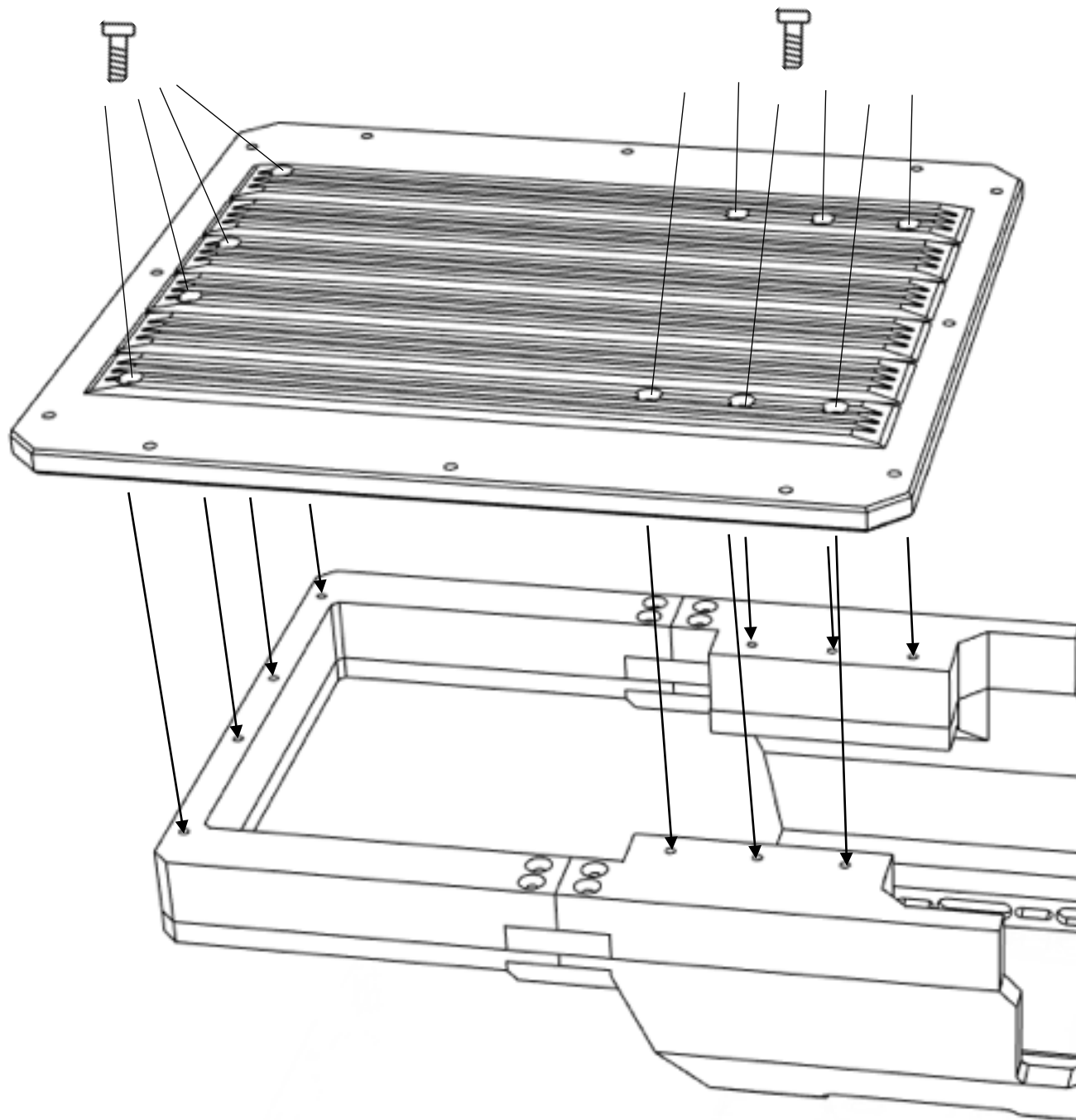

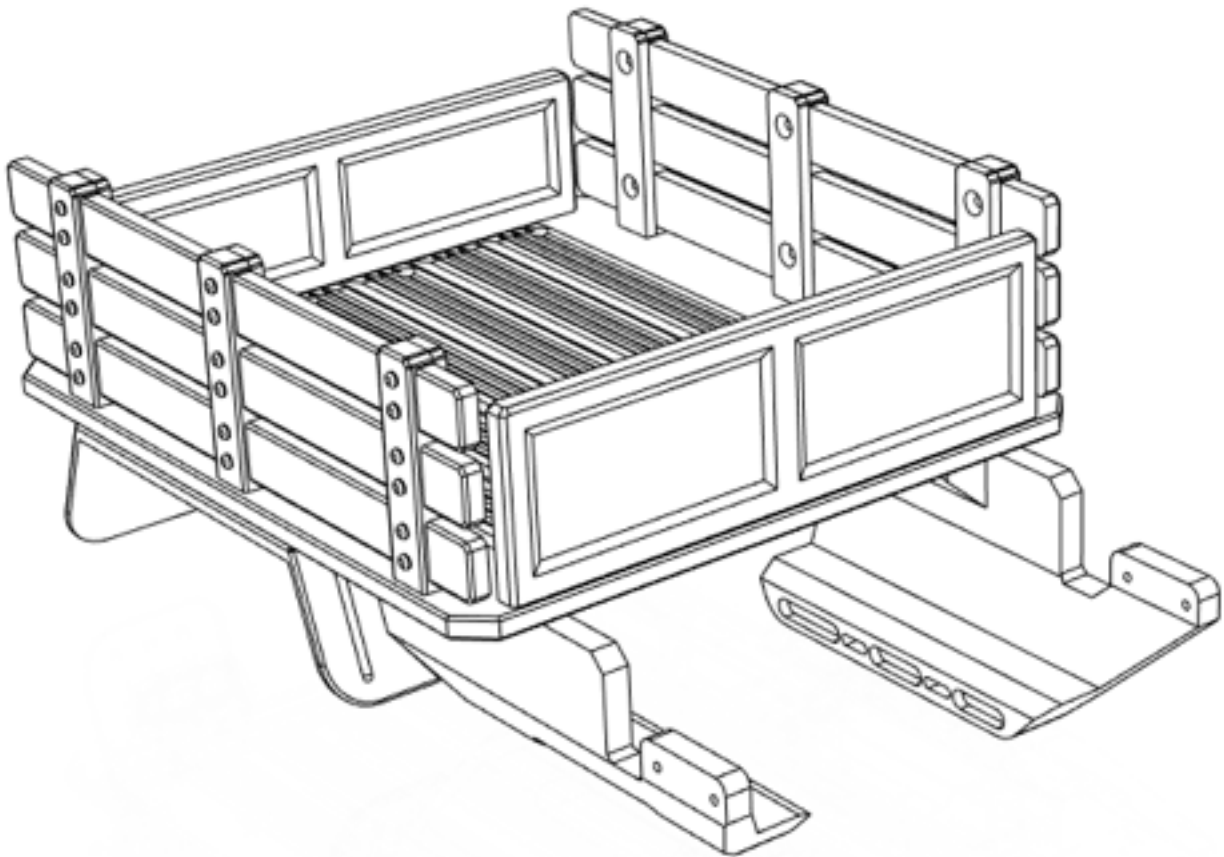

Body is now fully complete. Thank you for selecting ahead RC products.

If you have any questions or need help with the assembly, please do not hesitate to contact us at:

aheadrc@gmail.com

or visit us at:

www.aheadrc.com

Best of luck with your build!