

# **ahead RC** Crawler V304 6x6 for TRX6 Assembly Manual



## Required tools and hardware

### Tools

- 1.5mm Hex Driver
- 2.0mm Hex Driver
- 2.5mm Hex Driver
- Needle Nosed Pliers
- Instant Glue
- Hot Glue

### Electronics

- 5mm LED White x3
- 5mm LED Red x2
- 3mm LED Orange x2

### Hardware

Hardware	Quantity	Check ✓
M2*5 Socket head	41	
M2*8 Socket head	22	
M2*10 Socket head	20	
M3*10 Socket head	11	
M3*15 Socket head	20	
M3*20 Socket head	2	
M3*25 Socket head	2	
M3*10 Button head (BH)	2	
M3*15 Countersunk (CS)	2	
M3*3 Grub screw (GS)	4	
M3*10 Grub screw (GS)	2	
M3*20 Grub screw (GS)	2	
1*6 Dowel Pin	2	

# Before you begin

- Be sure to read through the manual and familiarise yourself with the instructions
- Visualise a plan to assemble all the pieces
- Make sure you have all of the hardware and tools
- Be sure to have enough instant glue
- Dry fit all parts before painting and assembling

**Tip:** It will help to paint all of the parts before final assembly

# Assembling the cab and door hinges

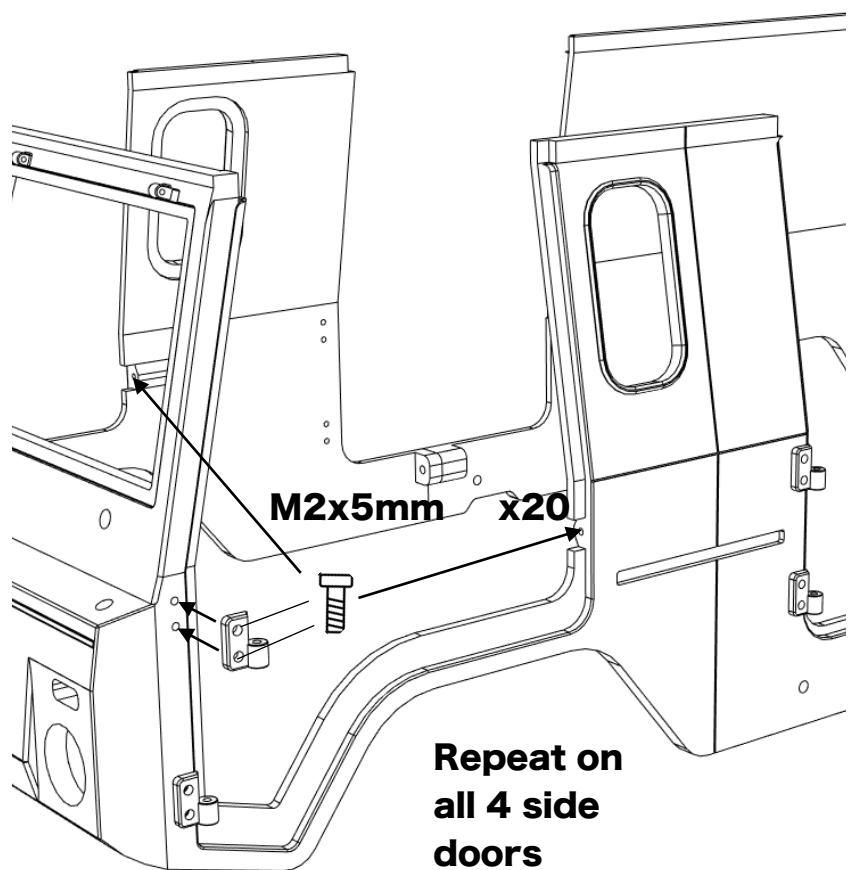
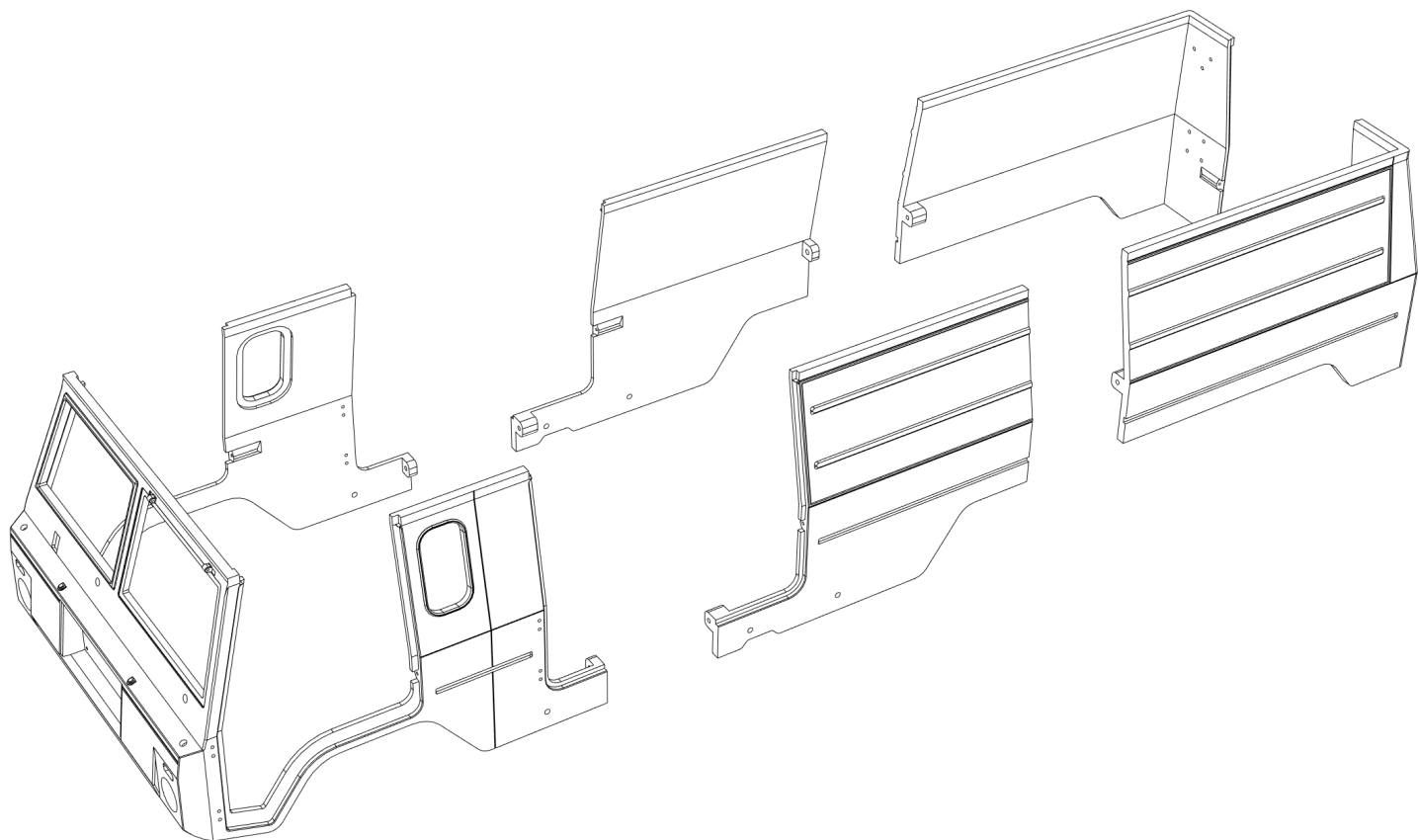

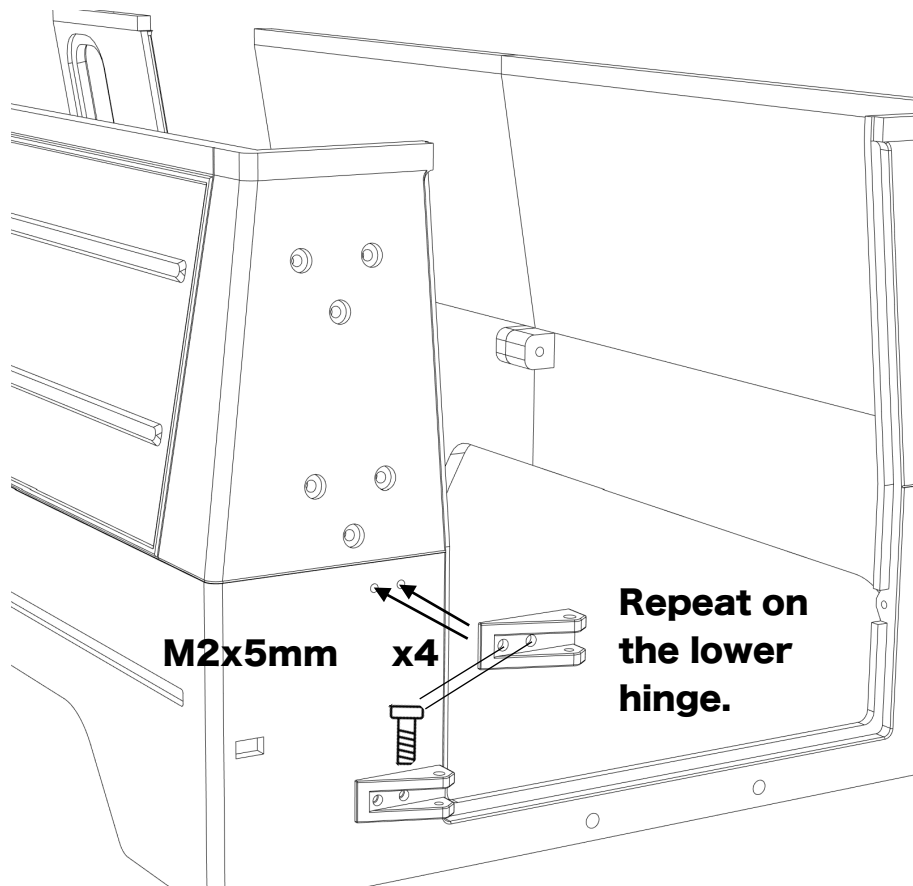

# Assembling the doors

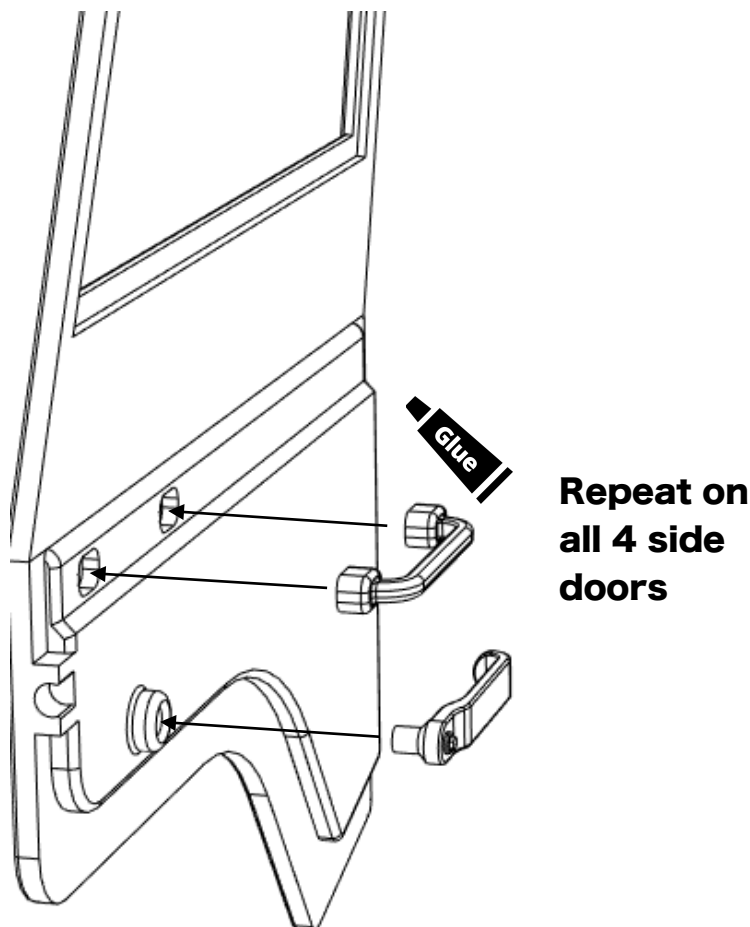
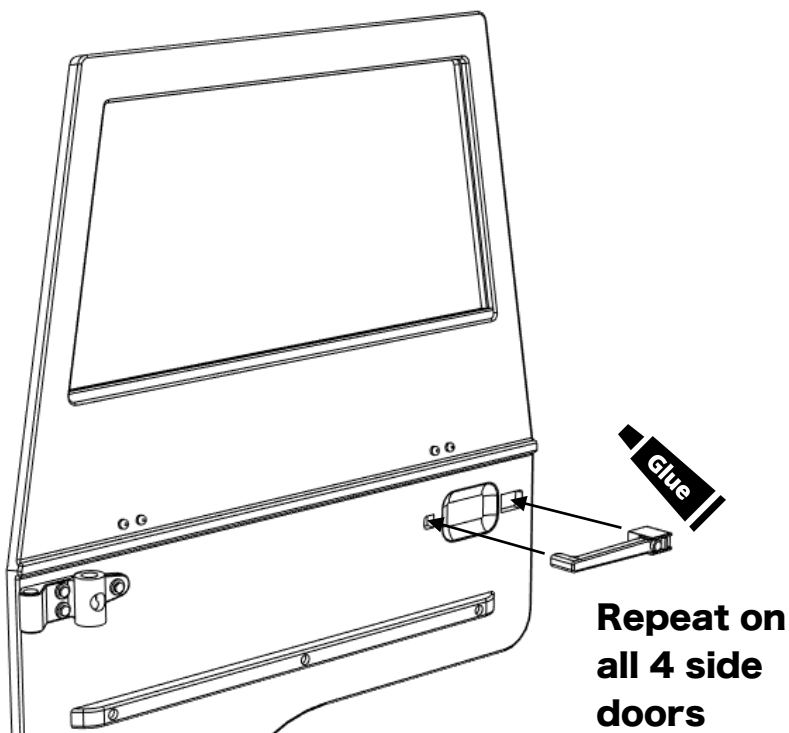

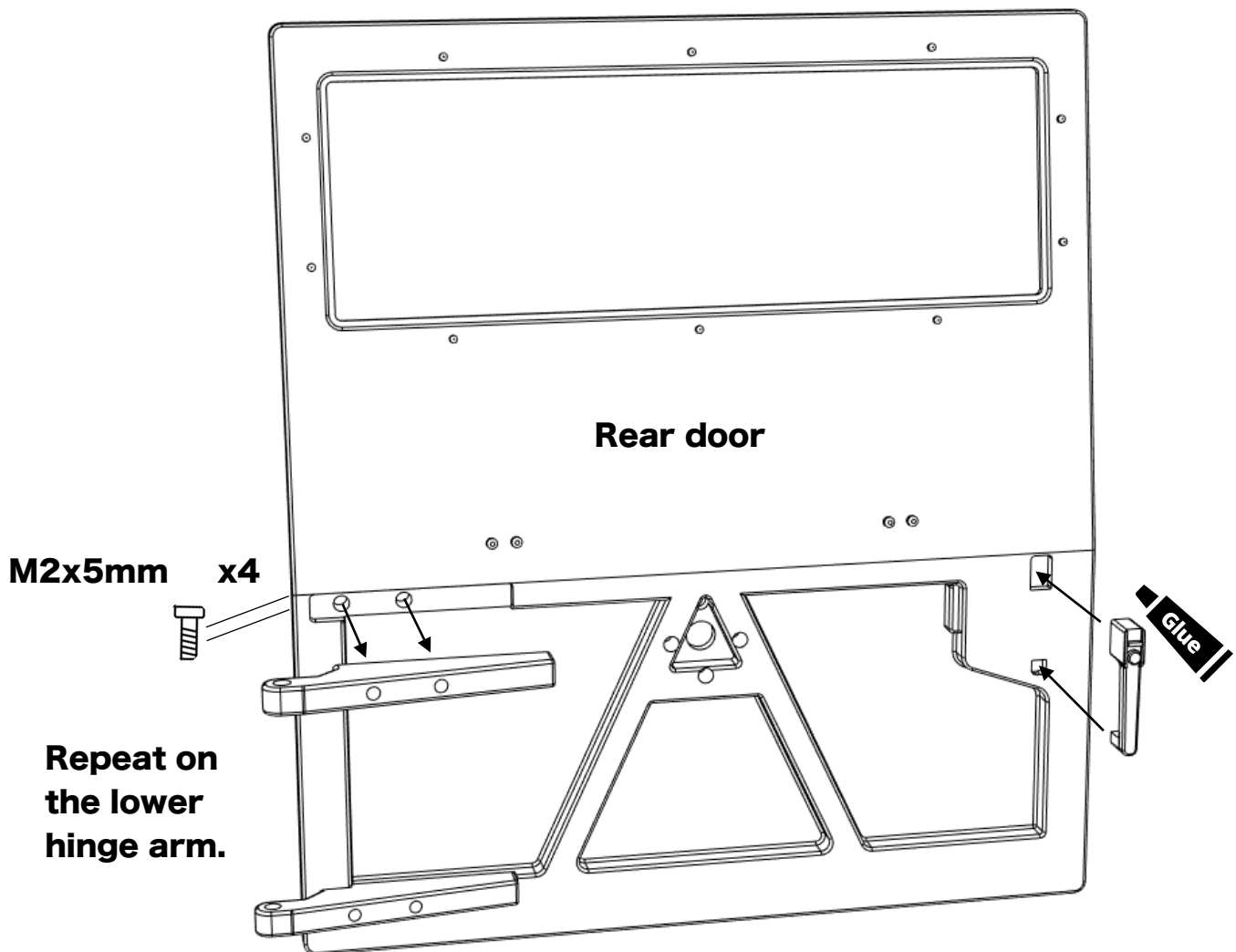
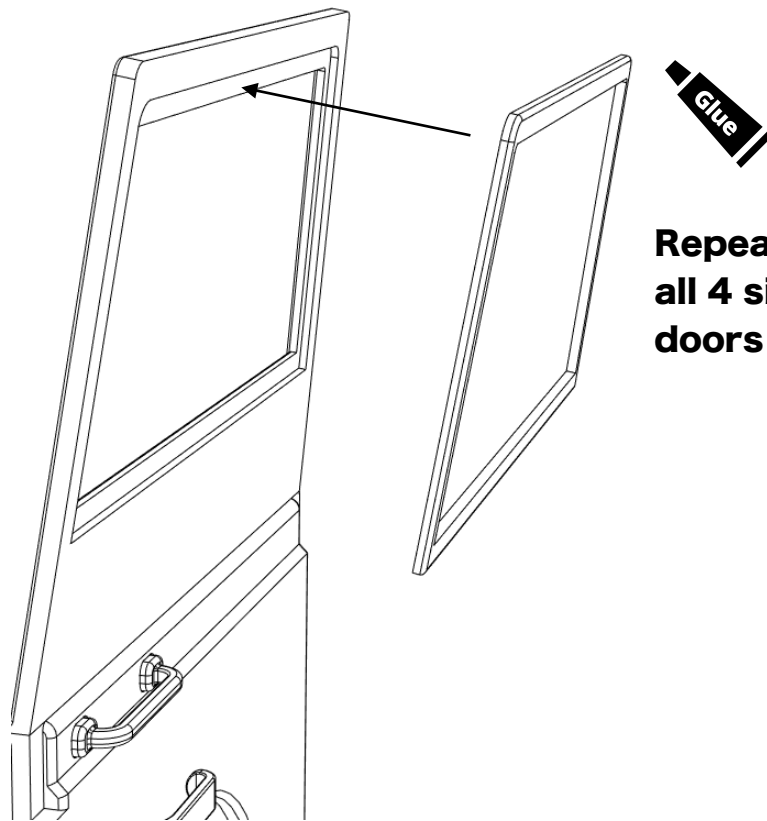

**M2x10mm**

**x4**

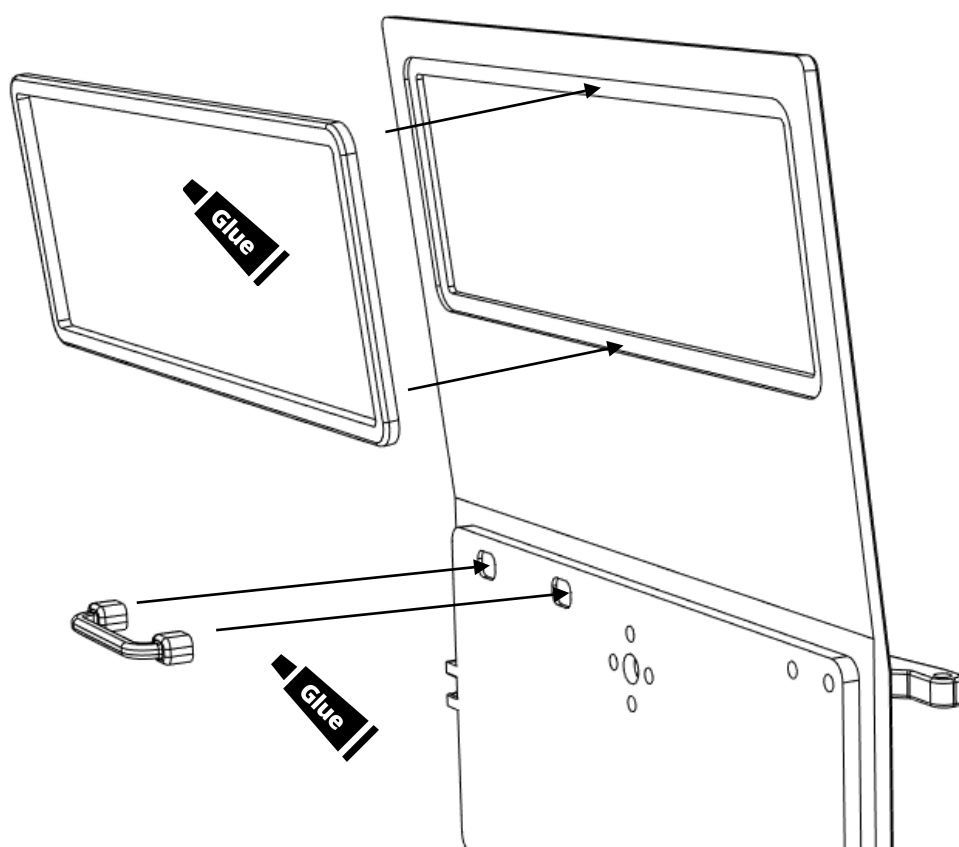
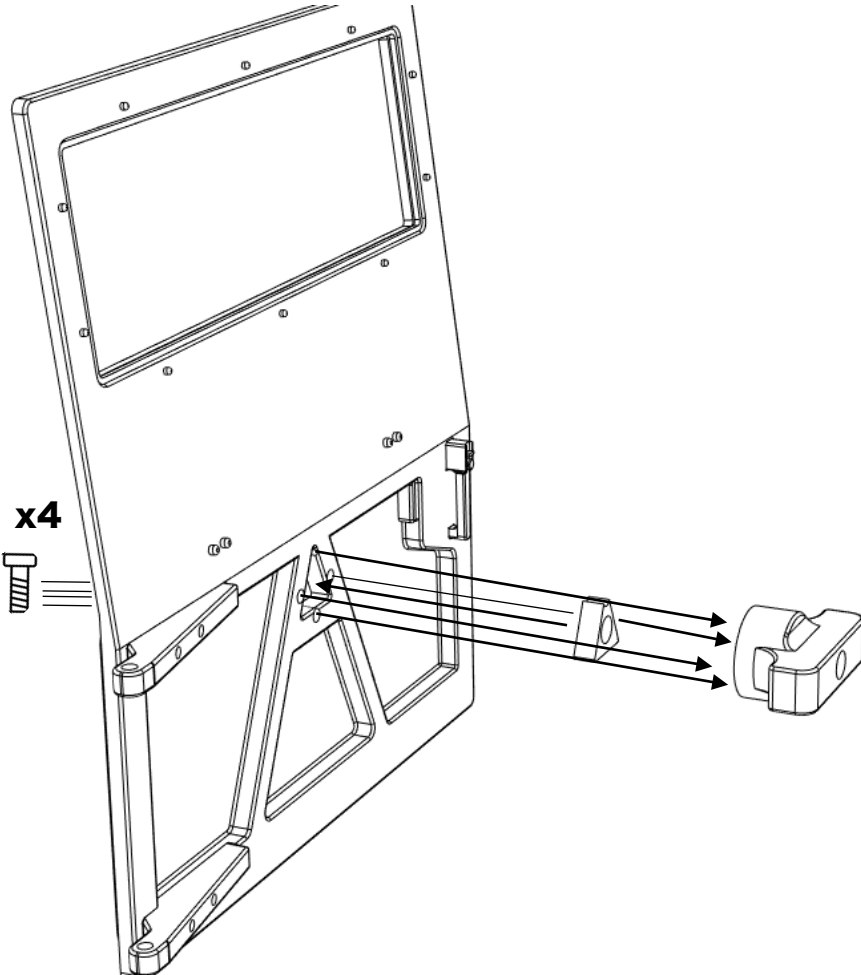



# Installing the doors

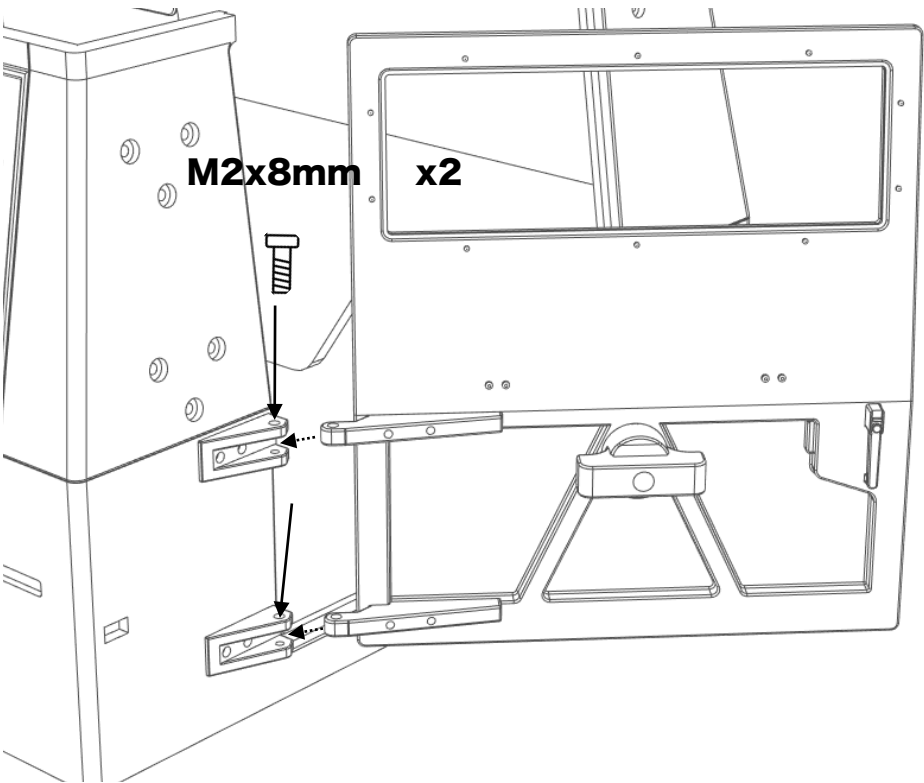
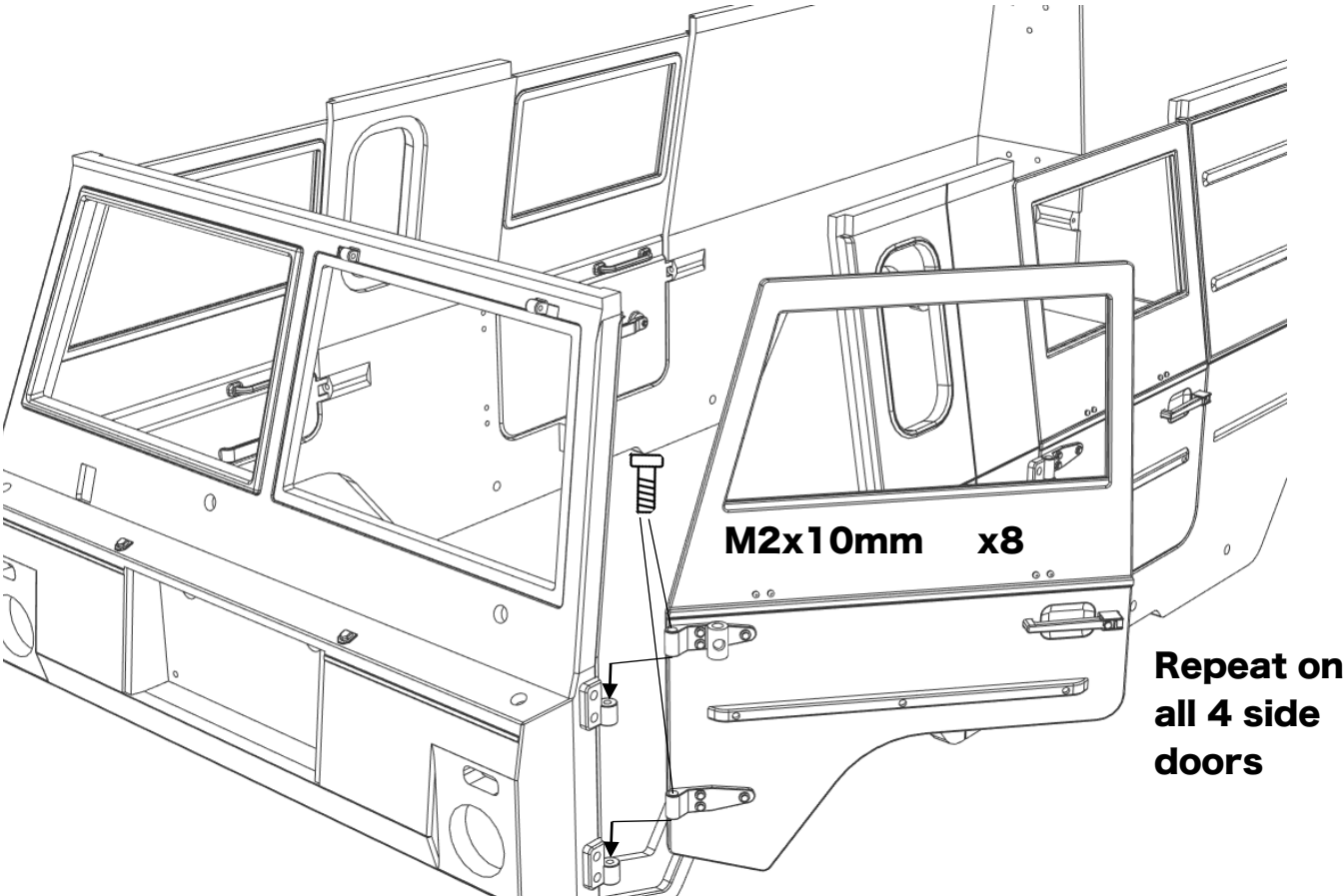

Installing cab window presses and windshield

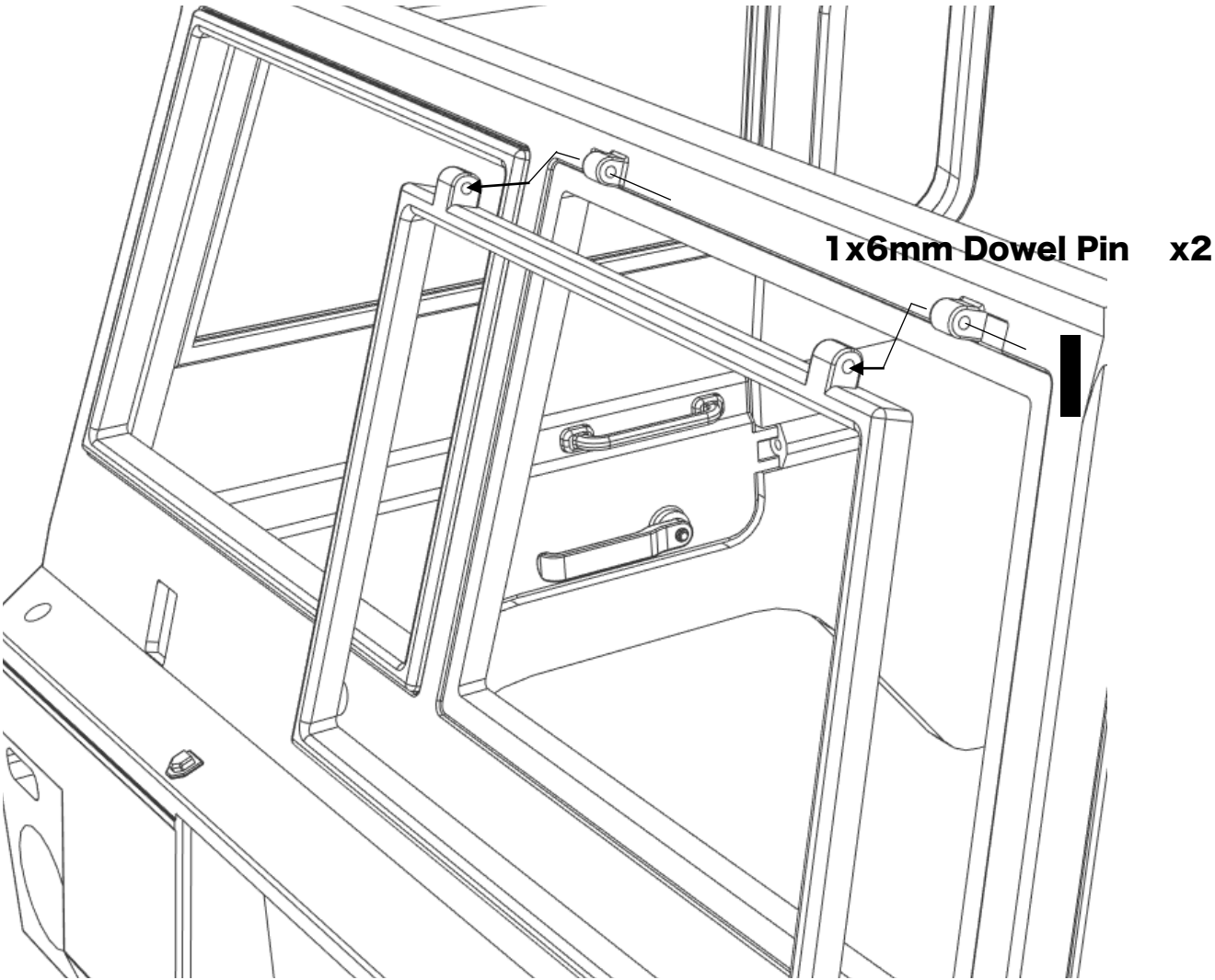
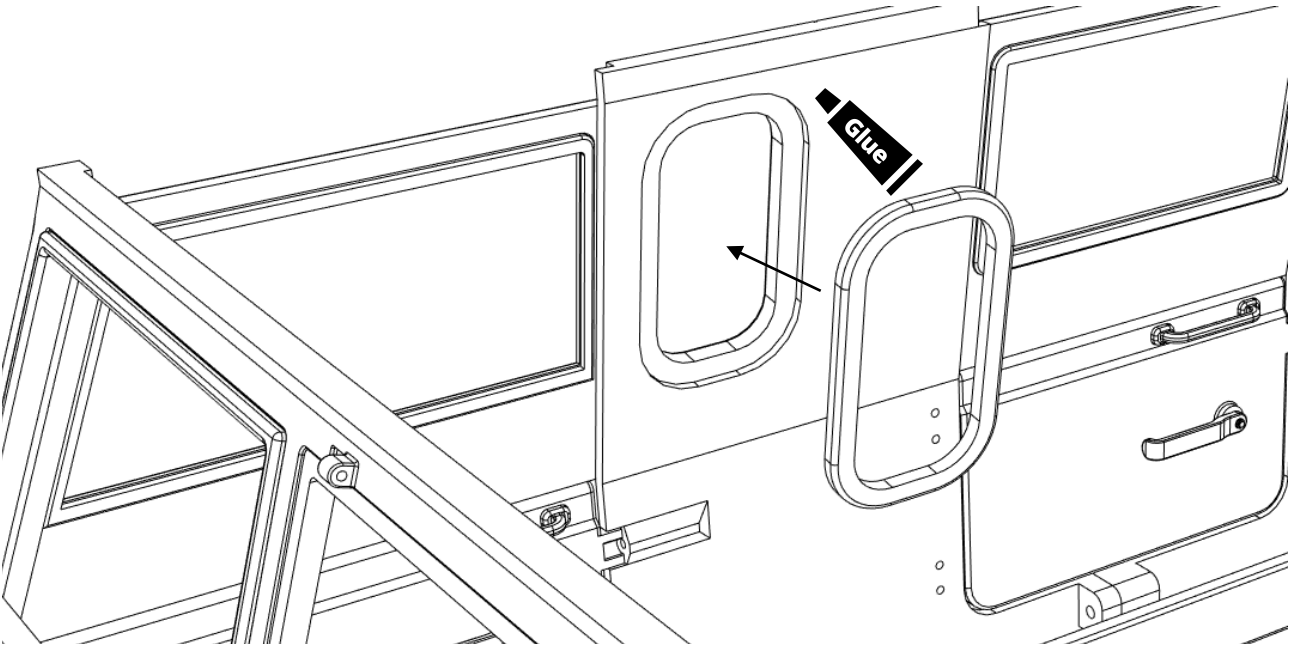

# Installing the lights and mirrors

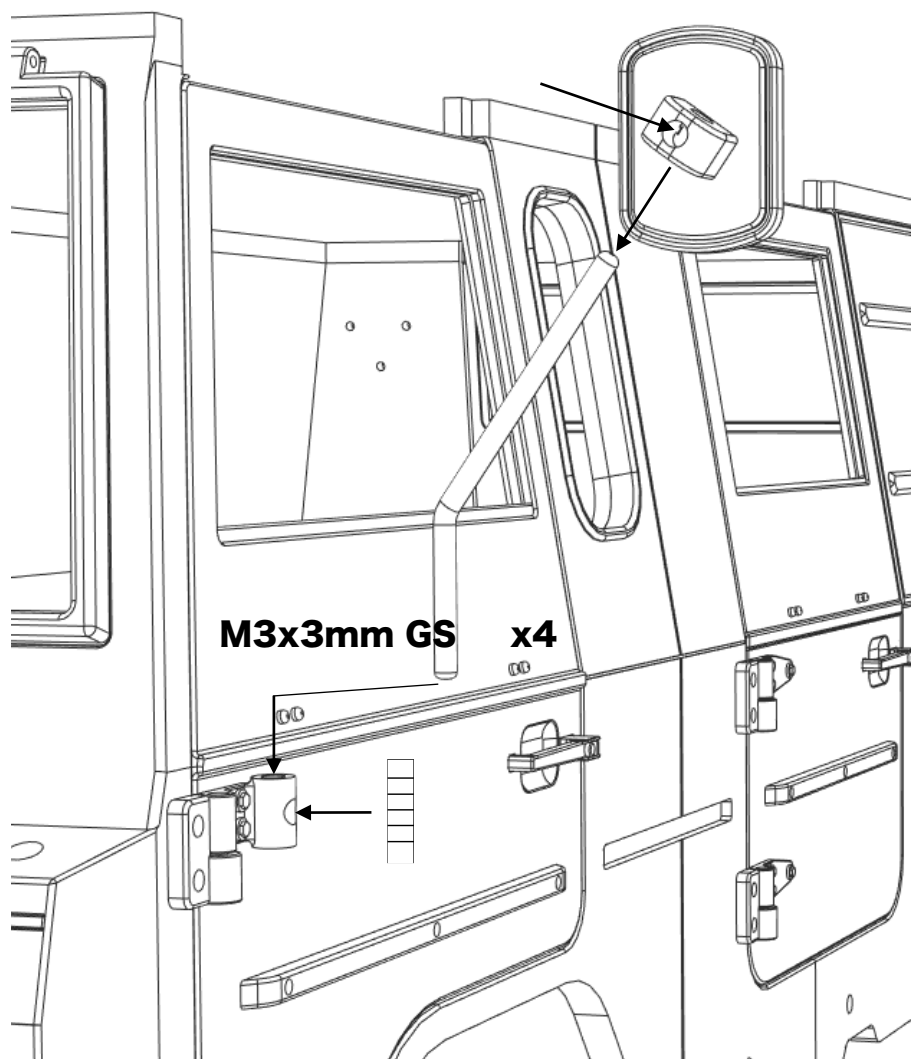
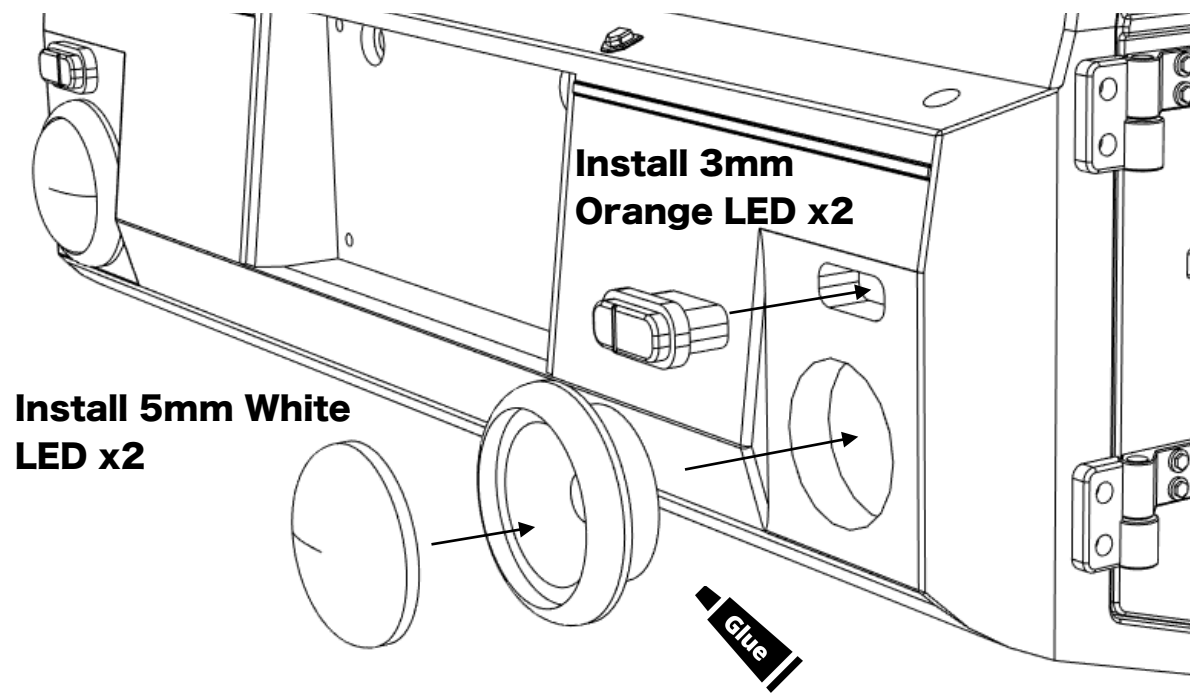

**Assembling the interior dashboard**

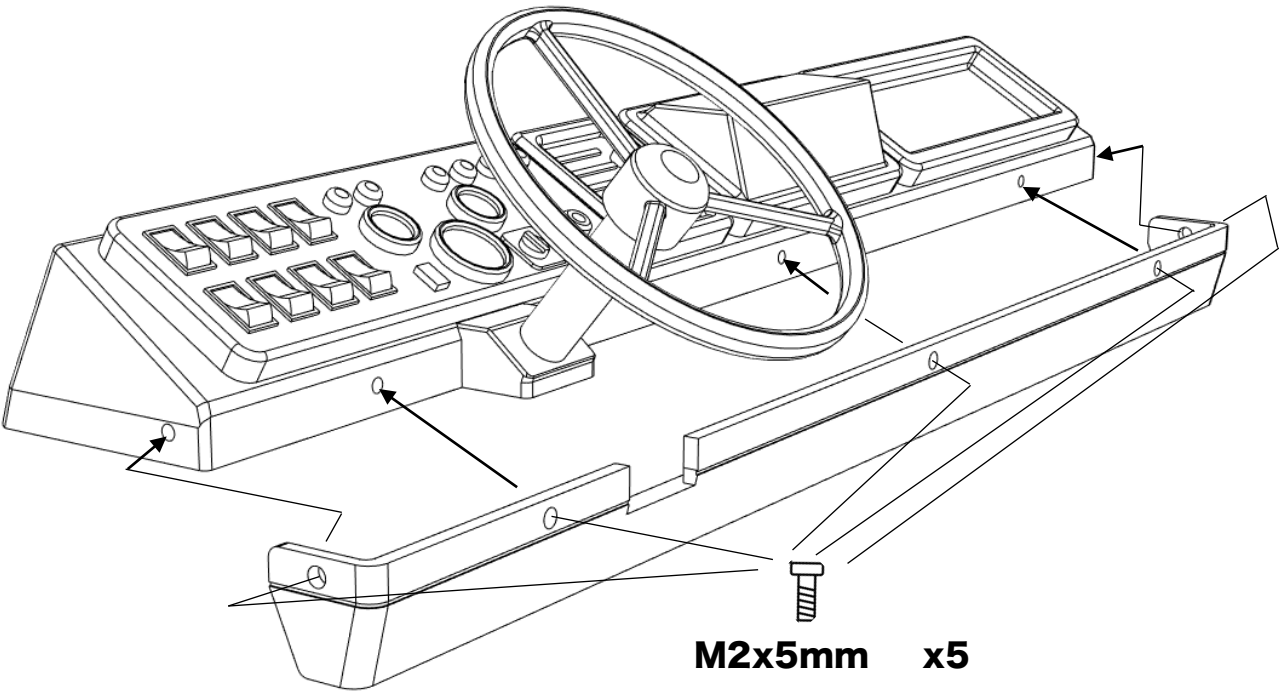
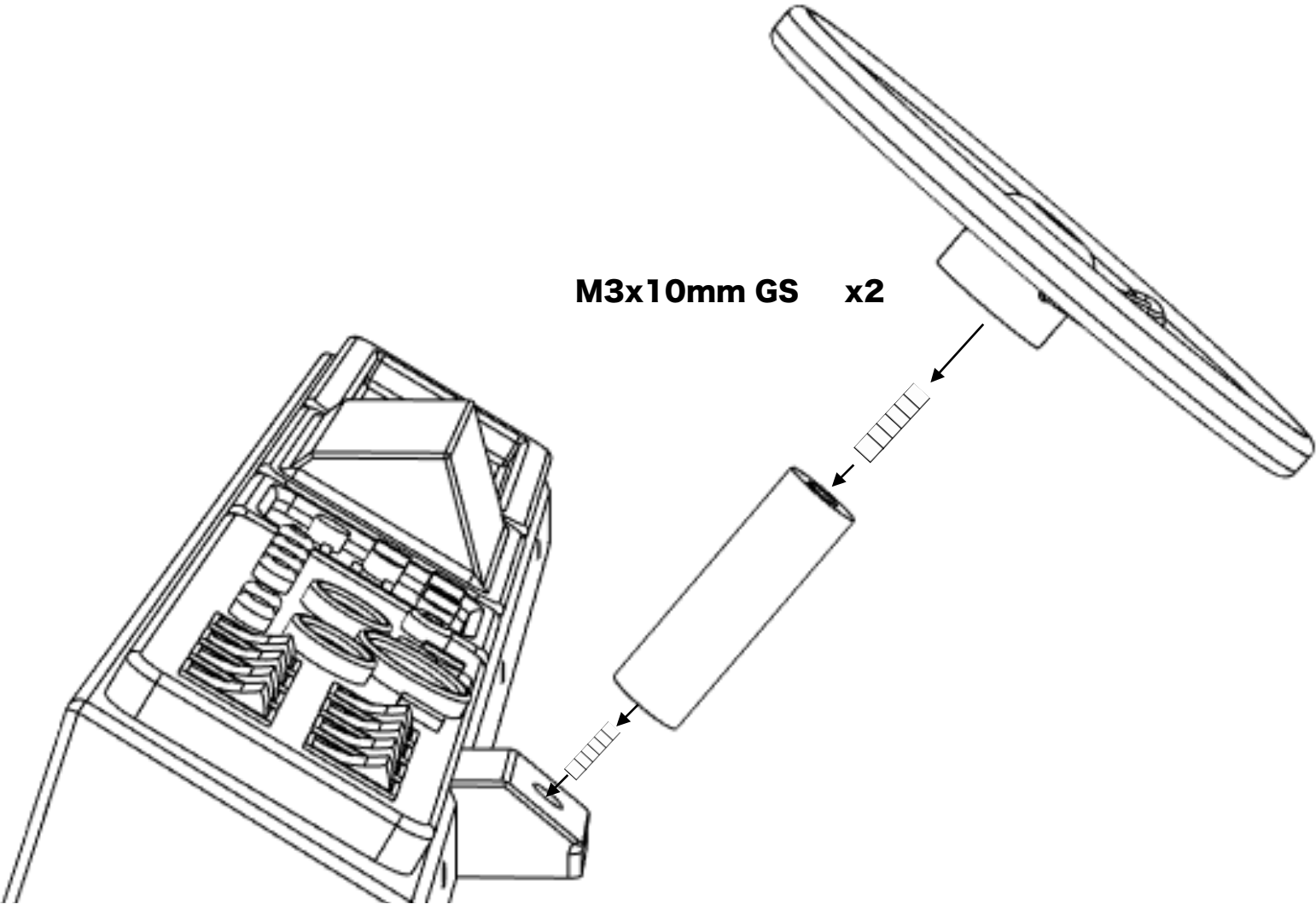

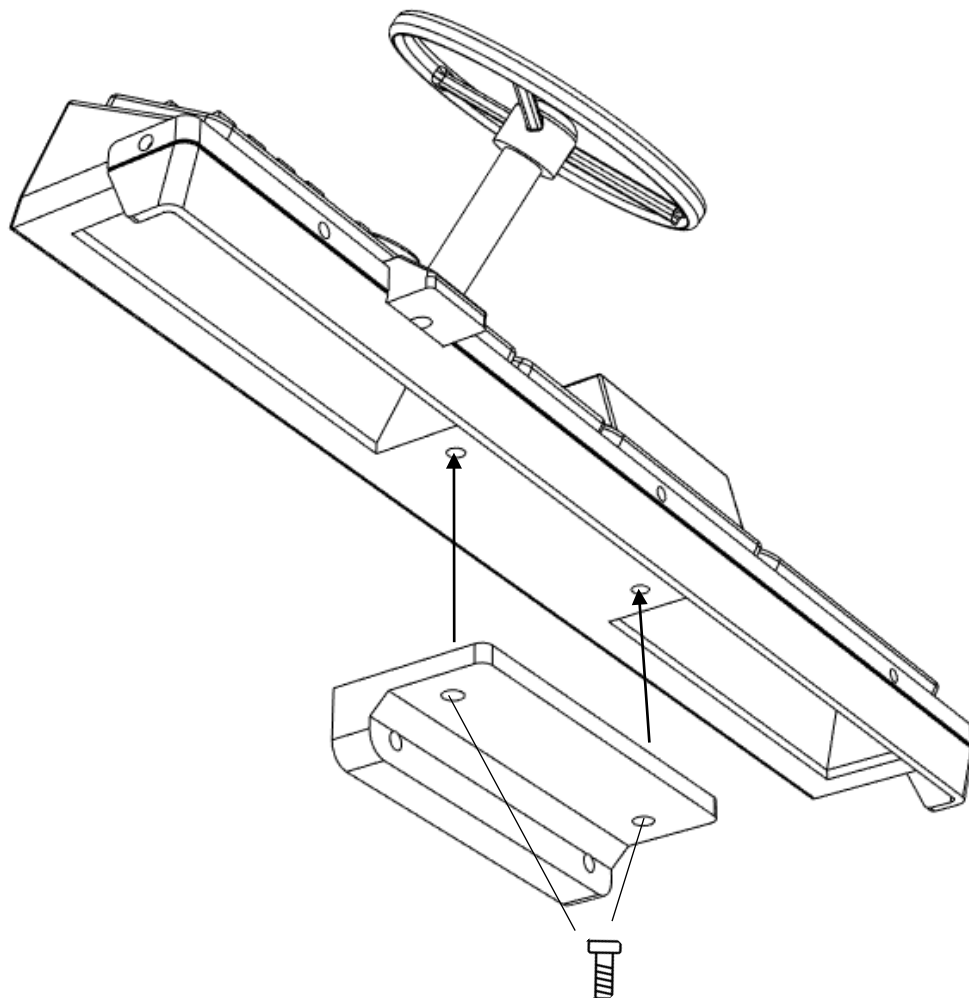

**M3x10mm x2**

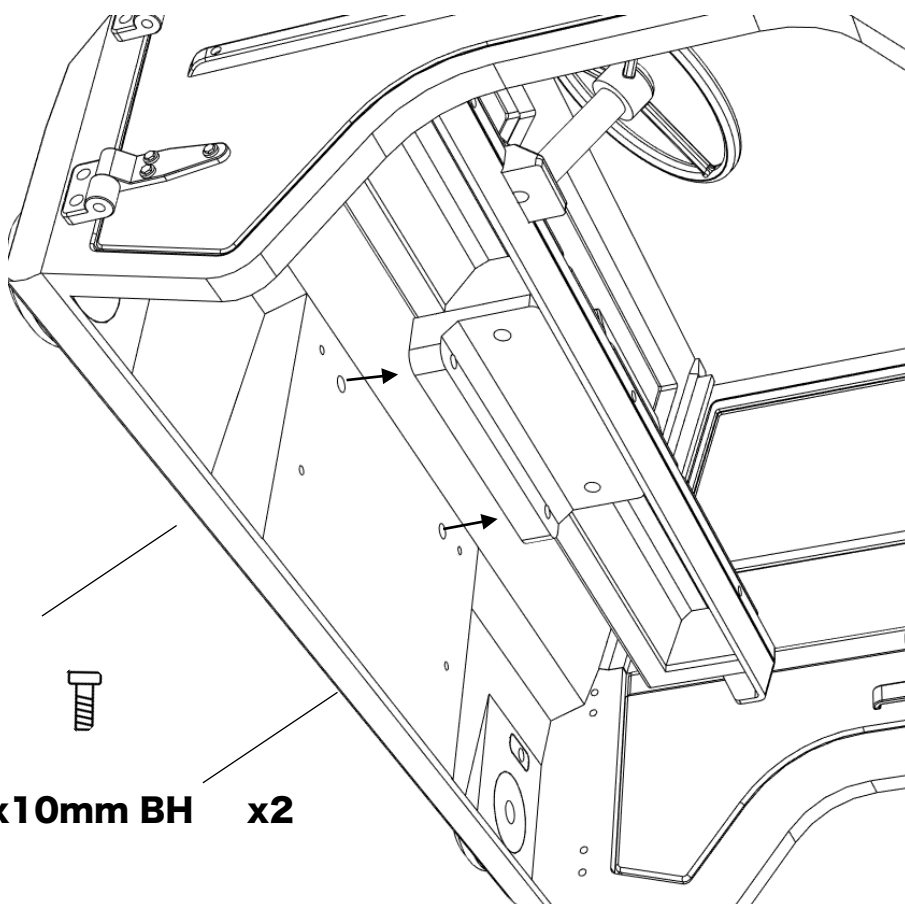

**M3x10mm BH x2**

**ahead RC**

# Installing the radiator and grille

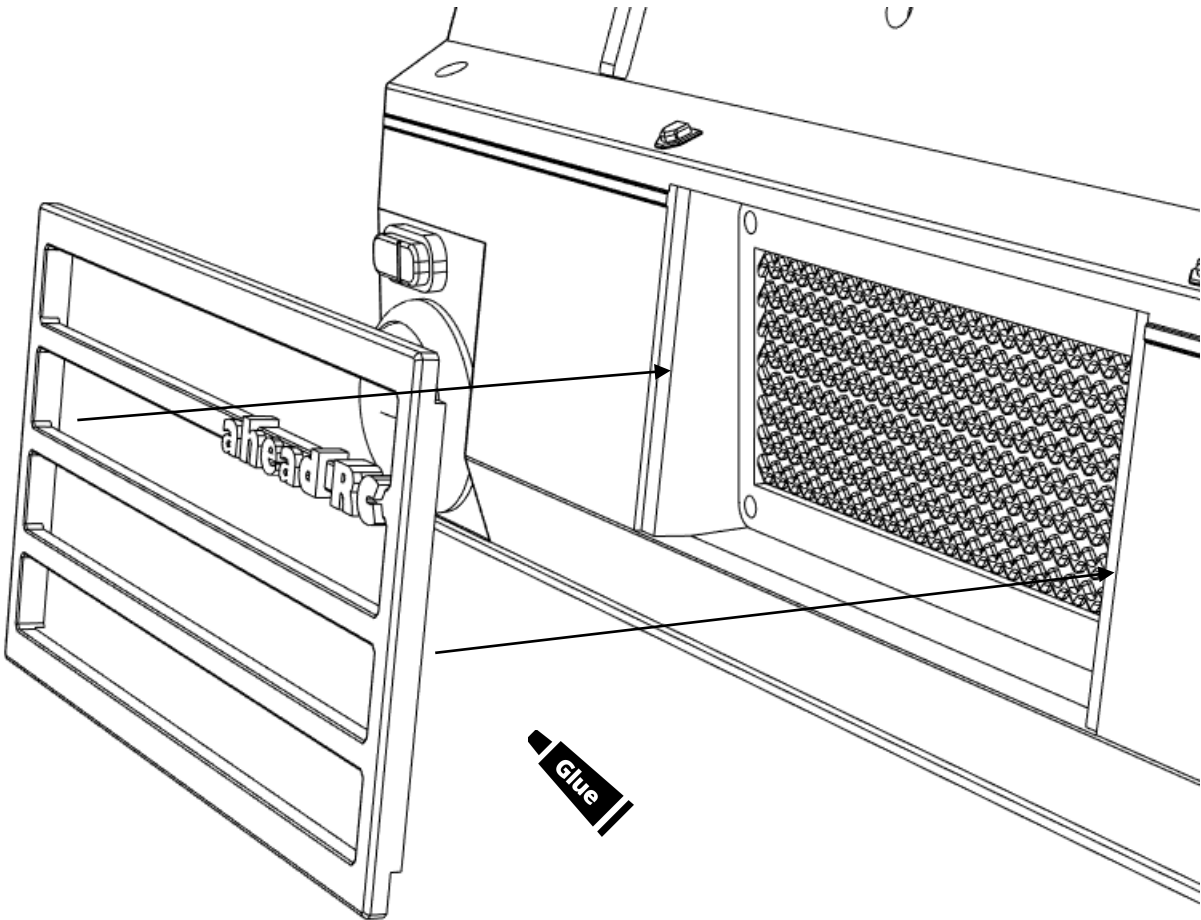
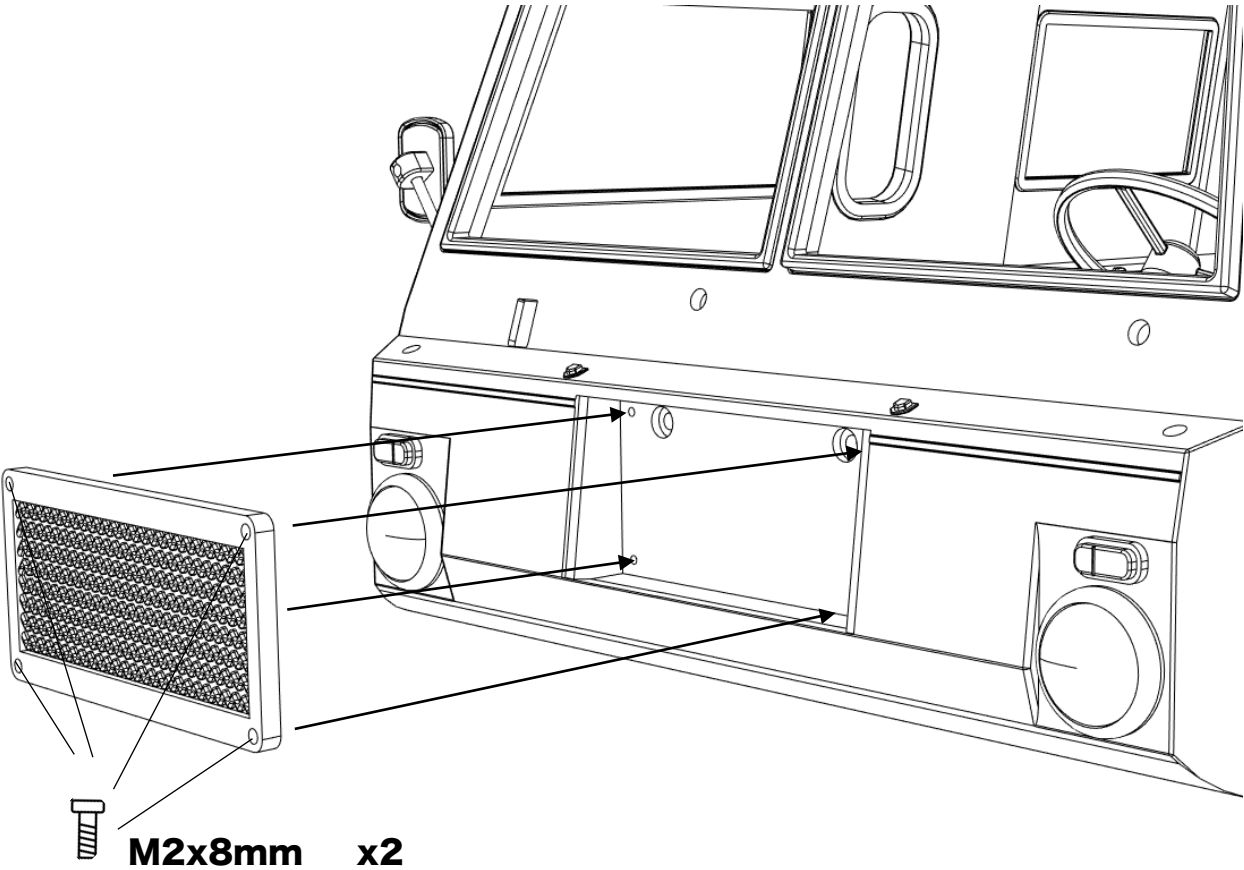

Installing the details

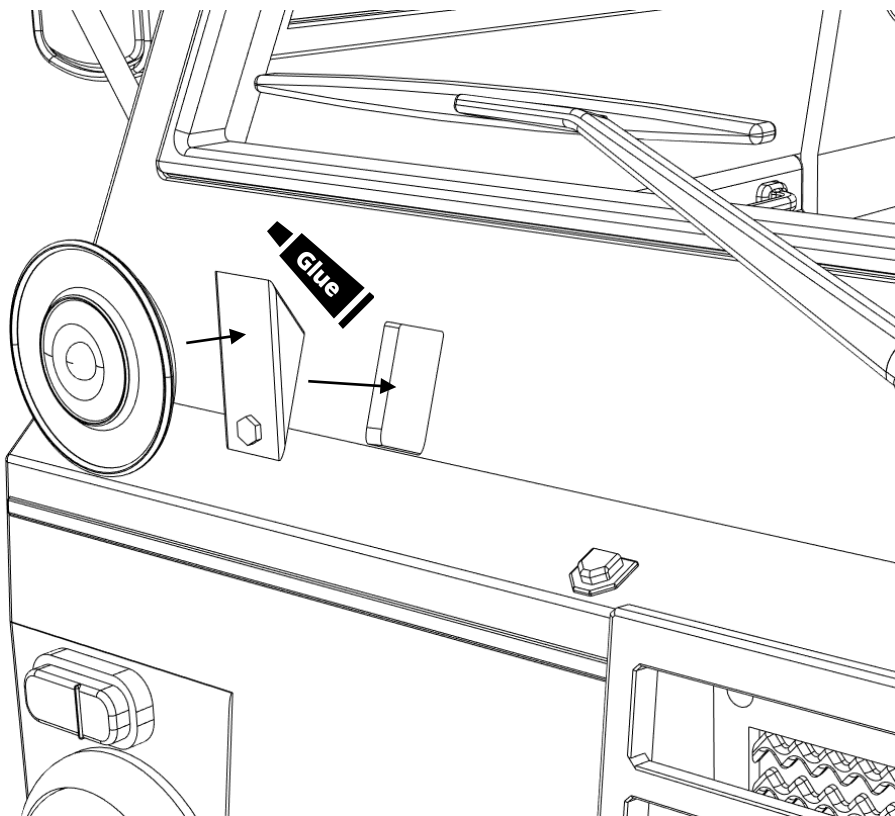
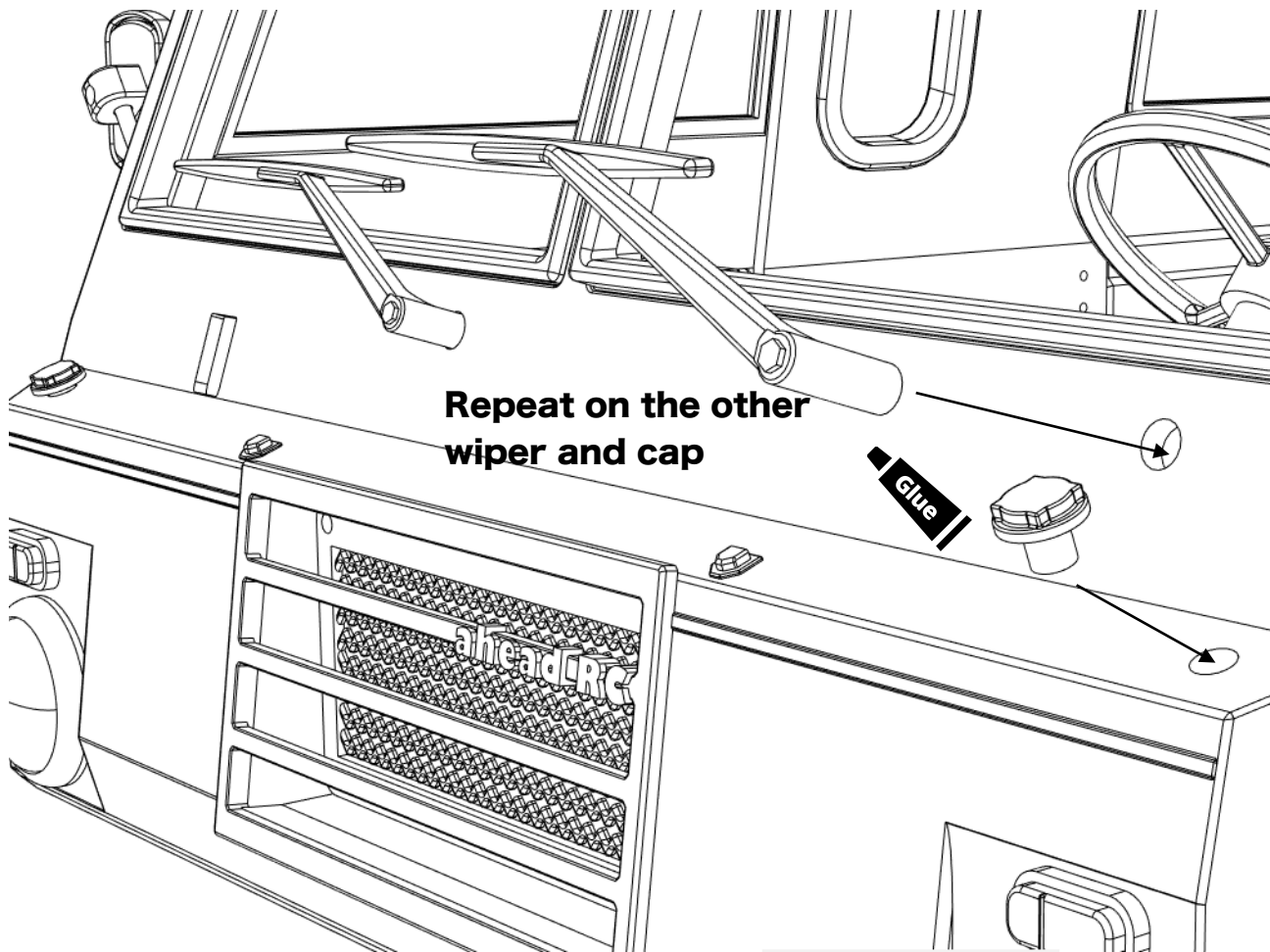

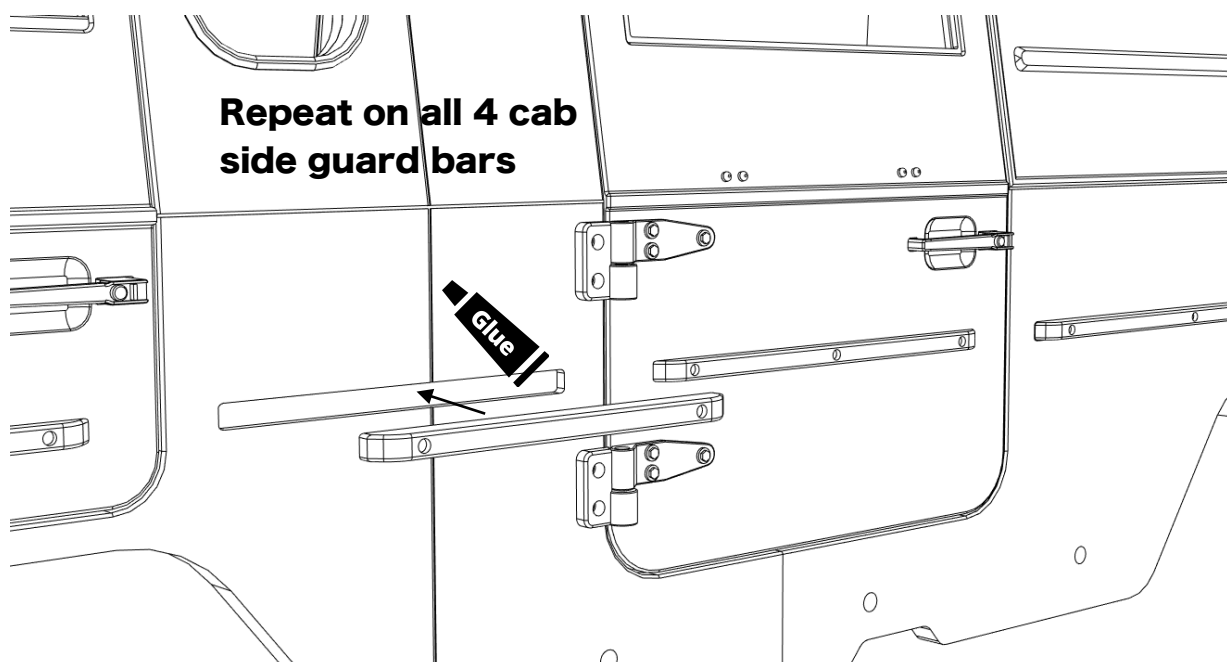

**Rear side**  
**Repeat on the other  
bracket**

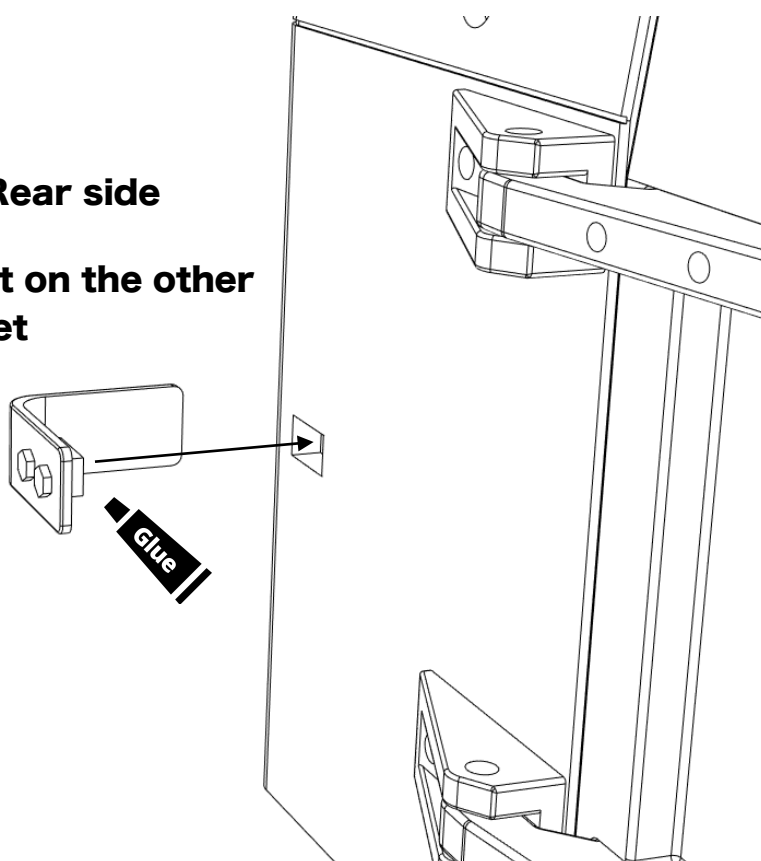



**Repeat on all 3 rear  
plate carriers**

**M2x8mm x9**

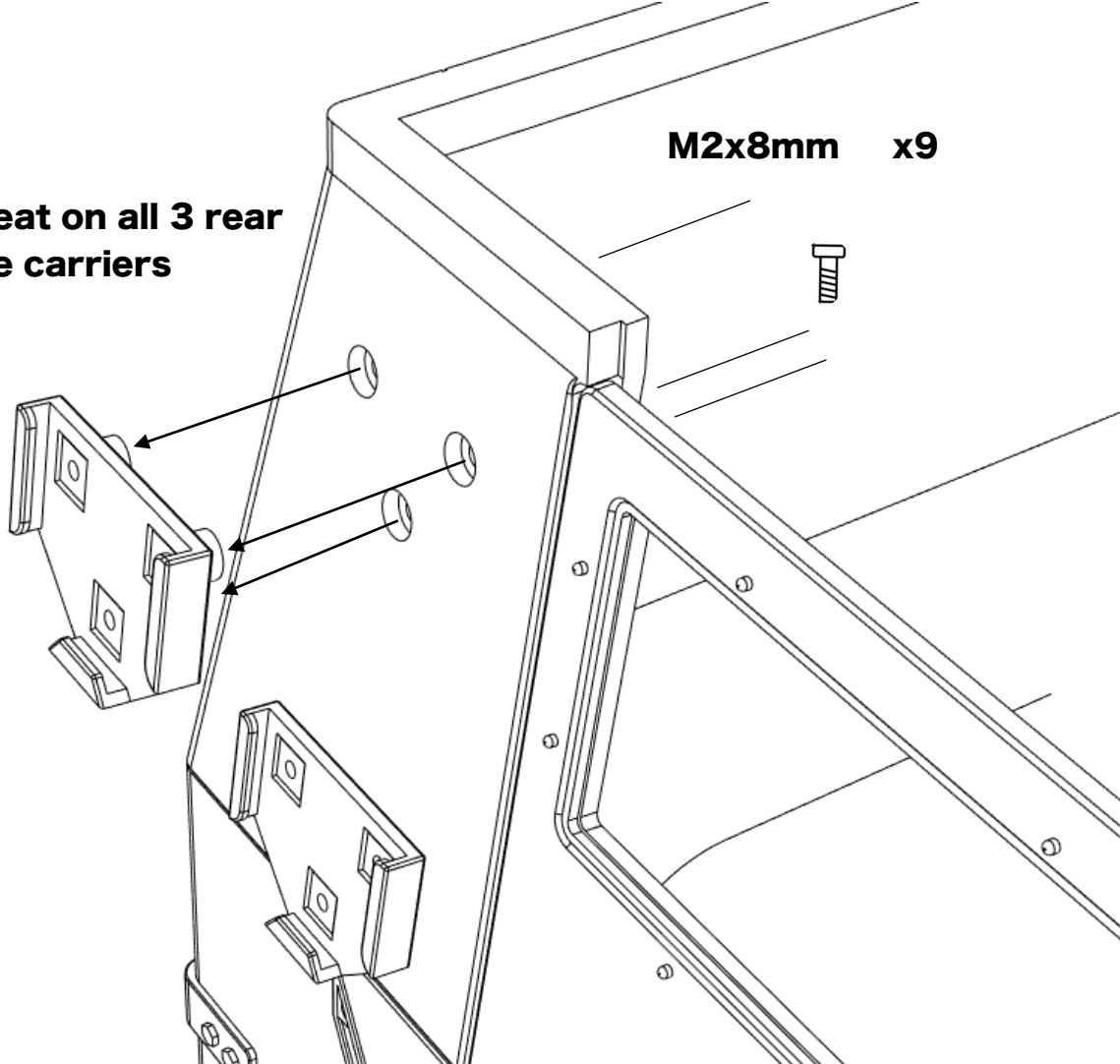

**M2x8mm x4**

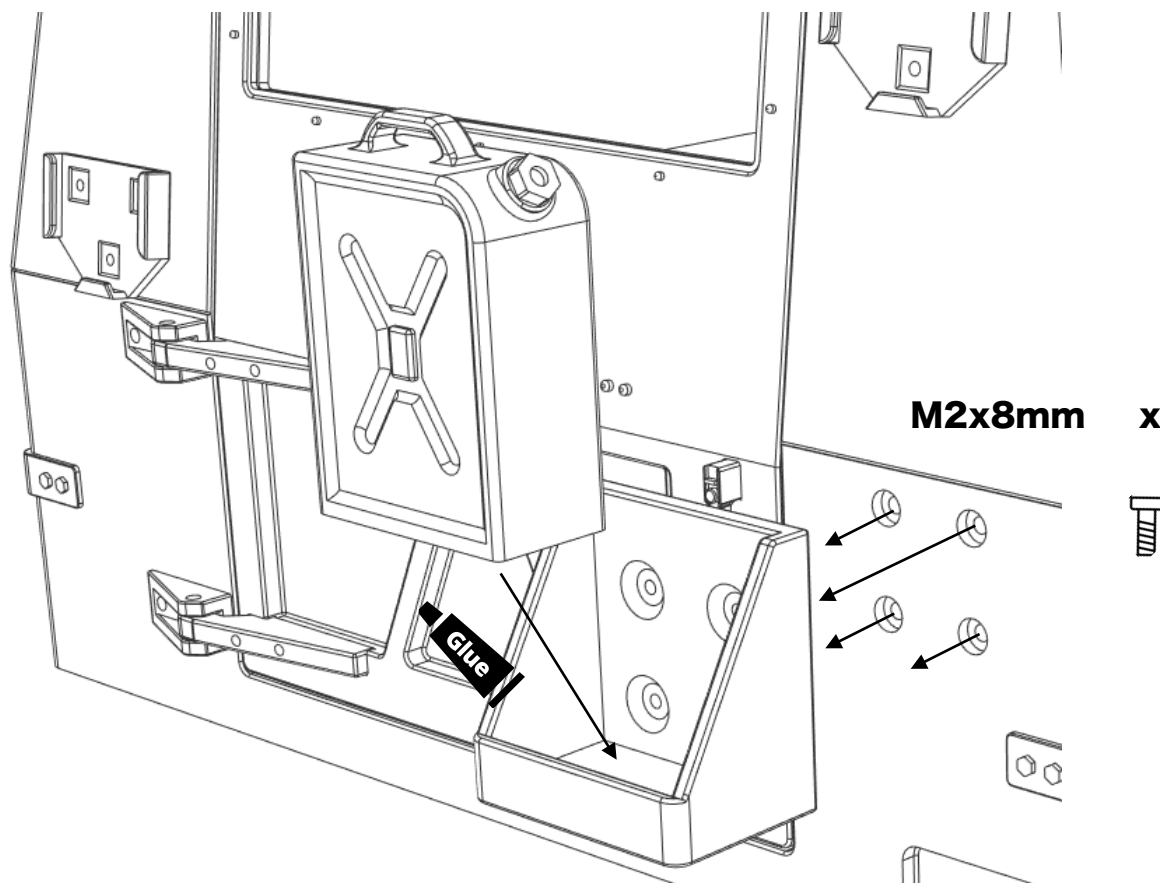

**Assembling the roof hatch**

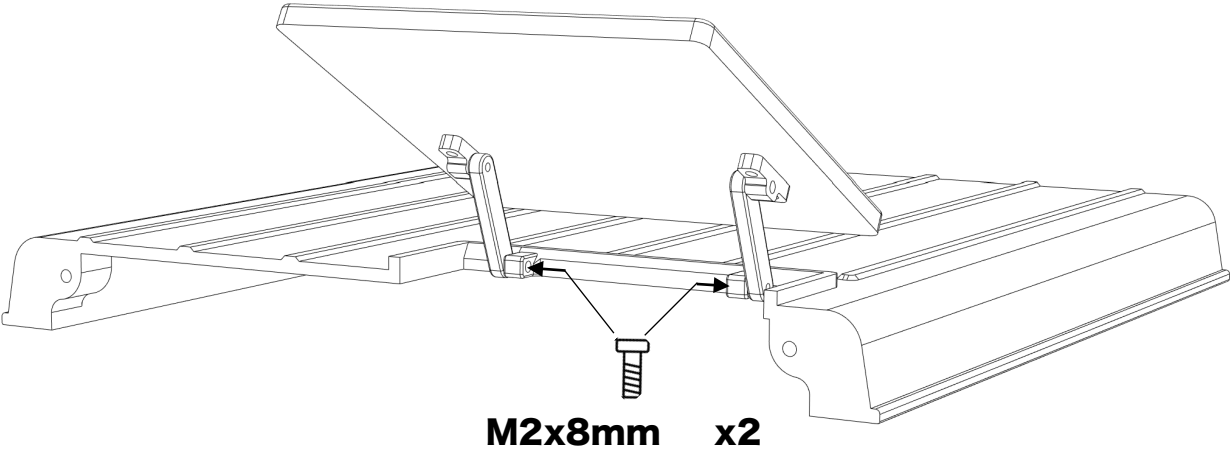
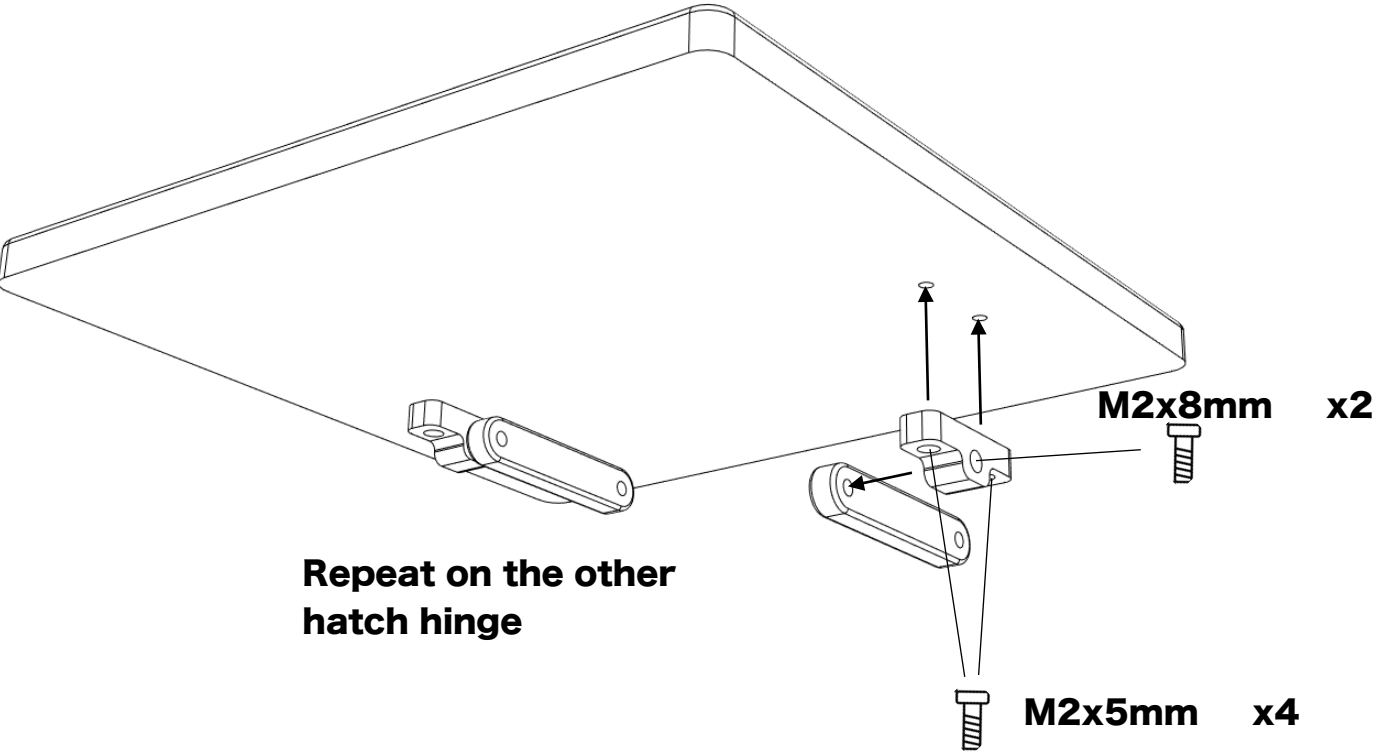

## Assembling and installing the roof

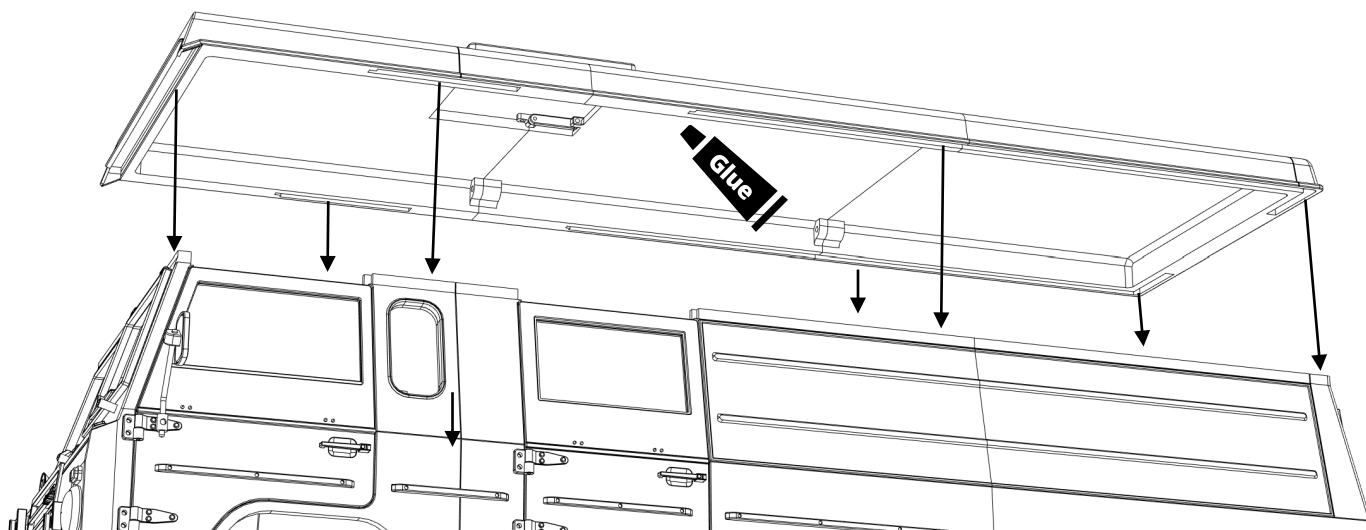
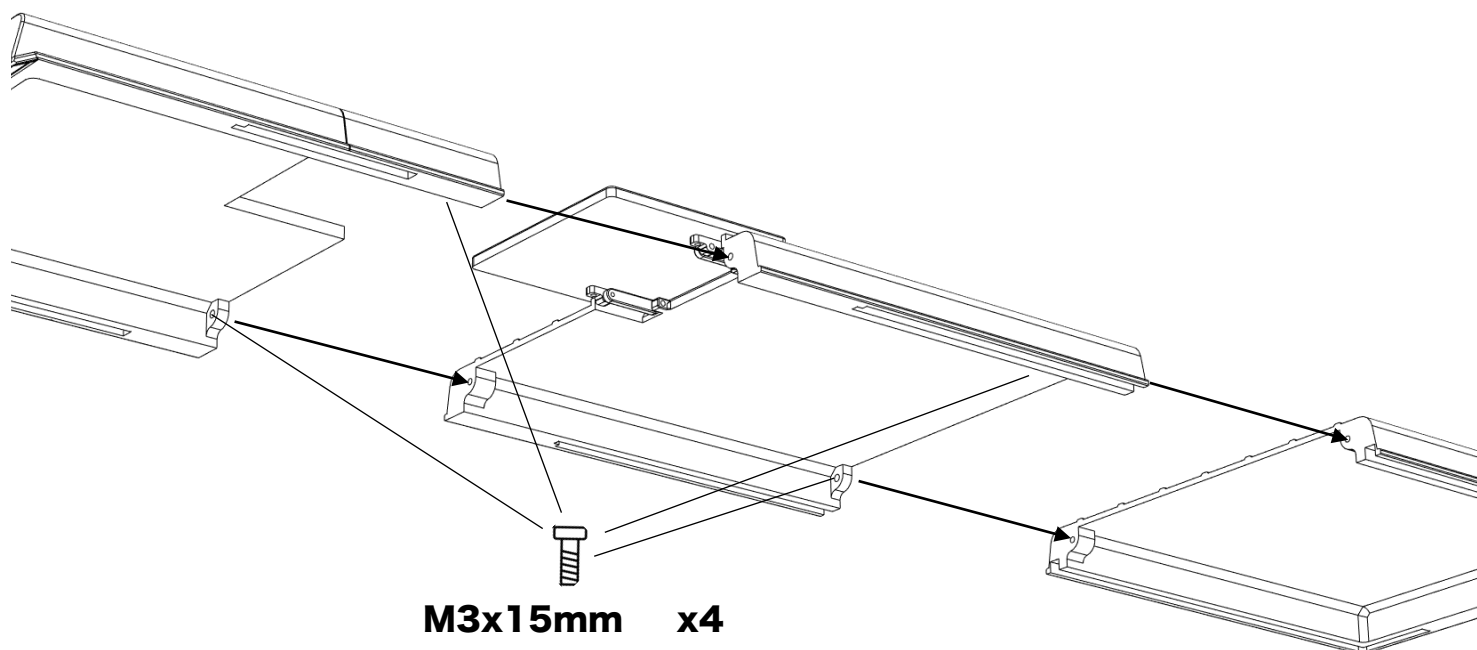

## Installing the chassis mounts

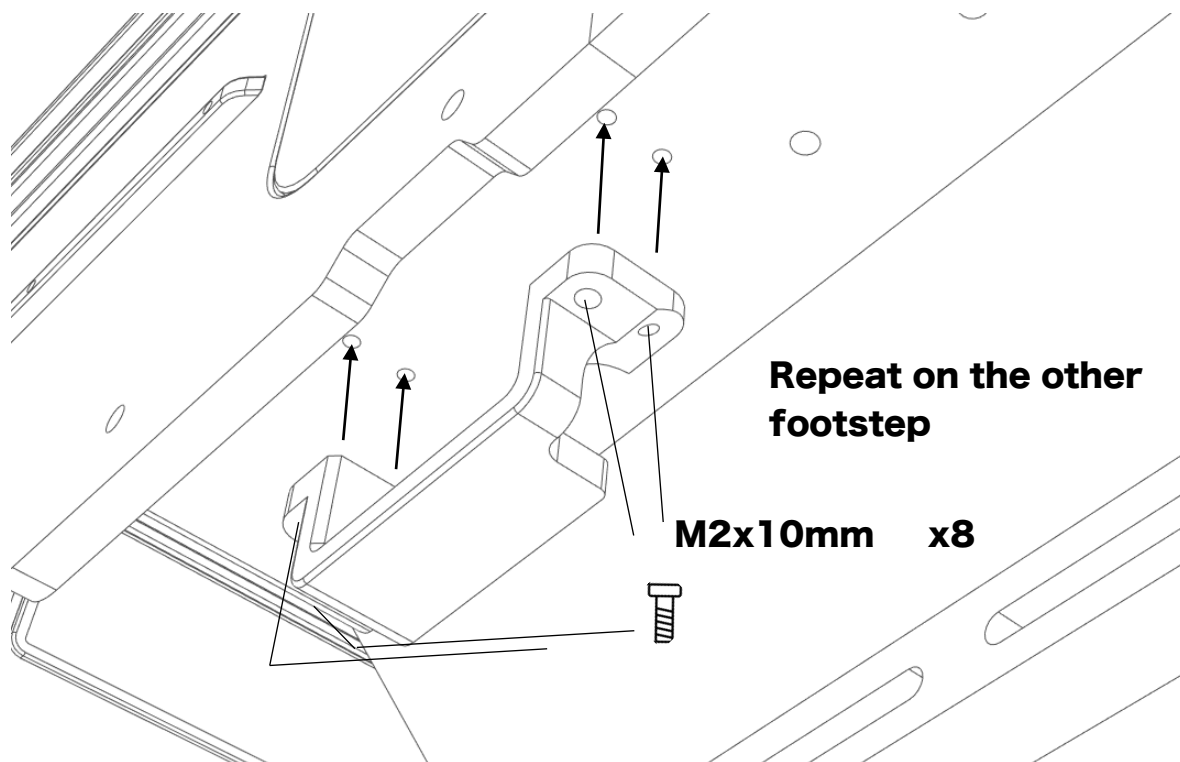
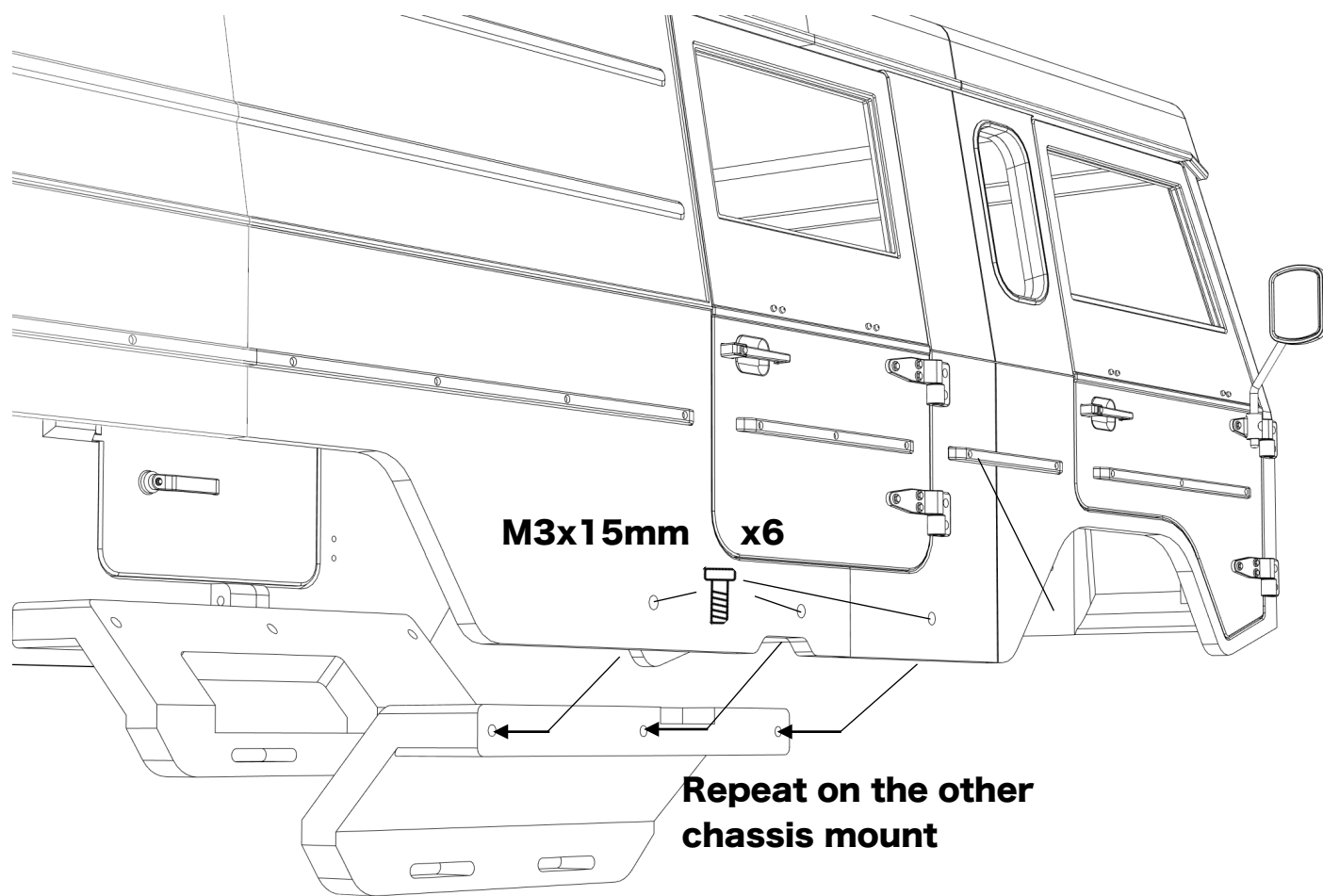

## Assembling and installing the exhaust

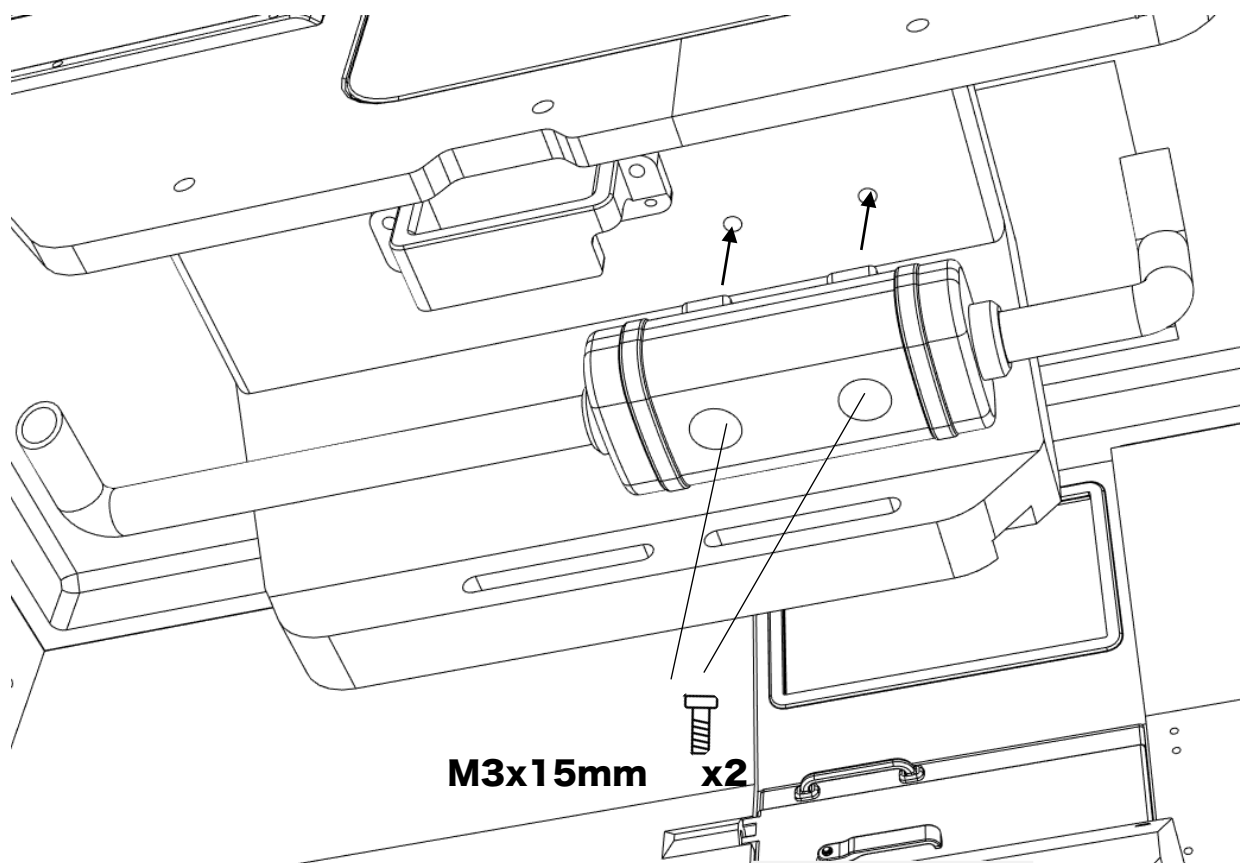
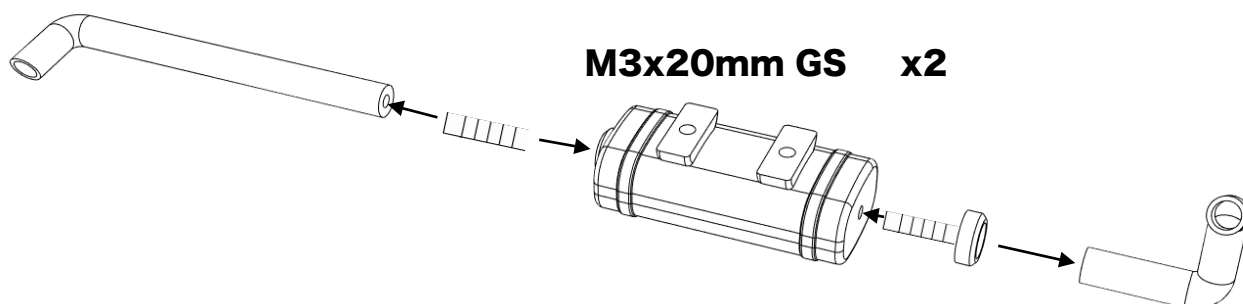

## Assembling and installing the rear bumper

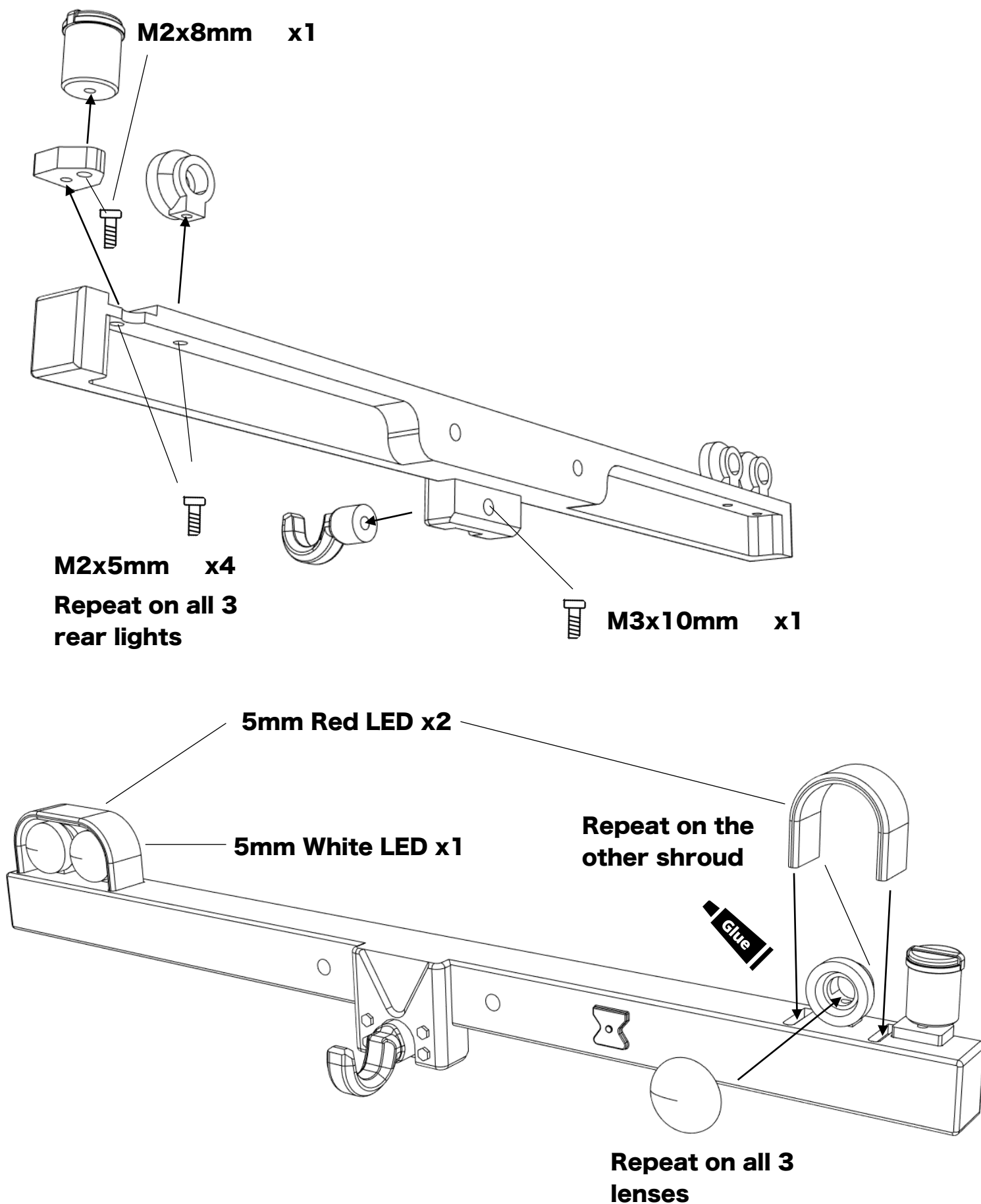

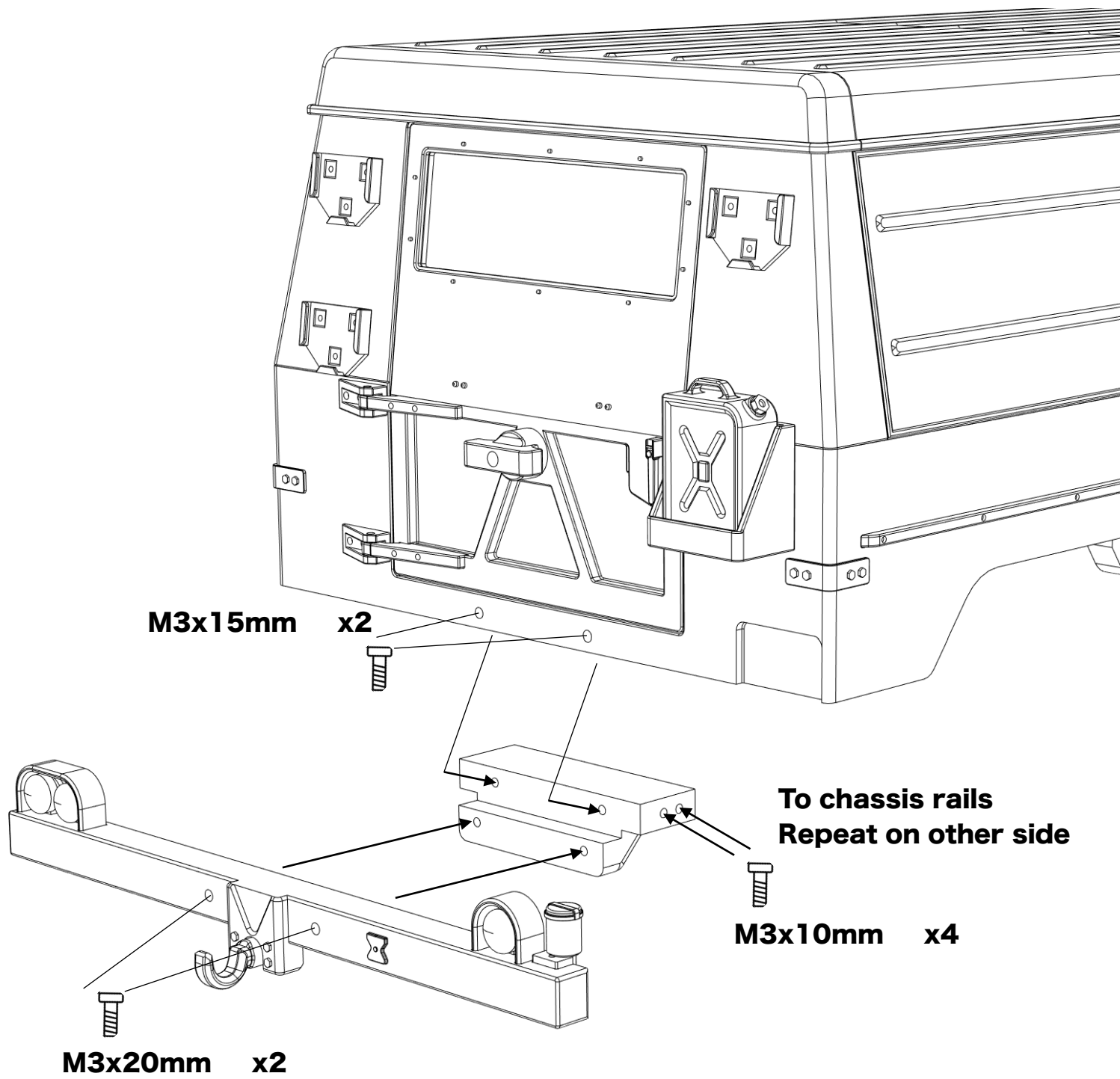

# Assembling and installing the front bumper

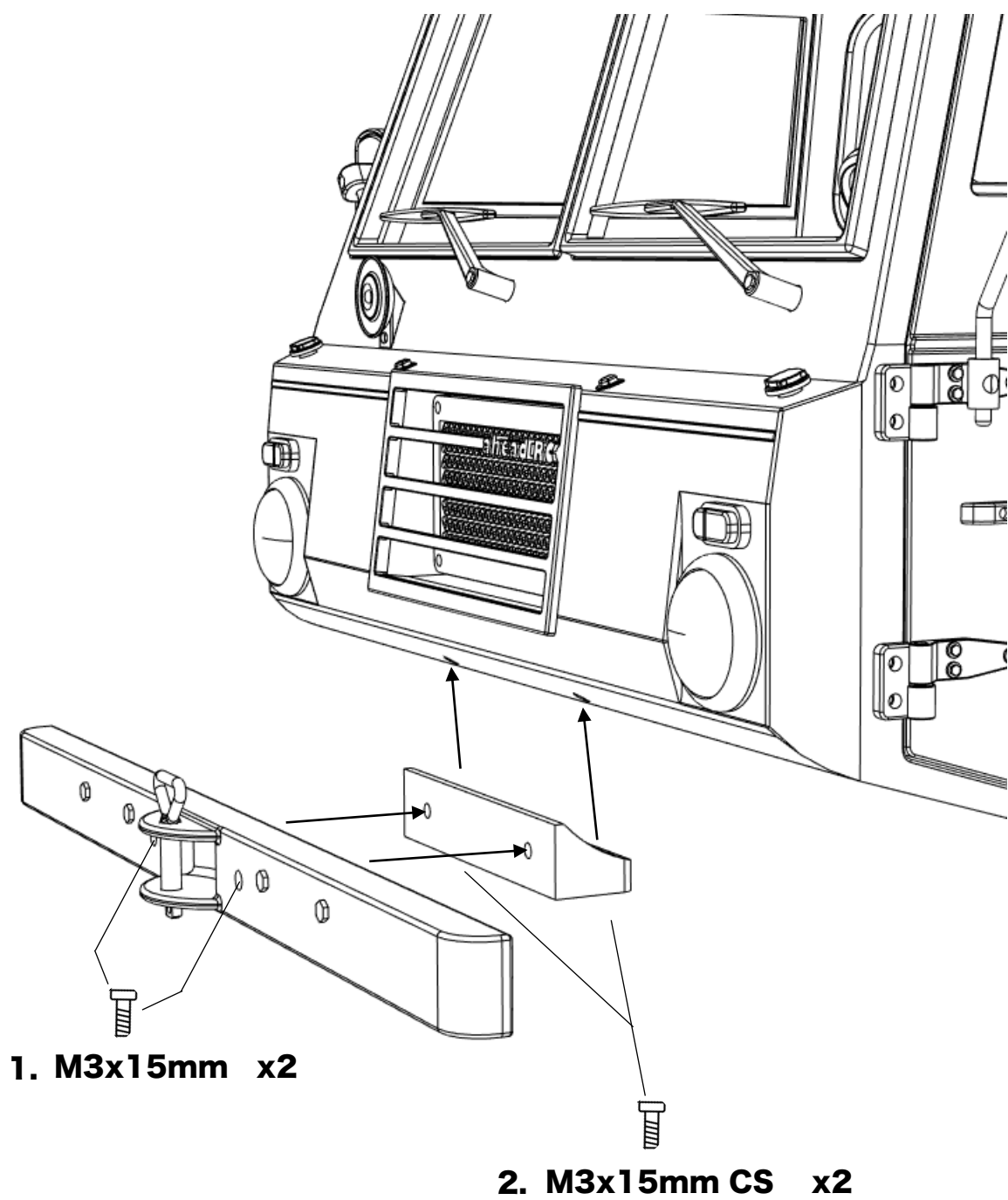



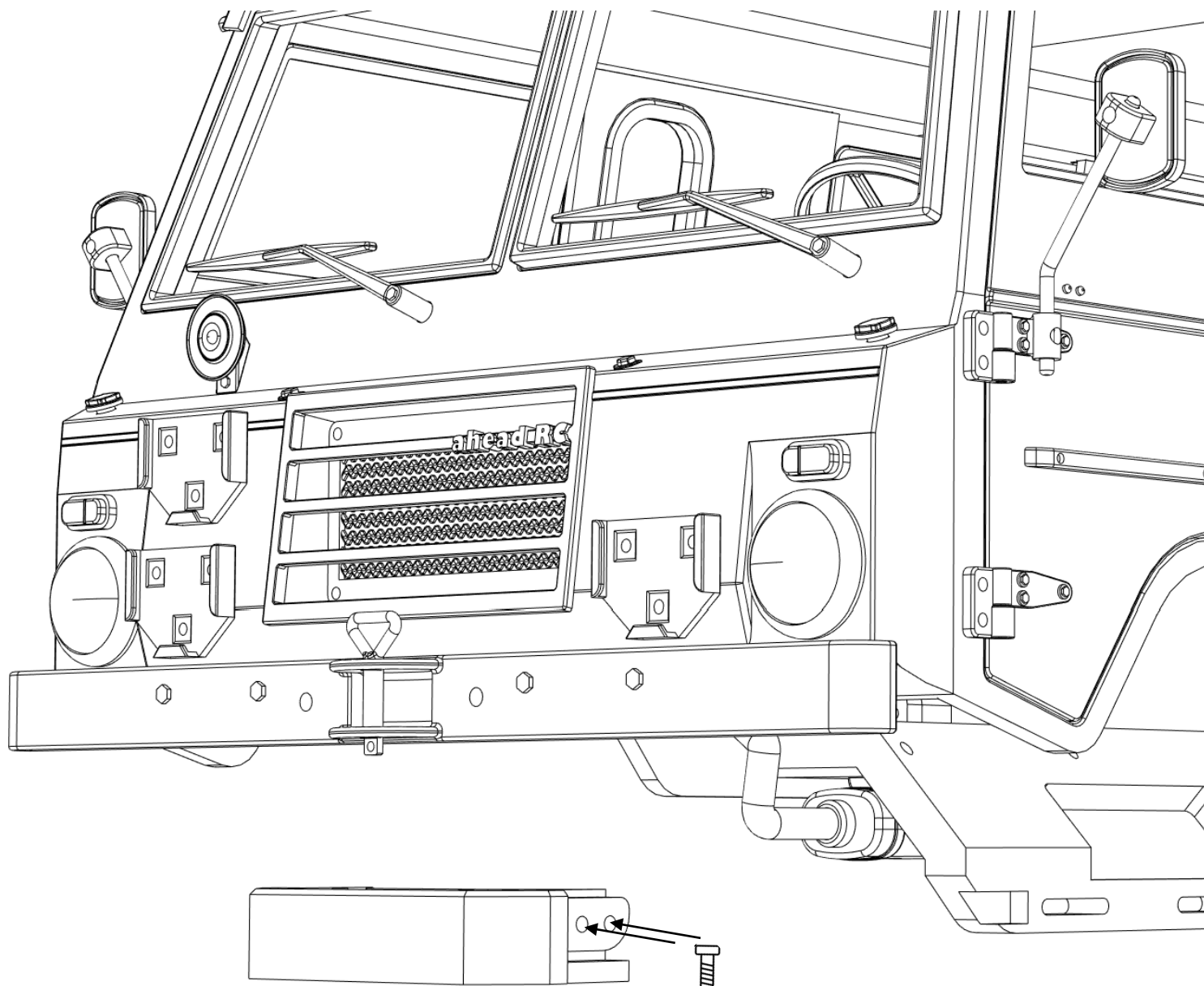

**M3x10mm x4**

**To chassis rails  
Repeat on the he  
other side**

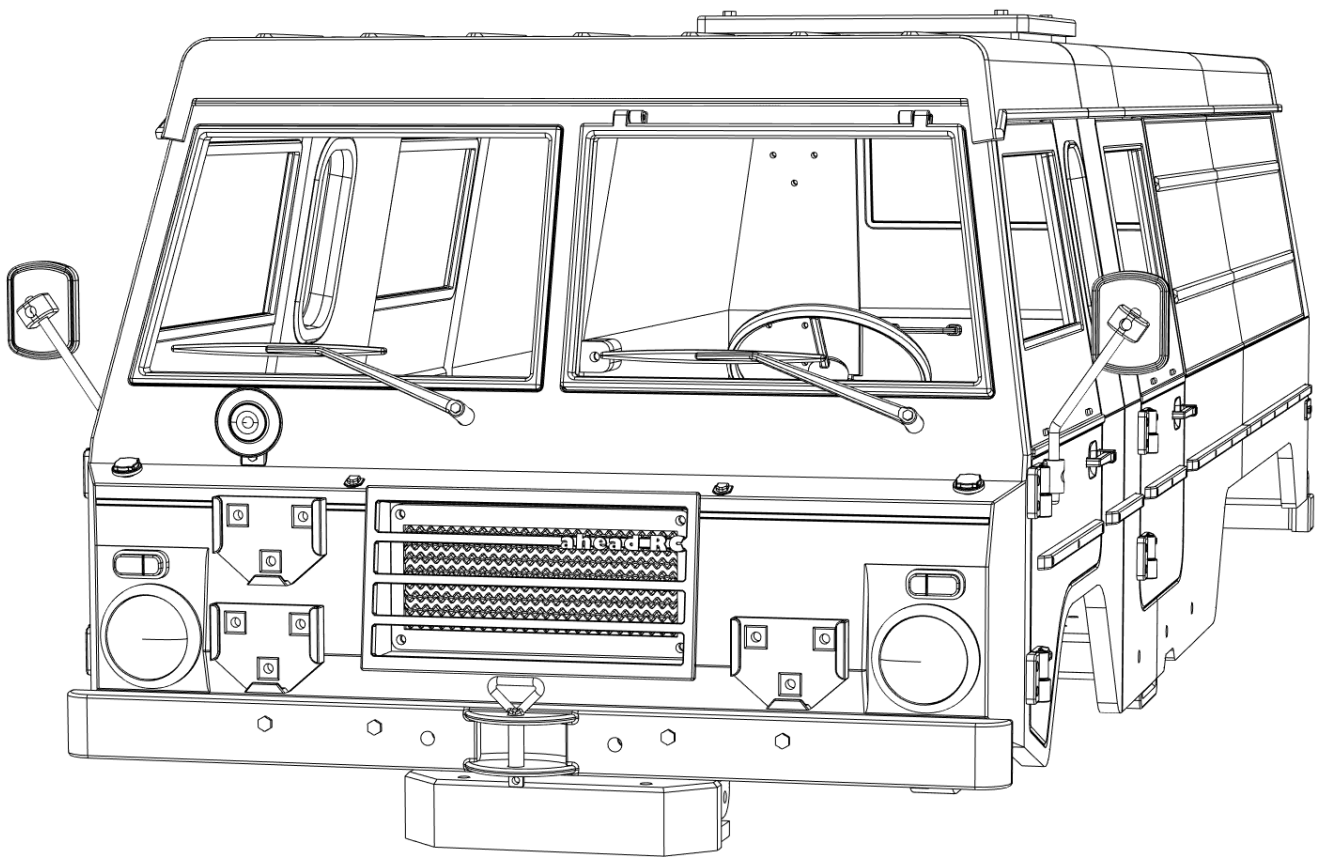

Body is now fully complete. Thank you for selecting ahead RC products.

If you have any questions or need help with the assembly, please do not hesitate to contact us at:

[aheadrc@gmail.com](mailto:aheadrc@gmail.com)

or visit us at:

[www.aheadrc.com](http://www.aheadrc.com)

## Best of luck with your build!