

ahead RC Crawler

G90 Sleeper Cab

for CR18P 6x6

Assembly Manual



Required tools and hardware

Tools

- 1.5mm Hex Driver
- 2.5mm Hex Driver
- Needle Nosed Pliers
- Instant Glue
- Hot Glue

Electronics

- 3mm LED White x8
- 3mm LED Orange x10

Hardware

Hardware	Quantity	Check
M2*5 Socket head	16	
M2*8 Socket head	7	
M2*10 Socket head	28	
M3*10 Socket head	2	
10x2mm magnet	18	

Before you begin

- It is recommended to use the lower shock mounting holes to raise the chassis to accommodate the body
- It is required to remove the following stock items on the chassis:
 - o Cab, bed, rear bumper, front fenders, receiver, lights, fuel tanks
- It is recommended to use the stock rear sway bars to prevent excessive body roll
- Be sure to read through the manual and familiarise yourself with the instructions
- Visualise a plan to assemble all the pieces
- Make sure you have all of the hardware and tools
- Be sure to have enough instant glue
- Dry fit all parts before painting and assembling
- Tip: It will help to paint all of the parts before final assembly

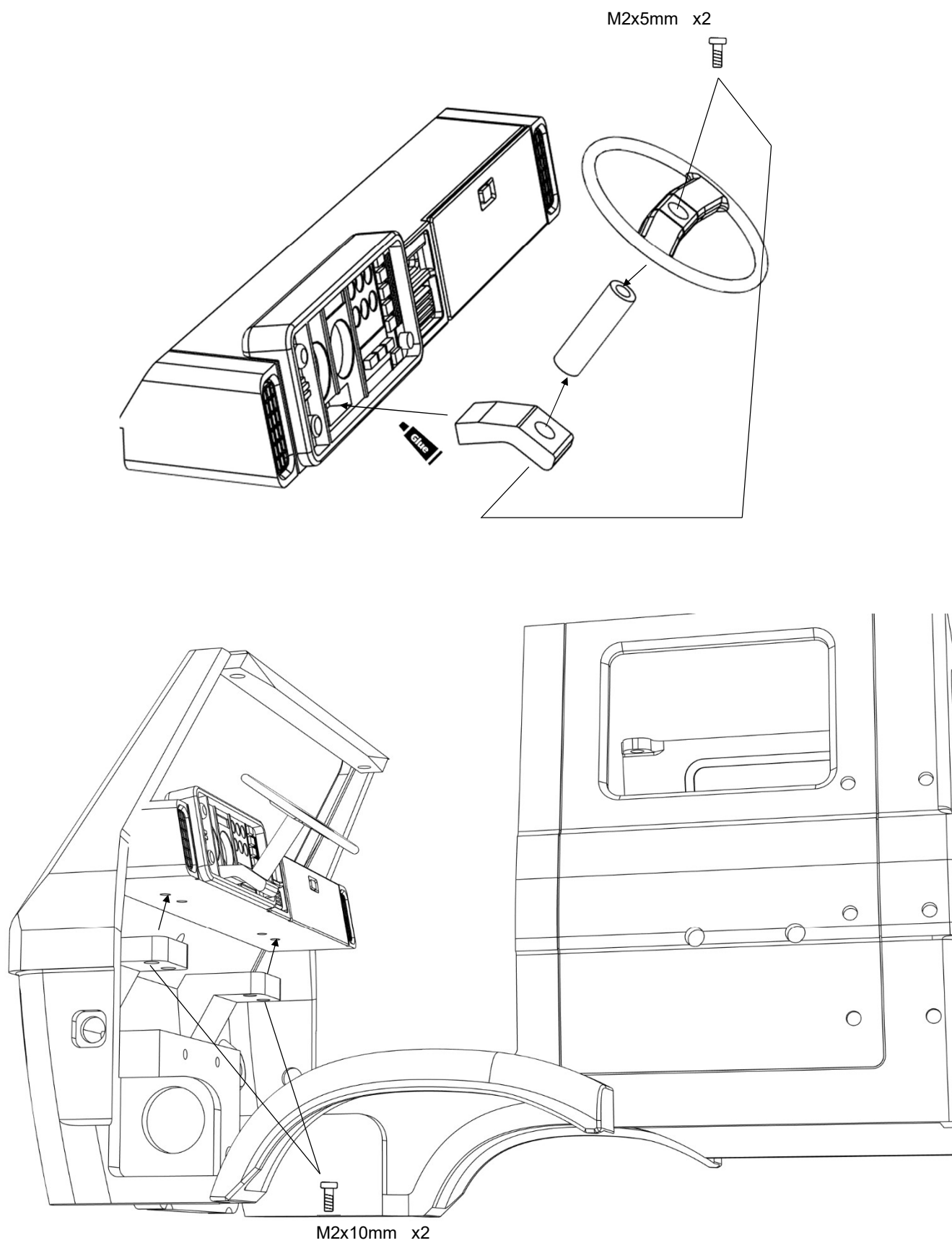

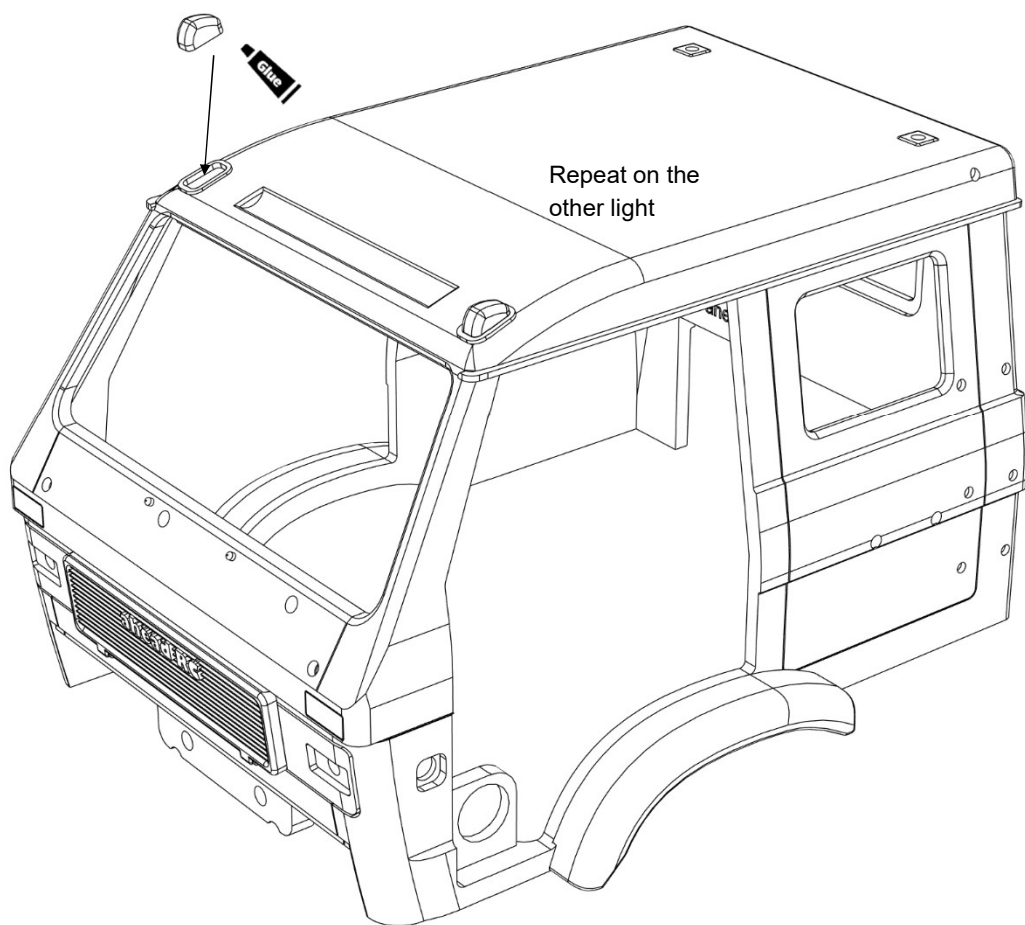
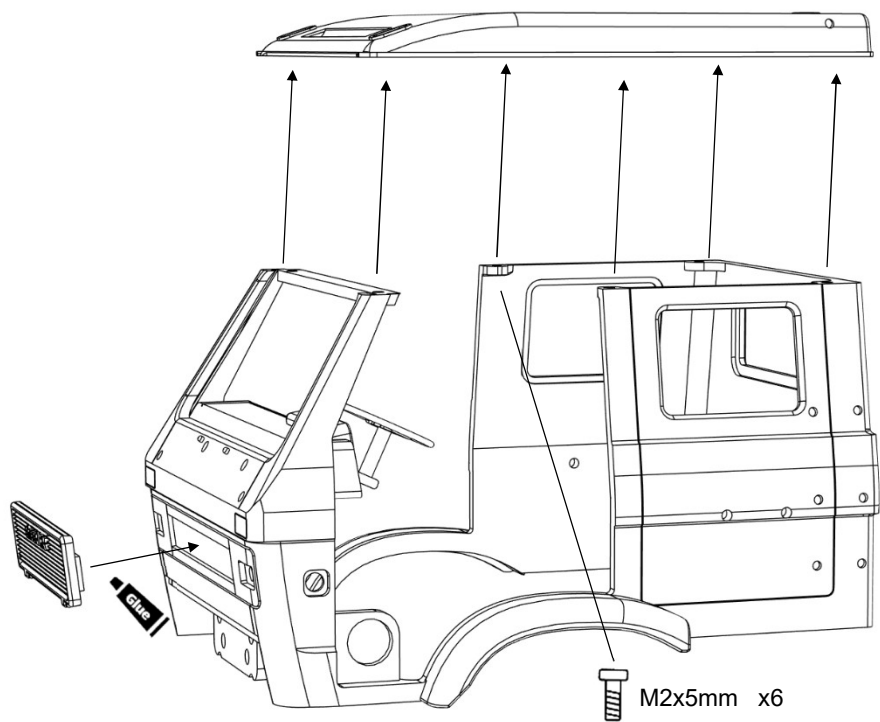

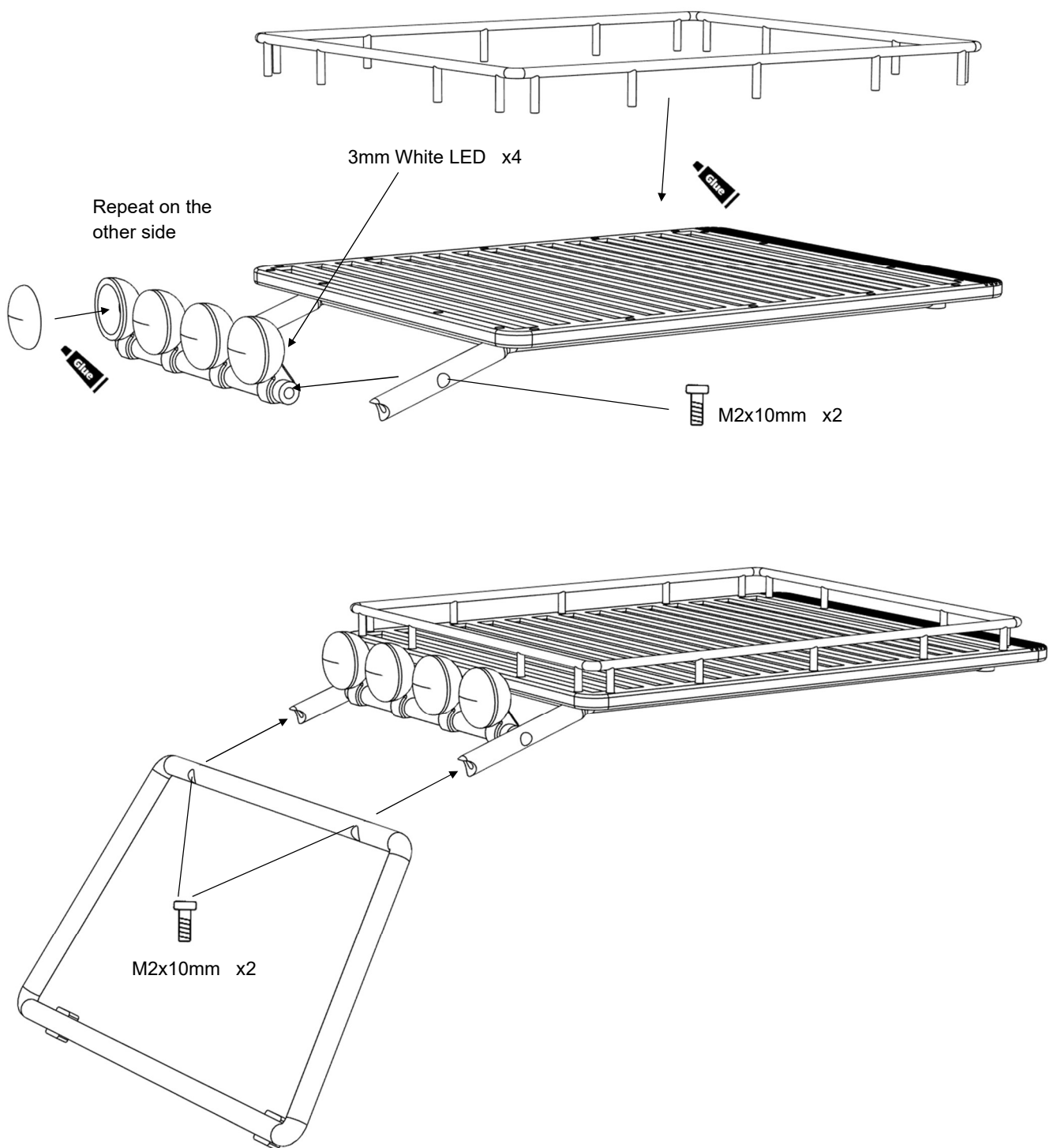

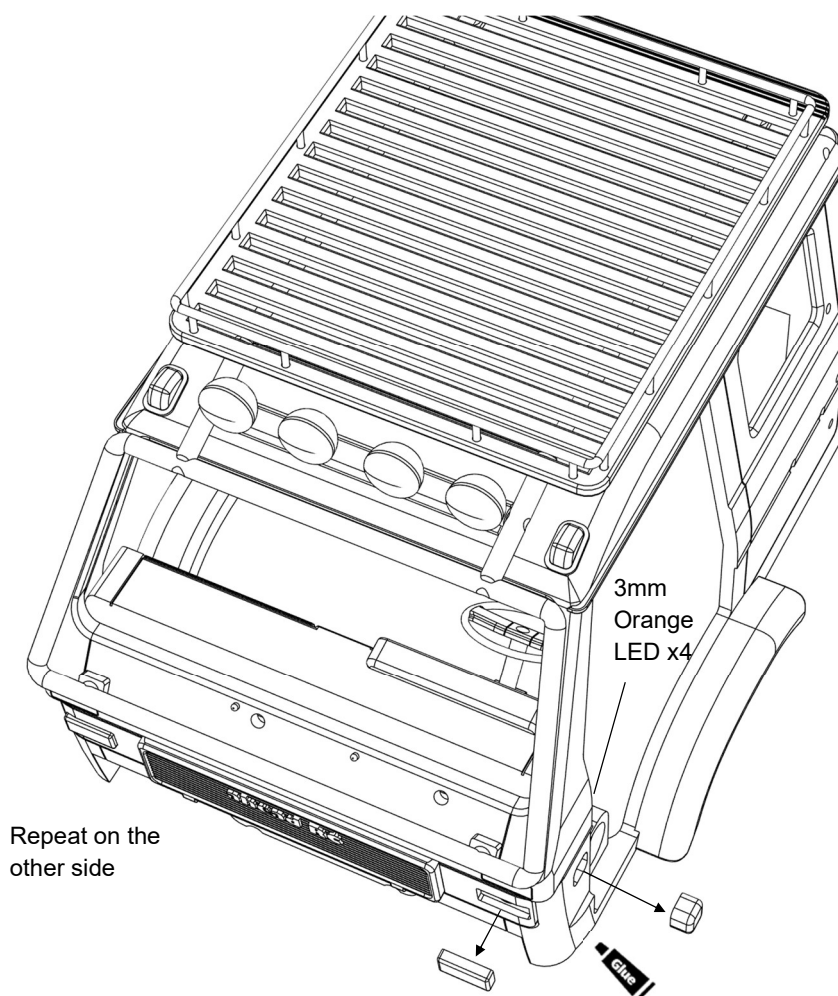
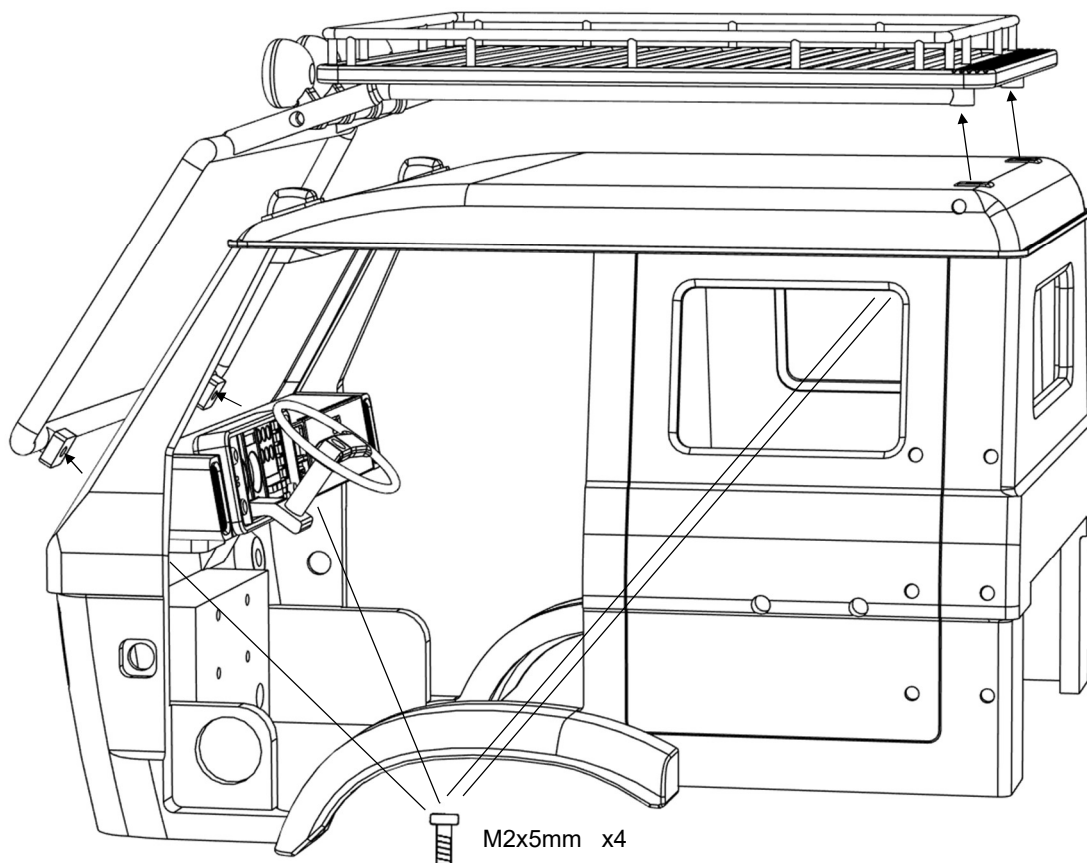

Bumper style 1

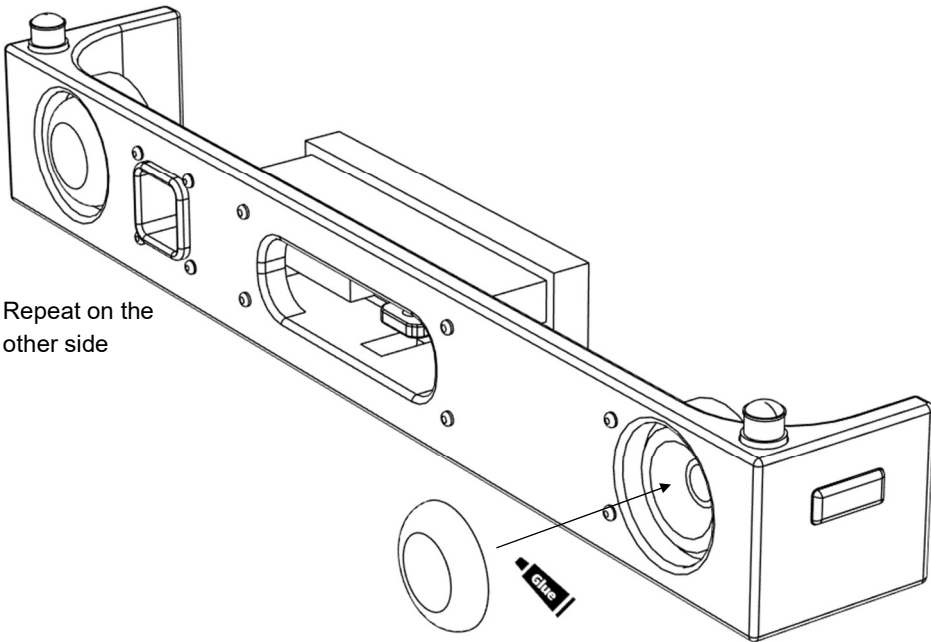

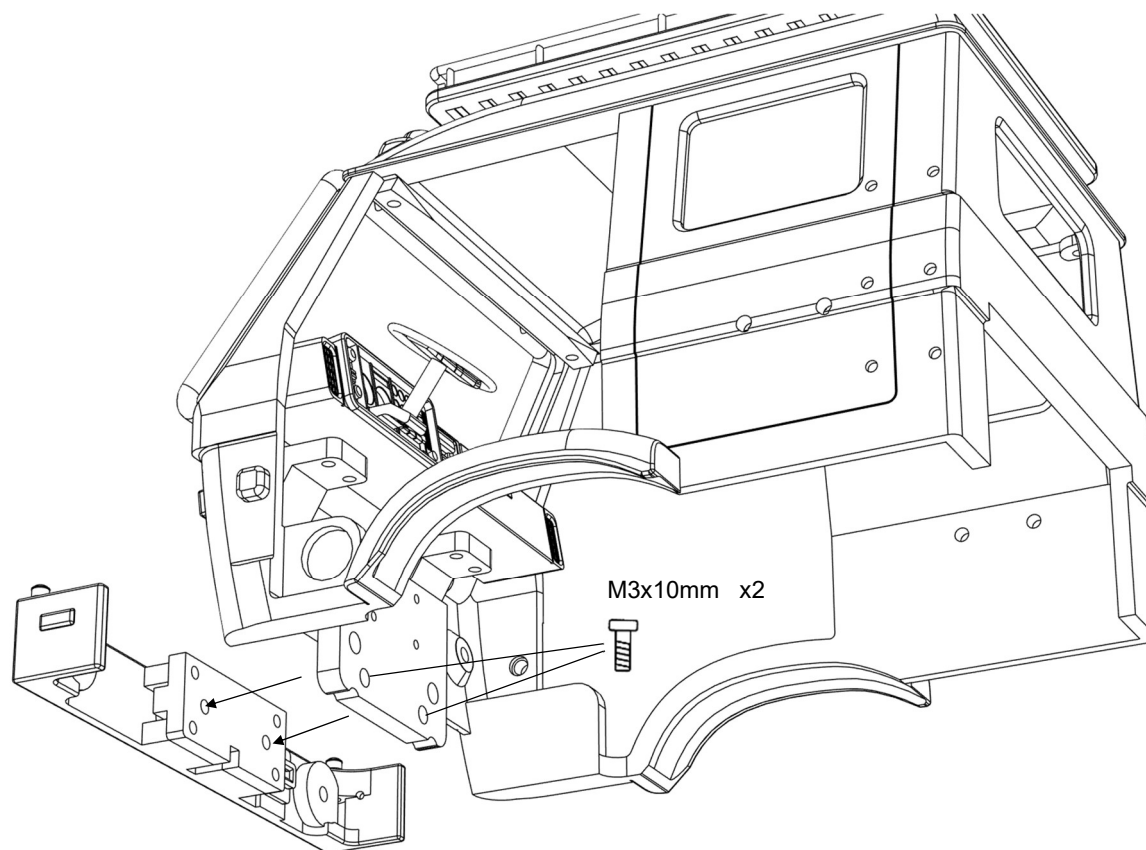

Bumper style 2

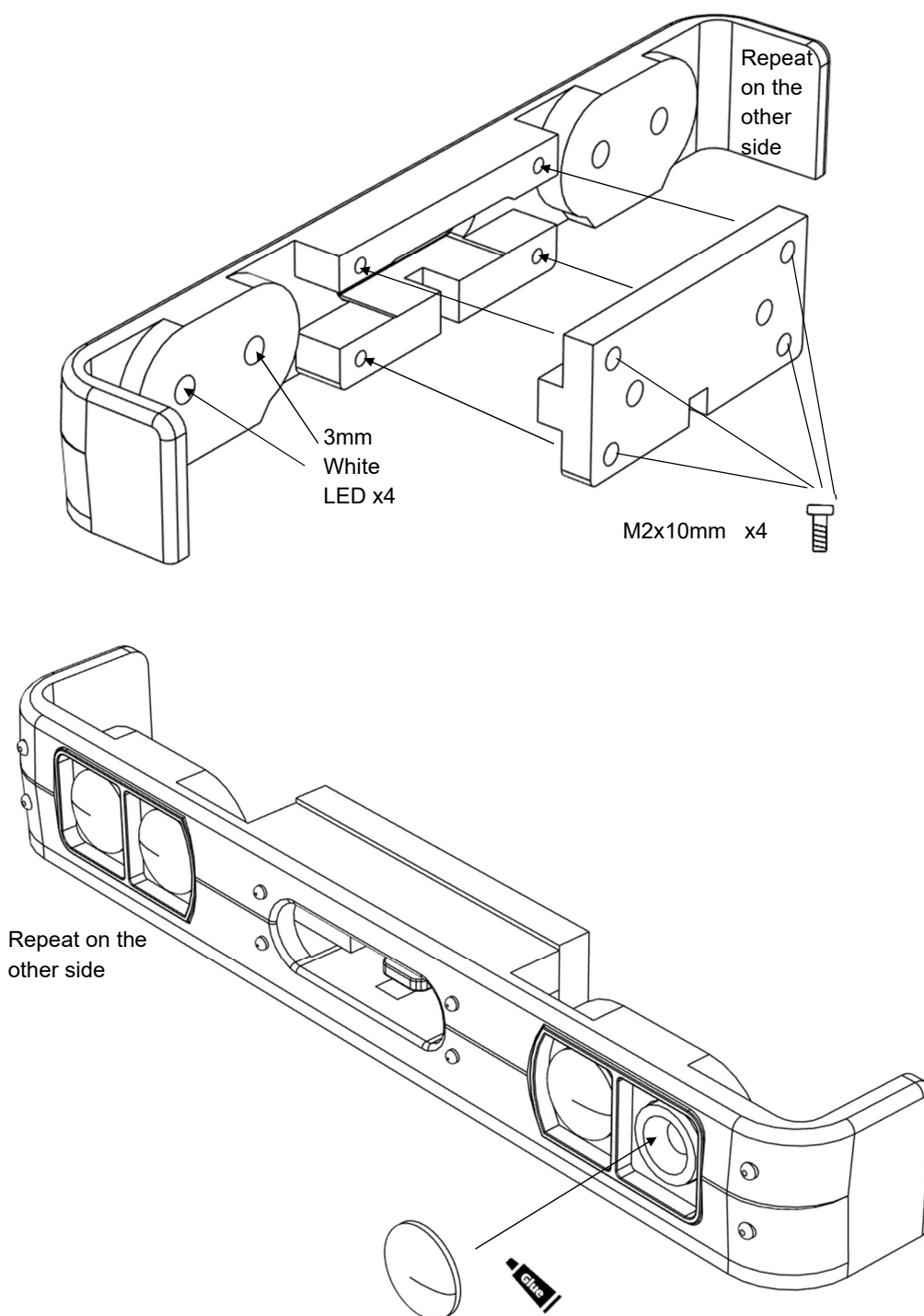

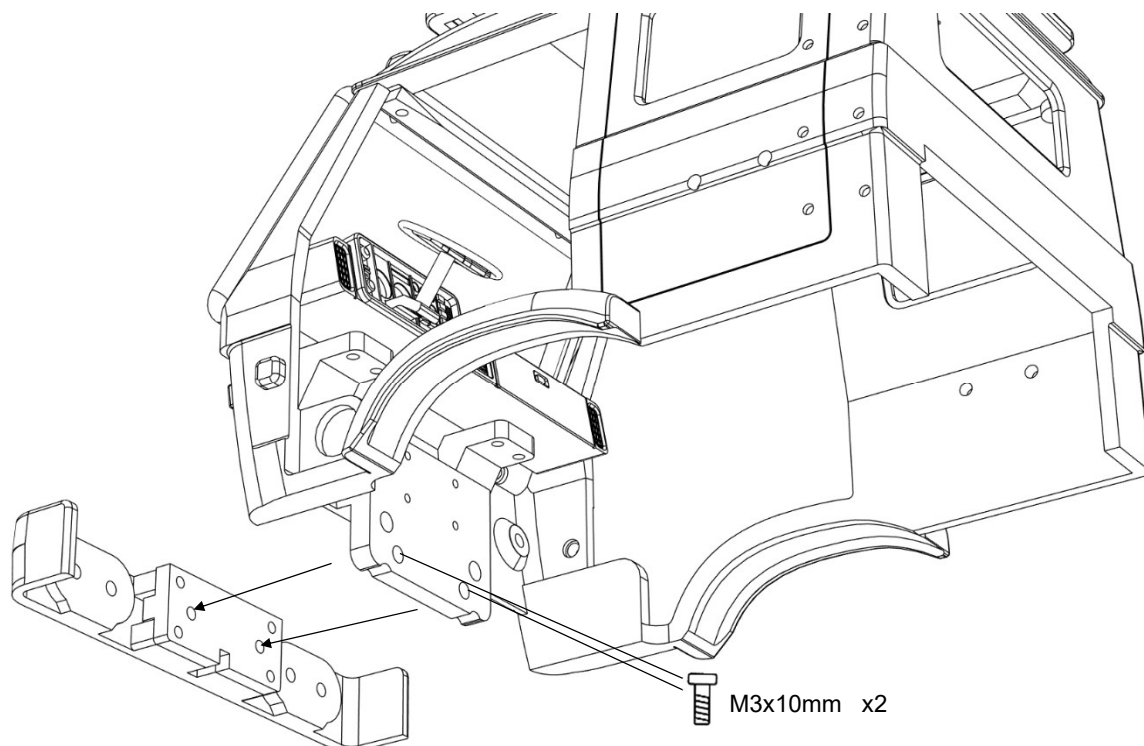

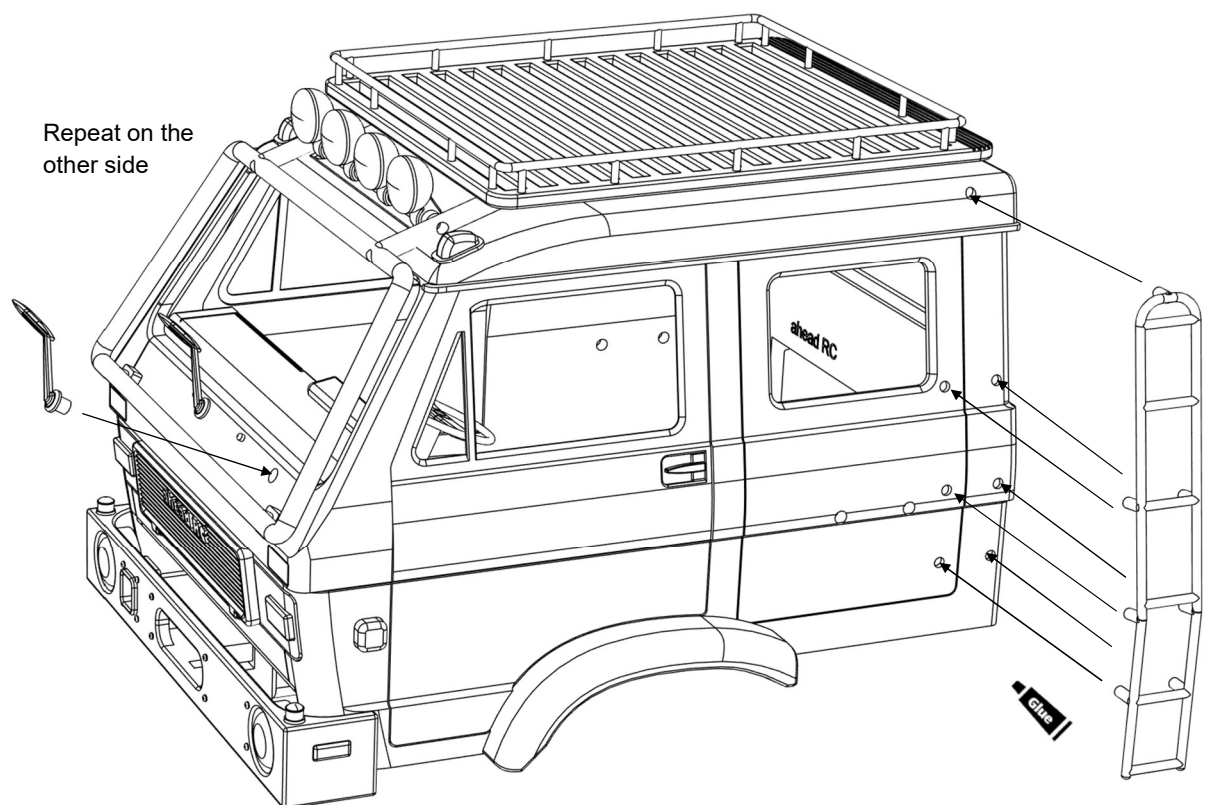
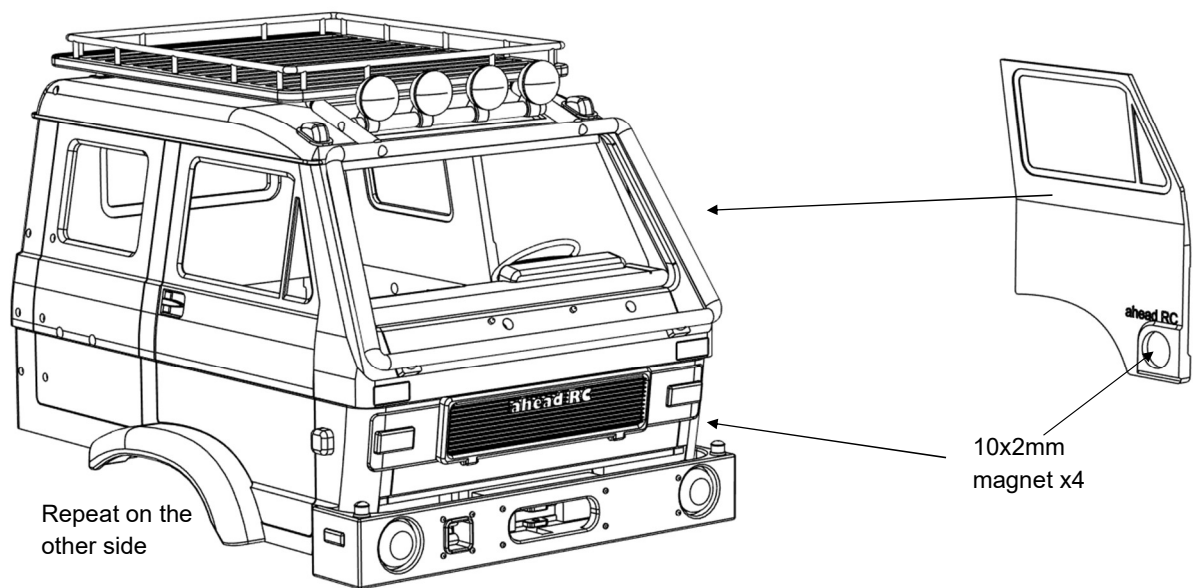

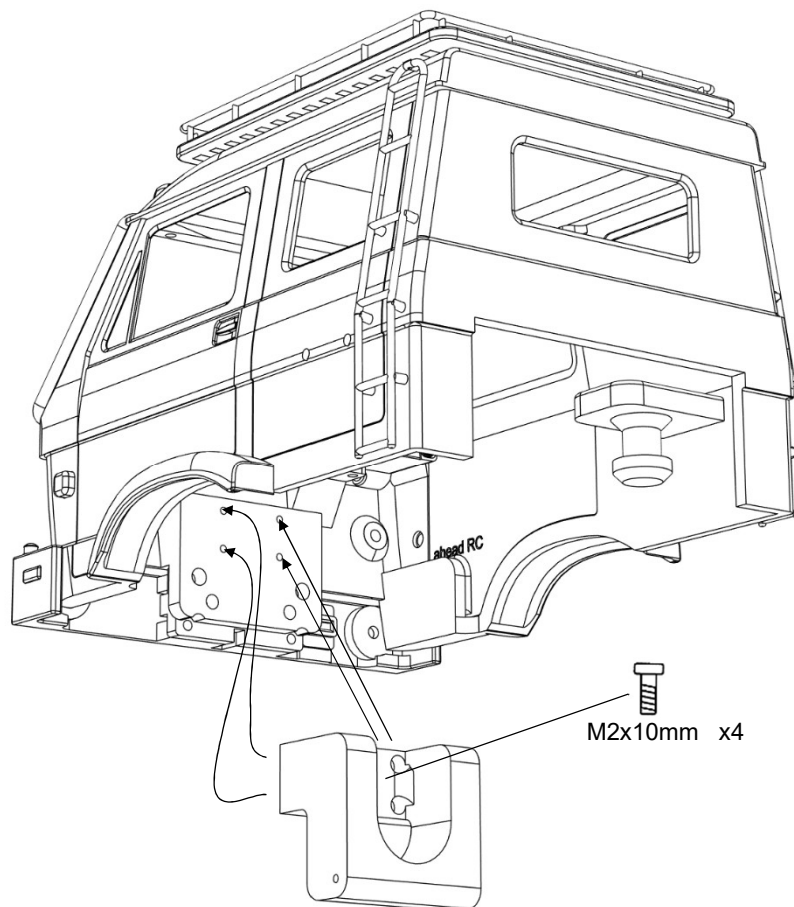
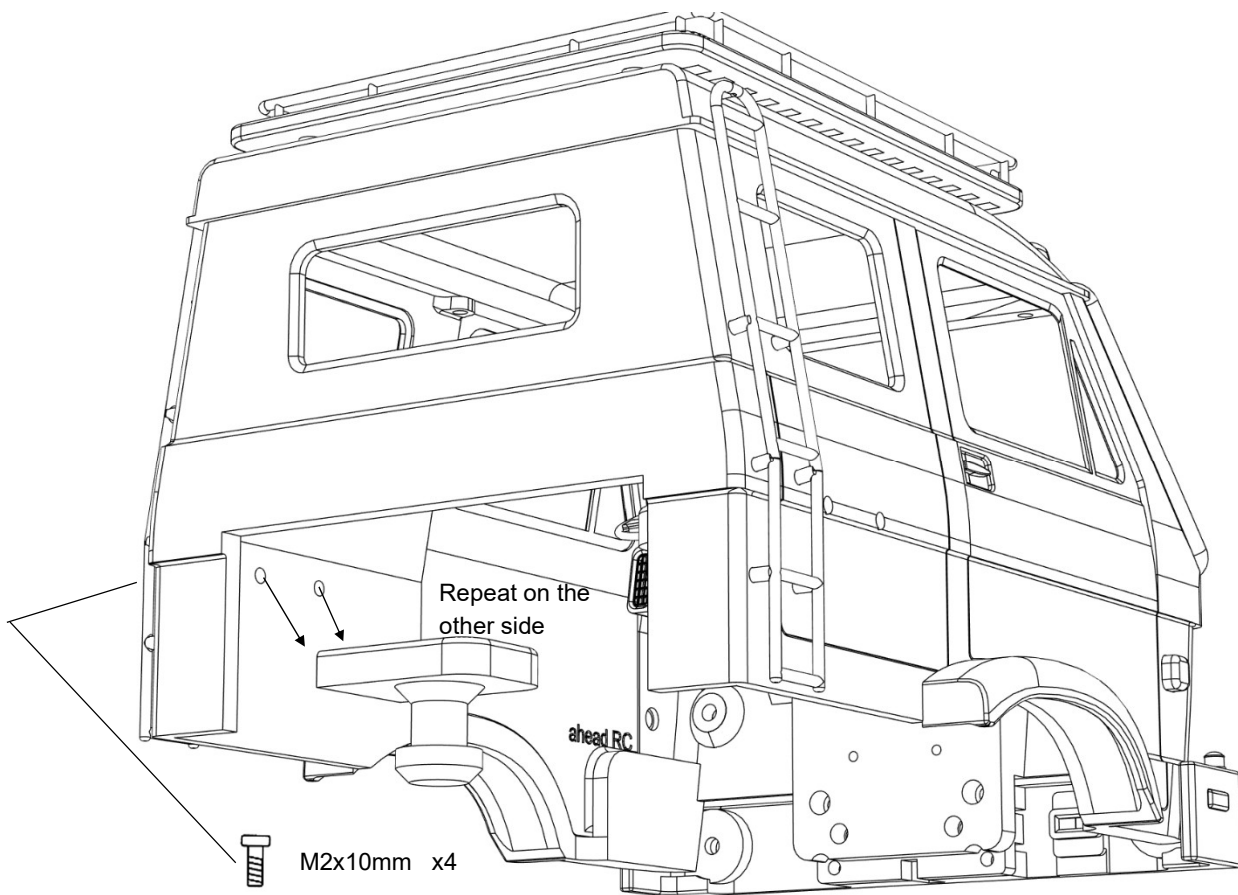

Option 1: Use printed battery strap mounts and M2x5mm screws

Option 2: use stock battery strap mounts and screws

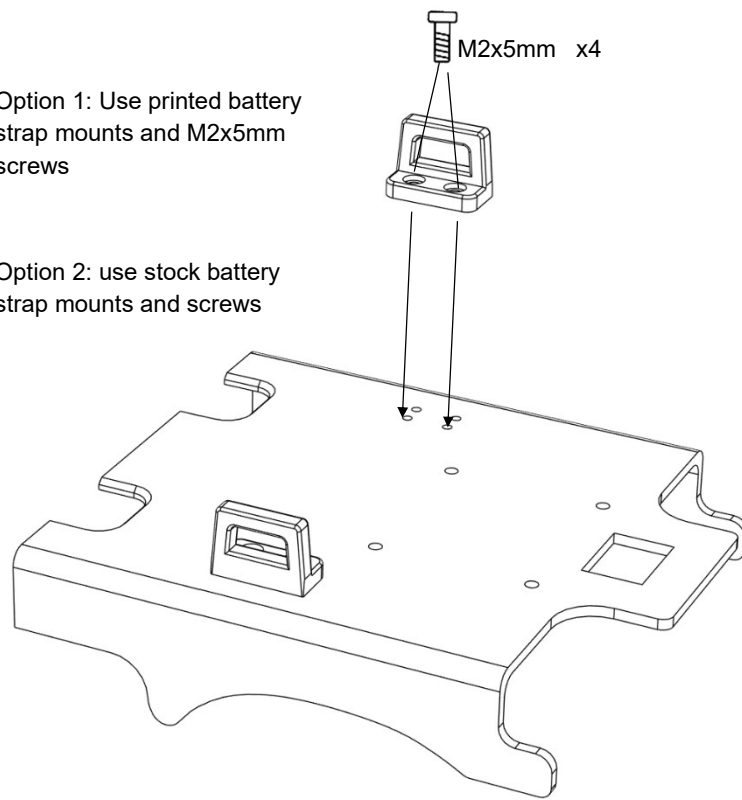

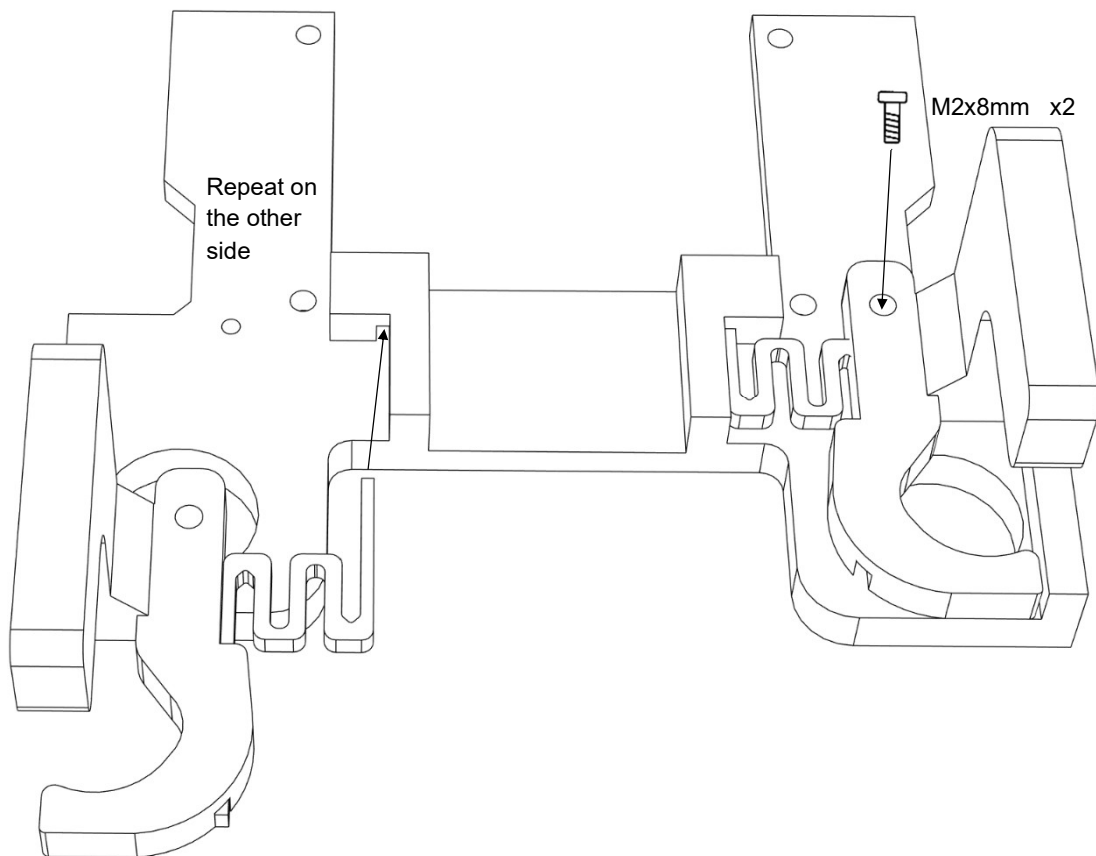
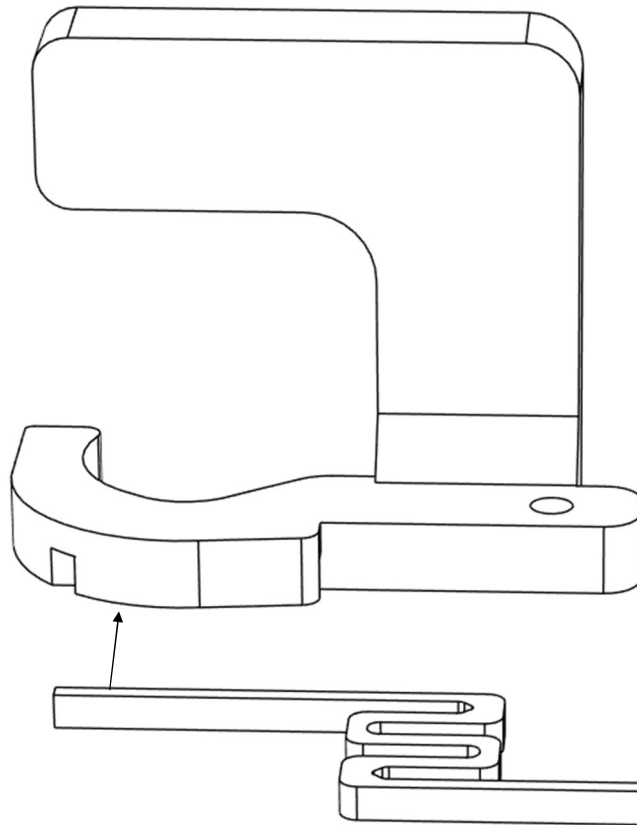

Note: To use the M2 version of the printed mounts, drill through the chassis at the two points using a 2mm drill bit.

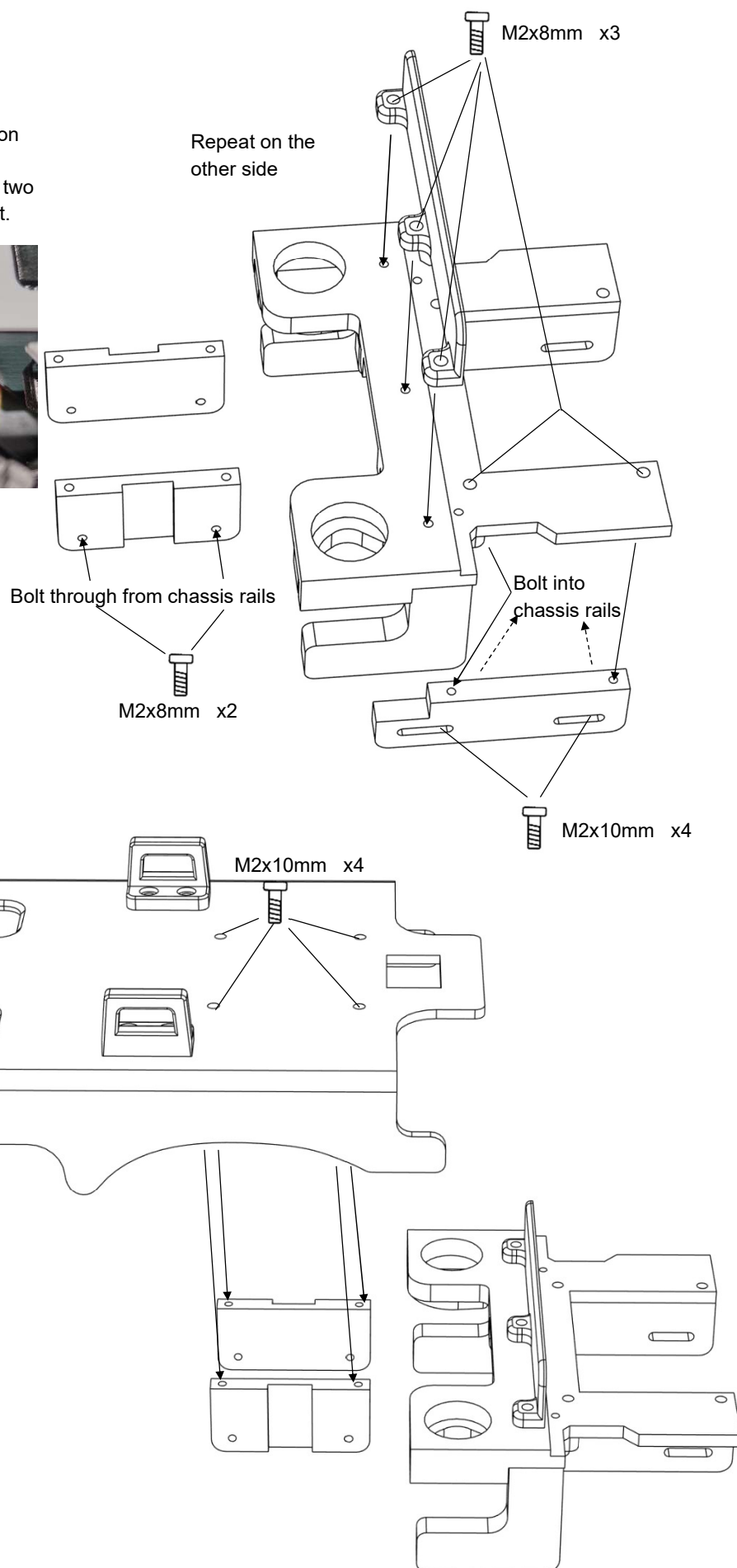
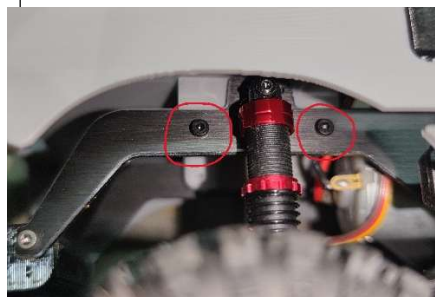

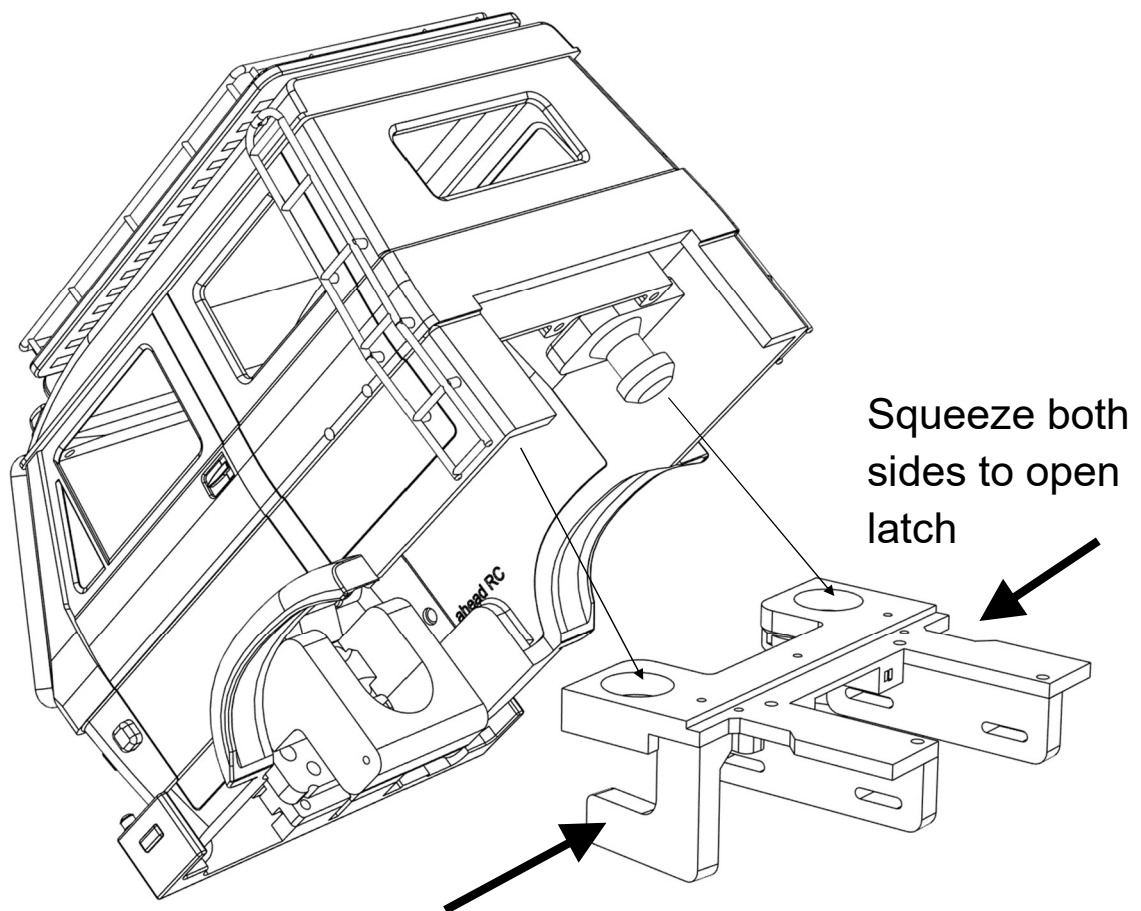
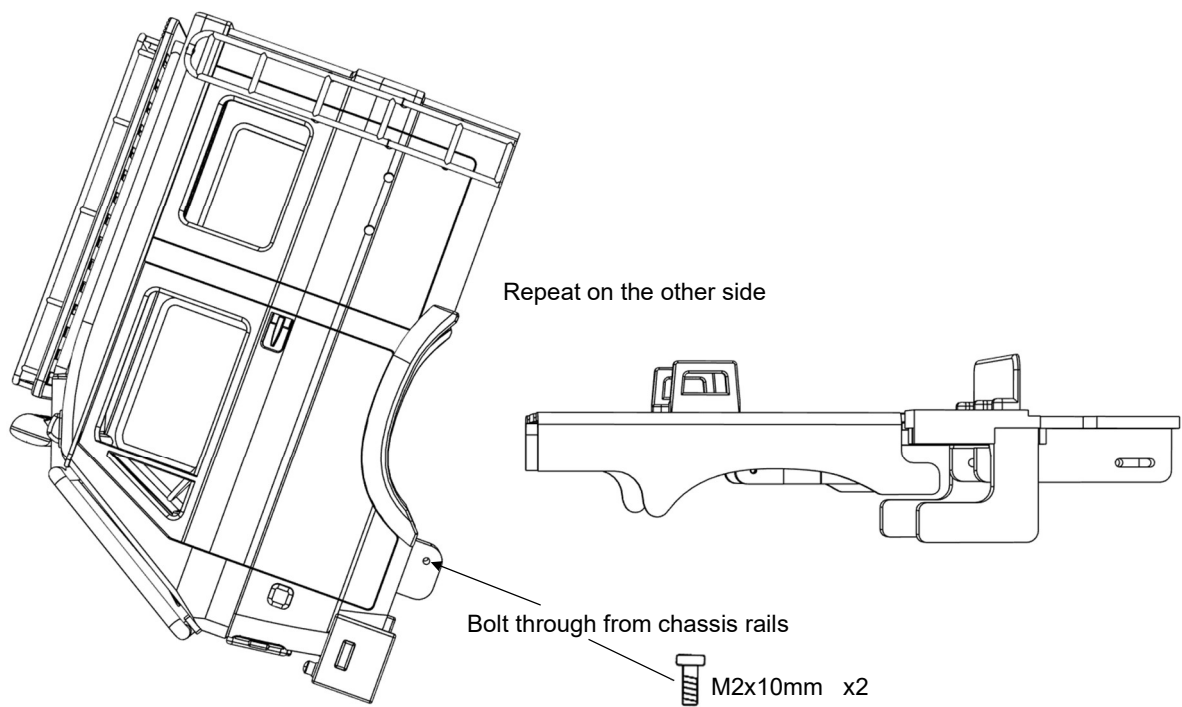

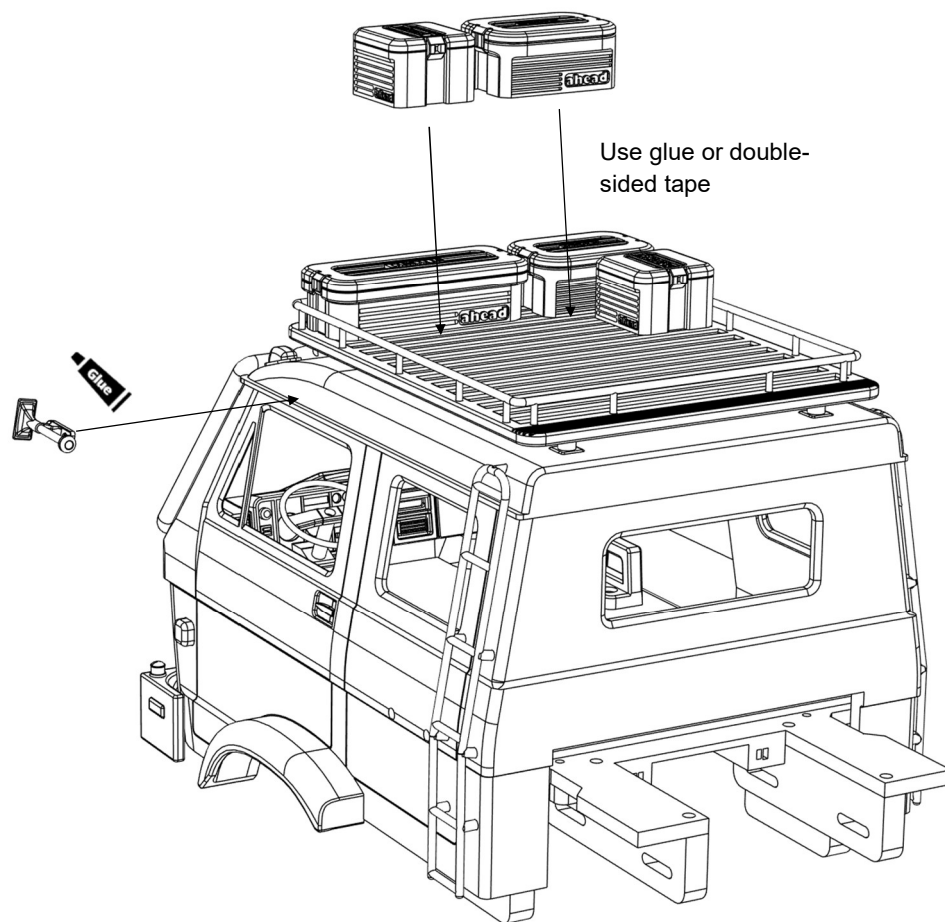

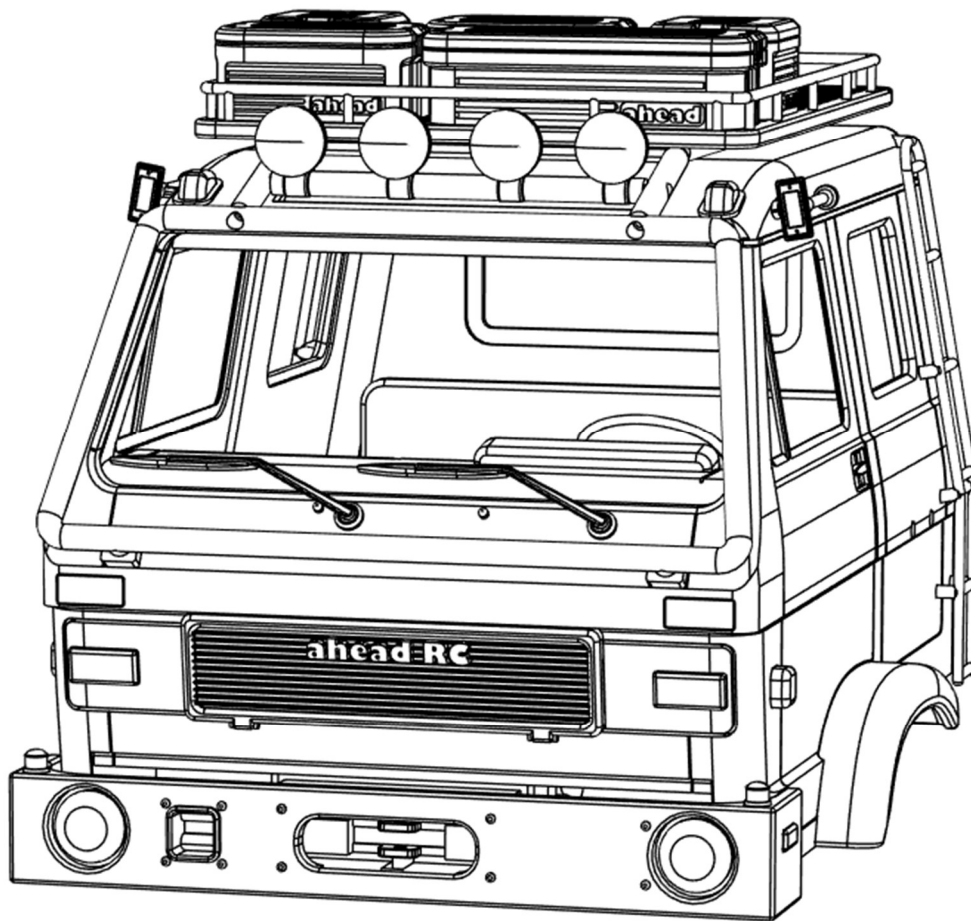

Body is now fully complete. Thank you for selecting ahead RC products.

If you have any questions or need help with the assembly, please do not hesitate to contact us at:

aheadrc@gmail.com

or visit us at:

www.aheadrc.com