

# **ahead RC** Crawler Bog 406 Crew Cab Assembly Manual

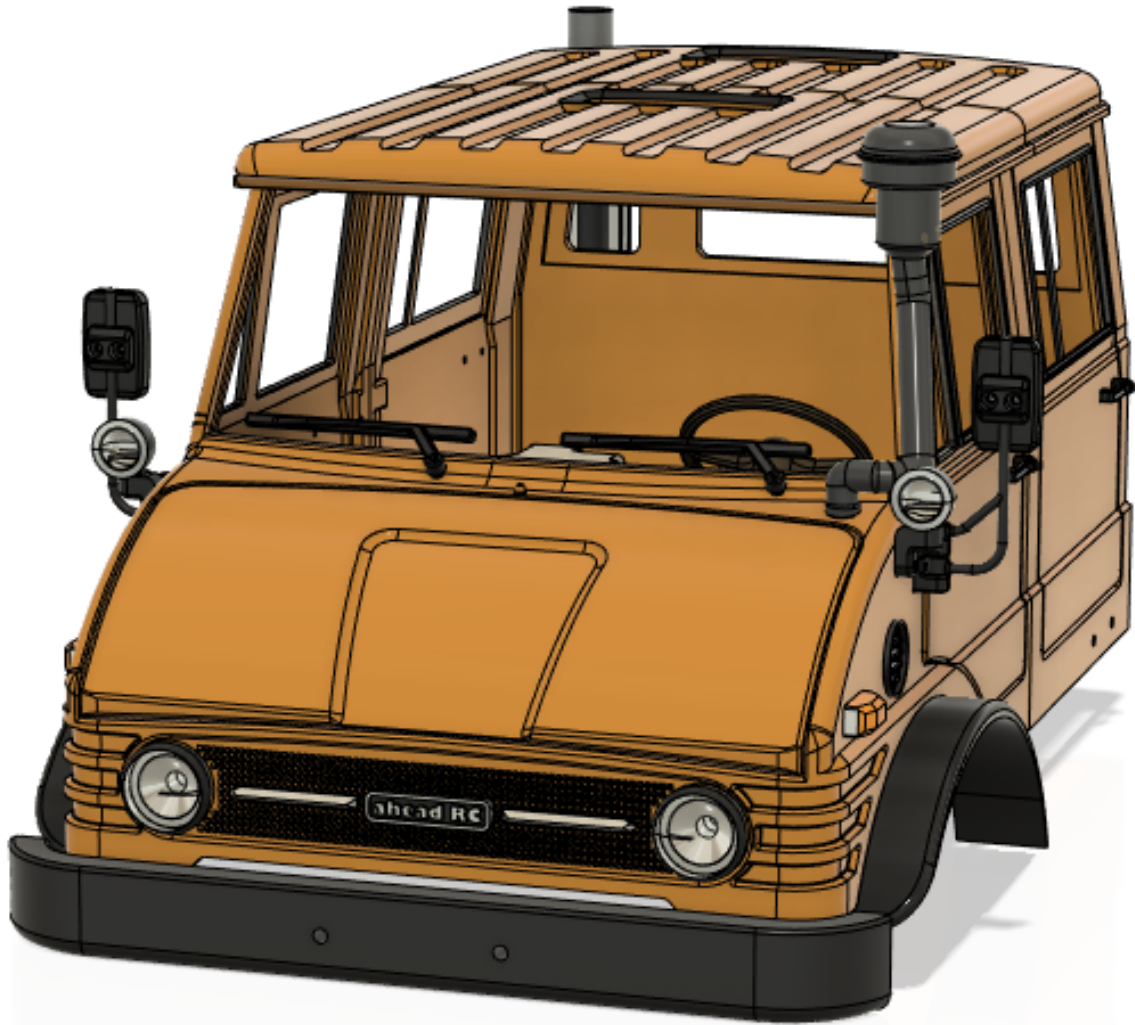

## Required tools and hardware

### Tools

- 1.5mm Hex Driver
- 2.5mm Hex Driver
- Needle Nosed Pliers
- Instant Glue
- Hot Glue

### Electronics

- 5mm Warm White LED x4
- 3mm Orange LED x2

### Hardware

Hardware	Quantity	Check ✓
M2*5 Socket head	24	
M2*8 Socket head	6	
M2*10 Socket head	12	
M2*15 Socket head	2	
M2*20 Socket head	1	
M3*10 Socket head	8	
M3*15 Socket head	9	
M3*15 Button head (BH)	5	
M3*20 Socket head	2	
M3*25 Button head (BH)	1	
M3*10 Grub Screw (GS)	1	
M3*20 Grub Screw (GS)	8	

# Before you begin

- Be sure to read through the manual and familiarise yourself with the instructions
- Visualise a plan to assemble all the pieces
- Make sure you have all of the hardware and tools
- Be sure to have enough instant glue
- Dry fit all parts before painting and assembling

**Tip:** It will help to paint all of the parts before final assembly

# Assembling the cab

1. M3x20mm GS    x6

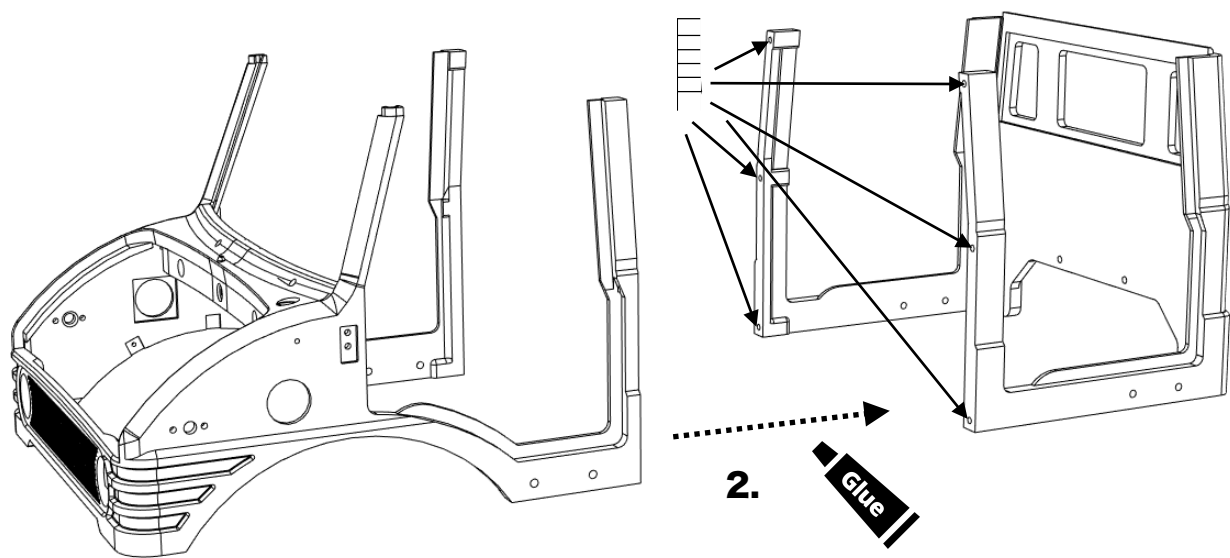

# Installing the headlight buckets

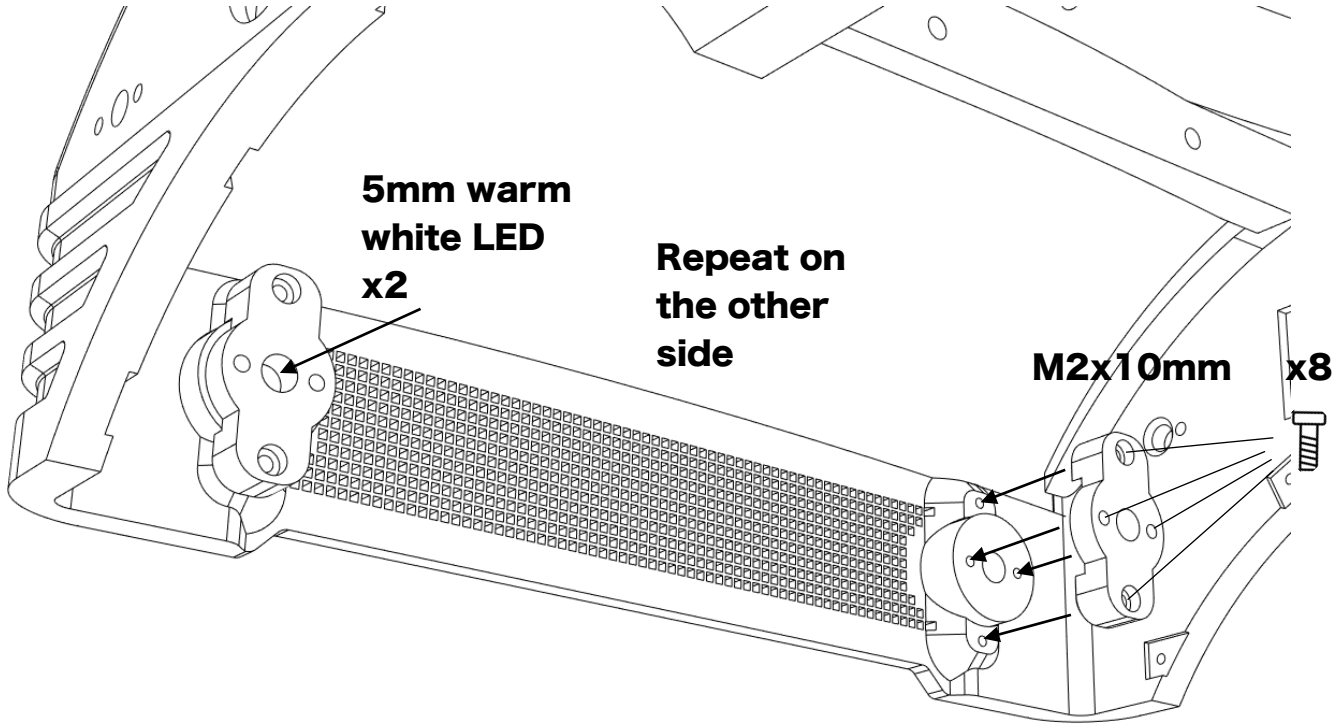
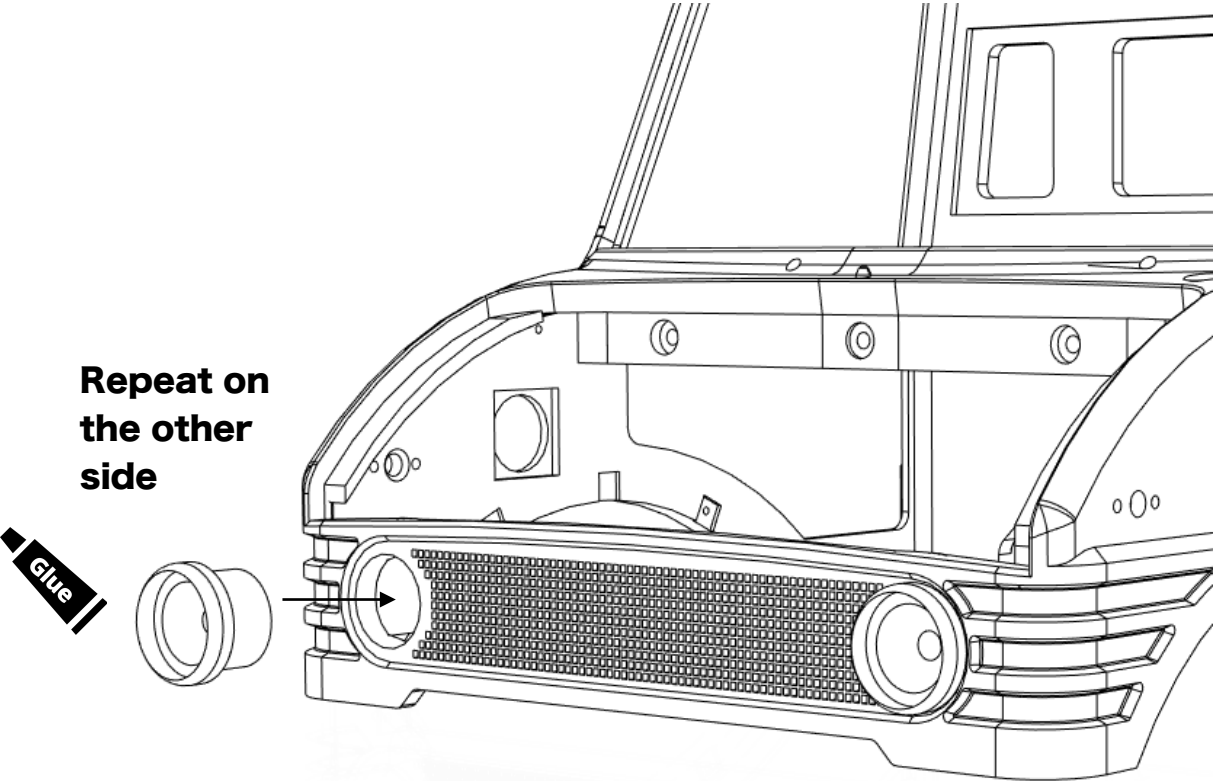

## Installing the fenders

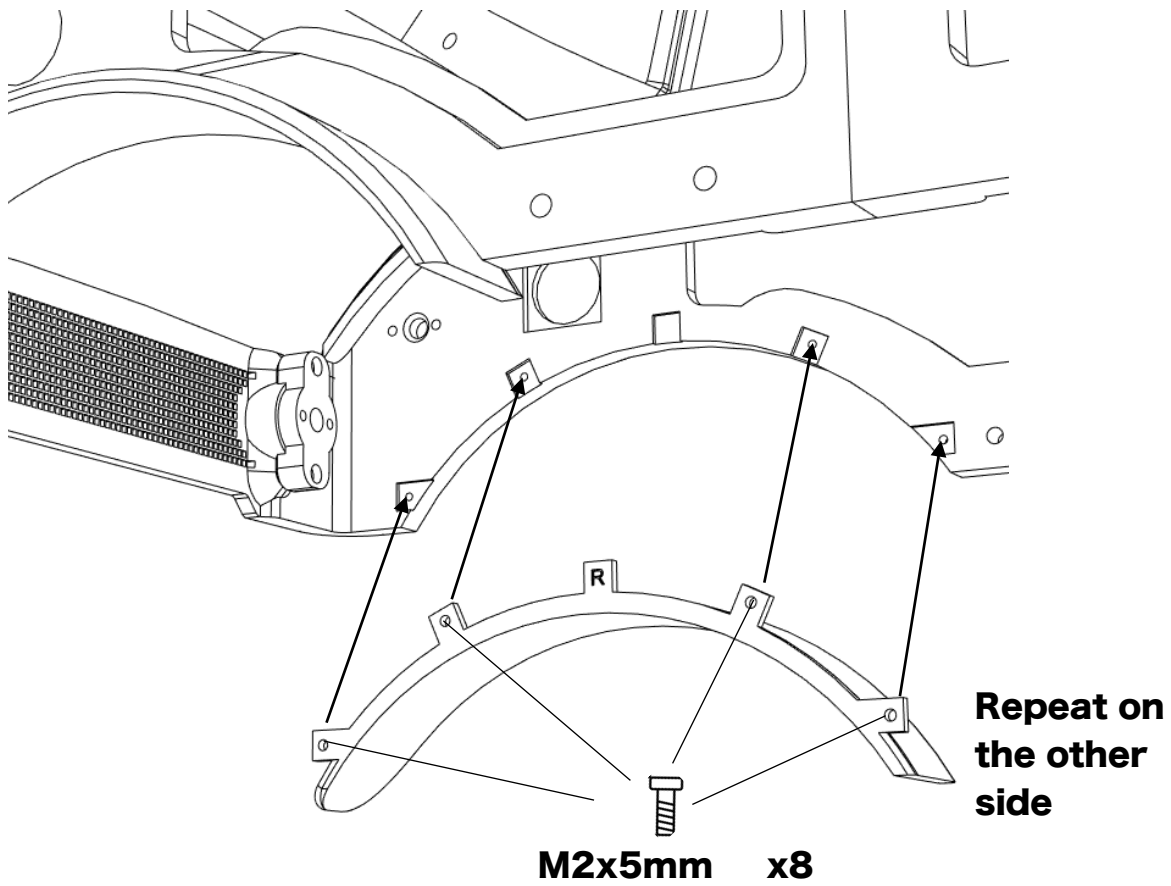

## Assembling the Mirrors

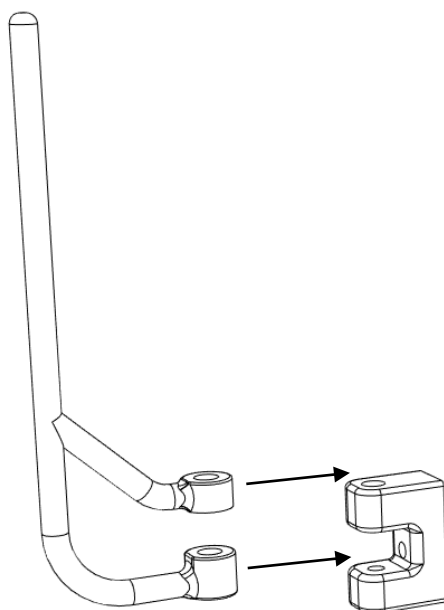

**Repeat on  
other  
mirror**

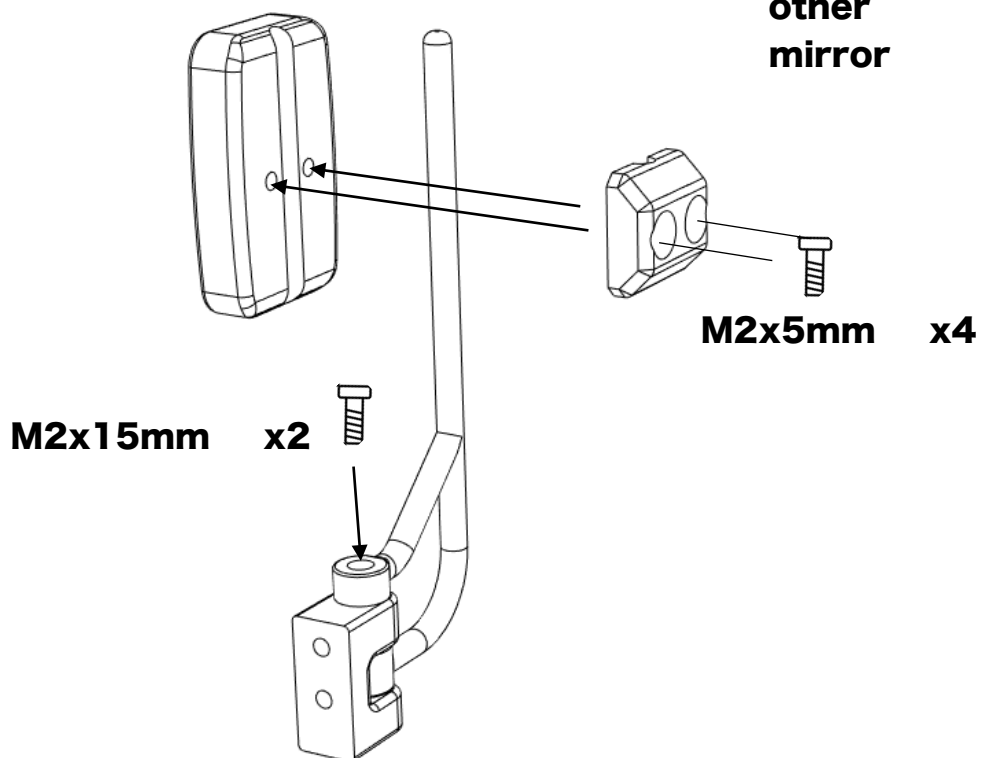

## Installing the mirrors and snorkel

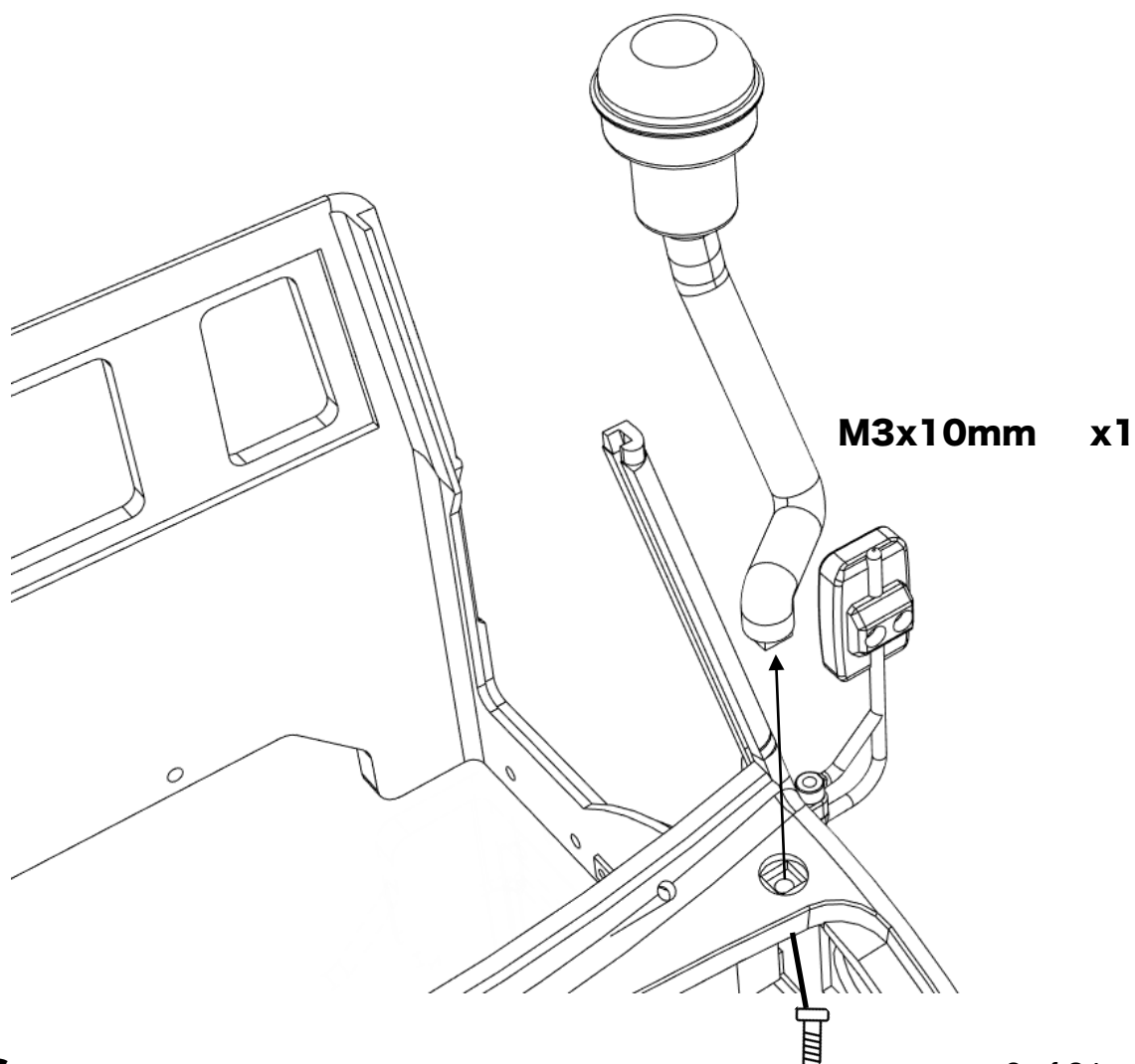
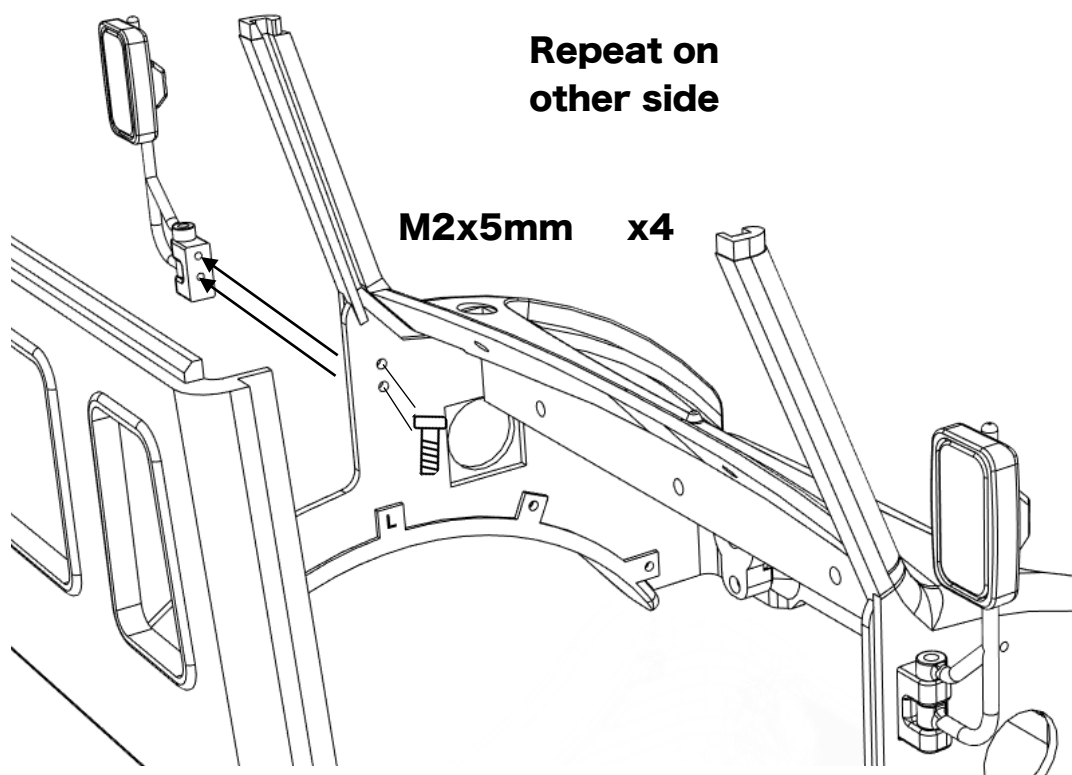



# Installing the wipers and side vents

Repeat on  
other wiper

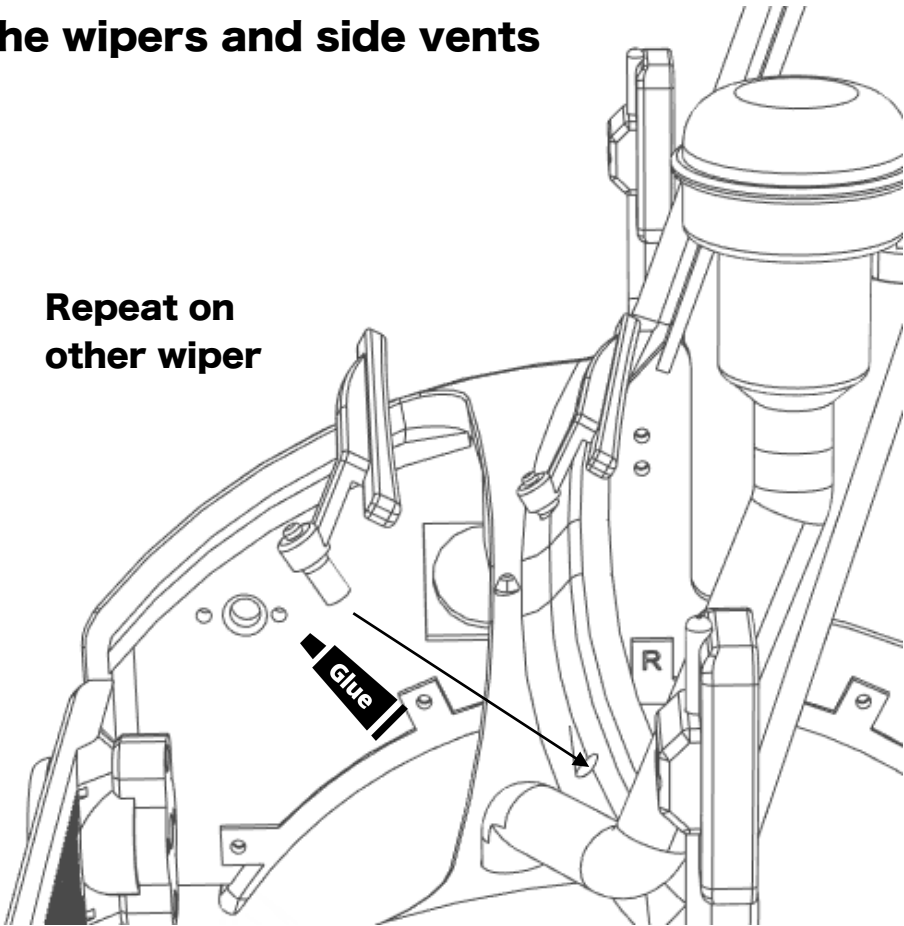

Repeat on  
other side  
vent

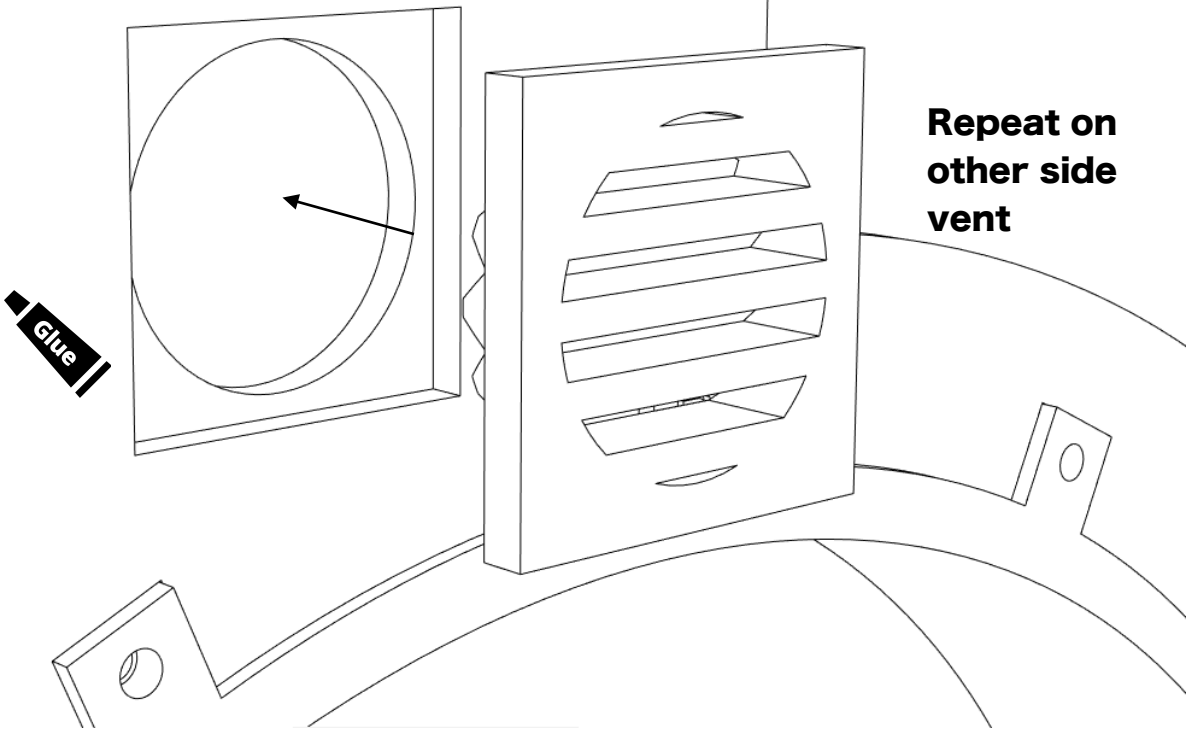

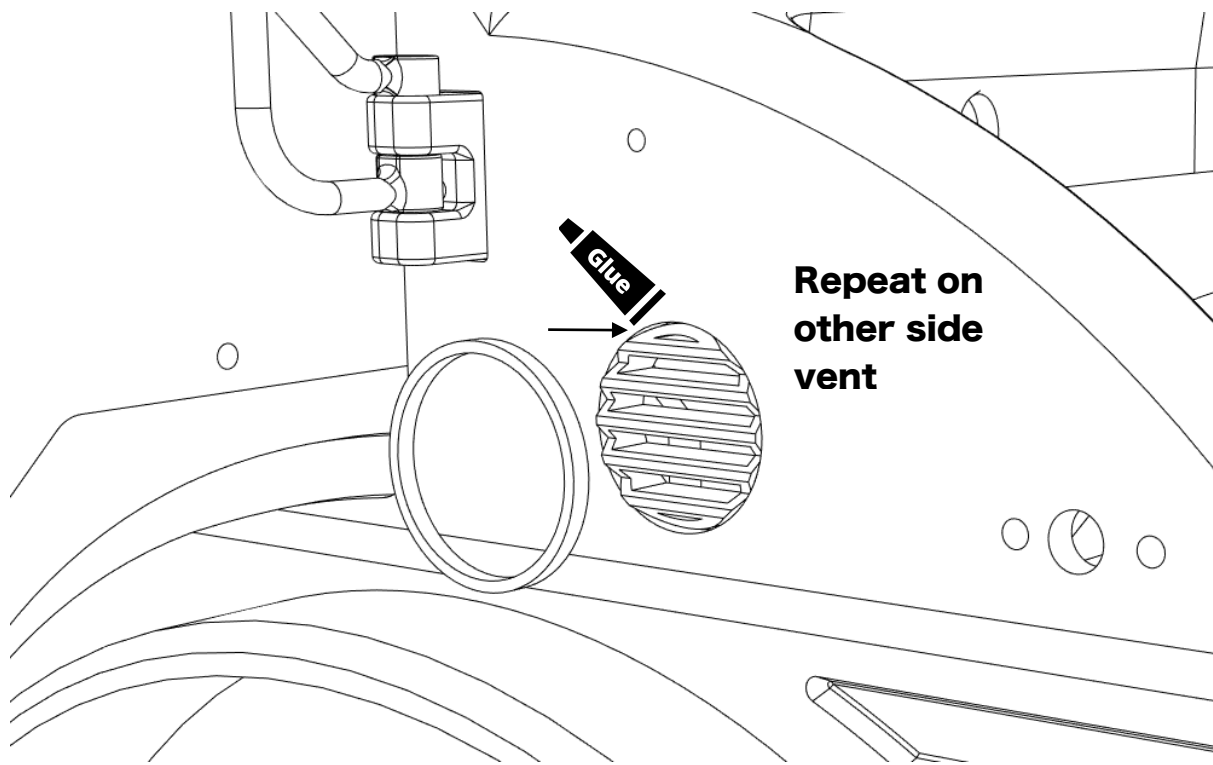

## Assembling the exhaust

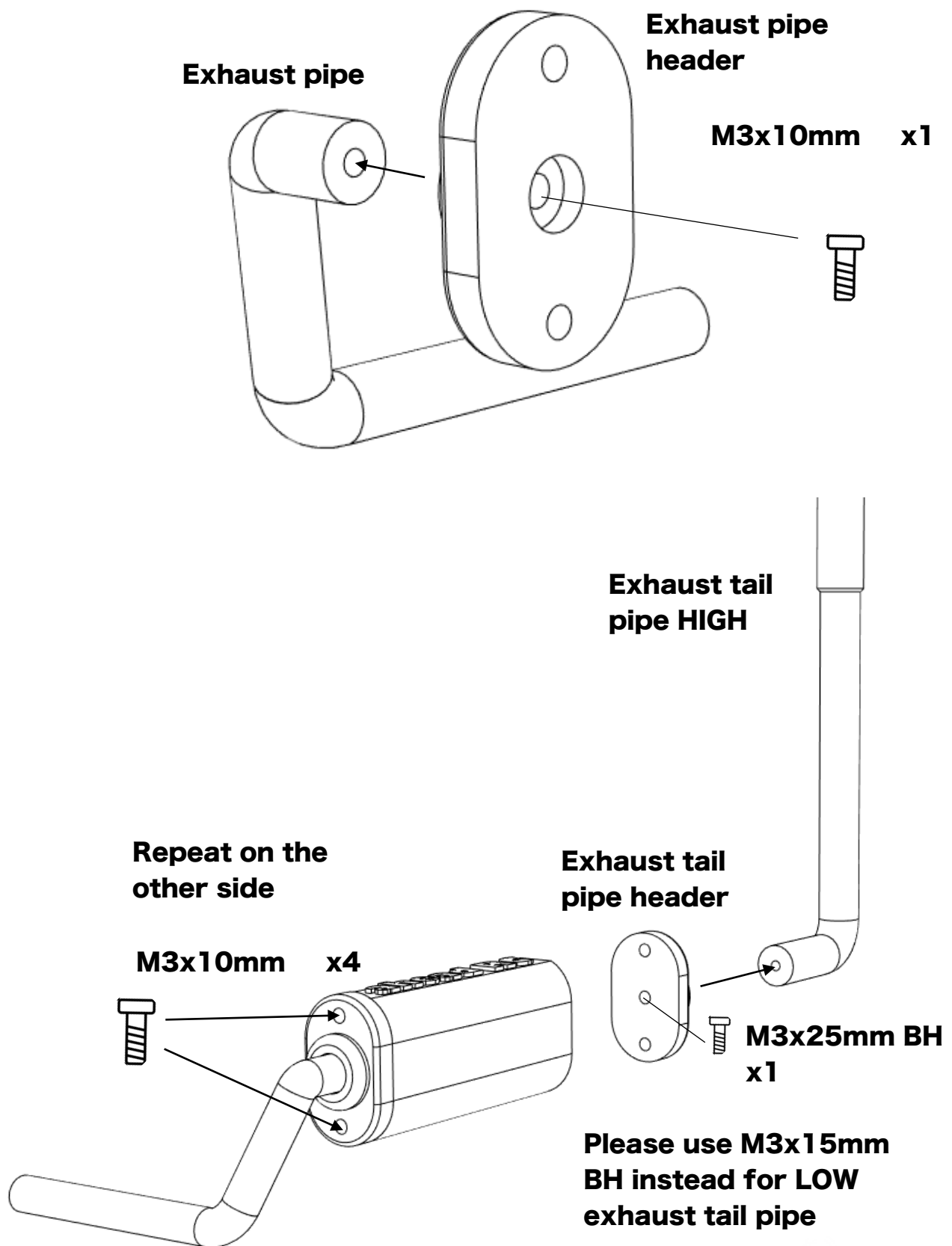

## Installing the vertical mounted exhaust

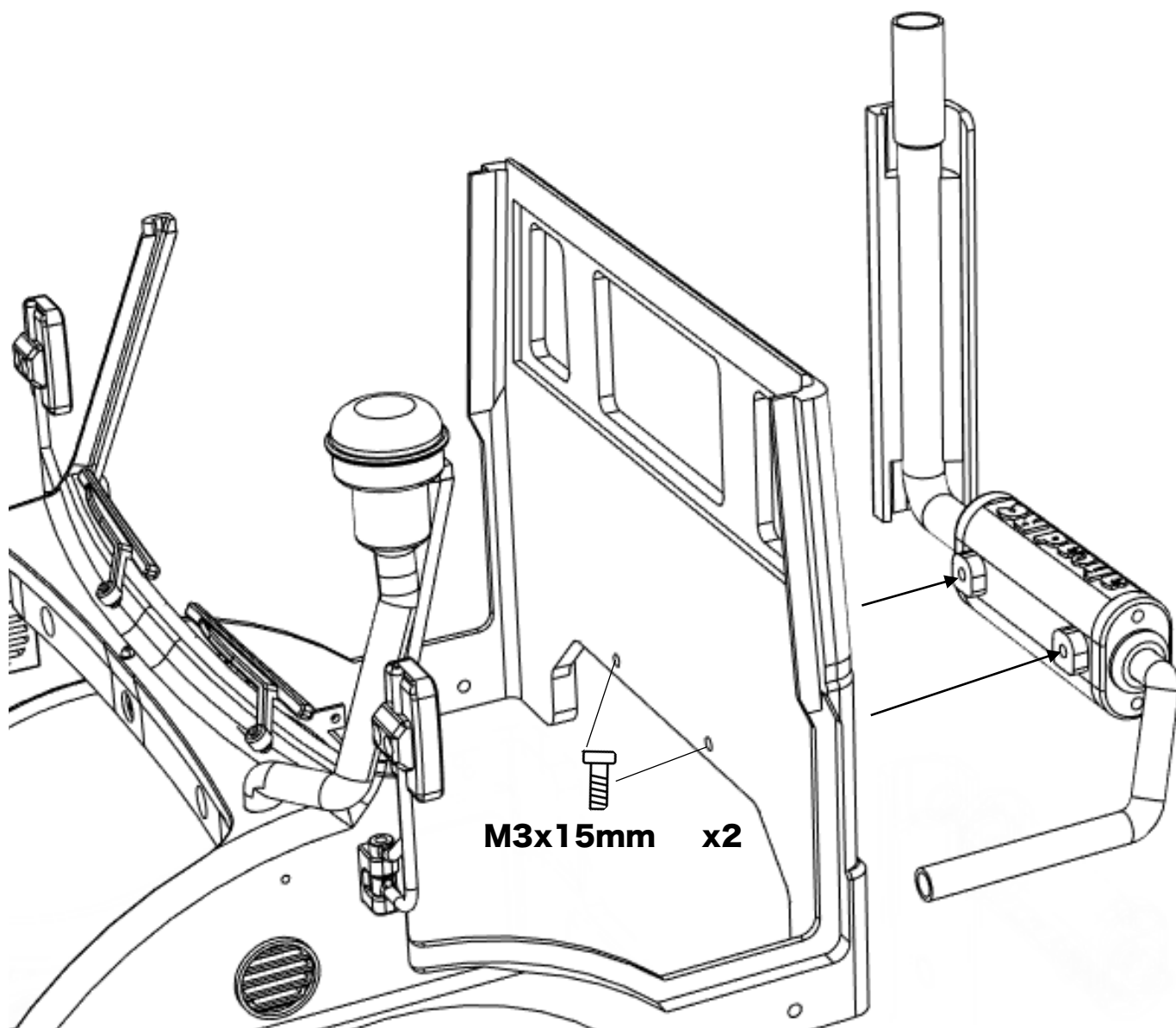
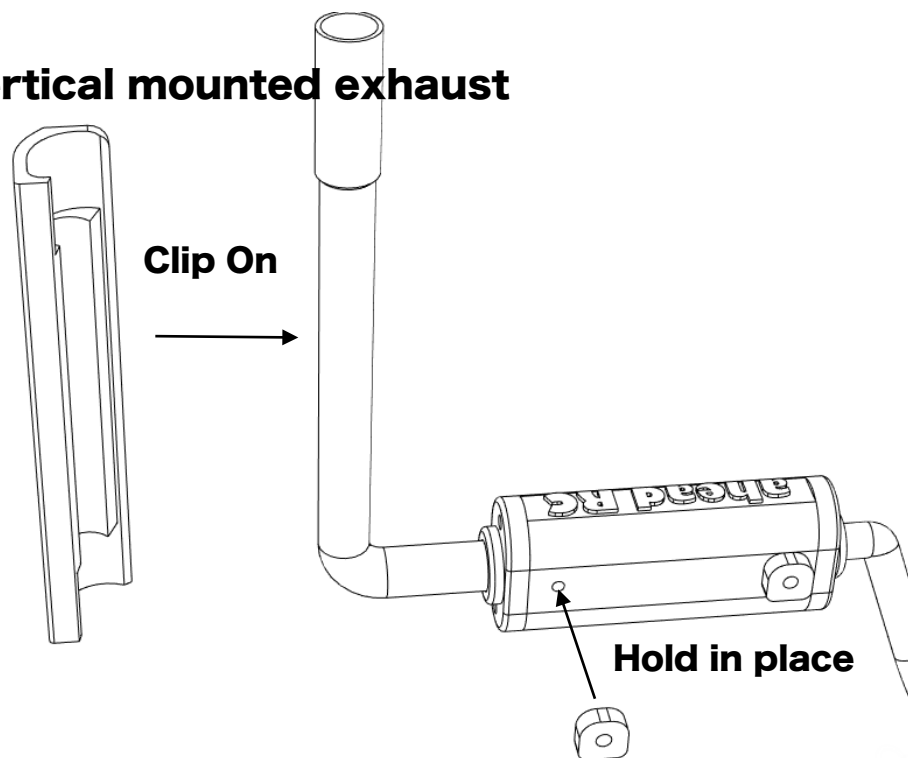

## Installing the horizontal mounted exhaust

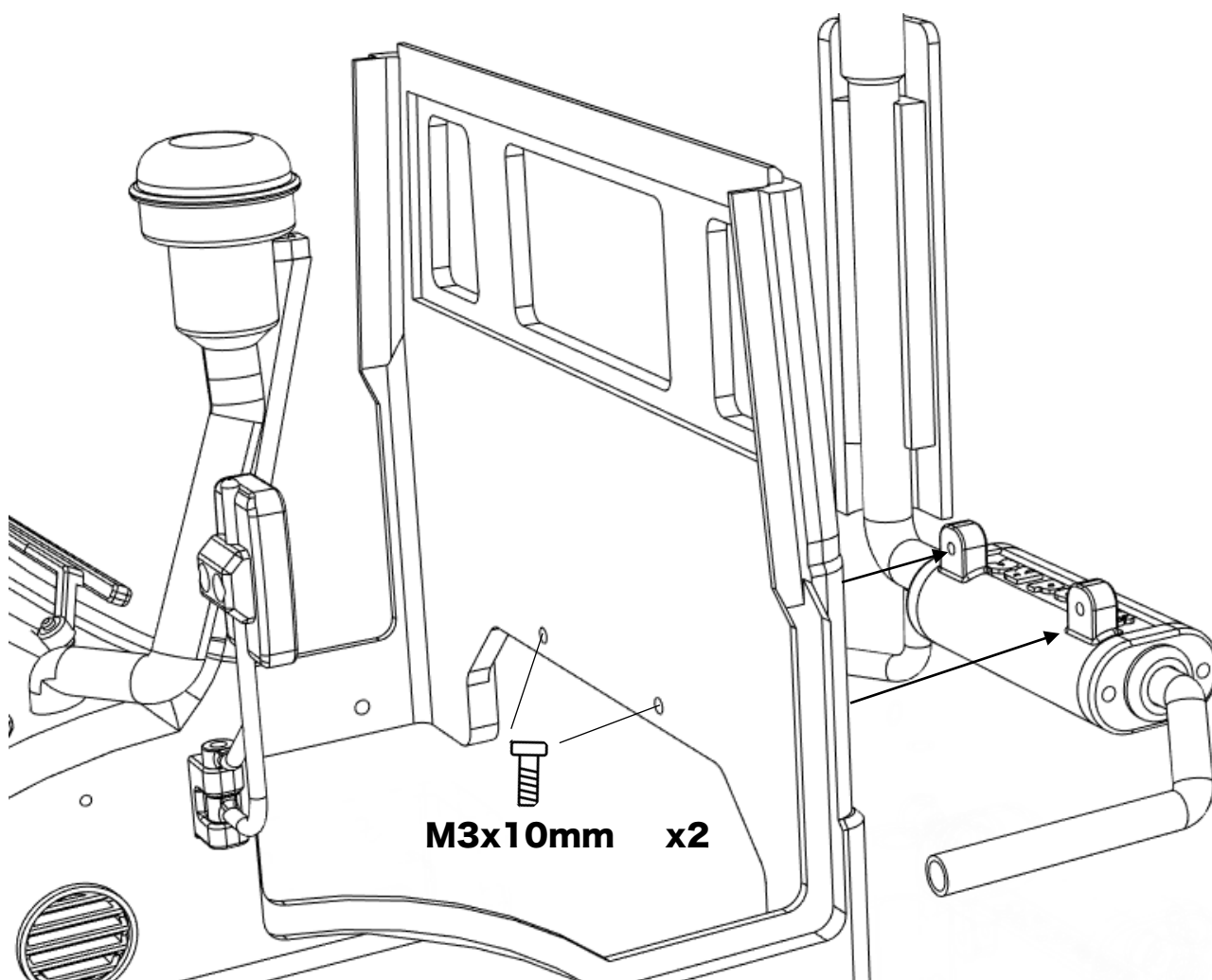

## Assembling the interior

**M2x20mm x1**

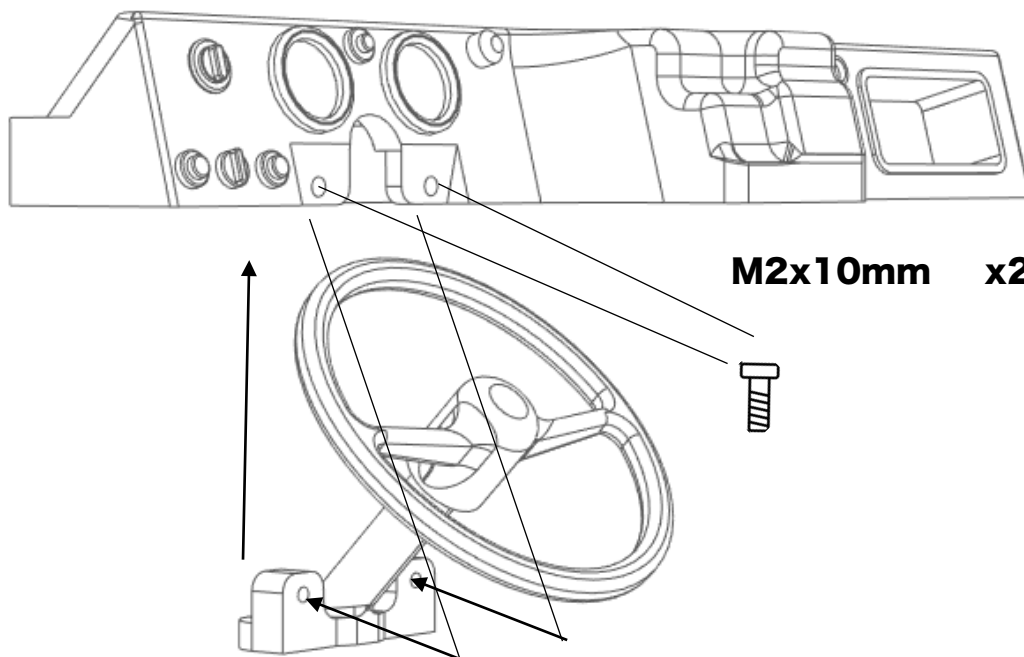
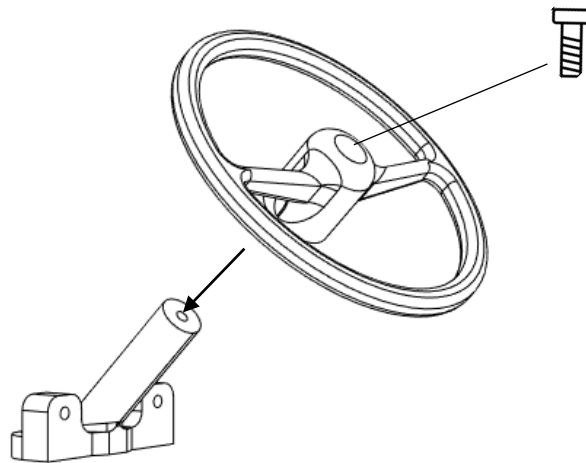

**M2x10mm x2**

## Installing the interior

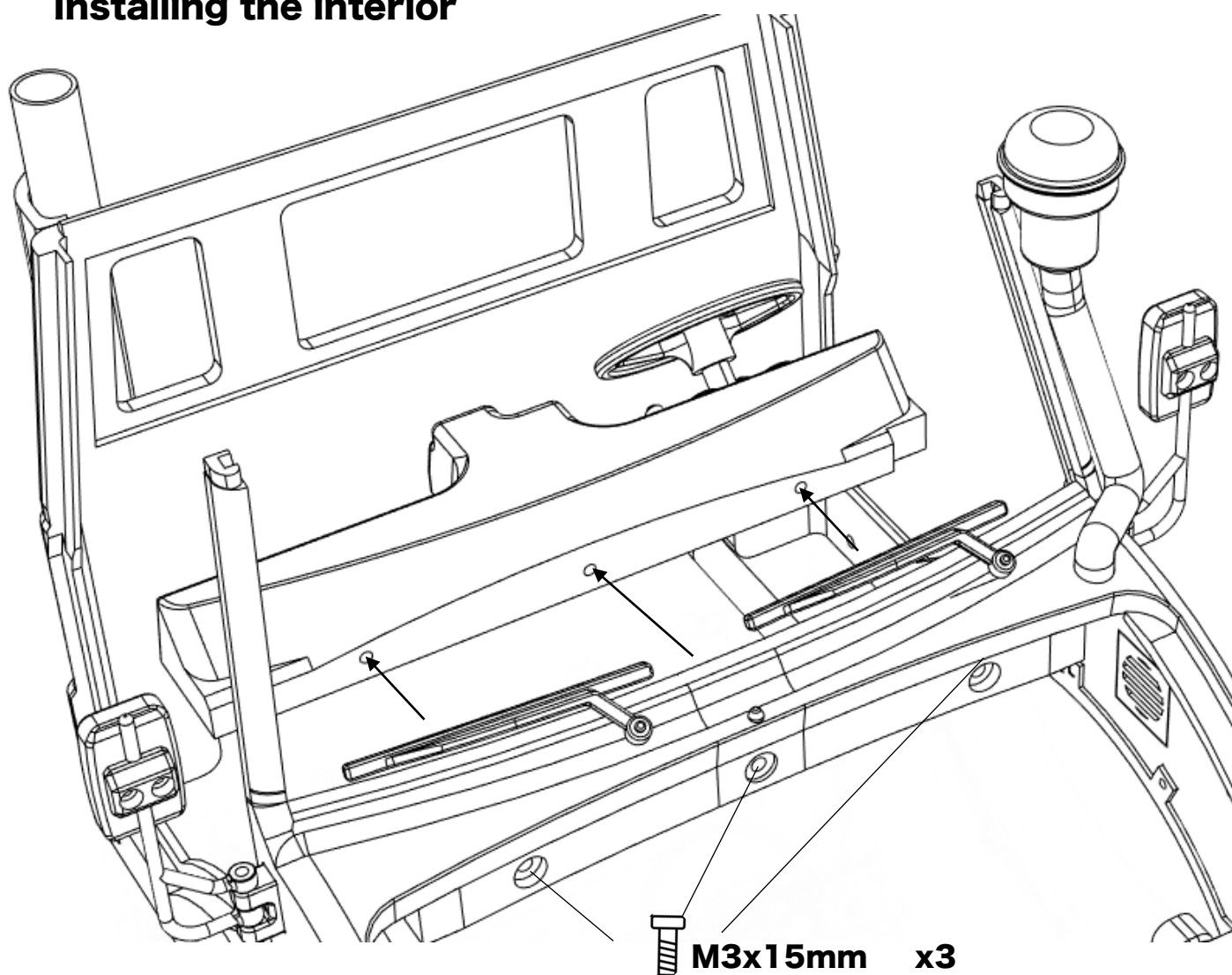

## Installing the roof

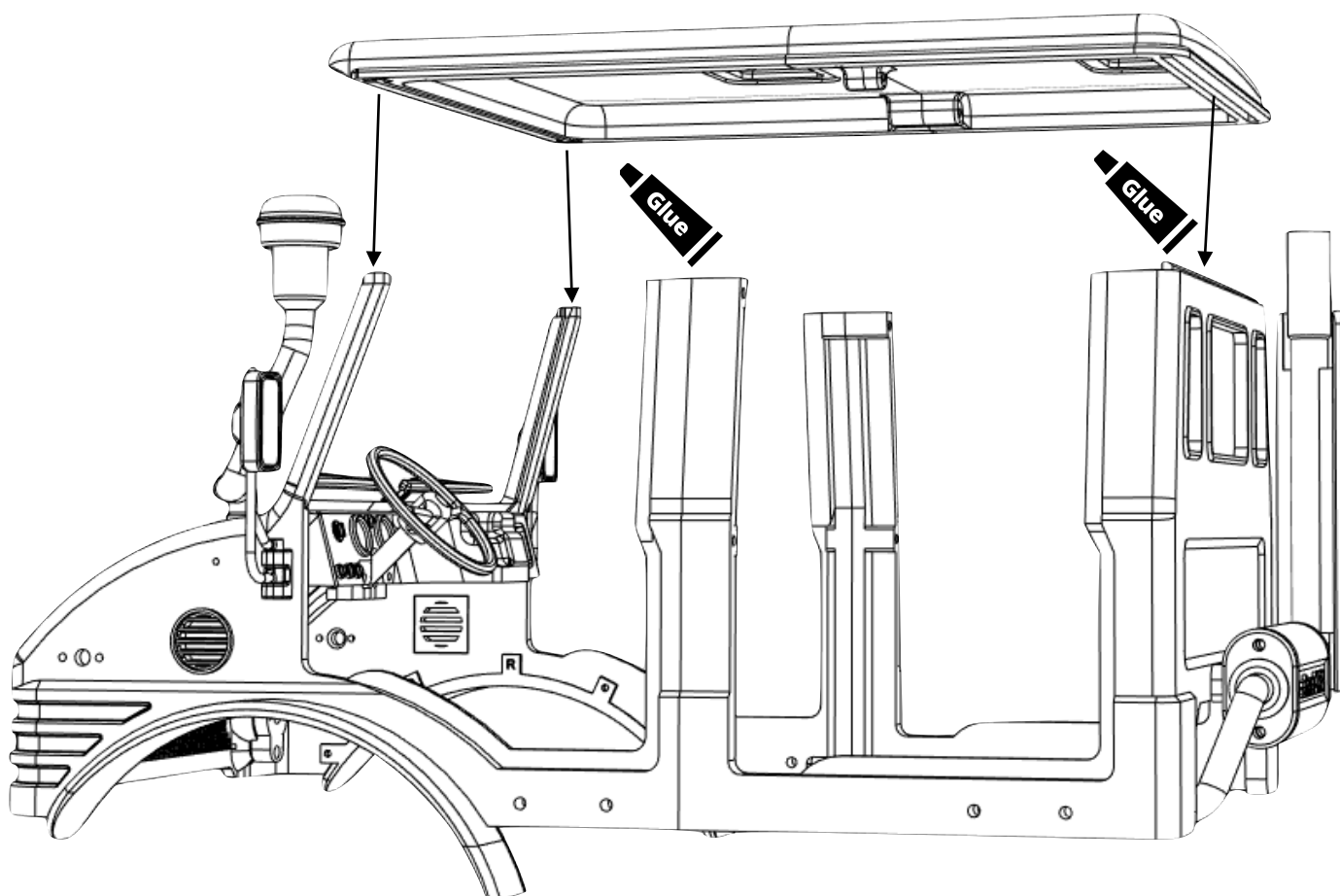
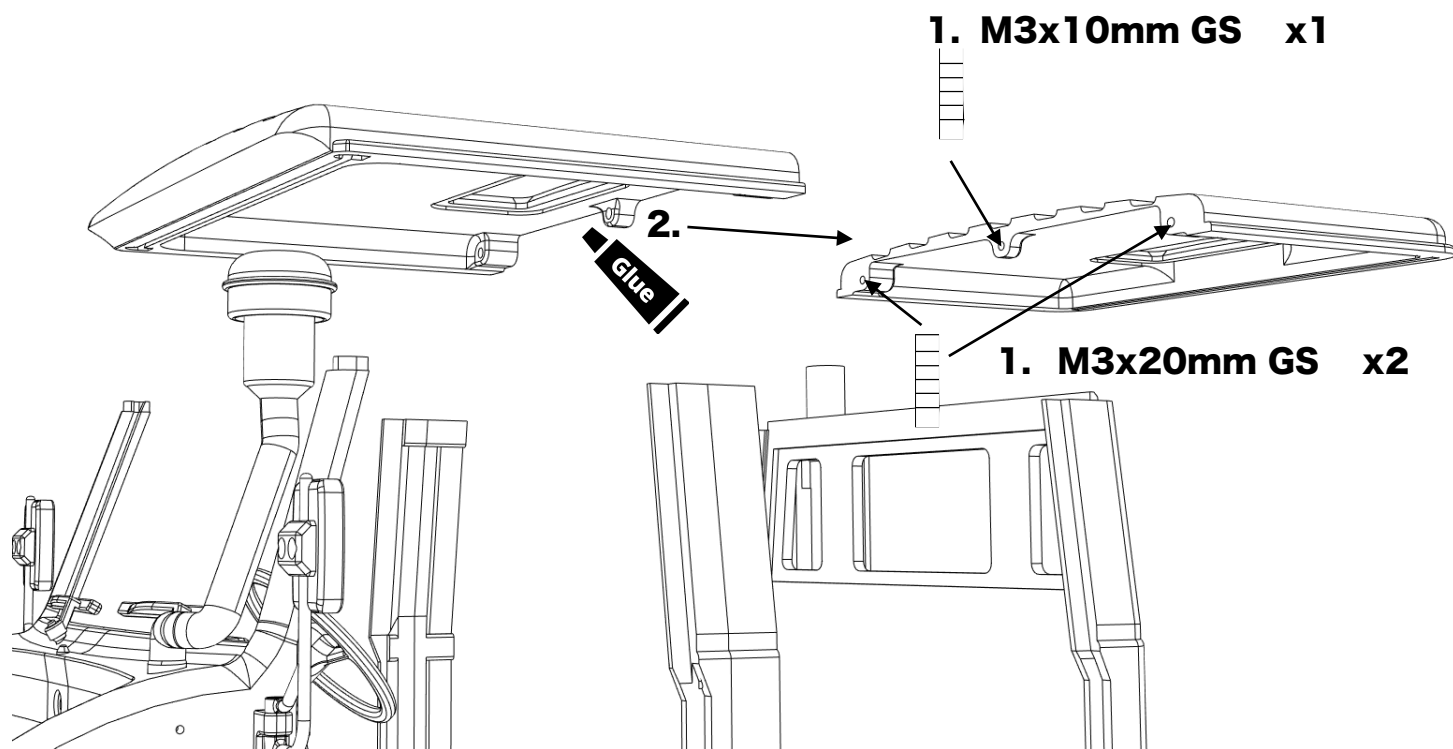



# Assembling and installing the doors

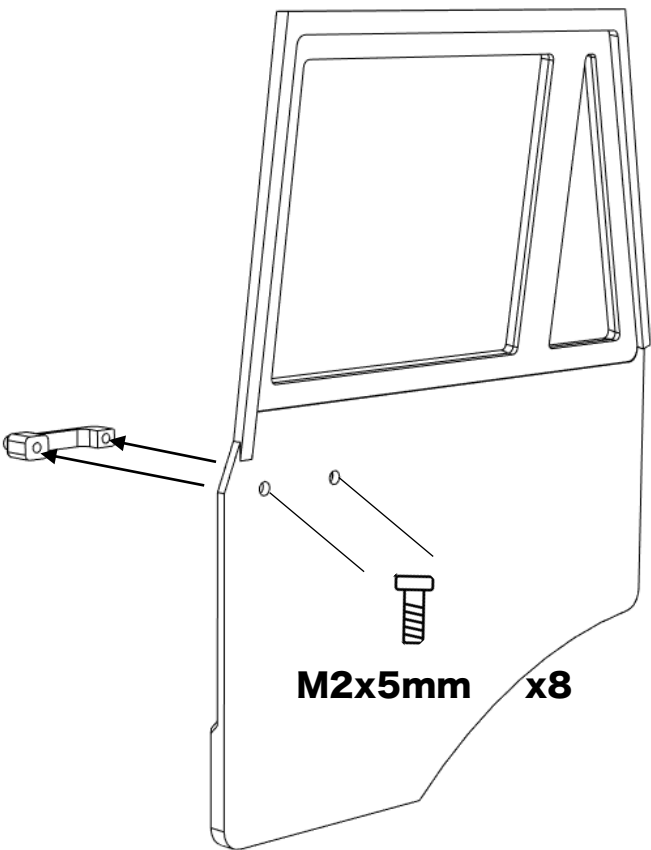

Repeat on all 4 doors

M2x5mm x8

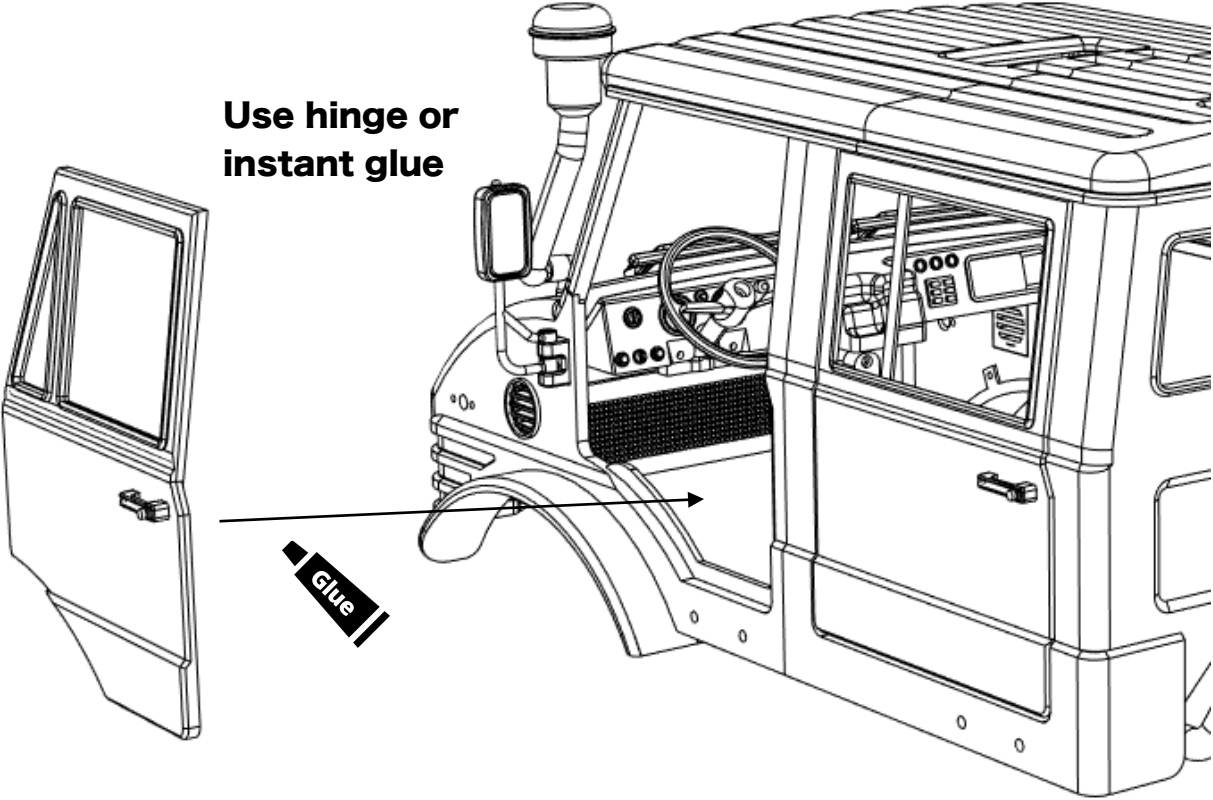

Use hinge or instant glue

Repeat on all 4 doors

Glue

## Installing the lights

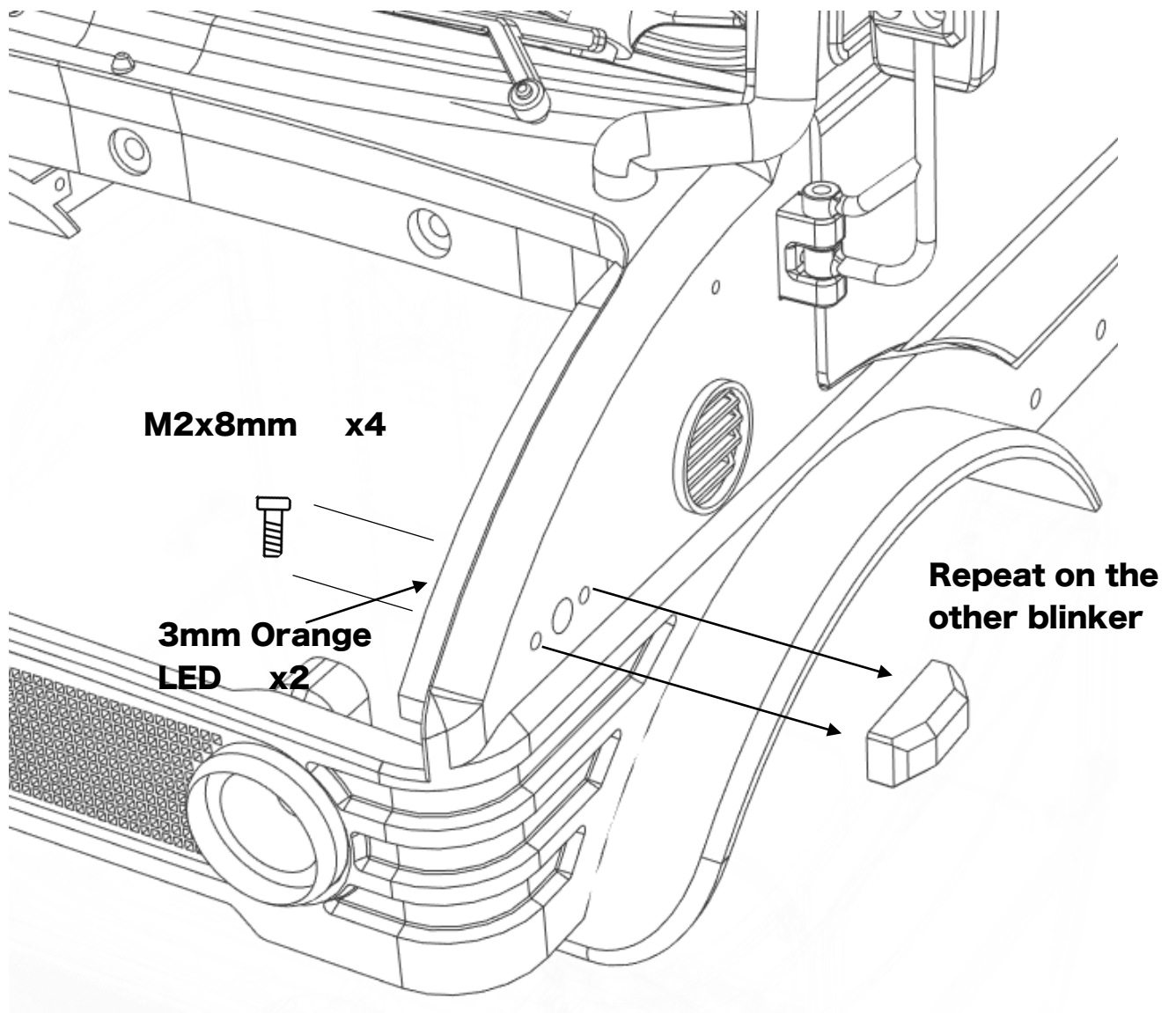

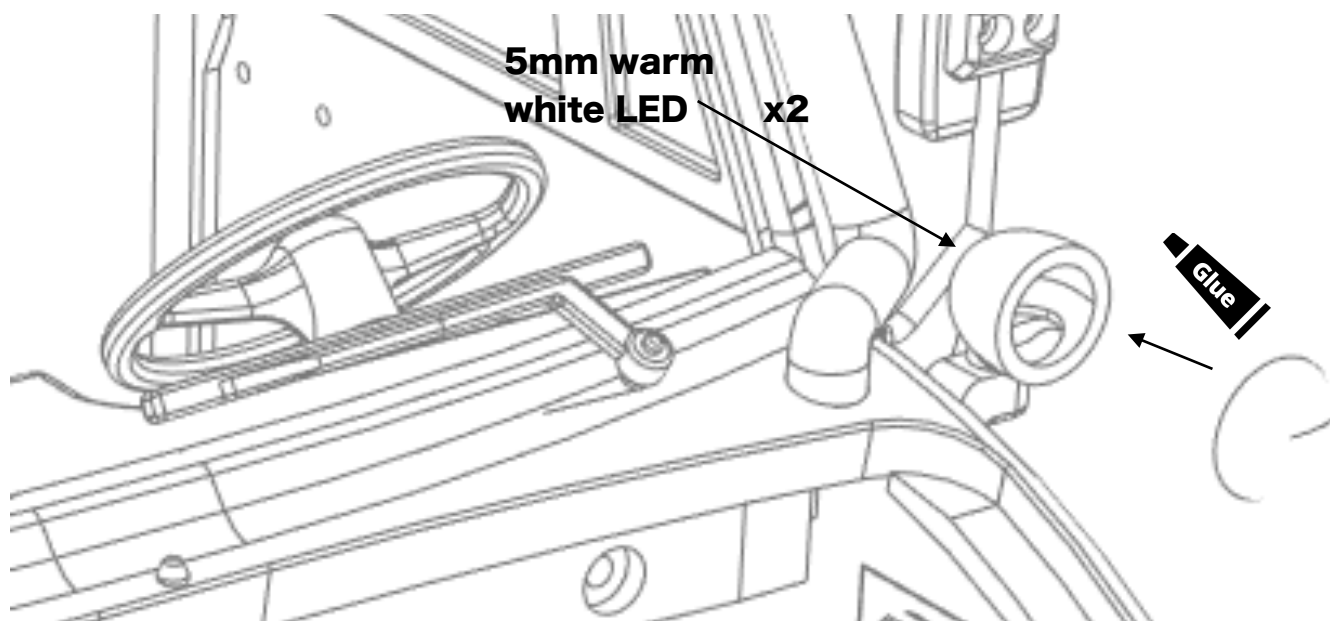
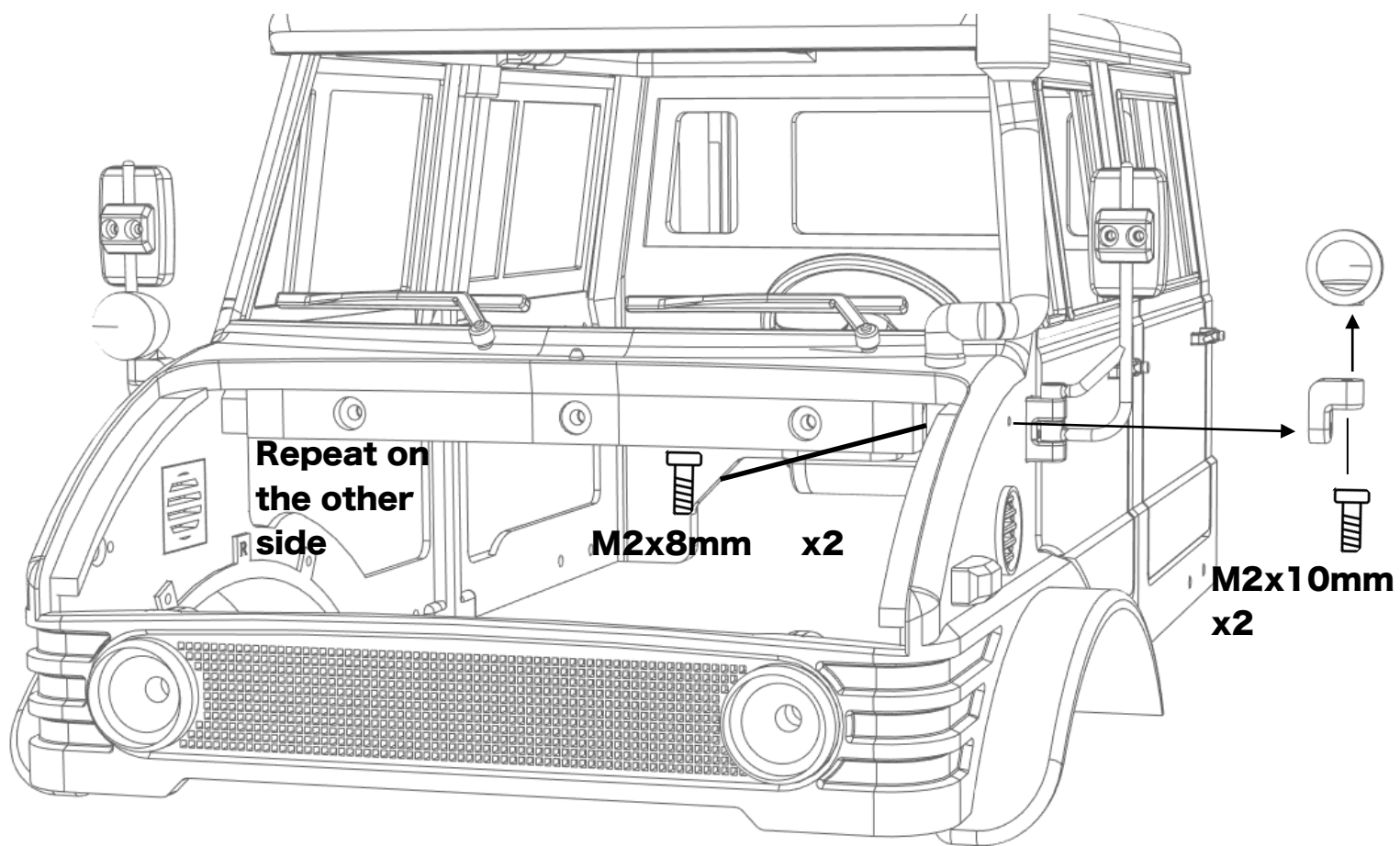

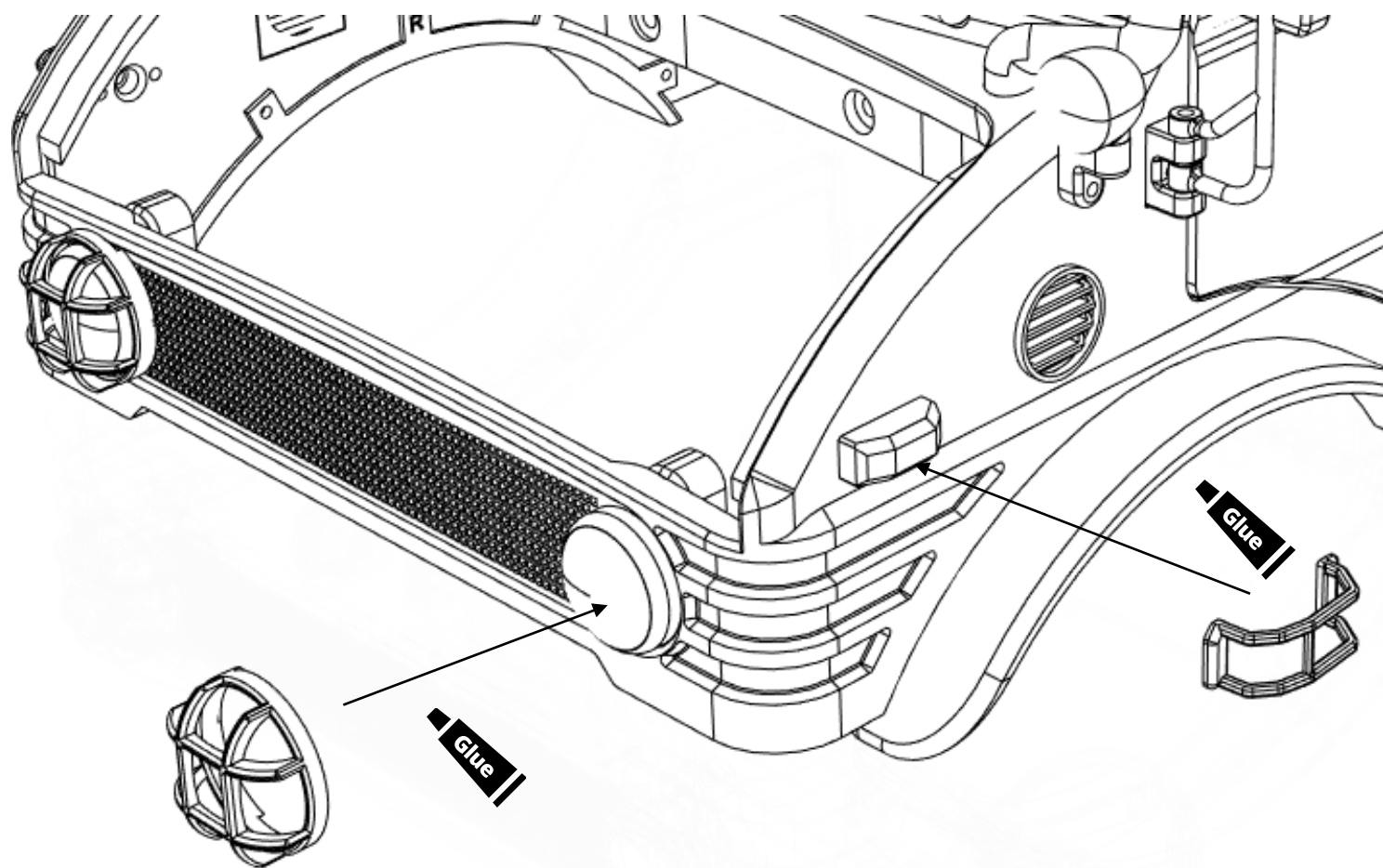
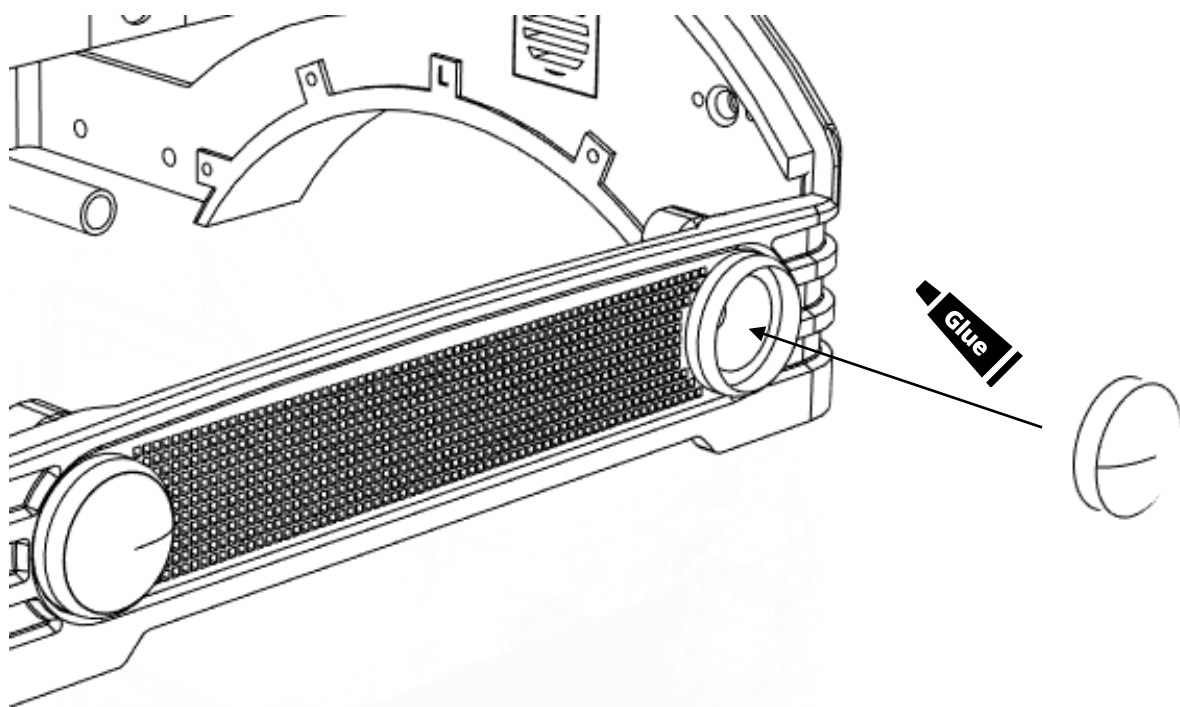

# Installing the grille ornaments

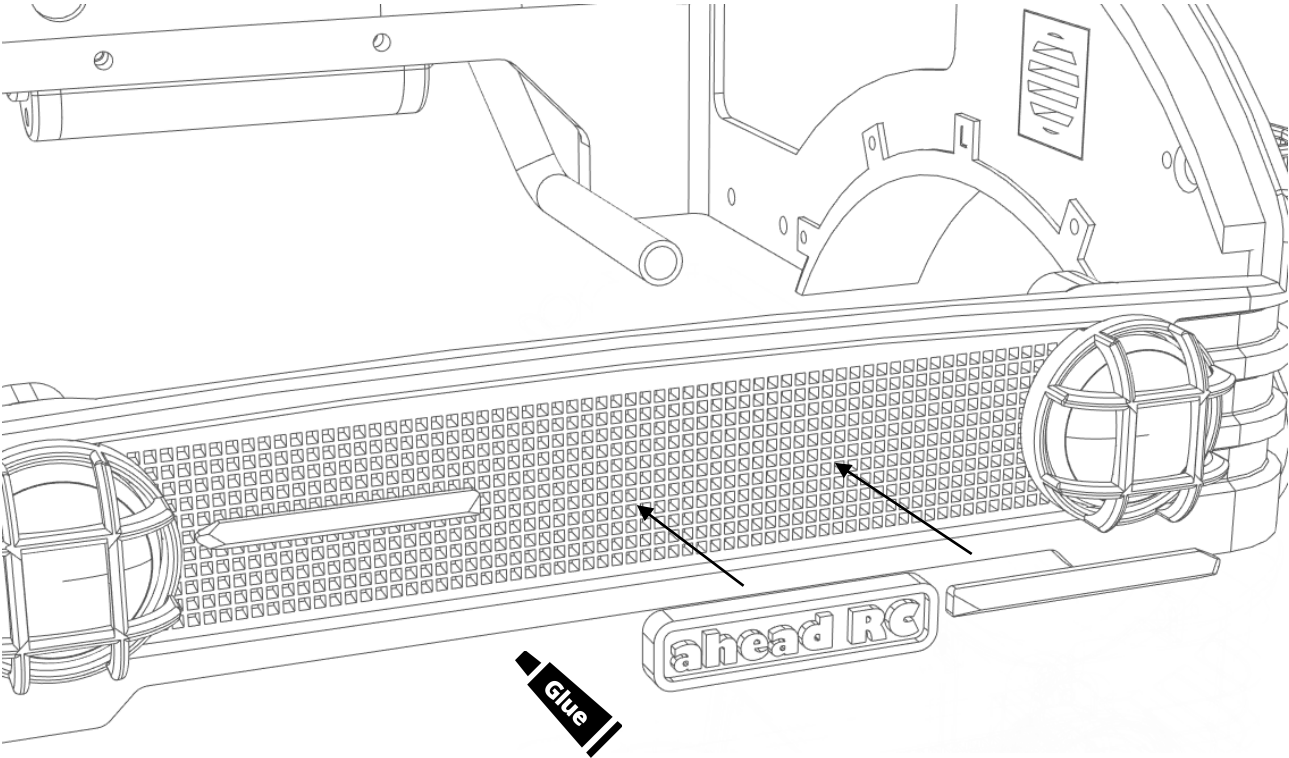

# Installing the bonnet and bumper

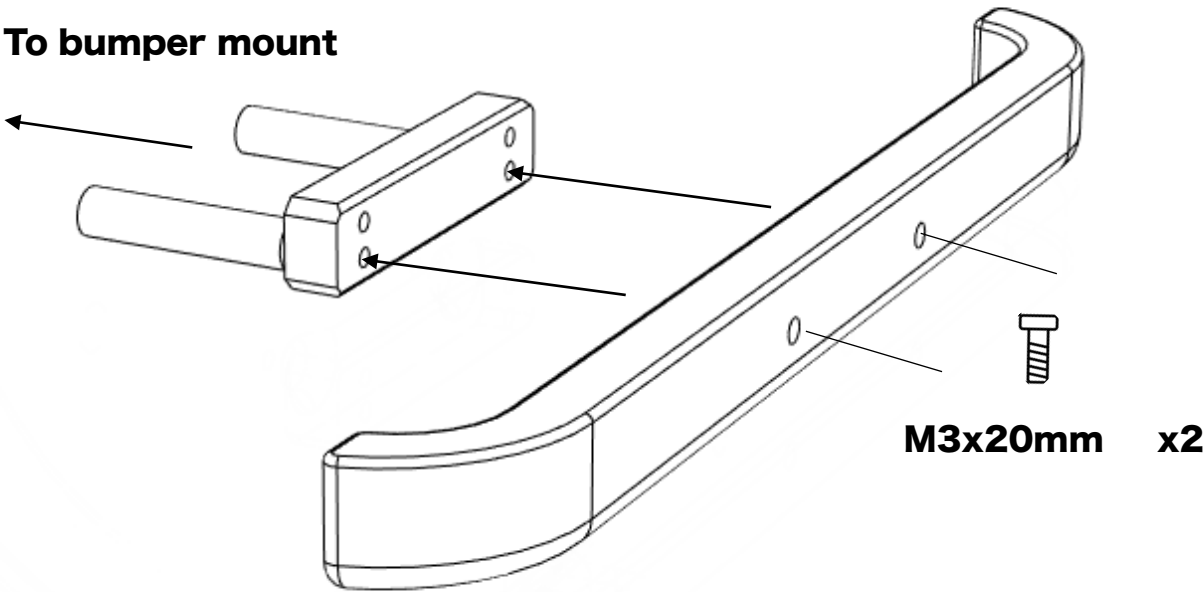
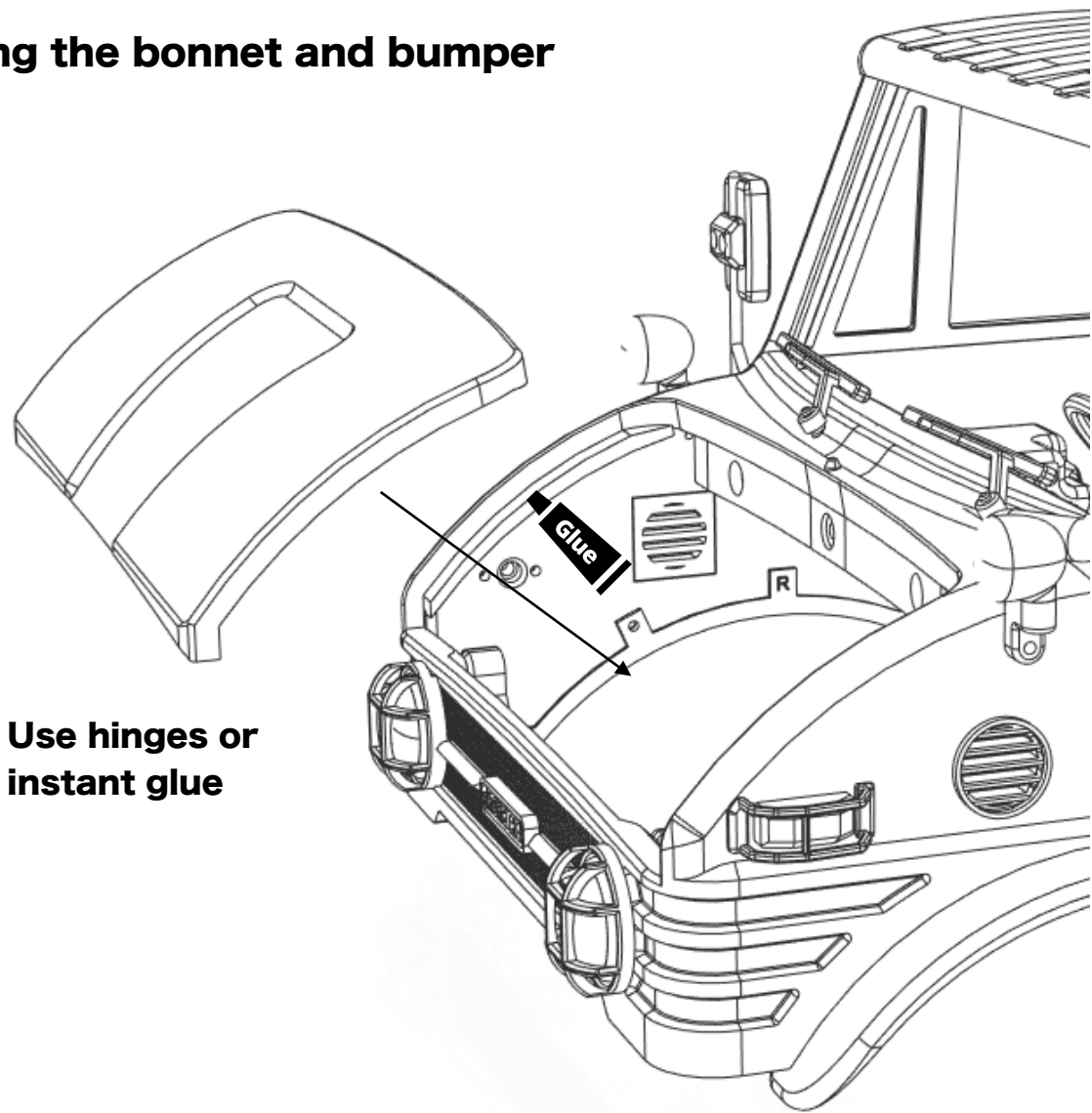

## Installing the mounts

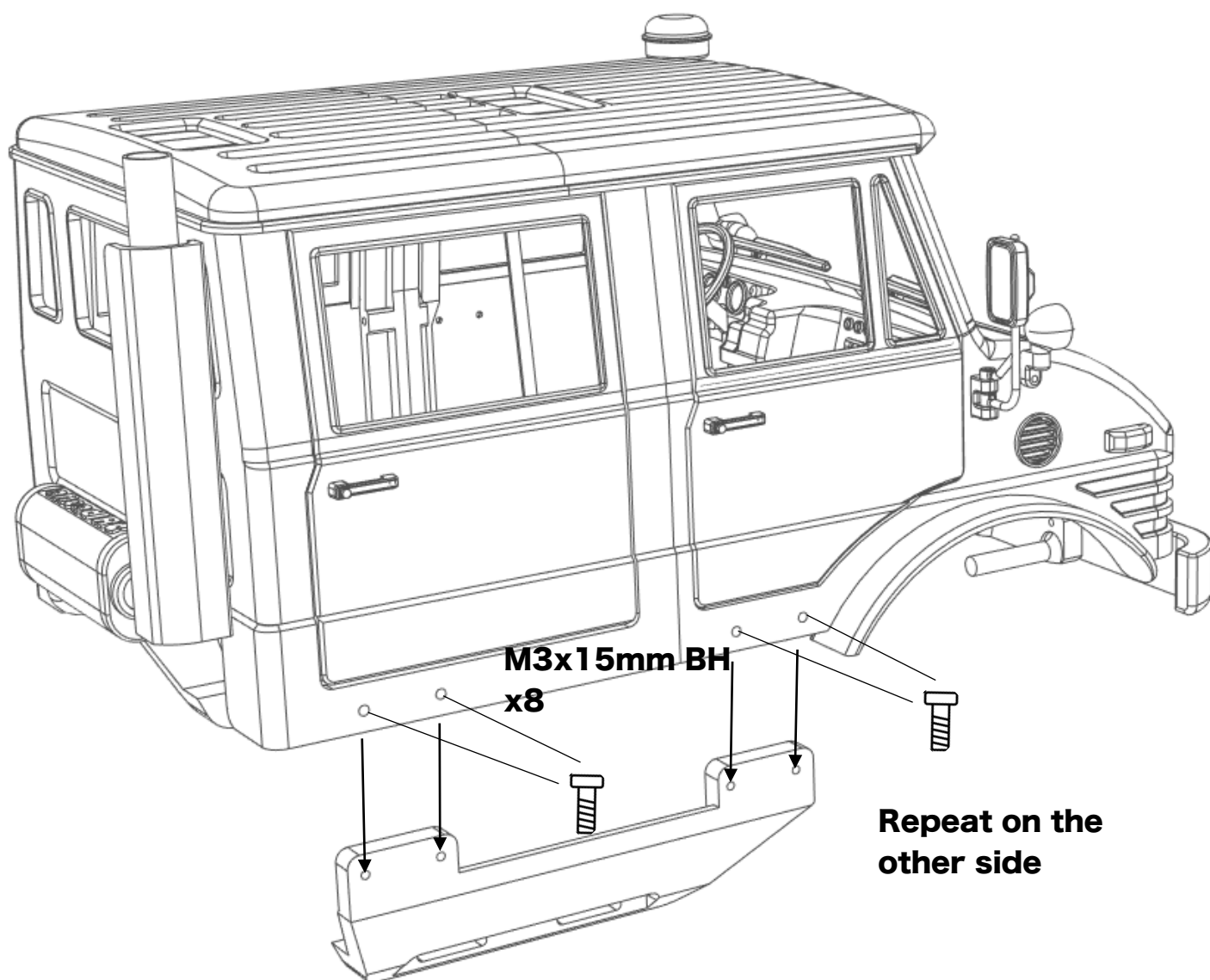

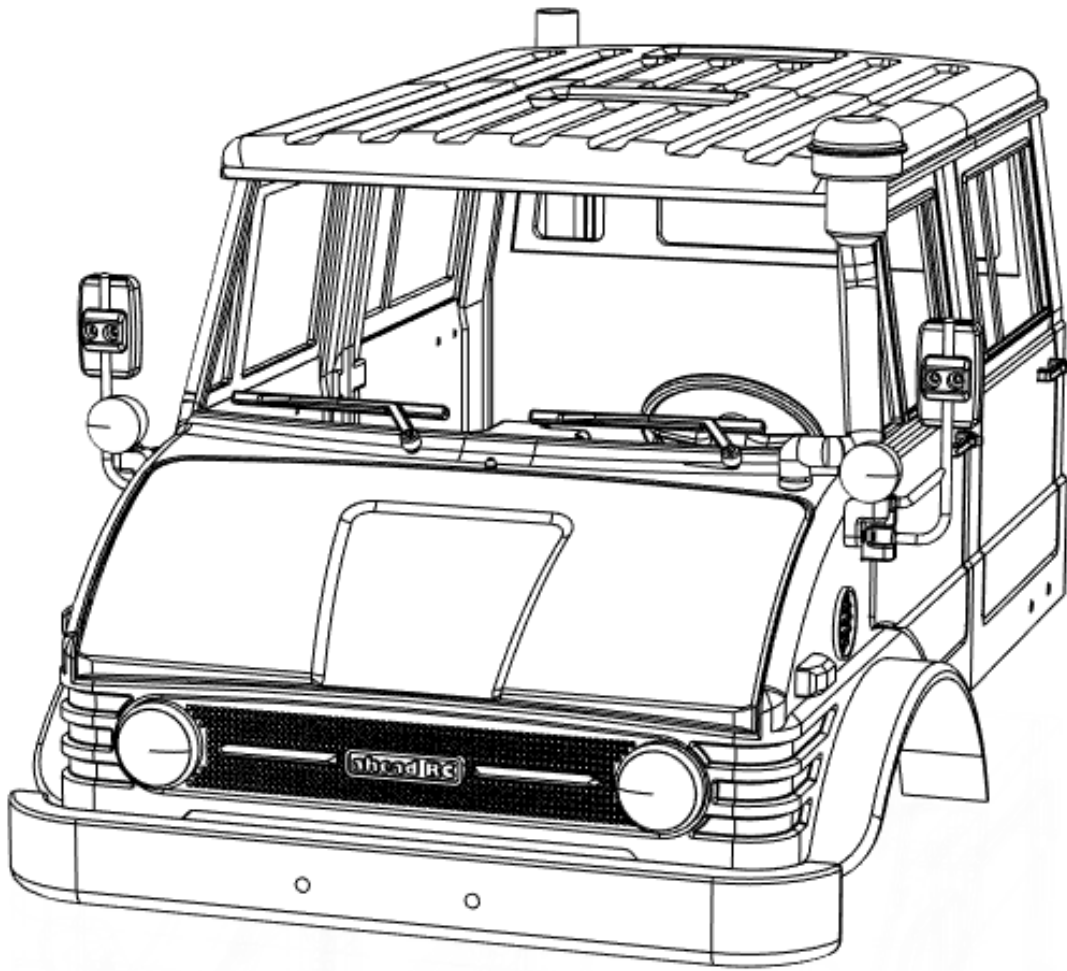

Body is now fully complete. Thank you for selecting ahead RC products.

If you have any questions or need help with the assembly, please do not hesitate to contact us at:

[aheadrc@gmail.com](mailto:aheadrc@gmail.com)

or visit us at:

[www.aheadrc.com](http://www.aheadrc.com)

## Best of luck with your build!